

F.A.I. RTE.	SECTION	COUNTY	TOTAL SHEETS	SHEET NO.
90/94	2005-032 I	COOK	37	14
STA. 108+00		TO STA. 111+25.50		
FED. ROAD DIST. NO. 1	ILLINOIS	FED. AID PROJECT		

60A03

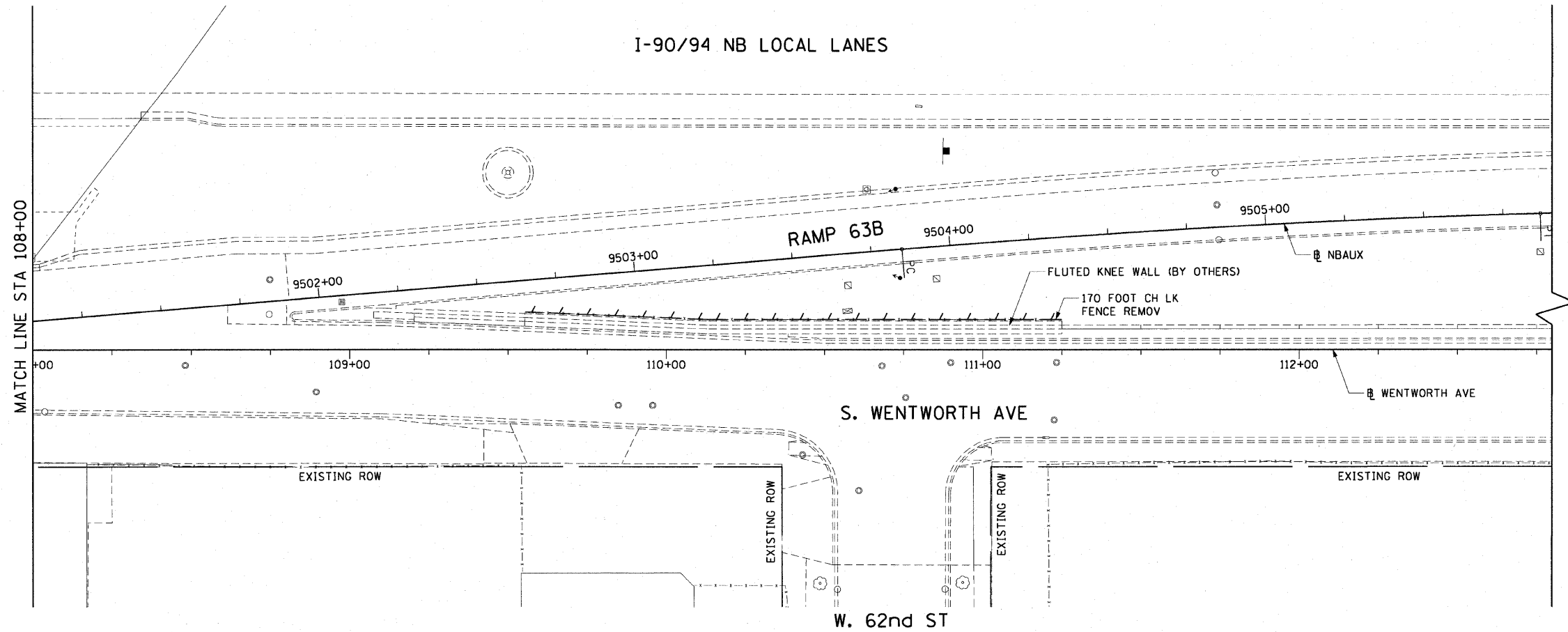
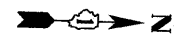

LEGEND:

--- LINEAR REMOVALS

EXISTING CONDITIONS AND REMOVAL
PROPOSED IMPROVEMENTS

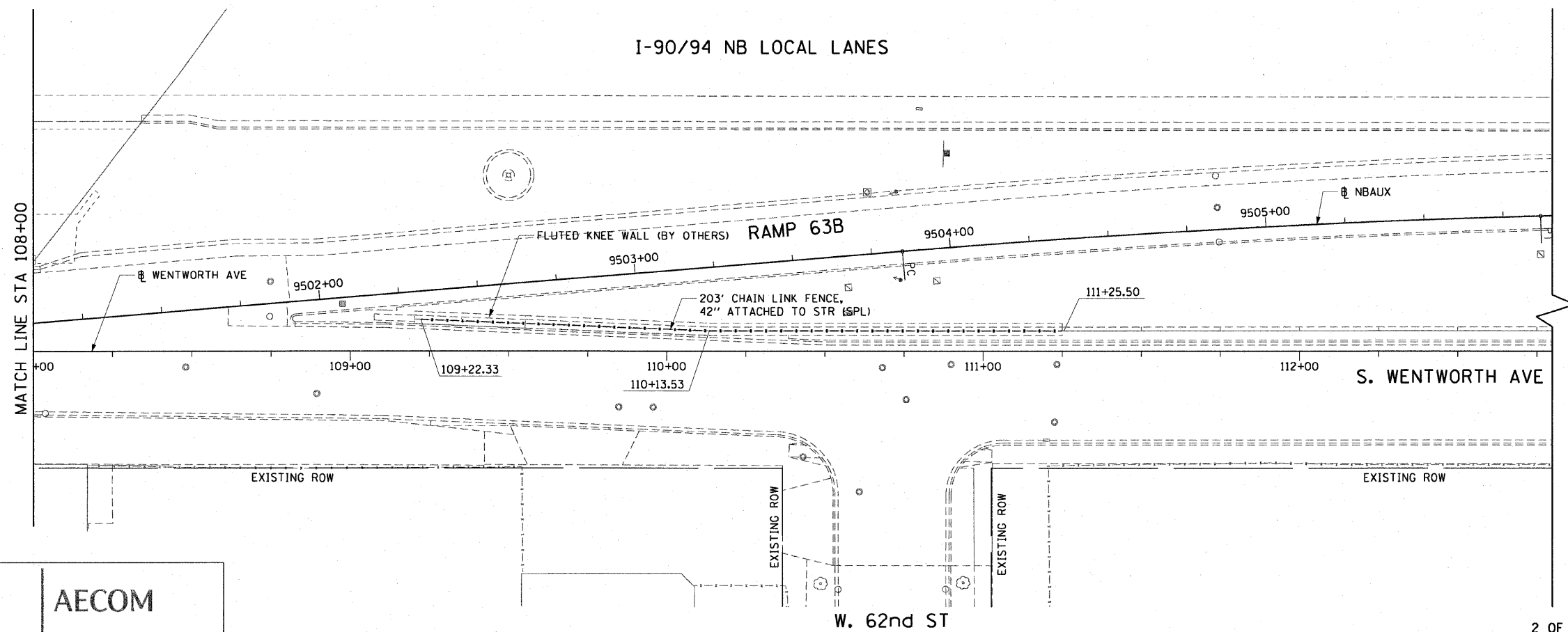

NOTES:

1. SEE STRUCTURAL DETAILS FOR CHAIN LINK FENCE AND GATE DETAILS.
2. ALL STATION CALLOUTS ARE TAKEN AT THE CENTERLINE OF THE CHAIN LINK FENCE.
3. FLUTED KNEE WALL CONSTRUCTED IN CONTRACT 62985.
4. COORDINATE WITH CONTRACT 62985 FOR LOCATION OF FLASHING BEACON POST.

REVISIONS	
NAME	DATE

ILLINOIS DEPARTMENT OF TRANSPORTATION
F.A.I. 90/94 (DAN RYAN EXPRESSWAY)
71ST ST TO 47TH ST (NB & SB FENCE AND GATES)

EXISTING AND PROPOSED ROADWAY PLANS
WENTWORTH AVENUE

SCALE: 1"=20'
DATE: JANUARY 14, 2009
DRAWN BY: NJH
CHECKED BY: RMG

AECOM

V:\schj\p207\p40468\p40468\civil\28-knee-wall_fence\dwg\60a03.dwg 1/13/2009 12:34:15 PM