

F.A.I. RTE.	SECTION	COUNTY	TOTAL SHEETS	SHEET NO.
90/94	2005-032 I	COOK	37	18
STA. 19+43.27		TO STA. 22+00		
FED. ROAD DIST. NO. 1		ILLINOIS FED. AID PROJECT		

60A03

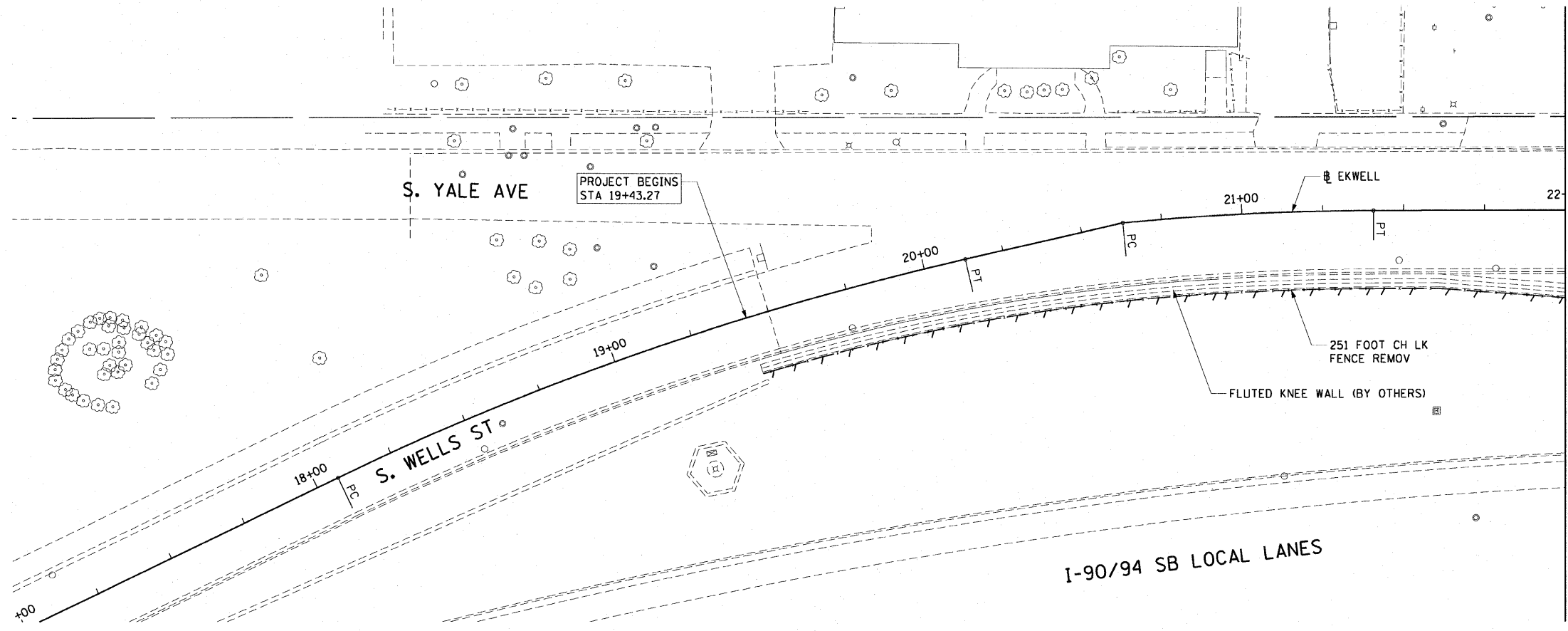

LEGEND:

--- LINEAR REMOVALS

EXISTING CONDITIONS AND REMOVAL

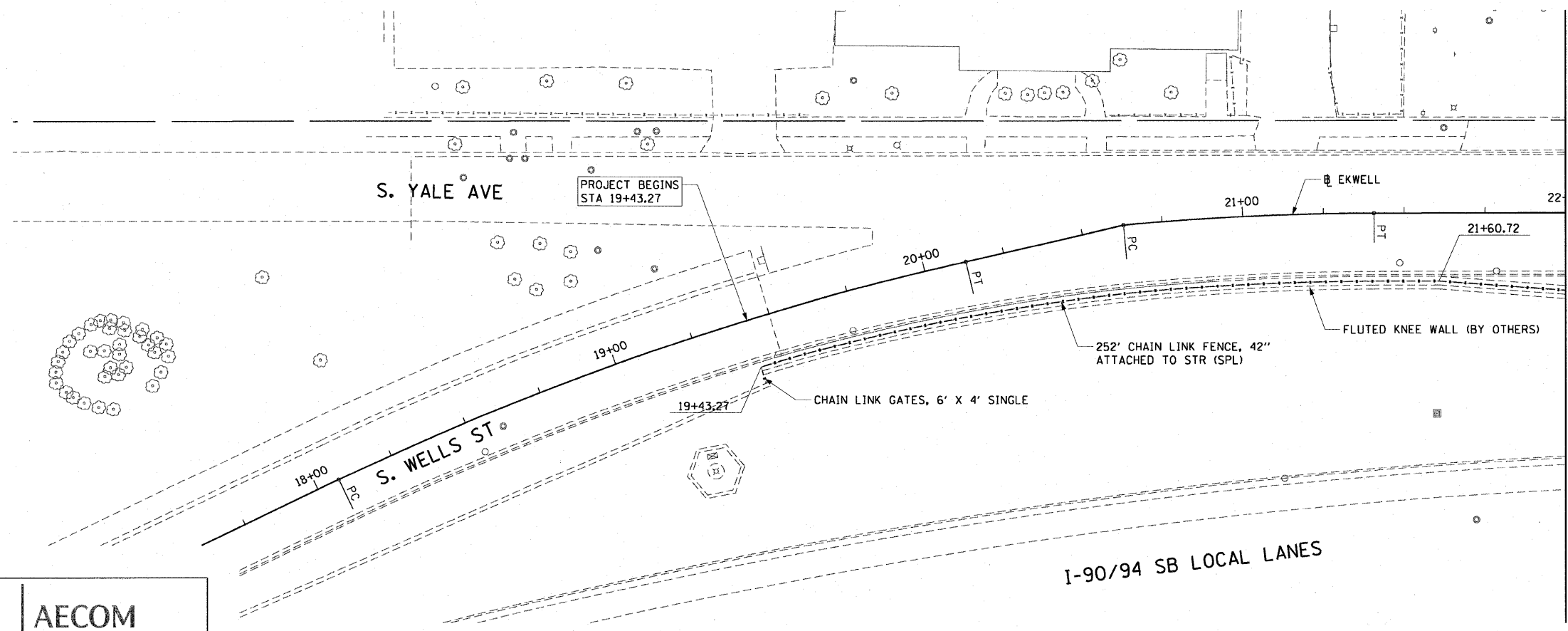

NOTES:

1. SEE STRUCTURAL DETAILS FOR CHAIN LINK FENCE AND GATE DETAILS.
2. ALL STATION CALLOUTS ARE TAKEN AT THE CENTERLINE OF THE CHAIN LINK FENCE.
3. FLUTED KNEE WALL CONSTRUCTED IN CONTRACT 62985.

REVISIONS	
NAME	DATE

ILLINOIS DEPARTMENT OF TRANSPORTATION  
 F.A.I. 90/94 (DAN RYAN EXPRESSWAY)  
 71ST ST TO 47TH ST (NB & SB FENCE AND GATES)  
 EXISTING AND PROPOSED ROADWAY PLANS  
 WELLS STREET

SCALE: 1"=20'  
 DATE: JANUARY 14, 2009  
 DRAWN BY: NJH  
 CHECKED BY: RMG

AECOM

V:\uscity\1207\1207-040465\1207-040465\CIVIL\2B-tree-wall-fence\60A03\contract 3500-350062a.st 12:34:16 PM 1/13/2009