

PRE-STAGE (US ROUTE 30):

1. CLOSE NORTH PORTION OF WB US ROUTE/30 IN ACCORDANCE WITH HIGHWAY STANDARD 701431.
2. PERFORM BRIDGE DECK PATCHING ON NORTH PORTION OF WB US ROUTE 30.
3. REMOVE HIGHWAY STANDARD 701431 UPON COMPLETION OF PATCHING WORK.

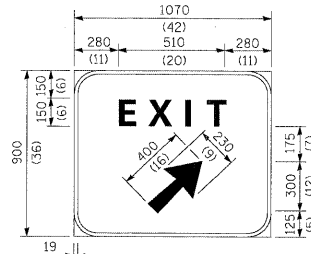

Background - Green
Border and legend - White
"D" size letters
EXIT SIGN - SPECIAL
DETAIL A

TEMPORARY SIGN SUPPORT WITH SIGN AND FLASHING LIGHT. SIGN SUPPORT TO BE STABILIZED WITH SANDBAGS.

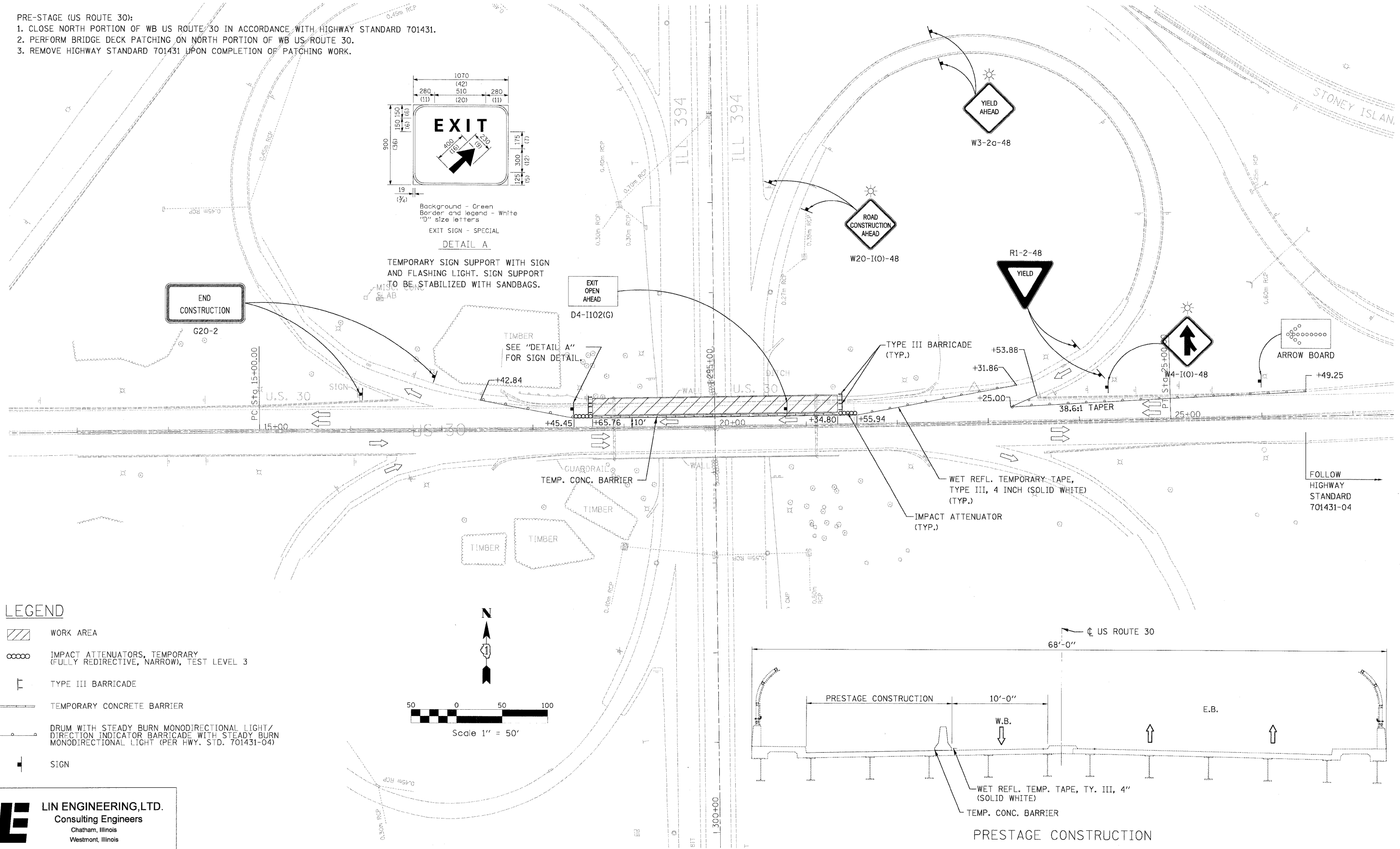

LEGEND

- WORK AREA
- IMPACT ATTENUATORS, TEMPORARY (FULLY REDIRECTIVE, NARROW), TEST LEVEL 3
- TYPE III BARRICADE
- TEMPORARY CONCRETE BARRIER
- DRUM WITH STEADY BURN MONODIRECTIONAL LIGHT / DIRECTION INDICATOR BARRICADE WITH STEADY BURN MONODIRECTIONAL LIGHT (PER HWY. STD. 701431-04)
- SIGN

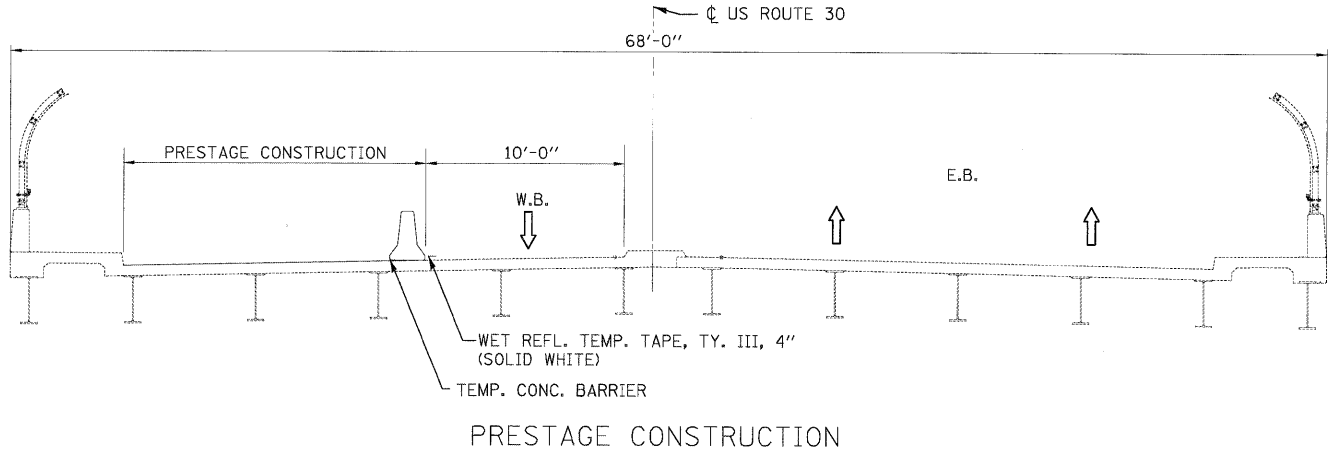
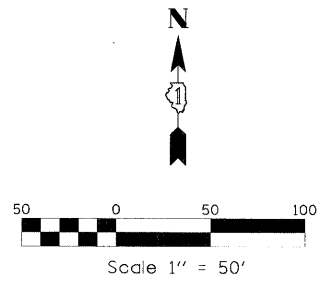

LIN ENGINEERING, LTD.
Consulting Engineers
Chatham, Illinois
Westmont, Illinois

FILE NAME = ...\\D162005-SHT-Stage-Prestage1.dgn	USER NAME = Plotted by Administrator	DESIGNED - ST	REVISED -	STATE OF ILLINOIS DEPARTMENT OF TRANSPORTATION	MAINTENANCE OF TRAFFIC PRESTAGE US ROUTE 30 OVER ILL ROUTE 394	F.A.P. RTE.	SECTION	COUNTY	TOTAL SHEETS	SHEET NO.
PLOT SCALE = 50.00' / IN.	CHECKED - FML	REVISED -	0353			0303.1B-1	COOK	91	13	
PLOT DATE = 5/5/2009	DATE - 05/01/2009	REVISED -	CONTRACT NO. 60C05							
						FED. ROAD DIST. NO. ILLINOIS FED. AID PROJECT				