

ROUTE	SECTION	COUNTY	TOTAL SHEETS	SHEET NUMBER
VARIOUS	2008-053 BP	VARIOUS	54	8

CONTRACT NO. 60F04

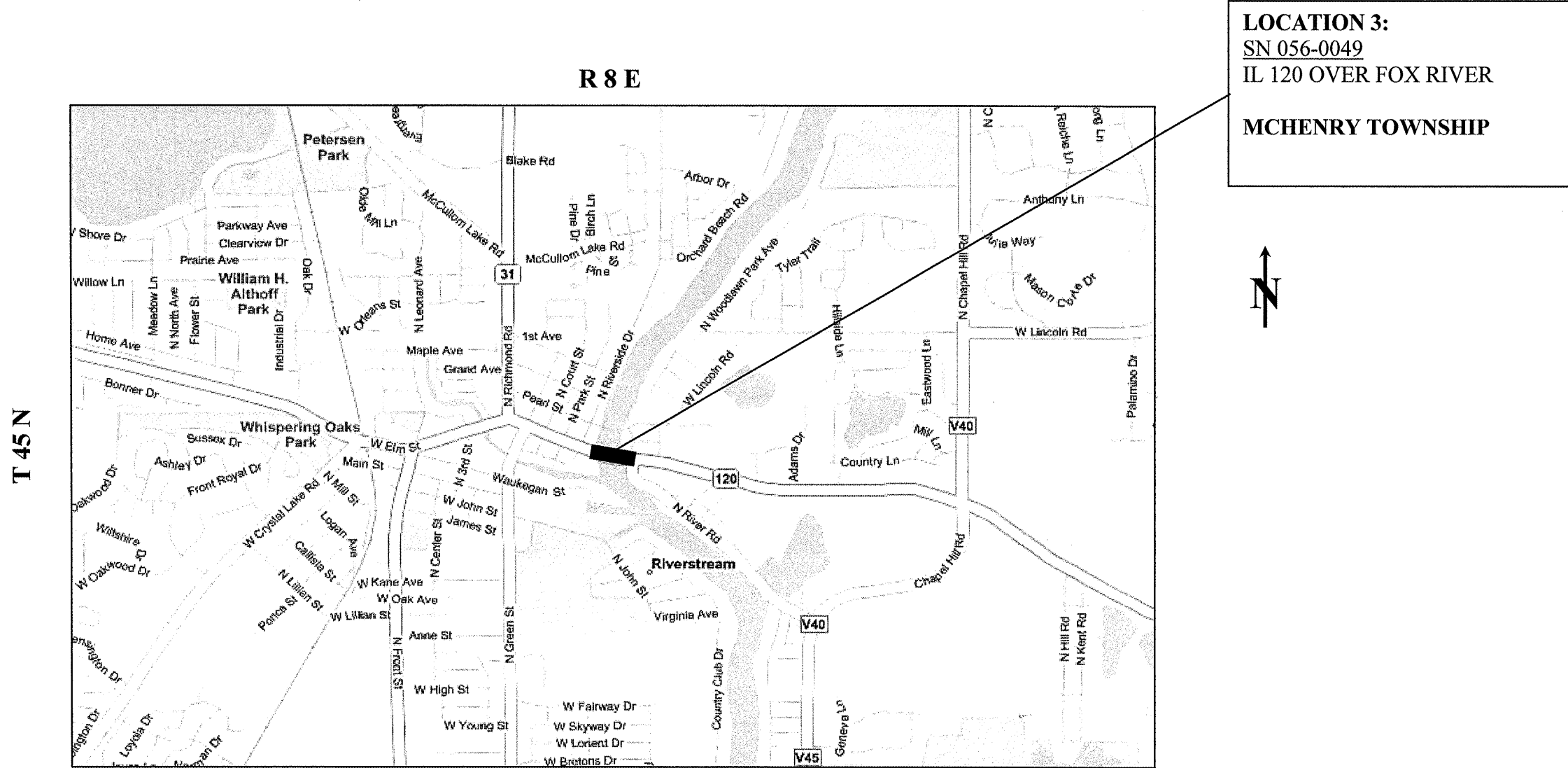

MCHENRY TOWNSHIP
MCHENRY COUNTY

TRAFFIC DATA: IL 120	
2007 ADT	= 20,600
POSTED SPEED LIMIT	= 30 MPH

ILLINOIS DEPARTMENT OF TRANSPORTATION
LOCATION MAPS
LOCATION 3: IL 120 OVER FOX RIVER