

**TYPICAL ENTRANCE/EXIT RAMP COMBINATION PAVEMENT MARKINGS**

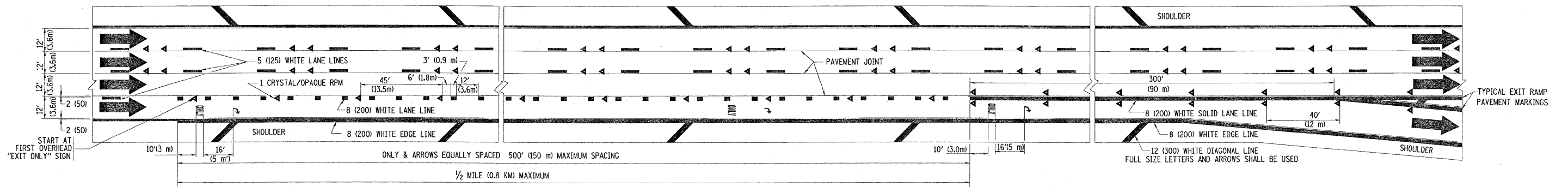

**TYPICAL EXIT ONLY LANE PAVEMENT MARKINGS**

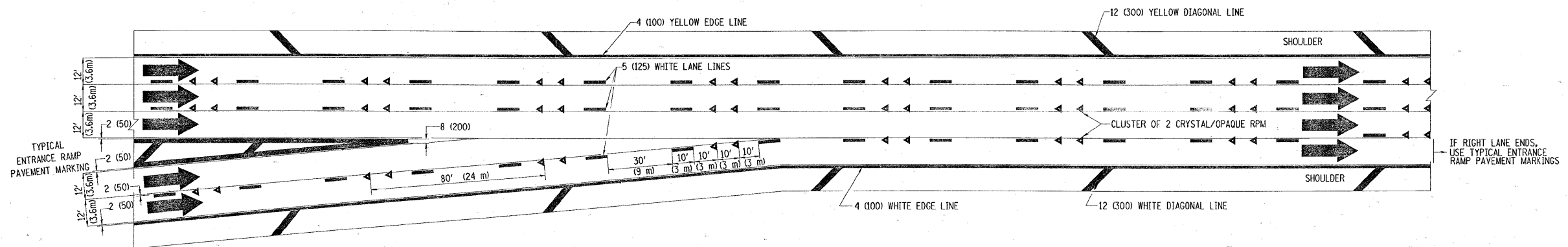

**TYPICAL TWO LANE ENTRANCE RAMP PAVEMENT MARKINGS**

FILE NAME =	USER NAME = steedpo	DESIGNED - D.W.S.	REVISED - A.H. 03-96	<b>STATE OF ILLINOIS DEPARTMENT OF TRANSPORTATION</b>	<b>MULTI-LANE FREEWAY PAVEMENT MARKING DETAILS</b>		F.A. RTE. 57	SECTION 2009-065 I	COUNTY WILL	TOTAL SHEETS 36	SHEET NO. 34	
at\p\work\p\wido\stedpo\00142782\01st3\01.dgn		DRAWN -	REVISED - D.W.S. 07-96		SCALE: NONE	SHEET NO. 2 OF 2 SHEETS	STA. TO STA.	<b>TC-12</b>		CONTRACT NO. 60H55		
		CHECKED -	REVISED - J.A.F. 02-06		FED. ROAD DIST. NO. 1 ILLINOIS FED. AID PROJECT							
		DATE - 01-90	REVISED - S.P.B. 01-07									