

PROFILE	DATE
BURNED	
PLANS	
CHECKED	
BY	
NO.	
STRUCTURE	
NOTATIONS	
CPROD	

F.A.I. RTE.	SECTION	COUNTY	TOTAL SHEETS	SHEET NO.
90/94	1717 I-6	COOK	60	36
STA. 2265+32.63		TO STA. 2287+21.27		
FED. ROAD DIST. NO.	ILLINOIS	FED. AID PROJECT	62973	

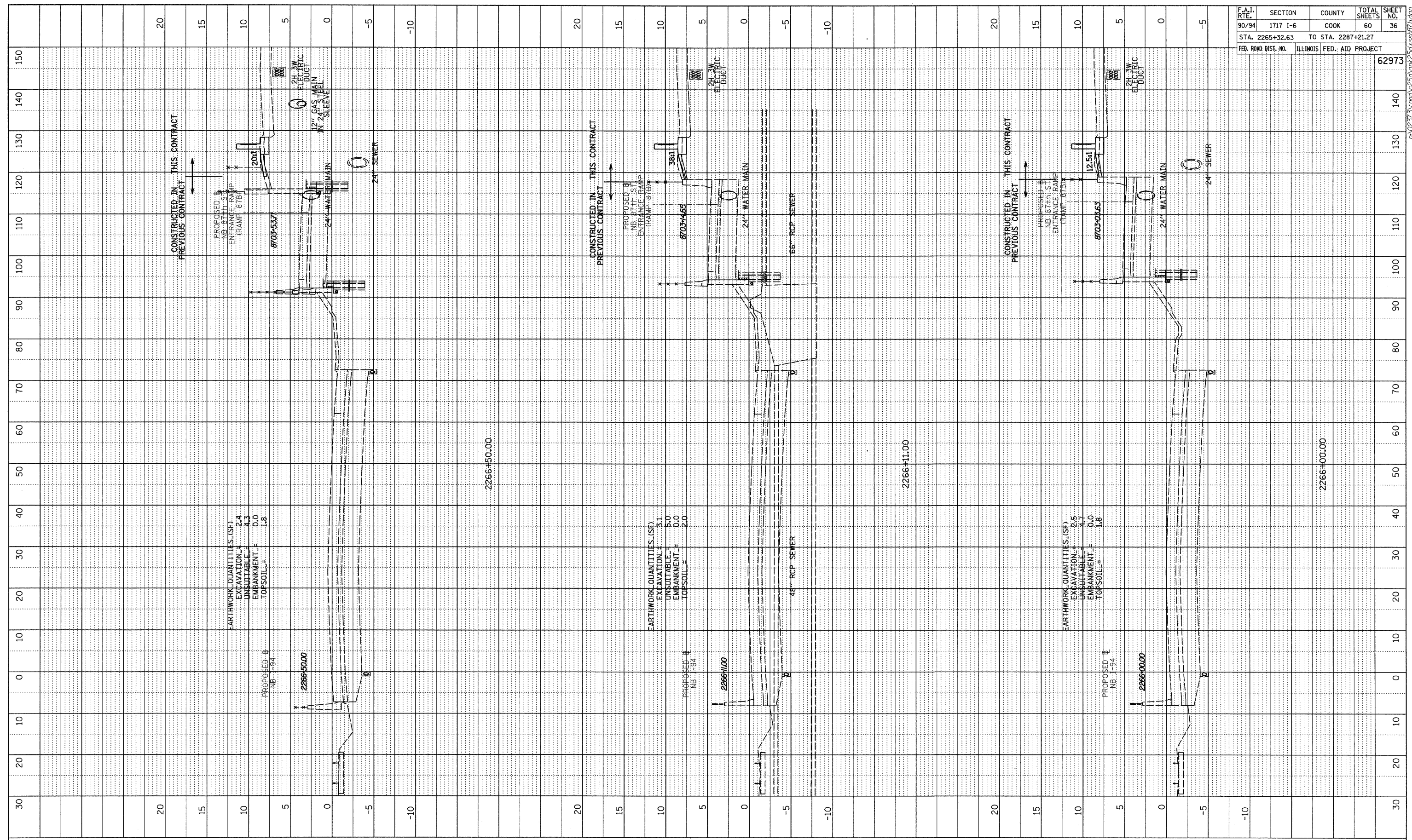

EARTHWORK QUANTITIES (SF)
 EXCAVATION = 2.4
 UNSUITABLE = 4.3
 EMBANKMENT = 0.0
 TOPSOIL = 1.8

EARTHWORK QUANTITIES (SF)
 EXCAVATION = 3.1
 UNSUITABLE = 5.0
 EMBANKMENT = 0.0
 TOPSOIL = 2.0

EARTHWORK QUANTITIES (SF)
 EXCAVATION = 2.5
 UNSUITABLE = 4.7
 EMBANKMENT = 0.0
 TOPSOIL = 1.8

TYLIN INTERNATIONAL

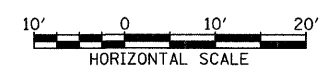

NB I-94 (DAN RYAN EXPRESSWAY)
 STA. 2266+00 TO STA. 2266+50

A:\0237\3\road\255\gpk\255\ass\87\tdwg