

PROFILE	DATE
BY	
REVIEWED	
DESIGNED	
CHECKED	
NO. NOTED	
NO.	
STRUCTURE	
INDICATING	
DEPTH	

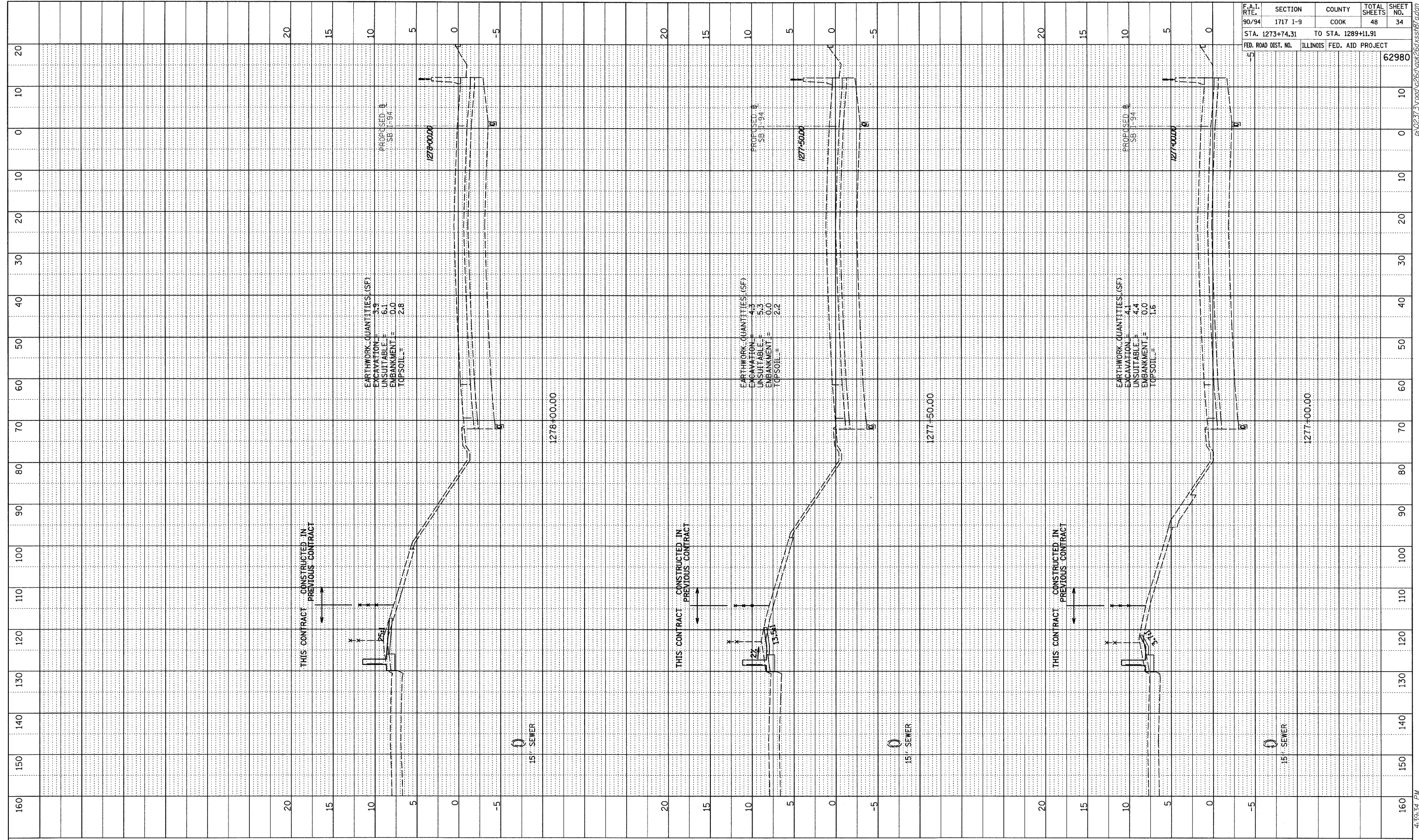

F.A.I. RTE.	SECTION	COUNTY	TOTAL SHEETS	SHEET NO.
90/94	1717 I-9	COOK	48	34
STA. 1273+74.31		TO STA. 1289+11.91		
FED. ROAD DIST. NO.		ILLINOIS FED. AID PROJECT		
				62980

TYLIN INTERNATIONAL

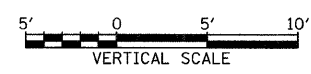
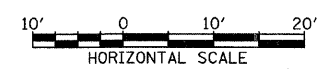

SB I-94 (DAN RYAN EXPRESSWAY)  
STA. 1277+00 TO STA. 1278+00

10/16/2008 4:39:34 PM