

PROFILE	SURVEYED	BY	DATE
NOTE BOOK	CHECKED		
NO.	STRUCTURE NOTATIONS		

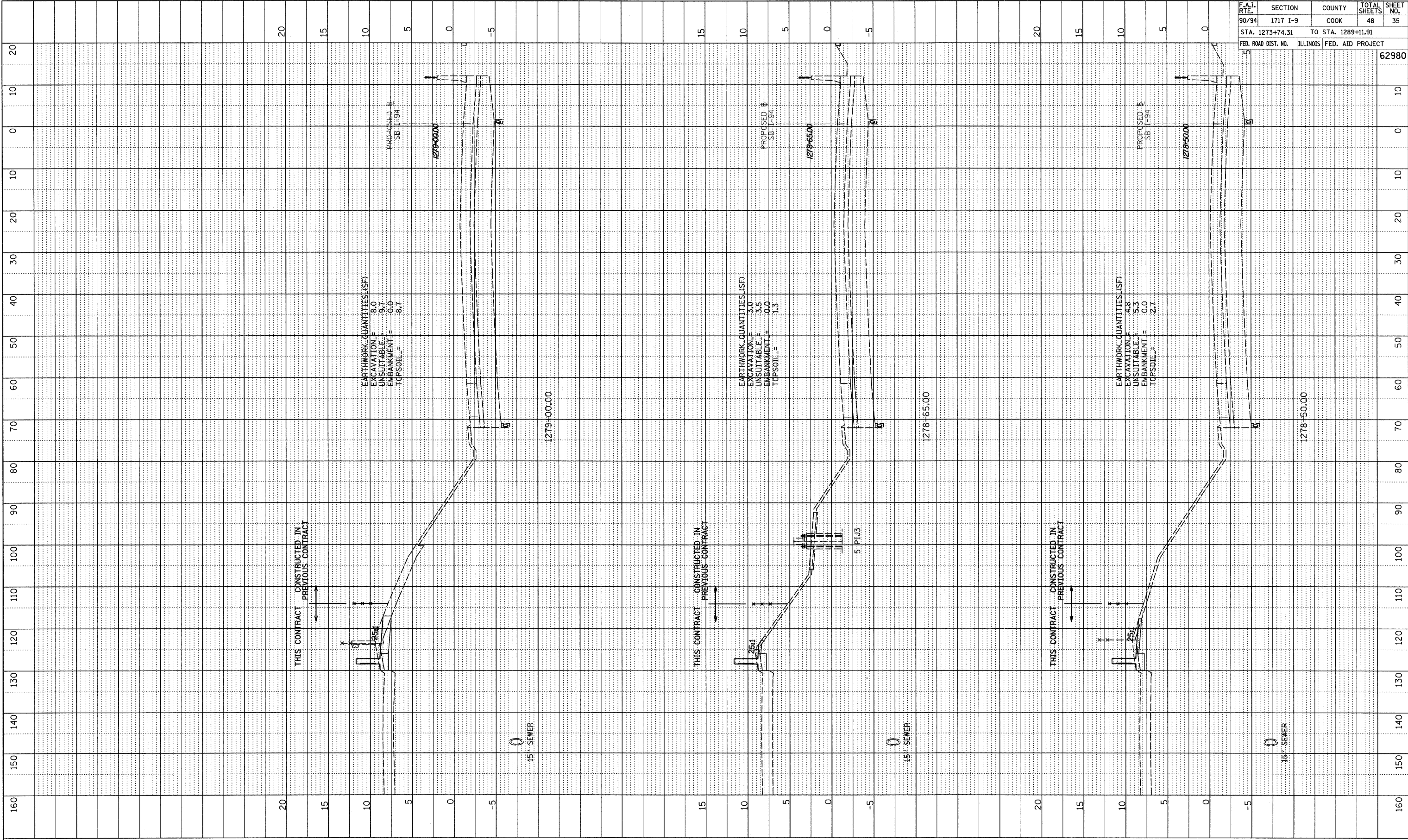

F.A.I. RTE.	SECTION	COUNTY	TOTAL SHEETS	SHEET NO.
90/94	1717 I-9	COOK	48	35
STA. 1273+74.31		TO STA. 1289+11.91		
FED. ROAD DIST. NO.	ILLINOIS	FED. AID PROJECT		
				62980

TYLIN INTERNATIONAL

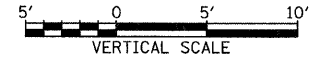
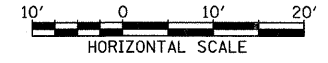

SB I-94 (DAN RYAN EXPRESSWAY)
STA. 1278+50 TO STA. 1279+00

10/16/2008 4:39:34 PM