

| | | |
|-----------|---------------------|------|
| PROFILE | SUPERVISED | DATE |
| NOTE BOOK | PROJECT CHECKED | |
| NO. | B.M. NOTED | |
| | STRUCTURE NOTATIONS | CRFD |

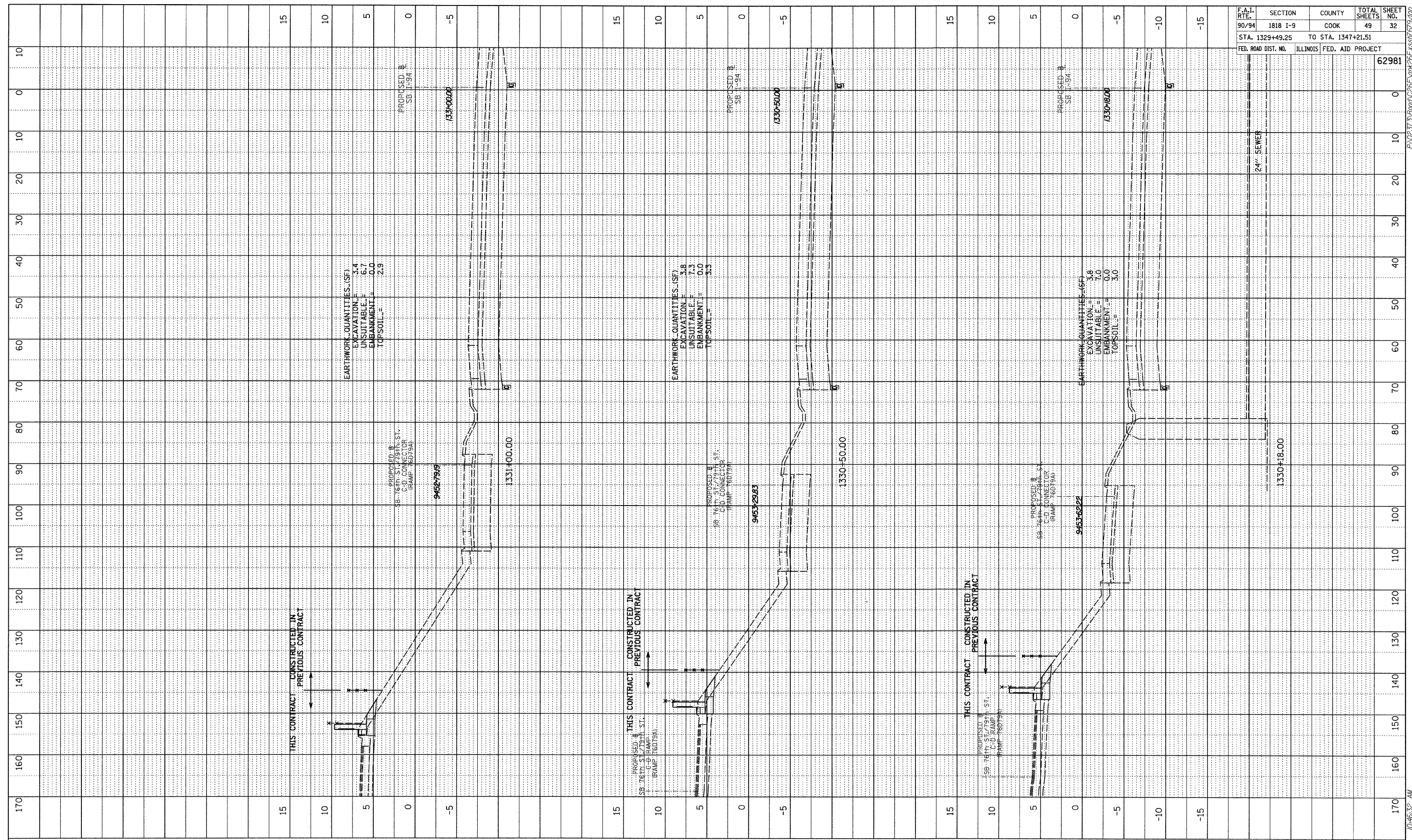

| | | | | |
|---------------------|----------|--------------------|--------------|-----------|
| F.A.I. RTE. | SECTION | COUNTY | TOTAL SHEETS | SHEET NO. |
| 90/94 | 1818 I-9 | COOK | 49 | 32 |
| STA. 1329+49.25 | | TO STA. 1347+21.51 | | |
| FED. ROAD DIST. NO. | ILLINOIS | FED. AID PROJECT | | |
| | | 62981 | | |

TYLIN INTERNATIONAL

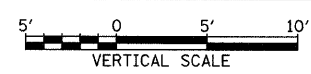
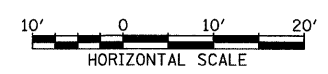

SB I-94 (DAN RYAN EXPRESSWAY)
STA. 1330+18 TO STA. 1331+00

10/17/2008 10:46:32 AM P:\0237\3\road\c26e\p\26e\assn\679.dgn