

PROFILE	SURVEYED	BY	DATE
NOTE BOOK	PLANS CHECKED		
NO.	DATE NOTED		
	STRUCTURE NOTATIONS CHRD		

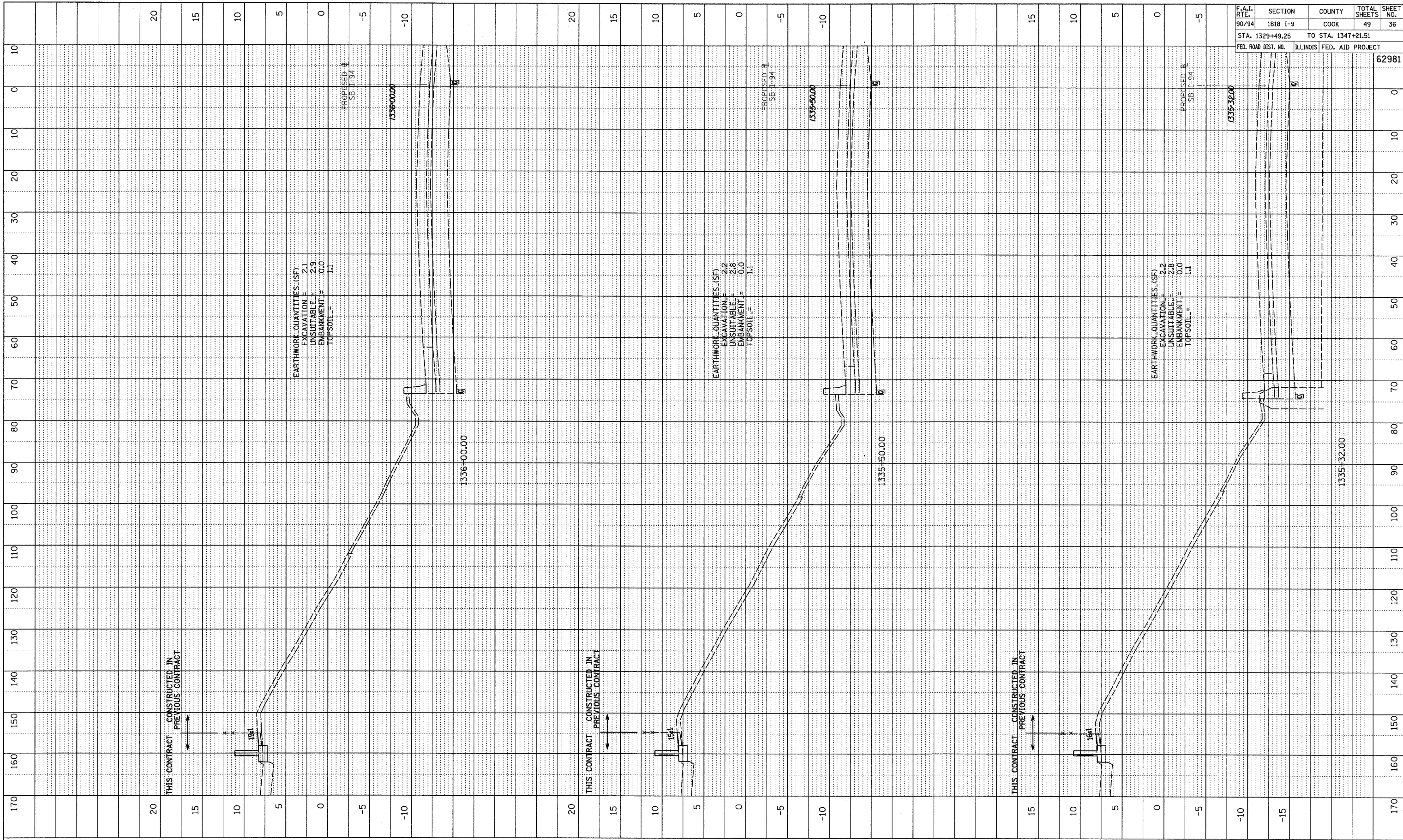

F.A.I. RTE.	SECTION	COUNTY	TOTAL SHEETS	SHEET NO.
90/94	1818 I-9	COOK	49	36
STA. 1329+49.25		TO STA. 1347+21.51		
FED. ROAD DIST. NO.	ILLINOIS	FED. AID PROJECT		
		62981		

TYLIN INTERNATIONAL

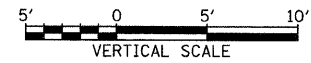

SB I-94 (DAN RYAN EXPRESSWAY)  
STA. 1335+32 TO STA. 1336+00

10/17/2008 10:46:33 AM