

PROFILE SURVEYED BY DATE  
 POINTS OBTAINED BY DATE  
 NOTE BOOK NO. DATE CHECKED BY DATE  
 NO. STRUCTURE NOTATIONS CIRCD

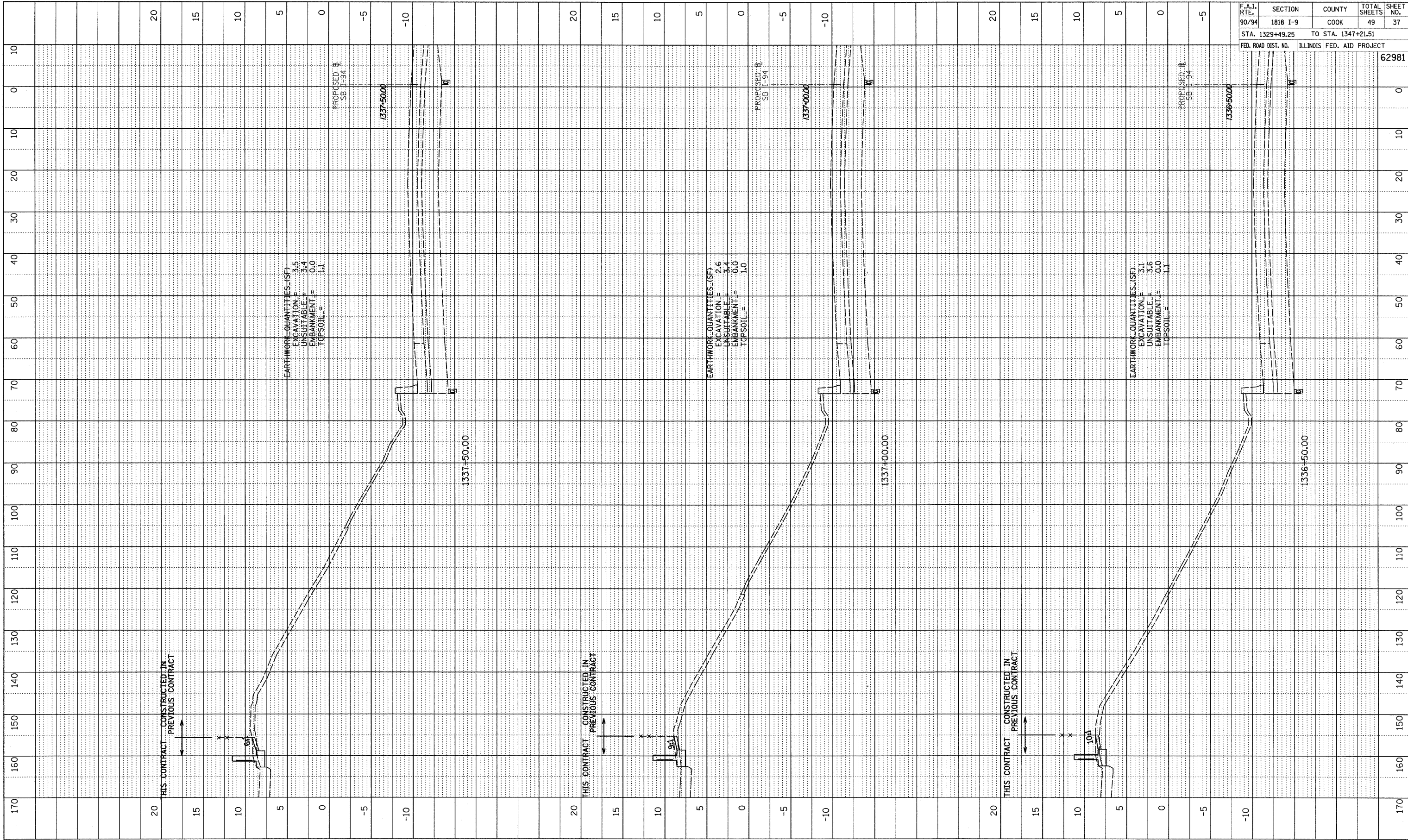

F.A.I. RTE.	SECTION	COUNTY	TOTAL SHEETS	SHEET NO.
90/94	1818 I-9	COOK	49	37
STA. 1329+49.25		TO STA. 1347+21.51		
FED. ROAD DIST. NO.		ILLINOIS FED. AID PROJECT		
				62981

TYLIN INTERNATIONAL

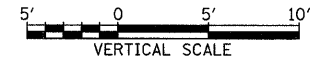
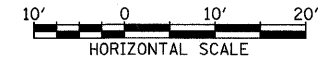

SB I-94 (DAN RYAN EXPRESSWAY)  
 STA. 1336+50 TO STA. 1337+50

10/17/2008 10:46:33 AM P:\0231\road\0266\0266.dwg 266.kassab69.dwg