

PROFILE SURVEYED BY DATE
 NOTES CHECKED BY
 NOTE BOOK NO. NOTED BY
 NO. STRUCTURE NOTATIONS CHFD

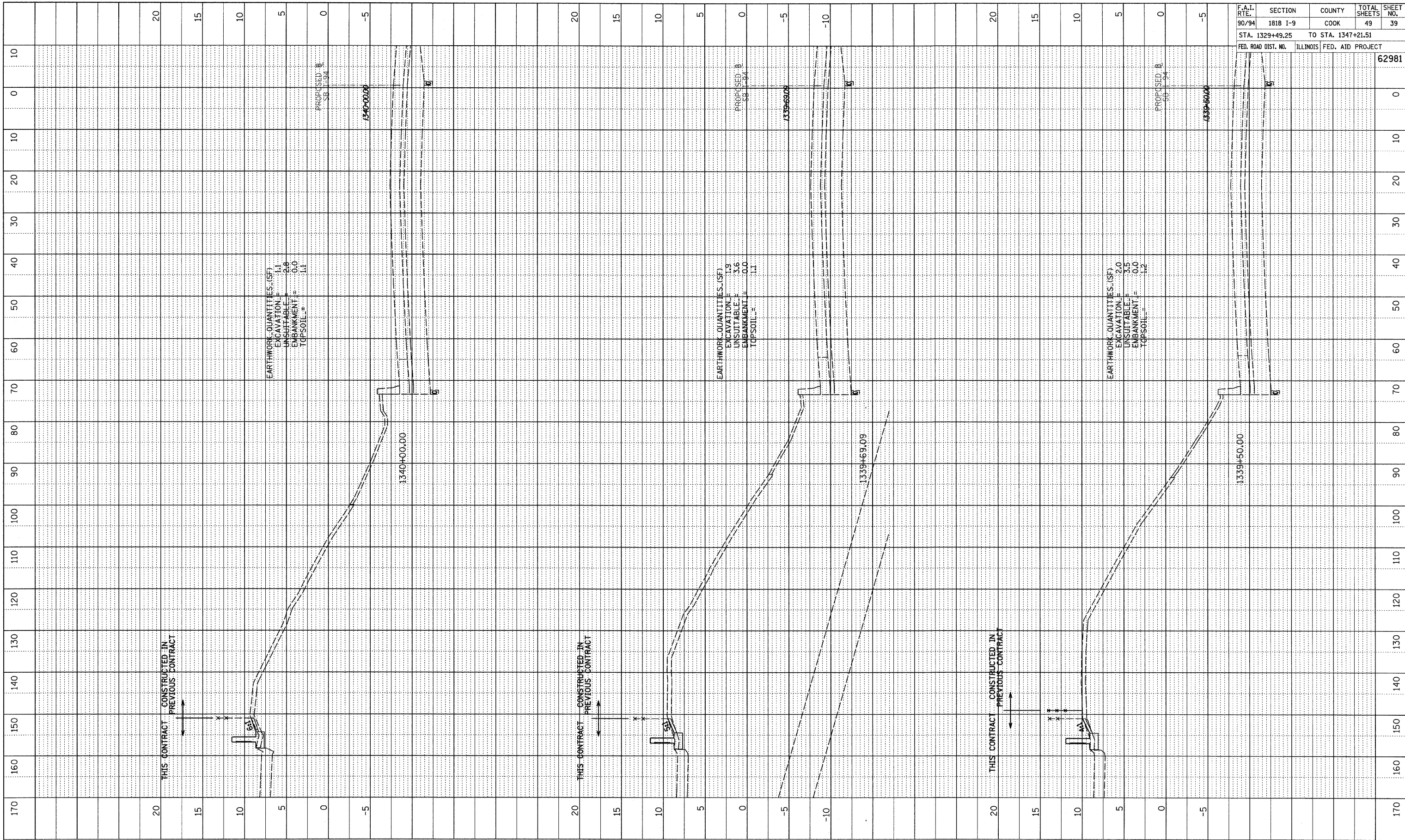

F.A.I. RTE.	SECTION	COUNTY	TOTAL SHEETS	SHEET NO.
90/94	1818 I-9	COOK	49	39
STA. 1329+49.25		TO STA. 1347+21.51		
FED. ROAD DIST. NO.		ILLINOIS FED. AID PROJECT		62981

TYLIN INTERNATIONAL

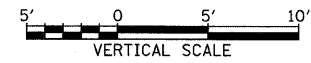
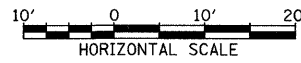

SB I-94 (DAN RYAN EXPRESSWAY)
 STA. 1339+50 TO STA. 1340+00

10/17/2008 10:46:34 AM