

PROFILE SURVEYED BY DATE
 PLOTTED BY
 NOTE BOOK NO. CHECKED BY
 NO. STRUCTURE NOTATIONS CHRD

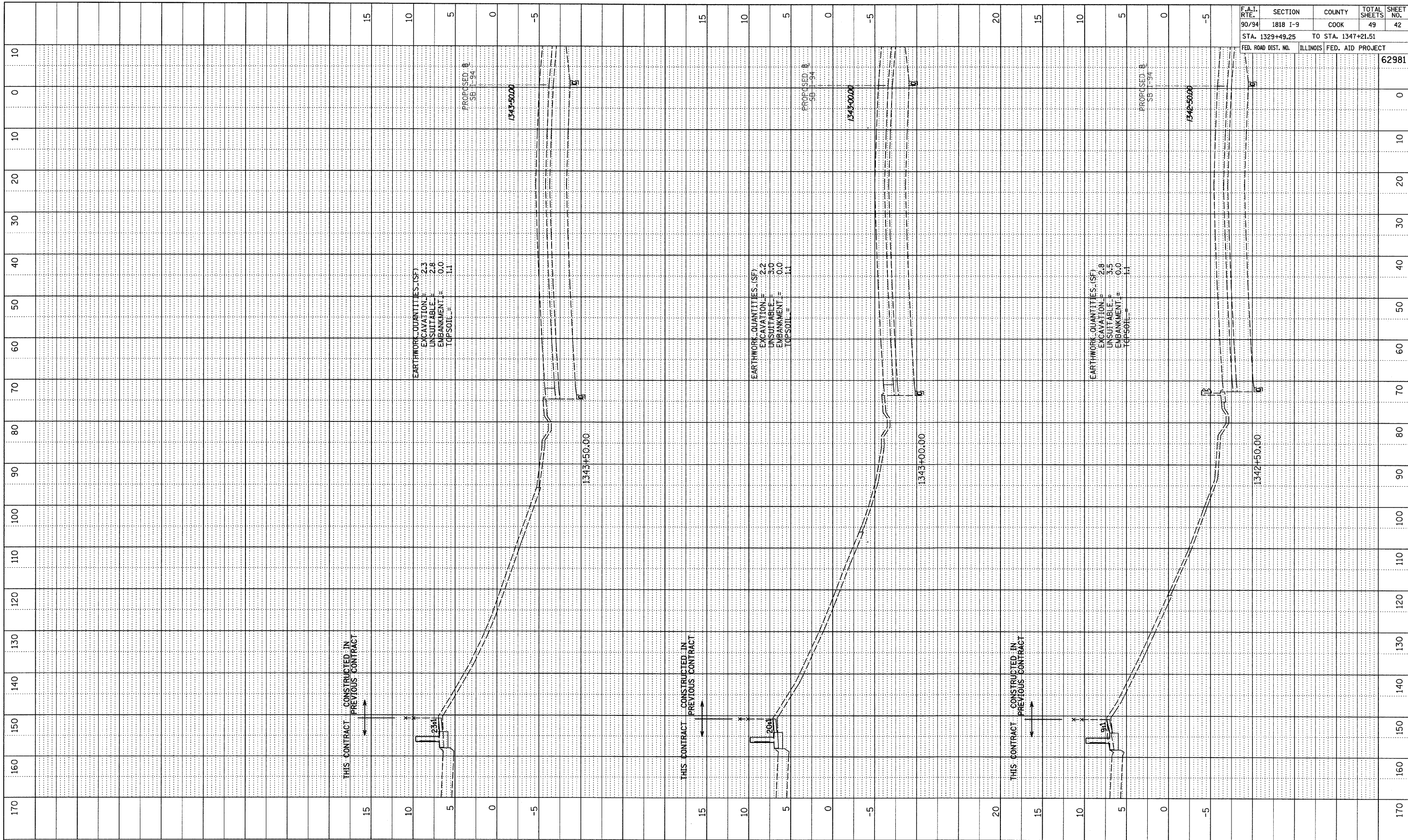

F.A.I. RTE.	SECTION	COUNTY	TOTAL SHEETS	SHEET NO.
90/94	1818 I-9	COOK	49	42
STA. 1329+49.25		TO STA. 1347+21.51		
FED. ROAD DIST. NO.	ILLINOIS	FED. AID PROJECT	62981	

TYLIN INTERNATIONAL

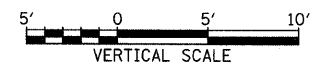

SB I-94 (DAN RYAN EXPRESSWAY)
 STA. 1342+50 TO STA. 1343+50

10/17/2008 10:46:35 AM P:\02313\road\62981\2\pers\17.5.dgn