

F.A.I. RTE.	SECTION	COUNTY	TOTAL SHEETS	SHEET NO.
90/94	*	COOK	31	5
STA. TO STA.			FED. ROAD DIST. NO. 1 ILLINOIS FED. AID PROJECT	
* (1818, 1919, 1919.15) 1-12			62984	

CURVE SBRMPO1	CURVE SBRMPO2	CURVE SBRMPO3	CURVE SBRMPO4
P.I. STA= 7107+24.23	P.I. STA= 7108+91.39	P.I. STA= 7110+86.37	P.I. STA= 7119+30.94
N= 1,859,529.38	N= 1,859,362.26	N= 1,859,167.46	N= 1,858,325.18
E= 1,177,115.44	E= 1,177,123.31	E= 1,177,131.79	E= 1,177,066.71
Δ= 5° 33' 25"	Δ= 0° 12' 05"	Δ= 6° 54' 42"	Δ= 5° 56' 51"
D= 2° 51' 53"	D= 0° 08' 36"	D= 3° 49' 11"	D= 28° 38' 52"
R= 2,000.00'	R= 39,975.44'	R= 1,500.00'	R= 200.00'
T= 97.06'	T= 70.24'	T= 90.58'	T= 10.39'
L= 193.98	L= 140.48	L= 180.95	L= 20.76
e= 2.35'	e= 0.06'	e= 2.73'	e= 0.27'
TR= N/A	TR= N/A	TR= N/A	TR= N/A
S.E. RUN= N/A	S.E. RUN= N/A	S.E. RUN= N/A	S.E. RUN= N/A
P.C. STA= 7106+27.17	P.C. STA= 7108+21.14	P.C. STA= 7109+95.79	P.C. STA= 7119+20.55
N= 1,859,625.44	N= 1,859,432.42	N= 1,859,257.95	N= 1,858,335.54
E= 1,177,101.51	E= 1,177,120.01	E= 1,177,127.85	E= 1,177,067.52
P.T. STA= 7108+21.14	P.T. STA= 7109+61.63	P.T. STA= 7111+76.74	P.T. STA= 7119+41.31
N= 1,859,432.42	N= 1,859,292.09	N= 1,859,077.14	N= 1,858,314.79
E= 1,177,120.01	E= 1,177,126.36	E= 1,177,124.81	E= 1,177,066.99

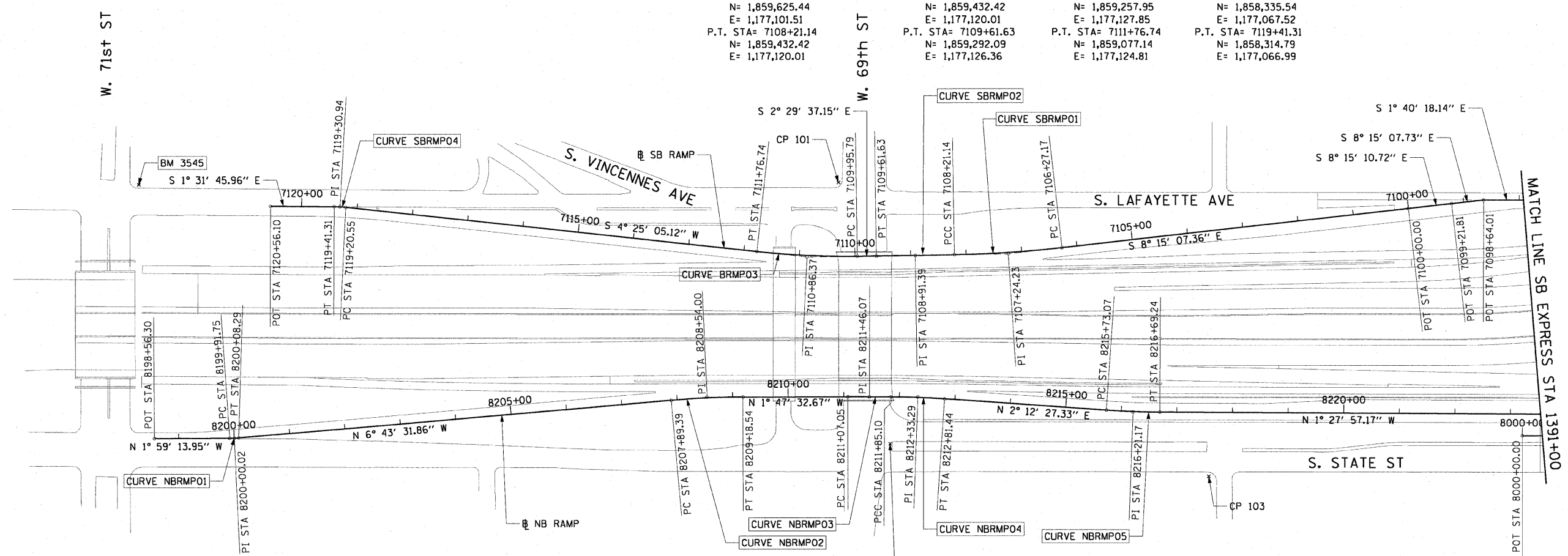
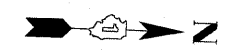

- BENCH MARK NO. 3528 ELEV. 16.20**
DESCRIPTION: CROSS CUT ON NORTHWESTERLY BOLT OF FIRE HYDRANT AT THE NORTHWEST CORNER OF 45TH ST AND WENTWORTH AVE
- BENCH MARK NO. 3530 ELEV. 18.18**
DESCRIPTION: CROSS CUT ON SOUTHEAST BOLT OF LIGHT POLE BASE AT THE NORTHWEST CORNER OF 51ST ST AND WELLS ST
- BENCH MARK NO. 3531 ELEV. 17.55**
DESCRIPTION: CROSS CUT ON NORTHEASTERLY FLANGE BOLT OF FIRE HYDRANT AT THE NORTHEAST CORNER OF GARFIELD BLVD AND WELLS ST
- BENCH MARK NO. 3532 ELEV. 18.84**
DESCRIPTION: HORIZONTAL BOLT ON CTA "EL" STRUCTURE, EAST SIDE OF WELLS ST ABOUT 50 FEET NORTH OF 59TH PL.
- BENCH MARK NO. 3533 ELEV. 19.71**
DESCRIPTION: BRASS DISK (CTA MONUMENT) AT THE SOUTHWEST CORNER OF 63RD ST AND HARVARD ST

- BENCH MARK NO. 3535 ELEV. 19.31**
DESCRIPTION: FOUND CROSS CUT ON SOUTHERLY FLANGE BOLT OF FIRE HYDRANT AT THE NORTHEAST CORNER OF 59TH ST AND WENTWORTH AVE
- BENCH MARK NO. 3536 ELEV. 18.37**
DESCRIPTION: CROSS CUT ON SOUTHEASTERLY FLANGE BOLT OF FIRE HYDRANT AT THE SOUTHEAST CORNER OF GARFIELD BLVD AND WENTWORTH AVE
- BENCH MARK NO. 3537 ELEV. 17.71**
DESCRIPTION: CROSS CUT ON NORTHEASTERLY FLANGE BOLT OF FIRE HYDRANT AT THE NORTHEAST CORNER OF 51ST ST AND WENTWORTH AVE
- BENCH MARK NO. 3538 ELEV. 17.31**
DESCRIPTION: CROSS CUT ON WESTERLY FLANGE BOLT OF FIRE HYDRANT AT THE NORTHWEST CORNER OF 67TH ST AND LAFAYETTE AVE
- BENCH MARK NO. 3544 ELEV. 19.38**
DESCRIPTION: CROSS CUT ON EASTERLY FLANGE BOLT OF FIRE HYDRANT AT THE NORTHEAST CORNER OF 47TH ST AND LASALLE ST
- BENCH MARK NO. 3545 ELEV. 10.53**
DESCRIPTION: CROSS CUT ON NORTHWEST BOLT OF LIGHT POLE BASE AT THE NORTHWEST CORNER OF 71ST ST AND LAFAYETTE AVE

CURVE NBRMPO1	CURVE NBRMPO2	CURVE NBRMPO3	CURVE NBRMPO4
P.I. STA= 8200+00.02	P.I. STA= 8208+54.00	P.I. STA= 8211+46.07	P.I. STA= 8212+33.29
N= 1,858,147.27	N= 1,858,995.39	N= 1,859,287.39	N= 1,859,374.58
E= 1,177,489.42	E= 1,177,389.40	E= 1,177,380.27	E= 1,177,378.02
Δ= 4° 44' 18"	Δ= 4° 55' 59"	Δ= 0° 19' 12"	Δ= 3° 40' 48"
D= 28° 38' 52"	D= 3° 49' 11"	D= 0° 24' 36"	D= 3° 49' 11"
R= 200.00'	R= 1,500.00'	R= 13,976.00'	R= 1,500.00'
T= 8.27'	T= 64.61'	T= 39.03'	T= 48.19'
L= 16.54	L= 129.15	L= 78.05	L= 96.34
e= 0.17'	e= 1.39'	e= 0.05'	e= 0.77'
TR= N/A	TR= N/A	TR= N/A	TR= N/A
S.E. RUN= N/A	S.E. RUN= N/A	S.E. RUN= N/A	S.E. RUN= N/A
P.C. STA= 8199+91.75	P.C. STA= 8207+89.39	P.C. STA= 8211+07.05	P.C. STA= 8211+85.10
N= 1,858,139.01	N= 1,858,931.22	N= 1,859,248.39	N= 1,859,326.41
E= 1,177,489.70	E= 1,177,396.97	E= 1,177,381.49	E= 1,177,379.26
P.T. STA= 8200+08.29	P.T. STA= 8209+18.54	P.T. STA= 8211+85.10	P.T. STA= 8212+81.44
N= 1,858,155.49	N= 1,859,059.97	N= 1,859,326.41	N= 1,859,422.73
E= 1,177,488.45	E= 1,177,387.38	E= 1,177,379.26	E= 1,177,379.88

CURVE NBRMPO5

P.I. STA= 8216+21.17
N= 1,859,762.21
E= 1,177,392.97
Δ= 3° 40' 25"
D= 3° 49' 11"
R= 1,500.00'
T= 48.10'
L= 96.17'
e= 0.77'
TR= N/A
S.E. RUN= N/A
P.C. STA= 8215+73.07
N= 1,859,714.14
E= 1,177,391.11
P.T. STA= 8216+69.24
N= 1,859,810.29
E= 1,177,391.74

NOTES:
1. AVERAGE GRID TO GROUND CONVERSION FACTOR = 1.000010988654360

REVISIONS	
NAME	DATE

ILLINOIS DEPARTMENT OF TRANSPORTATION
F.A.I. 90/94 (DAN RYAN EXPRESSWAY)
71ST ST TO 63RD ST (SOUTHBOUND KNEE WALLS)

ALIGNMENT PLAN

SCALE: 1"=100'
DATE: JANUARY 14, 2009
DRAWN BY: NJH/AMM
CHECKED BY: JAL/MS



V:\scgriff\p207\p40468\p40468\plan\26-knee-wall-Fence\DWG\contract 27\ba12\60012a.dwg 2/23/2009 1/13/2009