

**STATE OF ILLINOIS  
DEPARTMENT OF TRANSPORTATION  
DIVISION OF HIGHWAYS  
PLANS FOR PROPOSED  
FEDERAL AID PROJECT  
TRANSPORTATION CORRIDOR  
BEAUTIFICATION PROJECT  
ROOSEVELT ROAD (FAP 347)(ILLINOIS ROUTE 38)  
MANNHEIM ROAD TO WESTCHESTER BOULEVARD  
SECTION NO. 06-00071-00-SW  
PROJECT ARA -00D1(701)  
VILLAGE OF WESTCHESTER  
COOK COUNTY  
JOB NO. C-91-020-07**

ROUTE NO.	SECTION	COUNTY	TOTAL SHEETS	SHEET NO.
FAP 347	06-00071-00-SW	COOK	17	1
ILLINOIS PROJECT TE-00D1(701)				
VILLAGE SECTION ---				
CONTRACT NO. 63183				



LOCATION OF SECTION INDICATED THIS:

**TRAFFIC DATA**

2007 ADT = 28,000  
POSTED SPEED LIMIT = 30 MPH  
DESIGN SPEED LIMIT = 35 MPH

PROJECT LOCATED IN  
THE VILLAGE OF WESTCHESTER

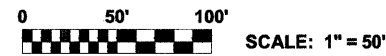
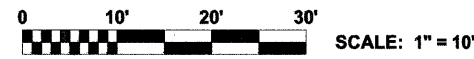

FULL SIZE PLANS HAVE BEEN PREPARED USING STANDARD ENGINEERING SCALES. REDUCED SIZED PLANS WILL NOT CONFORM TO STANDARD SCALES. IN MAKING MEASUREMENTS ON REDUCED PLANS, THE ABOVE SCALES MAY BE USED.

**LOCATION MAP**

TOWNSHIP 39 NORTH, RANGE 12 EAST, PROVISO TOWNSHIP

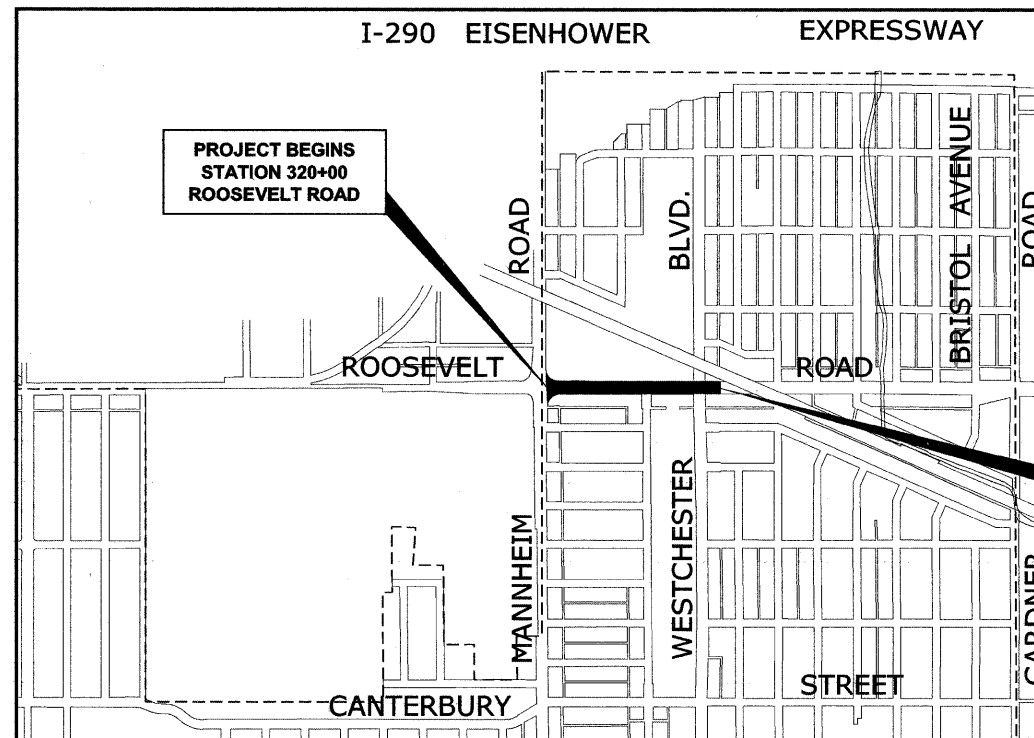

PROJECT BEGINS  
STATION 320+00  
ROOSEVELT ROAD

PROJECT ENDS  
STATION 333+40  
ROOSEVELT ROAD

- AREA OF IMPROVEMENT

GROSS AND NET LENGTH OF IMPROVEMENT = 1,340 FT. = 0.254 MI.

Drawing file: W:\Projects\83509263 - Roosevelt Rd ITP\Cover.dwg Apr 16, 2009 9:24am  
FIELD ENGINEER: MARILYN SOLOMON PHONE: (847)705-4407  
CONSULTANT: EDWIN HANCOCK ENGINEERING COMPANY  
9933 ROOSEVELT ROAD PHONE: (708)865-0300  
WESTCHESTER, ILLINOIS 60154



**Know what's below.  
Call before you dig.**

CONTRACT NO. 63183

APPROVED 84-16 20 09  
*Paul J. Hill*  
VILLAGE OF WESTCHESTER, PRESIDENT

PASSED APRIL 16 2009  
*CHULT CHRISTOPHER HOLT*  
DISTRICT ENGINEER OF LOCAL ROADS & STREETS

RELEASED FOR BID  
BASED ON LIMITED  
REVIEW APRIL 16, 20 09  
*Diane M. O'Keefe*  
DEPUTY DIRECTOR OF HIGHWAYS, 4F  
REGION 1 ENGINEER

STATE OF ILLINOIS  
DEPARTMENT OF TRANSPORTATION

(PRINTED BY AUTHORITY OF THE STATE OF ILLINOIS)

*Derek S. Treichel*

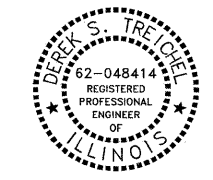

DATE SIGNED: 04-16-09  
LICENSE EXPIRES: 11-30-09





ROUTE NO.	SECTION	COUNTY	TOTAL SHEETS	SHEET NO.
FAP 347	06-00071-00-SW	COOK	17	4
ILLINOIS PROJECT		TE-00D1(701)		
VILLAGE SECTION				
CONTRACT NO. 63183				

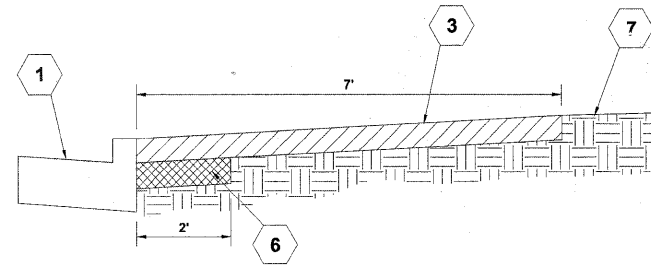

**EXISTING TYPICAL CROSS SECTION**

NORTH SIDE OF ROOSEVELT ROAD  
(STA. 320+00 TO STA. 325+87)  
SOUTH SIDE OF ROOSEVELT ROAD  
(STA. 320+00 TO STA. 323+05)

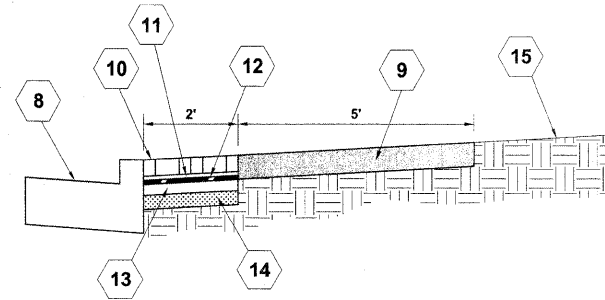

**PROPOSED TYPICAL CROSS SECTION**

NORTH SIDE OF ROOSEVELT ROAD  
(STA. 320+00 TO STA. 325+87)  
SOUTH SIDE OF ROOSEVELT ROAD  
(STA. 320+00 TO STA. 323+05)

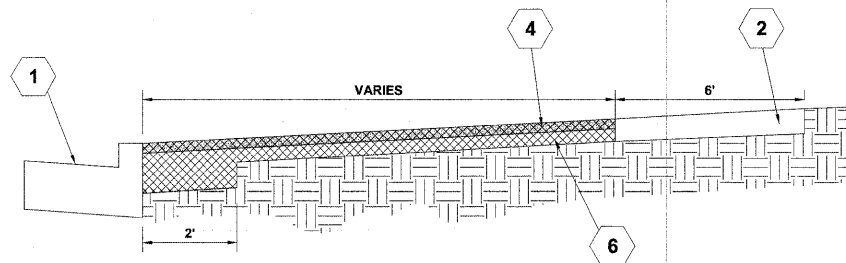

**EXISTING TYPICAL CROSS SECTION**

SOUTH SIDE OF ROOSEVELT ROAD  
(STA. 323+62 TO STA. 324+19)  
(STA. 324+45 TO STA. 325+71)  
(STA. 325+87 TO STA. 326+07)  
(STA. 326+33 TO STA. 326+50)  
(STA. 326+70 TO STA. 326+84)

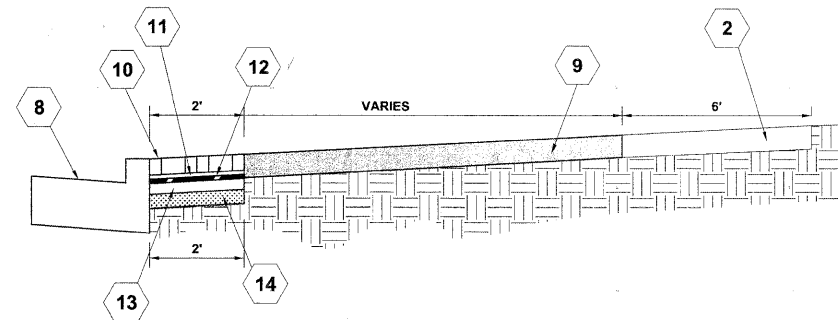

**PROPOSED TYPICAL CROSS SECTION**

SOUTH SIDE OF ROOSEVELT ROAD  
(STA. 323+62 TO STA. 324+19)  
(STA. 324+45 TO STA. 325+71)  
(STA. 325+87 TO STA. 326+07)  
(STA. 326+33 TO STA. 326+50)  
(STA. 326+70 TO STA. 326+84)

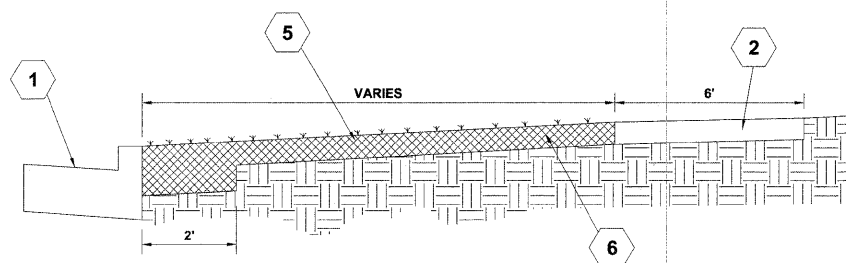

**EXISTING TYPICAL CROSS SECTION**

SOUTH SIDE OF ROOSEVELT ROAD  
(STA. 326+84 TO STA. 326+96)  
(STA. 327+16 TO STA. 327+44)  
(STA. 327+89 TO STA. 328+07)

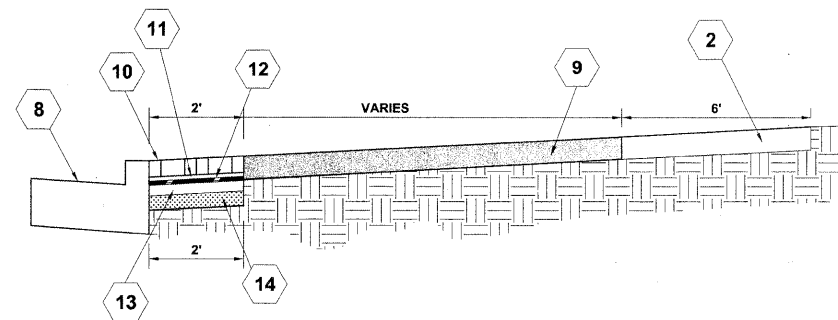

**PROPOSED TYPICAL CROSS SECTION**

SOUTH SIDE OF ROOSEVELT ROAD  
(STA. 326+84 TO STA. 326+96)  
(STA. 327+16 TO STA. 327+44)  
(STA. 327+89 TO STA. 328+07)

**TYPICAL CROSS SECTION LEGEND**

**EXISTING**

- 1 COMBINATION CONCRETE CURB & GUTTER, TYPE B-6.24 (ONLY CERTAIN DETERIORATED SECTIONS TO BE REMOVED) (REMOVAL TO BE PAID AS COMBINATION CONCRETE CURB & GUTTER REMOVAL)
- 2 CONCRETE SIDEWALK
- 3 SIDEWALK REMOVAL
- 4 ASPHALT SURFACE, ±3" (REMOVAL TO BE INCLUDED IN PAY ITEM FOR EARTH EXCAVATION)
- 5 GRASS PARKWAY (REMOVAL TO BE INCLUDED IN PAY ITEM FOR EARTH EXCAVATION)
- 6 EARTH EXCAVATION
- 7 EXISTING PARKWAY AS NOTED ON PLANS

**PROPOSED**

- 8 COMBINATION CONCRETE CURB & GUTTER, TYPE B-6.24 (ONLY CERTAIN DETERIORATED SECTIONS TO BE REPLACED)
- 9 PORTLAND CEMENT CONCRETE SIDEWALK, 5"
- 10 BRICK PAVER, 2-3/8" (INCLUDED IN PAY ITEM FOR DECORATIVE BRICK SIDEWALK)
- 11 SAND CUSHION, 1" (INCLUDED IN PAY ITEM FOR DECORATIVE BRICK SIDEWALK)
- 12 FILTER FABRIC (INCLUDED IN PAY ITEM FOR DECORATIVE BRICK SIDEWALK)
- 13 PORTLAND CEMENT CONCRETE BASE COURSE, 3"
- 14 COMPACTED CA-6 STONE BEDDING, 4" (INCLUDED IN PAY ITEM FOR PORTLAND CEMENT CONCRETE BASE COURSE, 3")
- 15 PARKWAY RESTORATION AS NOTED ON PLANS

**HOT-MIX ASPHALT MIXTURE REQUIREMENTS**

ITEM DESCRIPTION	AC TYPE	VOIDS
INCIDENTAL HOT-MIX ASPHALT SURFACING		
HOT-MIX ASPHALT SURFACE COURSE, MIX D, N50, (1L9.5mm), 3"	PG 64-22	4% @ 50 GYR.

THE UNIT USED TO CALCULATE ALL HMA SURFACE MIXTURE QUANTITIES IS 112 LBS/SQ YD/IN.

REVISION:

**HANCOCK ENGINEERING** ♦ Civil Engineers ♦ Municipal Consultants ♦ Established 1911  
9303 Riverwood Road, Westchester, Illinois 60591-3788, Phone: 708.945-4308, Fax: 708.945-1112

VILLAGE OF WESTCHESTER  
**ROOSEVELT ROAD (FAP 347)**  
**BEAUTIFICATION PROJECT**  
**TYPICAL CROSS SECTIONS**

DRAWN BY: MK  
CHECKED BY: JCG  
DATE: 04/15/09

SCALE: NONE







ROUTE NO.	SECTION	COUNTY	TOTAL SHEETS	SHEET NO.
FAP 347	06-000071-00-SW	COOK	17	8
ILLINOIS PROJECT TE-00D1(7b1)				
VILLAGE SECTION				
CONTRACT NO. 63183				

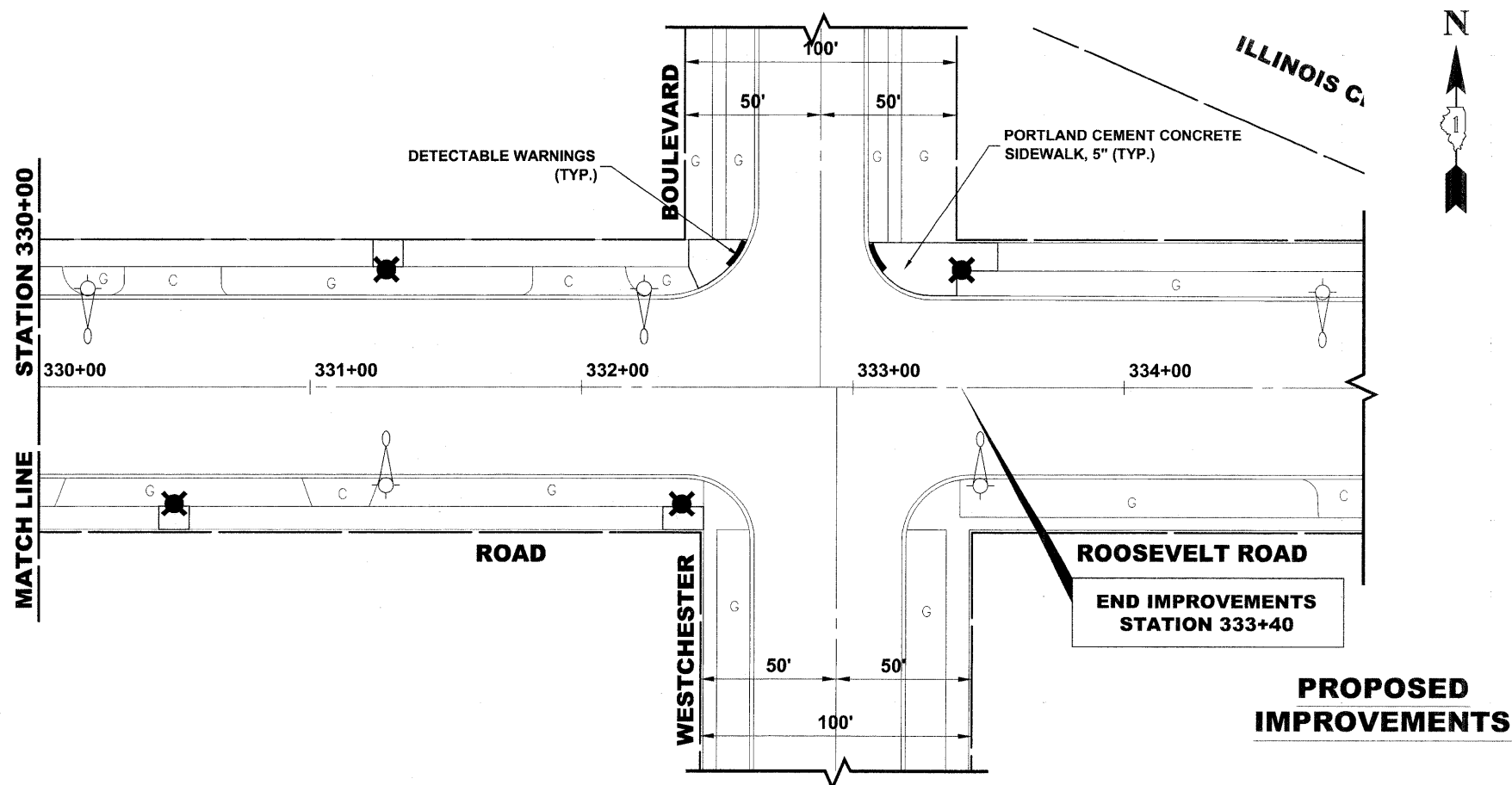
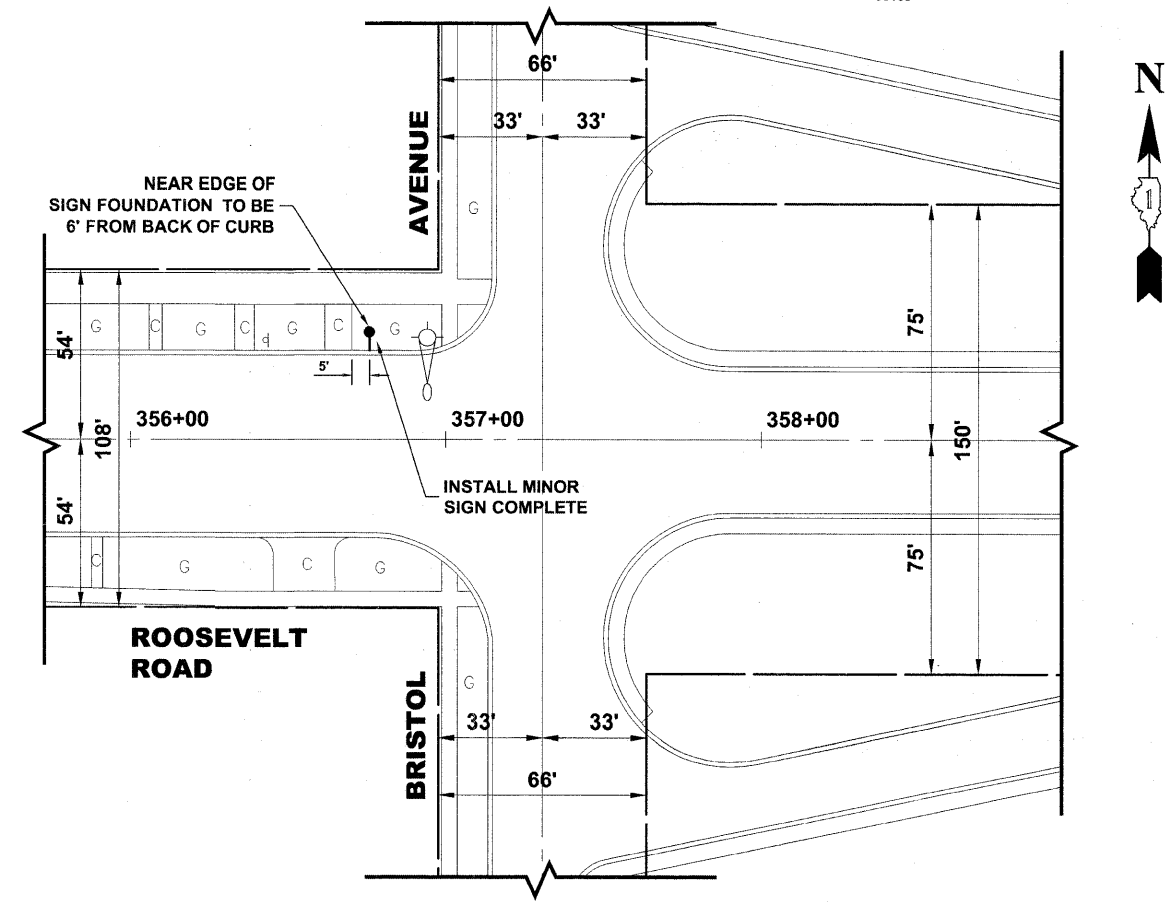
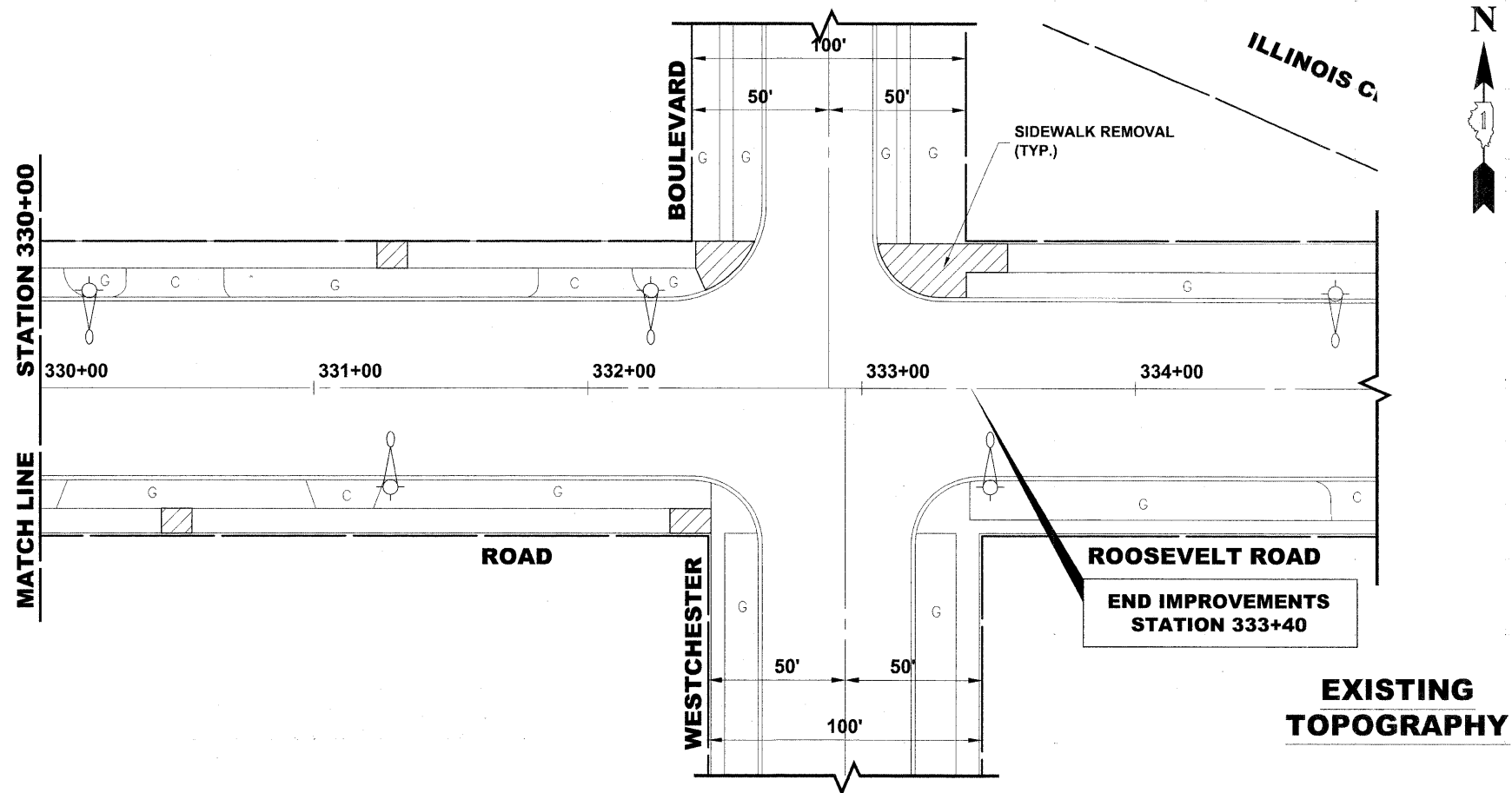

**NOTES:**

1. ONLY CERTAIN DETERIORATED SECTIONS OF CONCRETE CURB AND GUTTER WILL BE REMOVED AND REPLACED. LOCATIONS TO BE DETERMINED BY THE ENGINEER DURING CONSTRUCTION.
2. THE CONTRACTOR SHALL NEATLY REMOVE THE DESIGNATED SECTIONS OF CONCRETE CURB AND GUTTER SO AS TO NOT DAMAGE THE ADJACENT STREET PAVEMENT. ANY DAMAGE TO THE STREET PAVEMENT SHALL BE REPAIRED TO THE SATISFACTION OF THE ENGINEER AT THE CONTRACTORS EXPENSE.
3. ASPHALT PARKWAYS DISTURBED BY THE IMPROVEMENTS SHALL BE RESTORED WITH INCIDENTAL HOT-MIX ASPHALT SURFACING.
4. GRASS PARKWAYS DISTURBED BY THE IMPROVEMENTS SHALL BE RESTORED WITH TOPSOIL FURNISH AND PLACE, 4" AND SODDING. ANY EXCAVATION NECESSARY TO PLACE 4" OF TOPSOIL SHALL BE PAID FOR UNDER THE PAY ITEM FOR EARTH EXCAVATION.
5. A NOMINAL QUANTITY OF "FRAMES AND LIDS TO BE ADJUSTED" AND "FRAMES AND LIDS, TYPE 1, CLOSED LIDS" HAVE BEEN INCLUDED FOR USE BY THE ENGINEER. LOCATIONS TO BE DETERMINED BY THE ENGINEER DURING CONSTRUCTION.
6. P.C.C. SIDEWALK, 5" THAT IS INSTALLED WITHIN THE PARKWAY SHALL BE FINISHED WITH A "CALIFORNIA" FINISH. P.C.C. SIDEWALK, 5" THAT IS INSTALLED AS PEDESTRIAN SIDEWALK SHALL BE FINISHED WITH A STANDARD BROOM FINISH.

REVISION:	<p>◆ Civil Engineers ◆ Municipal Consultants ◆ Established 1911</p> <p>9533 Roosevelt Road Westchester, Illinois 60154-2708 Phone: 708/665-0300 Fax: 708/665-1212</p>
<p>VILLAGE OF WESTCHESTER ROOSEVELT ROAD (FAP 347) BEAUTIFICATION PROJECT EXISTING TOPOGRAPHY AND PROPOSED IMPROVEMENTS</p>	
<p>DRAWN BY: MK CHECKED BY: JCG DATE: 04/15/09</p>	
<p>SCALE: 1"=30'</p>	

Drawing File: W:\Projects\83806263 - Roosevelt Rd (TEP)\Roosevelt\_Rd\_TEP.dwg Apr 15, 2009 - 11:19am



ROUTE NO.	SECTION	COUNTY	TOTAL SHEETS	SHEET NO.
FAP 347	06-00071-00-SW	COOK	17	9
ILLINOIS PROJECT		TE-00D1(701)		
VILLAGE SECTION				
CONTRACT NO. 63183				

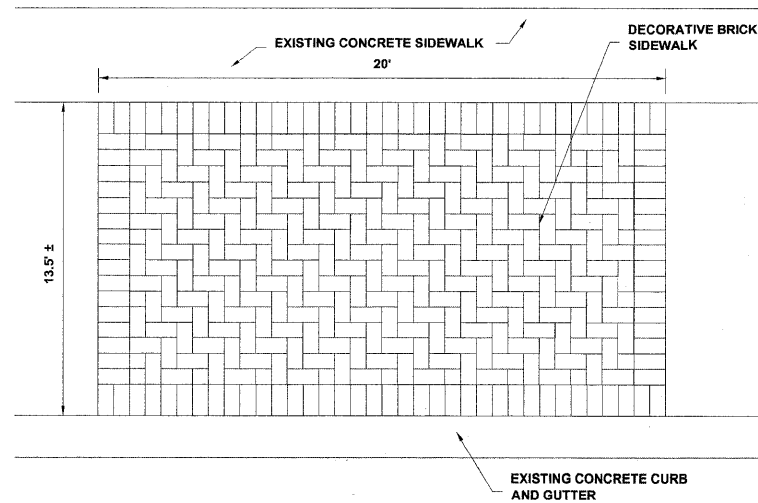

**BRICK PATTERN DETAIL**  
SOUTH SIDE OF ROOSEVELT ROAD  
(STA. 327+44 TO 327+64)

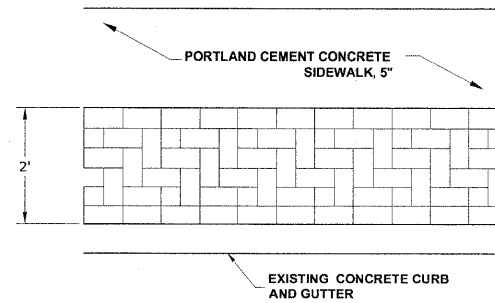

**DECORATIVE BRICK SIDEWALK PATTERN DETAIL**

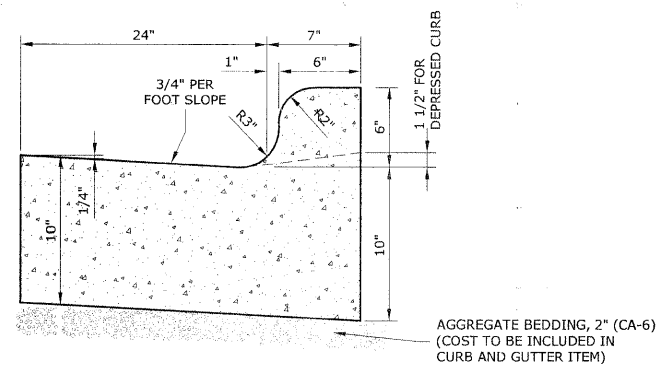

**COMBINATION CONCRETE CURB & GUTTER TYPE B-6.24 (SPECIAL)**

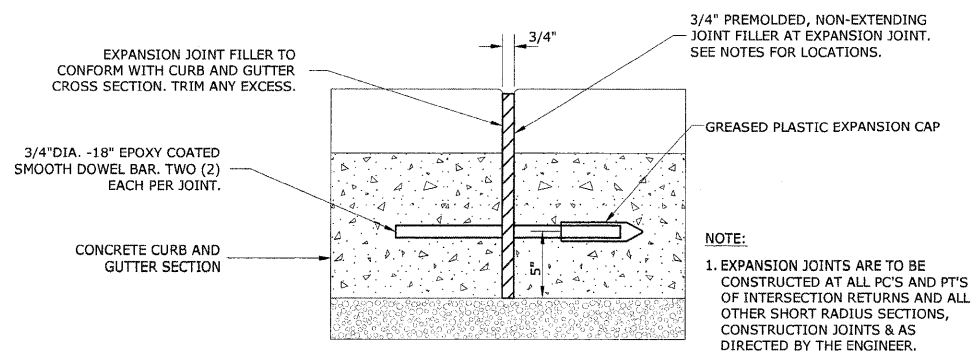

**TYPICAL CURB AND GUTTER EXPANSION JOINT**

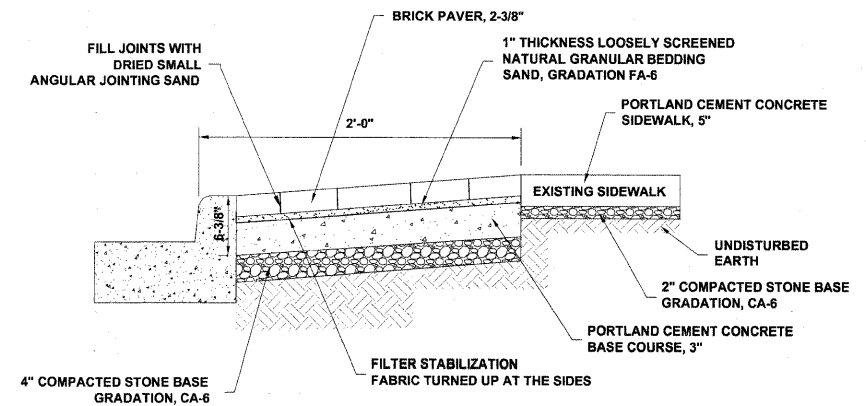

**DECORATIVE BRICK SIDEWALK DETAIL**

**GENERAL NOTES**

**DEPRESSED CURBS** - THE TOP OF CURBS SHALL BE DEPRESSED WHERE THE CURB AND GUTTER IS CONSTRUCTED AT HANDICAP ACCESSIBLE SIDEWALK RAMPS AT ALLEY RETURNS AND STREET INTERSECTIONS, AND FOR PRIVATE DRIVES AND AS DIRECTED BY THE ENGINEER

**DRAINAGE OPENINGS** - AT ALL LOCATIONS WHERE CASTINGS ARE TO BE INCORPORATED IN THE CURB AND GUTTER, A 3/4" EXPANSION JOINT SHALL BE INSTALLED IN THE CURB AND GUTTER A DISTANCE OF 5 FT. FROM EACH SIDE OF THE CASTING. 2-NO. 4 RE-BARS, 9' IN LENGTH, SHALL BE INCORPORATED IN THE CONTINUOUS PORTION OF CONCRETE CURB BEHIND THE CASTING.

**SLIPFORM CONSTRUCTION** - VERTICAL FACES MAY BE BATTERED AT THE RATE OF 3/4" PER FOOT OF HEIGHT TO AID IN SLIPFORM OPERATIONS.

**DEPRESSED CURB HEIGHT** - THE HEIGHT OF THE DEPRESSED CURB SHALL BE 1-1/2" AT DRIVEWAYS. SEE IDOT STANDARD 424001-04 FOR HEIGHT AT SIDEWALK RAMP.

**BITUMINOUS EXPANSION JOINTS** - THREE QUARTER INCH (3/4") BITUMINOUS PREMOLDED INORGANIC FIBER EXPANSION JOINTS SHALL BE INSTALLED WHERE NEW SIDEWALK OR CURB AND GUTTER OR DRIVEWAY PAVEMENT ABUTS AN EXISTING CONCRETE WALK, DRIVE, OR CURB WHICH IS TO REMAIN IN PLACE, AND AT NOT LESS THAN NINETY FOOT (90') INTERVALS AT LOCATIONS WHERE CURB REPLACEMENT IS IN EXCESS OF NINETY FEET (90'); AT RADIUS POINTS, AT BOTH SIDES OF FRAMES AND GRATES WHICH FALL IN THE CURB; AND AS DIRECTED BY THE ENGINEER.

ALL EXPANSION JOINTS LOCATED IN THE CURB AND GUTTER SHALL HAVE TWO (2) THREE QUARTER INCH (3/4") DIAMETER, SMOOTH, ROUND, EPOXY COATED DOWEL BARS, EIGHTEEN INCHES (18") IN LENGTH, WITH GREASED PLASTIC END CAPS INSERTED TO ALLOW THE CURB AND GUTTER TO EXPAND AND CONTRACT LATERALLY. CONTRACTION JOINTS SHALL BE TOOLED INTO THE CURB AND GUTTER AT INTERVALS NOT TO EXCEED FIFTEEN FEET (15'). THESE CONTRACTION JOINTS SHALL BE SAW CUT TO A DEPTH OF TWO INCHES (2") WITHIN TWENTY-FOUR (24) HOURS OF CONCRETE PLACEMENT. THE COST OF THE ABOVE WORK SHALL BE INCLUDED IN THE RESPECTIVE ITEMS FOR CONCRETE INSTALLATION.

**CURB AND GUTTER REMOVAL**

THE COSTS FOR REMOVAL OF ANY ASPHALT OVERLAY THAT EXTENDS INTO THE GUTTER PORTION OF THE CURB AND GUTTER WILL BE INCLUDED IN THE PRICE FOR COMBINATION CURB AND GUTTER REMOVAL.

REVISION:

**HANCOCK ENGINEERING** ♦ Civil Engineers ♦ Municipal Consultants ♦ Established 1911  
933 Roosevelt Road, Westchester, Illinois 60150-2798, Phone: 708/864-0300, Fax: 708/864-1212

VILLAGE OF WESTCHESTER  
ROOSEVELT ROAD (FAP 347)  
BEAUTIFICATION PROJECT  
ROADWAY DETAILS

DRAWN BY: MK  
CHECKED BY: JCG  
DATE: 04/15/09

SCALE: NONE

ROUTE NO.	SECTION	COUNTY	TOTAL SHEETS	SHEET NO.
FAP 347	06-00071-00-SW	COOK	17	10
ILLINOIS PROJECT TE-00D1(701)				
VILLAGE SECTION				
CONTRACT NO. 63183				

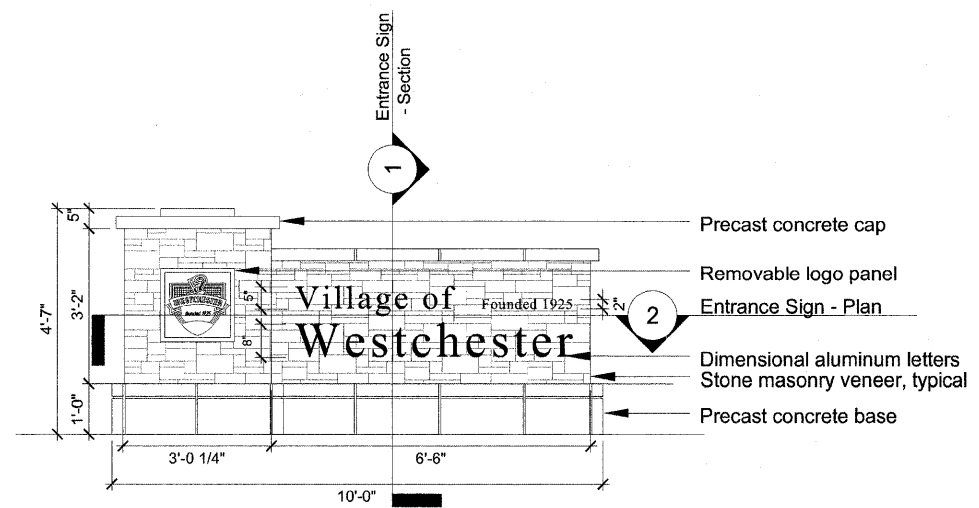

**ENTRANCE SIGN - FRONT ELEVATION**

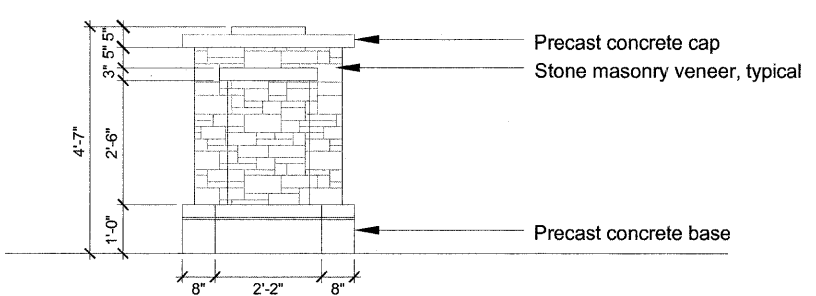

**ENTRANCE SIGN - SIDE ELEVATION**

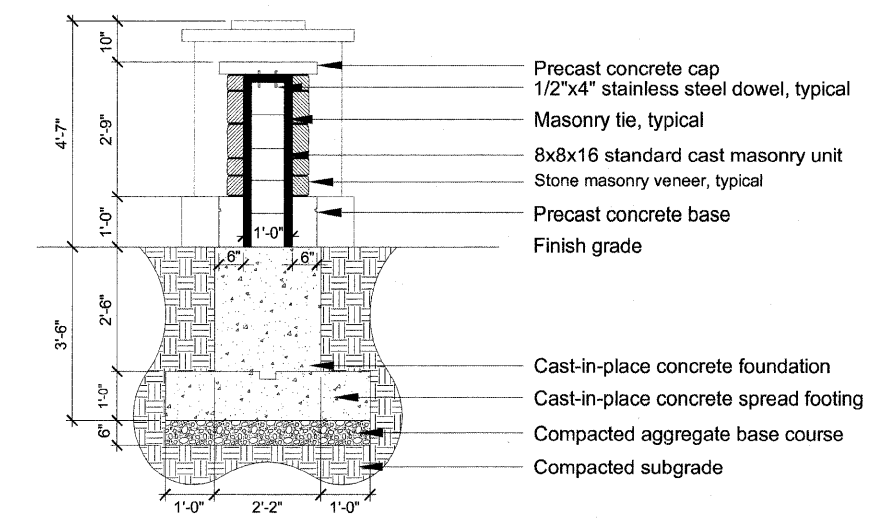

**1 ENTRANCE SIGN - SECTION**

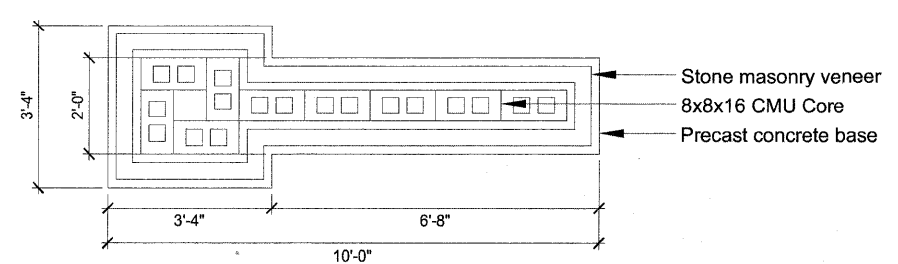

**2 ENTRANCE SIGN - PLAN**

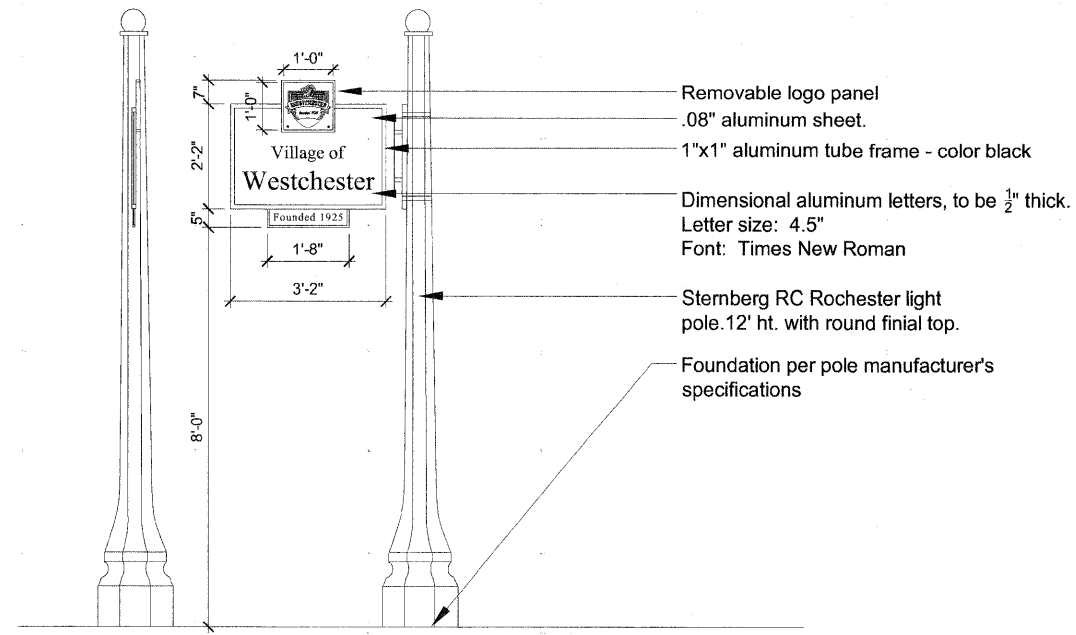

**MINOR SIGN COMPLETE**

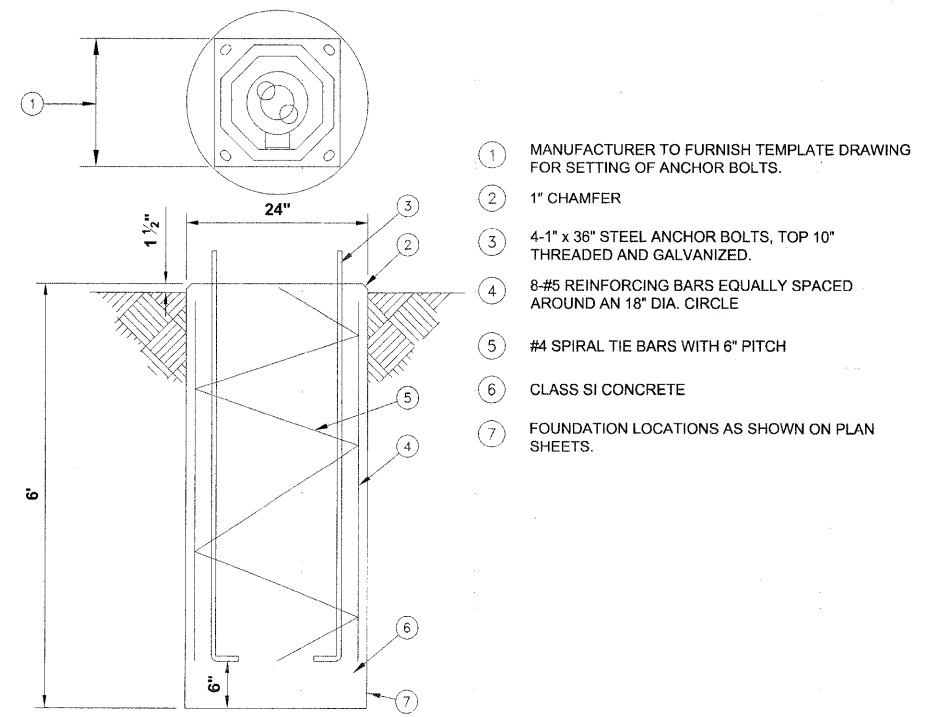

**SIGN POLE FOUNDATION**

**Signage General Notes**

1. Sign fabricator to submit shop drawings including all materials, connection methods, sizing, text, layout and color designations per details as shown on plans. If modifications are proposed by the fabricator, provide comprehensive explanation to the owner's representative for review. The owner's representative has sole discretion to approve or reject the proposed modifications to achieve a superior product.
2. Sign fabricator to submit manufacturer's product information for poles and vinyl film, color chip samples of all specified colors, and mock-ups of all artwork, logos, graphics and text for approval by the owner's representative prior to fabrication.
3. All aluminum materials to be powder coated per the specifications, colors as indicated on details.
4. Refer to specifications for additional information, standards and notes.
5. Drawings to be provided in an electronic format upon request for further dimensional detail.
6. Structural Engineer's stamp required on sign frames.

REVISION:		<p><b>HANCOCK ENGINEERING</b></p> <p>◆ Civil Engineers ◆ Municipal Consultants ◆ Established 1911</p> <p>9913 Roosevelt Road Westchester, Illinois 61081-2788 Phone: 708/665-6288 Fax: 708/665-1212</p>
<p>VILLAGE OF WESTCHESTER ROOSEVELT ROAD (FAP 347) BEAUTIFICATION PROJECT VILLAGE ENTRY SIGN DETAILS</p>		
<p>DRAWN BY: MK CHECKED BY: JCG DATE: 04/15/09</p>		<p>SCALE: NONE</p>

Drawing file: W:\Projects\83606263 - Roosevelt Rd ITP\Entrance Sign-Detail.dwg Apr 15, 2009 - 11:24am















ROUTE NO.	SECTION	COUNTY	TOTAL SHEETS	SHEET NO.
FAP 347	06-00071-00-SW	COOK	17	17
ILLINOIS PROJECT		TE-00D1(7D1)		
VILLAGE SECTION				
CONTRACT NO. 63183				

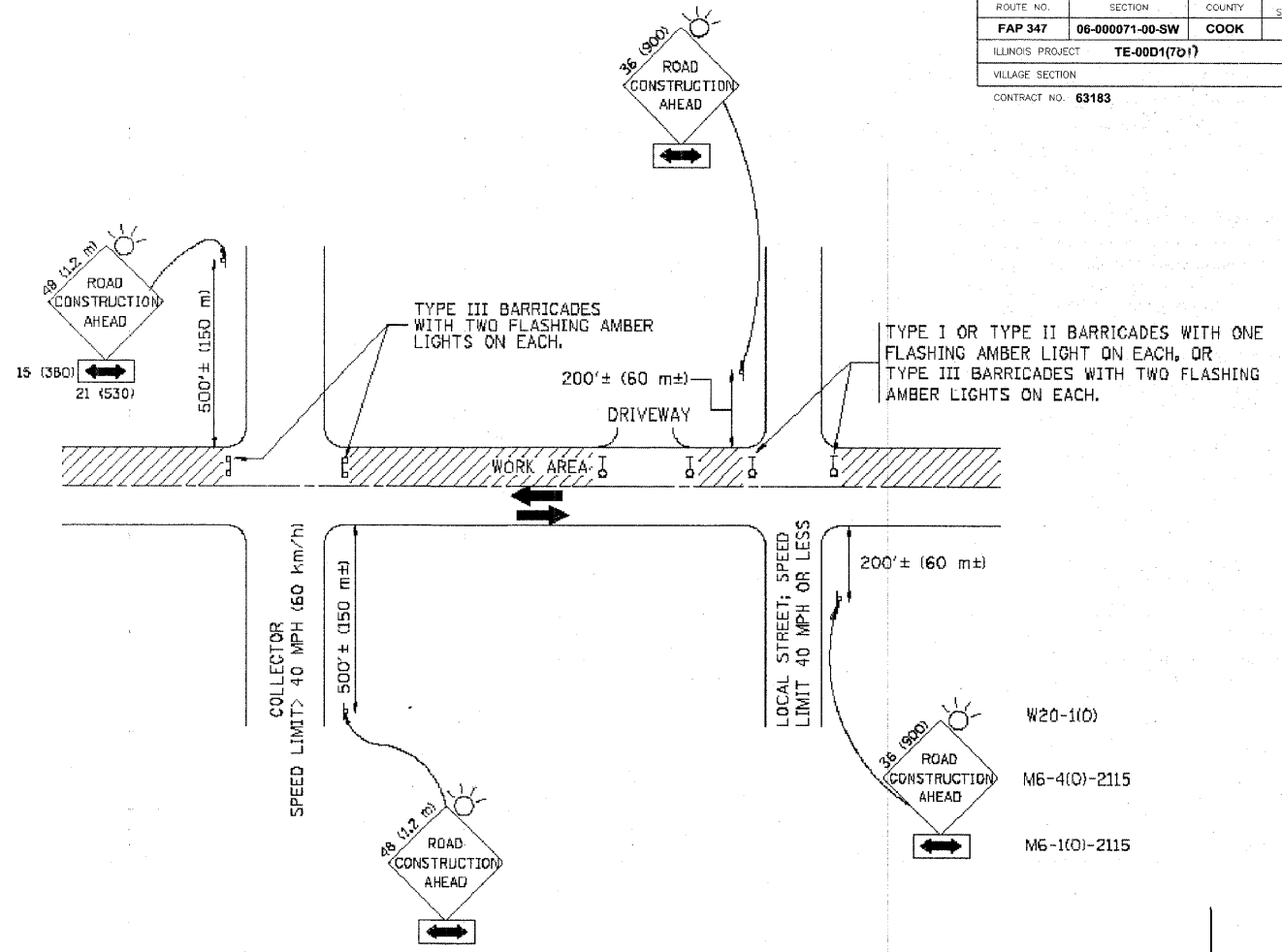

TRAFFIC CONTROL AND PROTECTION FOR SIDE ROADS, INTERSECTIONS, AND DRIVEWAYS

NOTES:

- A. FOR NO LANE RESTRICTION ON THE SIDE ROAD OR DRIVEWAYS
- SIDE ROAD WITH A SPEED LIMIT OF 40 MPH (60 km/h) OR LESS AS SHOWN ON THE DRAWING AND AS DIRECTED BY THE ENGINEER:
    - ONE **ROAD CONSTRUCTION AHEAD** SIGN 36 x 36 (900x900) WITH A FLASHER AND FLAG MOUNTED ON IT APPROXIMATELY 200' (60 m) IN ADVANCE OF THE MAIN ROUTE.
    - THE CLOSED PORTION OF THE MAIN ROUTE SHALL BE PROTECTED BY BLOCKING WITH TYPE I, TYPE II OR TYPE III BARRICADES, 1/3 OF THE CROSS SECTION OF THE CLOSED PORTION.
  - SIDE ROAD WITH A SPEED LIMIT GREATER THAN 40 MPH (60 km/h) AS SHOWN ON THE DRAWING AND AS DIRECTED BY THE ENGINEER:
    - ONE **ROAD CONSTRUCTION AHEAD** SIGN 48 x 48 (1.2 m x 1.2 m) WITH A FLASHER MOUNTED ON IT APPROXIMATELY 500' (150 m) IN ADVANCE OF THE MAIN ROUTE.
    - THE CLOSED PORTION OF THE MAIN ROUTE SHALL BE PROTECTED BY BLOCKING WITH TYPE III BARRICADES, 1/2 OF THE CROSS SECTION OF THE CLOSED PORTION.
  - WHEN THE SIDE ROAD LIES BETWEEN THE BEGINNING OF THE MAINLINE SIGNING AND THE WORK ZONE, A SINGLE HEADED ARROW (M6-1) SHALL BE USED IN LIEU OF THE DOUBLE HEADED ARROW (M6-4).
- B. FOR A LANE CLOSURE ON A SIDE ROAD OR DRIVEWAY:  
USE APPLICABLE PORTIONS OF THE TYPICAL APPLICATION OF TRAFFIC CONTROL DEVICES (STD. 701501, STD. 701605 OR THE APPROPRIATE STANDARD). THE SPACING OF SIGNS AND BARRICADES SHALL BE ADJUSTED FOR FIELD CONDITIONS AS DIRECTED BY THE ENGINEER. THE DIRECTIONAL ARROW SHALL BE COVERED OR REMOVED WHEN NO LONGER CONSISTENT WITH THE SIDE ROAD LANE CLOSURE.
- C. ADVANCE WARNING SIGNS ARE TO BE OMITTED ON DRIVEWAY UNLESS OTHERWISE NOTED.
- D. THE TRAFFIC CONTROL AND PROTECTION FOR SIDE ROADS, INTERSECTIONS, AND DRIVEWAYS SHALL BE INCIDENTAL TO THE COST OF SPECIFIED TRAFFIC CONTROL STANDARDS OR ITEMS.

All dimensions are in millimeters (inches) unless otherwise shown.

Drawing file: W:\Projects\83806263 - Roosevelt Rd ITEMP\MARKING.dwg Apr 10, 2009 - 1:43pm

FILE NAME = W:\data\rd\22x34\td18.dgn	USER NAME = geglanabt	DESIGNED - LHA	REVISED - J. OBERLE 10-18-95
		DRAWN -	REVISED - A. HOUSEH 03-06-96
		CHECKED -	REVISED - A. HOUSEH 10-15-96
		DATE - 06-89	REVISED - T. RAMMACHER 01-06-00

STATE OF ILLINOIS  
DEPARTMENT OF TRANSPORTATION

TRAFFIC CONTROL AND PROTECTION FOR  
SIDE ROADS, INTERSECTIONS, AND DRIVEWAYS

SCALE: NONE SHEET NO. 17 OF 17 SHEETS STA. TO STA.

F.A. RTE.	SECTION	COUNTY	TOTAL SHEETS	SHEET NO.
	06-00071-00-SW	COOK	17	17
TC-10		CONTRACT NO.		
FED. ROAD DIST. NO. 1 ILLINOIS FED. AID PROJECT				
E.H.E. PROJECT NO. : 838-06-26320				