

SHERIDAN ROAD SOUTH BOULEVARD TO MAIN STREET

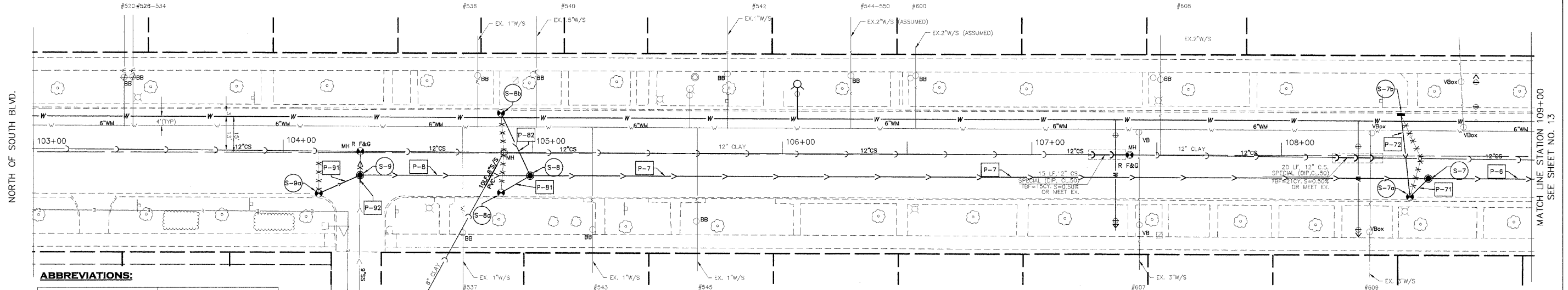

ABBREVIATIONS:

IN - INLET	HCI - HIGH CAPACITY INLET
CB - CATCH BASIN	EX. CB - EXISTING CATCH BASIN
MH - MANHOLE	R - TO BE RECONSTRUCTED
TA - TYPE A	T1F - TYPE 1 FRAME
CL - CLOSED LID	RS - RELIEF SEWER, AKIN TO STORM SEWER
CS - COMBINED SEWER	T4B - CURB BACK HEIGHT ADJUSTS FROM 3.50' TO 6.00'
MIG - TYPE M8 GRATE (VANE)	M1G - TYPE M1 GRATE (SINUSOIDAL)
7035 - EAST JORDAN IRON WORKS DESIGNATION	7045 - EAST JORDAN IRON WORKS DESIGNATION

STRUCTURE SCHEDULE

STRUCTURE NO.	STATION	OFFSET	STRUCTURE TYPE	DIA. (FT)	RM ELEV.	INVERT											
						N	S	E	W	NE	NW	SE	SW				
S-7	106+00.00	9.0RT	MH TA T1F CL	4.0'	11.30	2.00	2.00										
S-7a	106+51.40	16.5RT	EX. CB R M1G 7045	4.0'	11.02				7.44		7.00						
S-7b	106+47.00	16.3LT	HCI M1G T4B 7035	2.0x3.0'	11.00			8.10									
S-8	106+00.00	9.0RT	MH TA T1F CL	4.0'	10.92	4.00	4.25										
S-8a	104+97.30	15.55RT	EX. CB R M1G T4B 7035	4.0'	10.59												
S-8b	104+97.30	16.20LT	EX. CB R M1G T4B 7035	4.0'	10.58												
S-9	104+31.90	9.00RT	MH TA T1F CL	4.0'	11.10	4.35			6.25								
S-9a	104+14.25	15.35RT	EX. CB R M1G T4B 7035	4.0'	10.88												

PIPE SCHEDULE

PIPE NO.	FROM STRUCTURE	TO STRUCTURE	MATERIAL	TYPE	LENGTH (FT)	DIA. (IN)	UPPER INVERT	LOWER INVERT	SLOPE	TBF
P-7	S-7	S-8	DIP. CL. 50	SPECIAL	30	18	4.00	2.00	0.53%	496
P-7a	S-7	S-7a	DIP. CL. 50	SPECIAL	19	12	7.00	6.93	0.50%	5
P-7b	S-7	S-7b	DIP. CL. 50	SPECIAL	33	10	8.30	7.44	0.50%	3
P-8	S-8	S-9	DIP. CL. 50	SPECIAL	69	18	5.74	4.23	0.15%	63
P-8a	S-8	S-8a	DIP. CL. 50	SPECIAL	13	12	6.50	6.43	0.50%	5
P-8b	S-8	S-8b	DIP. CL. 50	SPECIAL	28	12	7.90	7.76	0.50%	7
P-9	S-9	S-9a	DIP. CL. 50	SPECIAL	18	12	6.40	6.31	0.50%	12
P-9a	S-9	S-9a	EX. PIPE	DIP. CL. 50	3	10	6.20	6.25	0.5% OR EX.	3

NOTES:

- ALL ABANDONED SEWERS AND/OR EXISTING REMOVED SEWERS FROM THE EXISTING STRUCTURES SHALL BE PLUGGED AT BOTH ENDS WITH A MINIMUM TWO FOOT (2') LONG NON-SHRINK CONCRETE OR MORTAR PLUGS (SEE DETAIL SHEET 22)
- ALL EXISTING SEWERS CONNECTING TO PROPOSED STRUCTURES AND PROPOSED STRUCTURES CONNECTING INTO EXISTING STRUCTURES MUST BE A.S.T.M. C-923. (SEE DETAIL SHEET 22)

