

EXISTING TYPICAL CROSS SECTION  
OVERLOOK DRIVE (FAU ROUTE 1311)  
STA 5+91 TO STA 29+20

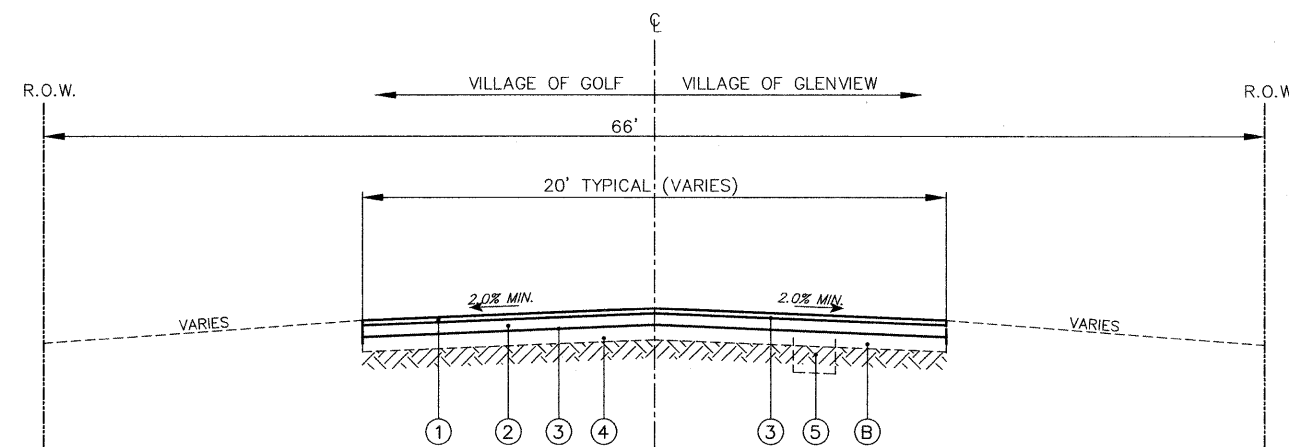

PROPOSED TYPICAL CROSS SECTION  
OVERLOOK DRIVE (FAU ROUTE 1311)  
STA 5+91 TO STA 29+20

NOTES:

- PAVEMENT REMOVAL SHALL INCLUDE REMOVAL OF 2"-4" EXISTING HMA SURFACE AND 2"-4" STONE BASE COURSE TO A DEPTH OF 6"

- INSTALLATION OF HMA BINDER COURSE SHALL IMMEDIATELY FOLLOW PAVEMENT REMOVAL TO LEAVE NO MORE THAN A 2" DIFFERENTIAL IN PAVEMENT SURFACE ELEVATIONS AT THE END OF EACH DAY

- CURB AND GUTTER REMOVAL AND REPLACEMENT IN LOCATIONS AS MARKED BY THE ENGINEER.

- RESIDENTIAL DRIVEWAY HMA PAVEMENT TO BE REMOVED AND REPLACED AS MARKED IN THE FIELD BY THE ENGINEER (2.00" THICKNESS).

EXISTING LEGEND:

- (A) EXISTING HMA PAVEMENT, 2"-4" & VARIES
- (B) EXISTING AGGREGATE BASE, TYPE B, 7"-9" & VARIES
- (C) EXISTING SUBBASE
- (D) PAVEMENT REMOVAL, 6" (2"-4" HMA SURFACE & 2"-4" STONE BASE)

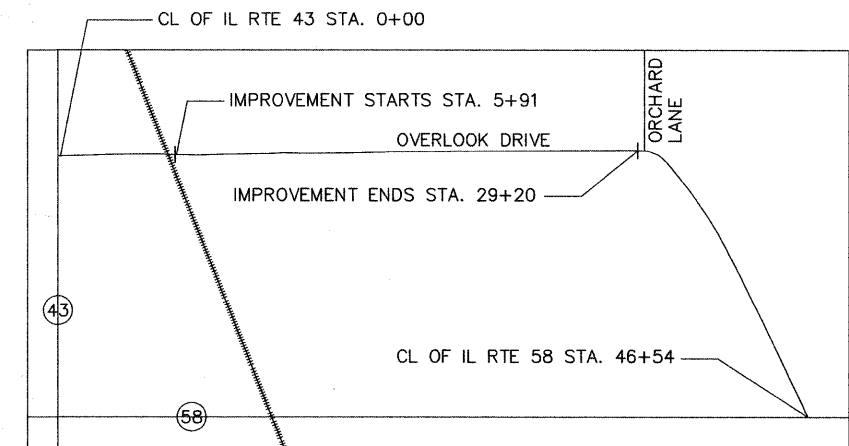

PROJECT SCHEMATIC

PROPOSED LEGEND

- (1) HOT-MIX ASPHALT SURFACE COURSE, MIX 'C', N50, 2"
- (2) HOT-MIX ASPHALT BINDER COURSE, IL-19.0, N50, 4" (TWO LIFTS)
- (3) BITUMINOUS MATERIALS (PRIME COAT) AND AGGREGATE (PRIME COAT)
- (4) REPAIR/PREPARATION OF AGGREGATE SUB-BASE
- (5) REMOVAL OF UNSUITABLE MATERIAL (AS NECESSARY)

HOT-MIX ASPHALT MIXTURE REQUIREMENTS TABLE

| MIXTURE TYPE  | AC TYPE    | AIR VOIDS   |
|---|------------|-------------|
| HOT MIX ASPHALT SURFACE COURSE, MIX 'C', N50, 2" (IL-9.5mm) | PG 64 -22  | 4% @ 50 GYR |
| HOT MIX ASPHALT BINDER COURSE IL-19.0, N50                  | PG 64 -22* | 4% @ 50 GYR |

THE UNIT WEIGHT TO CALCULATE ALL HMA SURFACE MIXTURE QUALITIES IS 112 LBS/SQ/IN

\*WHEN RAP EXCEEDS 20%, THE NEW ASPHALT BINDER IN THE MIX SHALL BE PG 58-22

|                                      |                    |                                |  |   |                         |                        |                           |                |                      |   |
|--------------------------------------|--------------------|--------------------------------|--|---|-------------------------|------------------------|---------------------------|----------------|----------------------|---|
| FILE NAME =<br>9434-008_Overlook.dwg | USER NAME =        | DESIGNED - BVS<br>DRAWN - BVS  | REVISED - 5/18/09 PER IDOT COMMENTS<br>REVISED - 5/28/09 PER IDOT COMMENTS | <b>OVERLOOK DRIVE<br/>RESURFACING PROGRAM</b> | <b>TYPICAL SECTIONS</b> | F.A.U.<br>RTE.<br>1311 | SECTION<br>09-00006-00-RS | COUNTY<br>COOK | TOTAL<br>SHEETS<br>6 | SHEET<br>NO.<br>3                               |
| PLOT SCALE = N.T.S.                  | PLOT DATE = 4/7/09 | CHECKED - PJG<br>DATE - 4/7/09 | SCALE: NONE  |   |                         | SHEET NO. 3 OF 6       | SHEETS                    | STA.           | TO STA.              | CONTRACT NO. 63191<br>ILLINOIS FED. AID PROJECT |