

ROUTE NO.	LOCAL AGENCY	COUNTY	TOTAL SHEETS	SHEET NO.
FAU 4082	Greenwood	McHenry	6	3
LOCAL AGENCY PAVEMENT PRESERVATION				
CONTRACT: 63192			SECTION: 09-00001-00-RS	

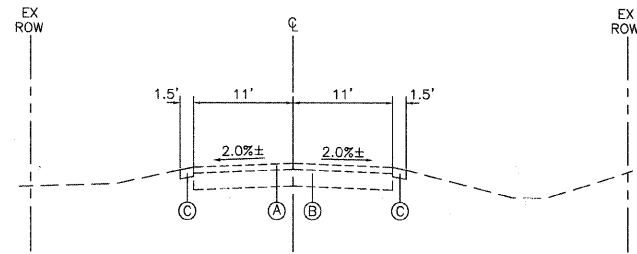

EXISTING TYPICAL SECTION
WONDERMERE ROAD

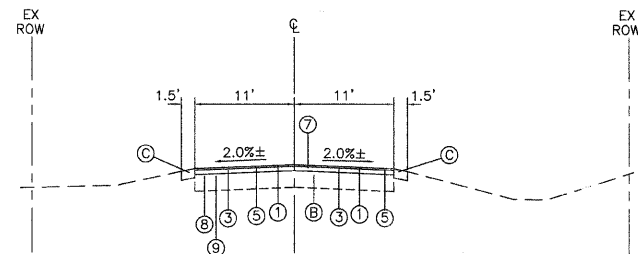

PROPOSED TYPICAL SECTION - REMOVAL
WONDERMERE ROAD
FROM STA. 103+70 TO STA. 118+50
FROM STA. 122+50 TO STA. 125+00

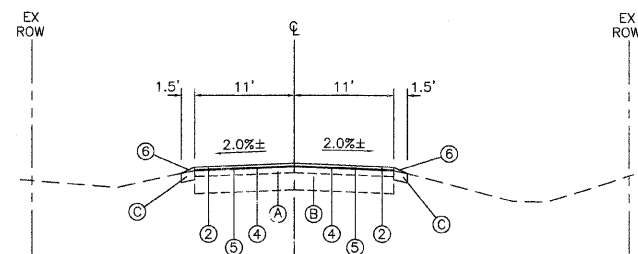

PROPOSED TYPICAL SECTION - OVERLAY
WONDERMERE ROAD
FROM STA. 100+46.39 TO STA. 103+70
FROM STA. 118+50 TO STA. 122+50
FROM STA. 125+00 TO STA. 157+26.62

EXISTING LEGEND

- (A) ASPHALT PAVEMENT, 3"-4"±
- (B) AGGREGATE BASE, 12"
- (C) AGGREGATE SHOULDER

PROPOSED LEGEND

- ① HOT-MIX ASPHALT SURFACE COURSE, MIX C, IL-9.5, N50, 1½"
- ② HOT-MIX ASPHALT SURFACE COURSE, MIX C, IL-9.5, N50, 2"
- ③ LEVELING BINDER (MACHINE METHOD), N50, 1¼"
- ④ LEVELING BINDER (MACHINE METHOD), N50, ¾"
- ⑤ BITUMINOUS MATERIALS (PRIME COAT)
- ⑥ PROPOSED AGGREGATE SHOULDER, TYPE B
- ⑦ HOT-MIX ASPHALT SURFACE REMOVAL, VARIABLE DEPTH, 2" TO 4"
- ⑧ AGGREGATE BASE COURSE, THICKNESS TO BE DETERMINED BY ENGINEER
- ⑨ PREPARATION OF BASE

HOT-MIX ASPHALT MIXTURE REQUIREMENTS

MIXTURE TYPE	AC TYPE	AIR VOIDS
HOT-MIX ASPHALT SURFACE COURSE, MIX "C" N50 (IL-9.5)	PG 64-22	4% @ 50 GYR.
LEVELING BINDER (MACHINE METHOD) N50	PG 64-22 **	4% @ 50 GYR.
PAVEMENT PATCHING	PG 64-22 **	4% @ 70 GYR.

** WHEN MORE THAN 15% RAP USED, A SOFTER ASPHALT BINDER (PG-58-22) MAY BE REQUIRED AS DETERMINED BY THE ENGINEER.

UNIT WEIGHT USED TO CALCULATE HOT-MIX ASPHALT - 112 LBS/SQ YD/IN.

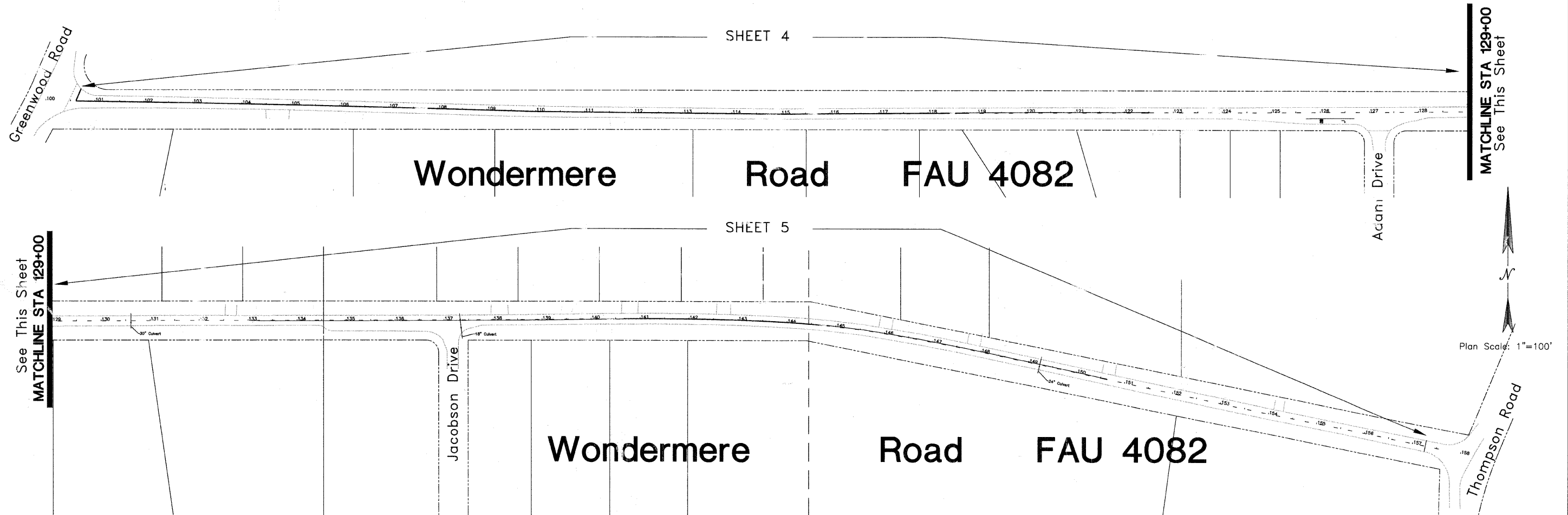

STATE OF ILLINOIS DEPARTMENT OF TRANSPORTATION	#	DATE	REMARKS	SCHEFFLOW ENGINEERS 1814 GRANDSTAND PLACE ELGIN, ILLINOIS 60123 (847) 697-7095 FIRM LICENSE NUMBER: 184-001104	Village of Greenwood, Illinois 09-00001-00-RS FAU 4082 Wondermere Road Resurfacing TYPICAL SECTION / OVERALL PLAN	SCALE	DATE
						NONE	4-30-09
						DRAWN BY	FILE NO.
						P.C.S.	4510
			CHECKED BY	SHEET NO.			
			F.C.C.	3 of 6			