

FAU RTE	SECTION	COUNTY	TOTAL SHEETS	SHEET NO.
VARIOUS	06-00080-00-BT	COOK	16	7
F.H.W.A. REG.	ILLINOIS PROJECT	HPP-3463(004)	CONTRACT NO. 63220	



PAINTED STRIPING CODE

- (A) PROPOSED SOLID YELLOW PAINTED PAVEMENT MARKING - LINE 4" (STALL LINE)
- (B) PROPOSED SOLID WHITE PAINTED PAVEMENT MARKING - LINE 6" (LANE LINE)
- (C) PROPOSED SOLID WHITE PAINTED PAVEMENT MARKING - LINE 24" (STOP BAR)
- (D) PROPOSED SOLID WHITE PAINTED PAVEMENT MARKING - LETTERS & SYMBOLS

CURB PAINTING

- (E) PROPOSED SOLID YELLOW PAINTED CURB & GUTTER MARKING (LENGTH AS NOTED)

SIGNING

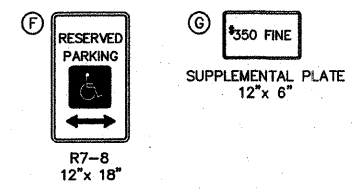

LEGEND

- [Diagonal hatching] DENOTES HOT-MIX ASPHALT SURFACE REMOVAL, VARIABLE DEPTH, PREPARATION OF BASE, HOT-MIX ASPHALT BINDER COURSE, N50, 2-1/4" AND HOT-MIX ASPHALT SURFACE COURSE, MIX "D", N50, 1-1/2"
- [Diagonal hatching] DENOTES HOT-MIX ASPHALT SURFACE REMOVAL, 1-1/2", AND HOT-MIX ASPHALT SURFACE COURSE, MIX "D", N50, 1-1/2"
- [Diagonal hatching] DENOTES PAVEMENT REMOVAL AND HIGH EARLY STRENGTH P.C. CONCRETE PAVEMENT, 10"
- [Diagonal hatching] DENOTES PAVEMENT REMOVAL (SPECIAL) AND HIGH EARLY STRENGTH P.C. CONCRETE PAVEMENT, 10" AND PAVEMENT FABRIC
- [Diagonal hatching] DENOTES SIDEWALK REMOVAL AND P.C. CONCRETE SIDEWALK, 5 INCH. DETECTABLE WARNING TO BE INSTALLED AS REQUIRED.
- "A" DENOTES VALVE VAULTS, VALVE BOXES, INLETS, CATCH BASINS, MANHOLES, AND HANDHOLES, TO BE ADJUSTED
- "R" DENOTES DRAINAGE & UTILITY STRUCTURES TO BE RECONSTRUCTED
- (10') DENOTES SOLID YELLOW PAINTED CURB MARKING
- 8 FT DENOTES COMBINATION CONCRETE CURB & GUTTER REMOVAL AND REPLACEMENT, DEPRESS CURB ADJACENT TO CURB RAMPS FOR SIDEWALKS AS REQUIRED.

NOTE:
 1 ALL EXISTING FRAMES AND LIDS THAT ARE TO BE REPLACED (AS DIRECTED BY THE ENGINEER) SHALL BE SALVAGED TO THE CONTRACTOR.
 2 ALL SAW CUTS SHALL BE CONSIDERED INCIDENTAL TO THE CONTRACT.

FOR TYPICAL CROSS SECTIONS OF NEW PAVEMENT WORK
 (SEE SHEET 8)

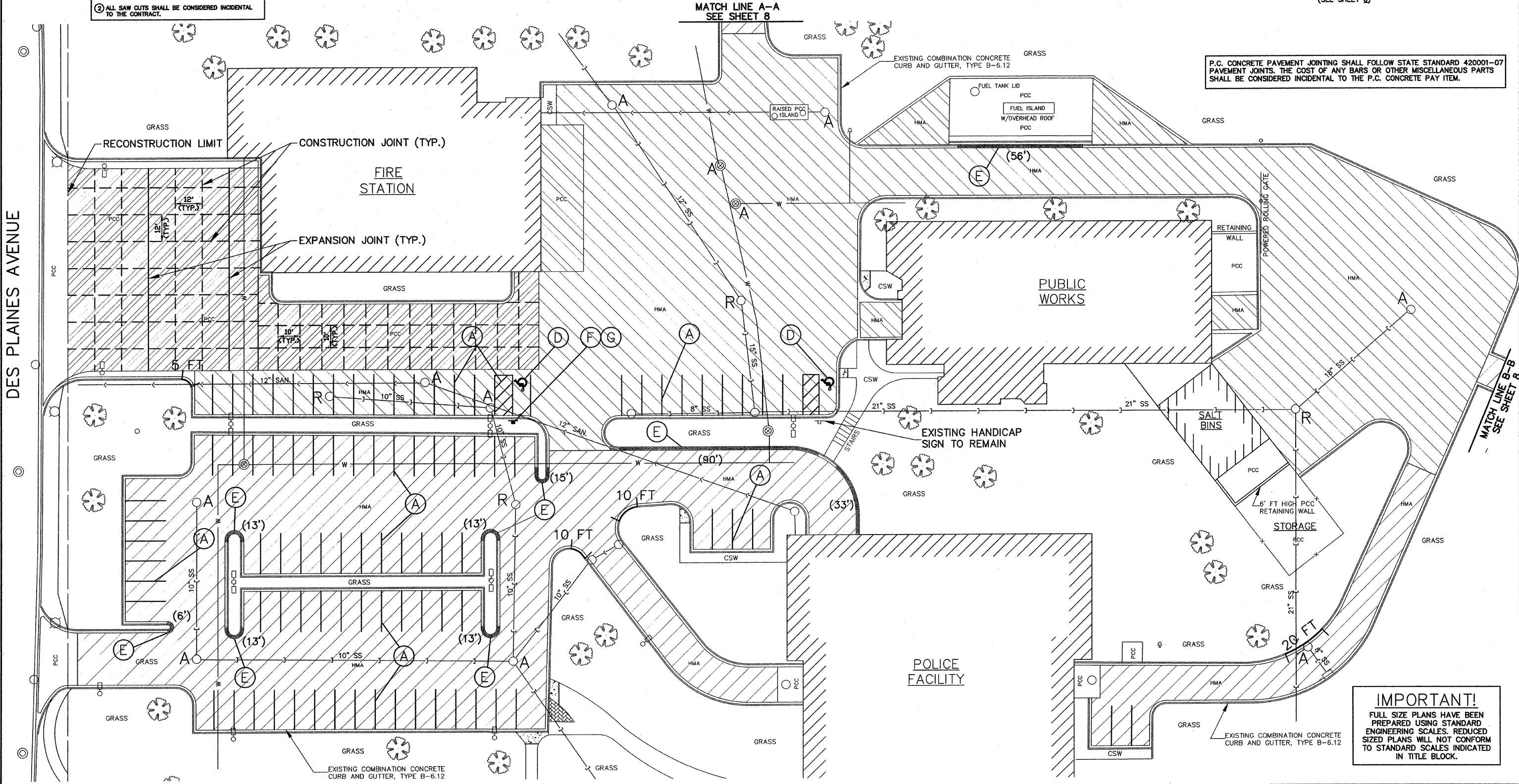

P.C. CONCRETE PAVEMENT JOINTING SHALL FOLLOW STATE STANDARD 420001-07 PAVEMENT JOINTS. THE COST OF ANY BARS OR OTHER MISCELLANEOUS PARTS SHALL BE CONSIDERED INCIDENTAL TO THE P.C. CONCRETE PAY ITEM.

IMPORTANT!
 FULL SIZE PLANS HAVE BEEN PREPARED USING STANDARD ENGINEERING SCALES. REDUCED SIZED PLANS WILL NOT CONFORM TO STANDARD SCALES INDICATED IN TITLE BLOCK.

Frank Novotny & Associates, Inc.
 Civil Engineers/Municipal Consultants
 825 Midway Drive • Willowbrook, IL • 60527 • Telephone: (630) 887-8640 • Fax: (630) 887-0132
 Illinois Professional Design Firm No. 184-000228

PROJECT VILLAGE OF NORTH RIVERSIDE, ILLINOIS
 VILLAGE WIDE BIKE PATH - STAGE 1
 26TH STREET RESURFACING (1ST AVENUE TO DES PLAINES AVENUE)
 & VILLAGE COMMONS COMPLEX PARKING REHABILITATION
 M.F.T. SECTION NO. 06-00080-00-BT

R E V I S I O N S			
NO.	BY	DATE	DESCRIPTION

PLAN SHEET: VILLAGE COMMONS
 (RESURFACING & PAVEMENT MARKING)
 VILLAGE POLICE FACILITY, PUBLIC WORKS,
 & FIRE STATION PARKING LOT, ROADWAYS,
 APRONS, & YARD RESURFACING

PROJECT NO. 03049	SCALE NONE	SHEET 7
DRAWN/DESIGNED JEP/AMS	DATE APRIL, 2009	OF 16
CHECKED/APPROVED JFP/JEF	FIELD BOOK NO. FILE	SHEETS

I:\North Riverside\2009\03049 - BIC (A)1\Sheet 2 - Plan\03049.dwg, 5/26/2009 1:55:48 PM, USER: JN, PLOT: 5/26/2009 1:55:48 PM