

SECTION 13, T15N, R6W, 3rd PM

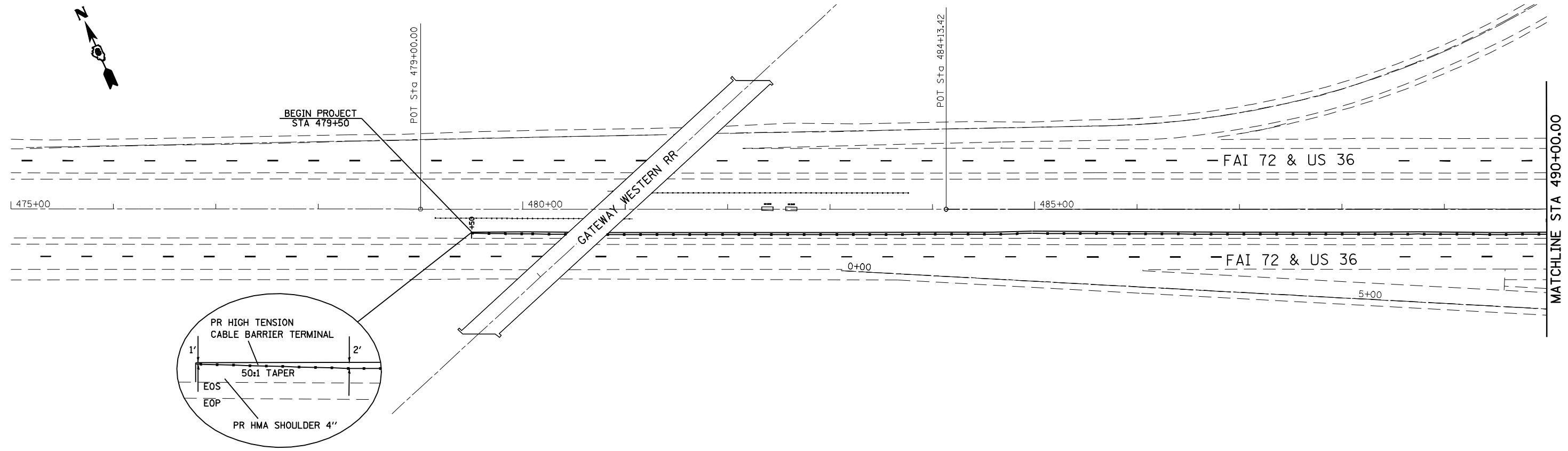

SECTION 13, T15N, R6W, 3rd PM

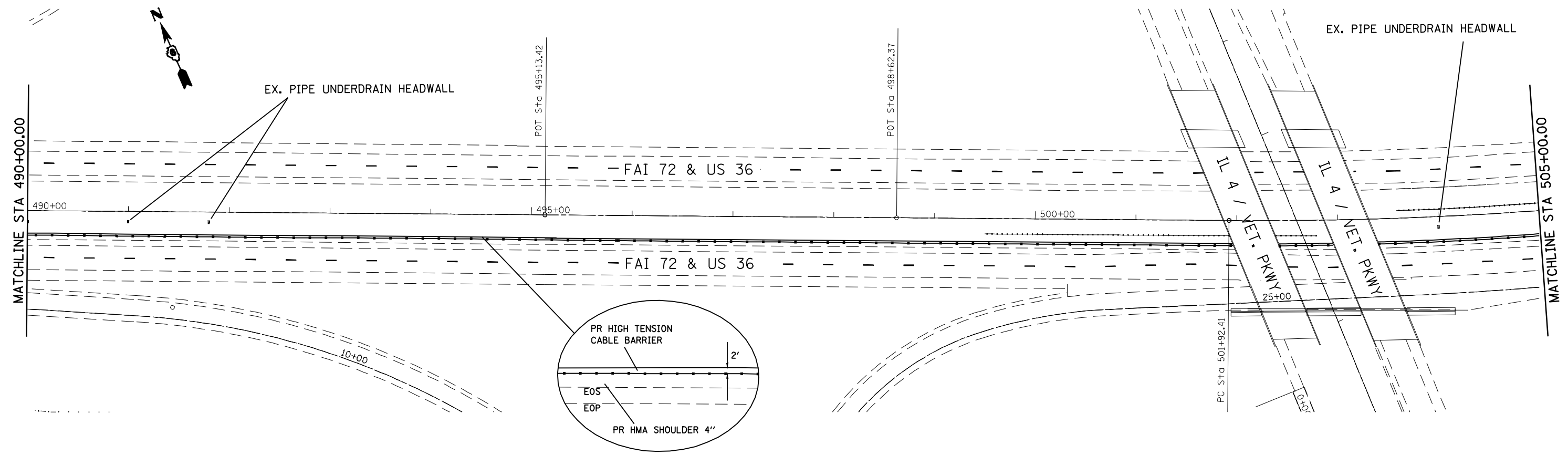

FILE NAME =	USER NAME = laughlinr1	DESIGNED - BKL	REVISED -
e:\pwork\pwork\LAUGHLINRL\0128581\0672C77-sh-t-DBLPLN1.dgn		DRAWN - BKL	REVISED -
PLOT SCALE = 100.0000' / IN.		CHECKED - JPM	REVISED -
PLOT DATE = May-07-2009 08:11:46AM		DATE - 04/10/09	REVISED -

**STATE OF ILLINOIS
DEPARTMENT OF TRANSPORTATION**

PLAN SHEET			
SCALE: 1" = 50'	SHEET NO.	OF SHEETS	STA. TO STA.

F.A.I. RTE.	SECTION	COUNTY	TOTAL SHEETS	SHEET NO.
72	*	SANGAMON	100	10
CONTRACT NO. 72C77				
ILLINOIS FED. AID PROJECT				

• DE CARLE/GIARDRAI 2010