

SECTION 16, T15N, R5W, 3rd PM

SECTION 15, T15N, R5W, 3rd PM

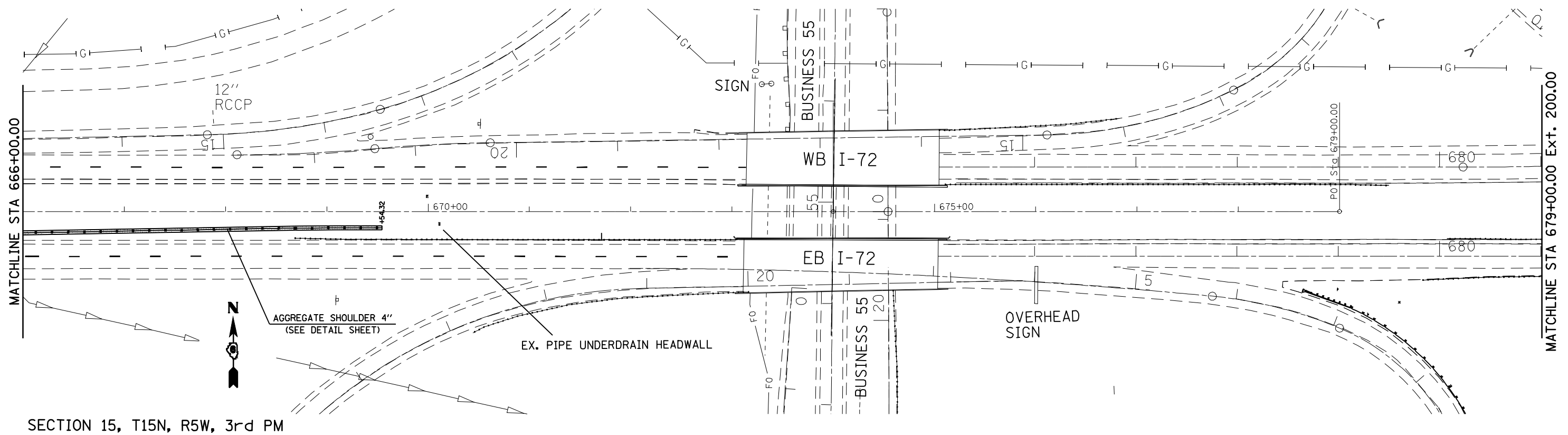
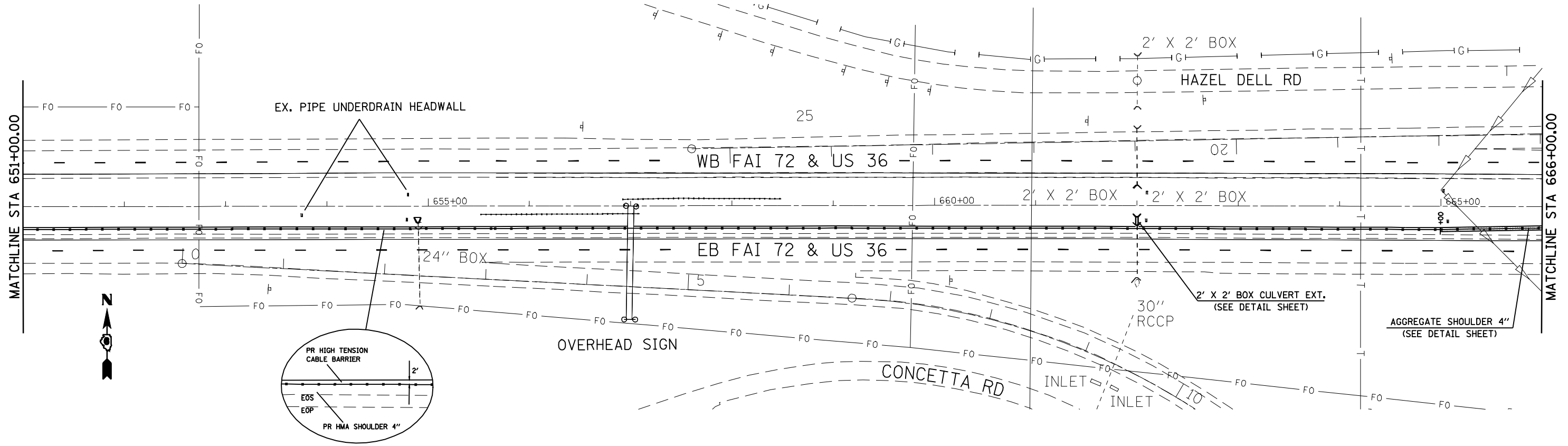

SECTION 15, T15N, R5W, 3rd PM

FILE NAME =	USER NAME = laughlinr1	DESIGNED - BKL	REVISED -	STATE OF ILLINOIS DEPARTMENT OF TRANSPORTATION	PLAN SHEET				F.A.I. RTE. = 72	SECTION =	COUNTY = SANGAMON	TOTAL SHEETS = 100	SHEET NO. = 16
es:\pwork\pwork\LAUGHLINR1\0672C77-sh-t-DBLPLN1.dgn		DRAWN - BKL	REVISED -		SCALE: 1" = 50'	SHEET NO.	OF SHEETS	STA.	TO STA.	CONTRACT NO. 72C77			
		CHECKED - JPM	REVISED -		ILLINOIS FED. AID PROJECT								
		DATE - 04/10/09	REVISED -		ILLINOIS FED. AID PROJECT								