

SECTION 16, T15N, R5W, 3rd PM

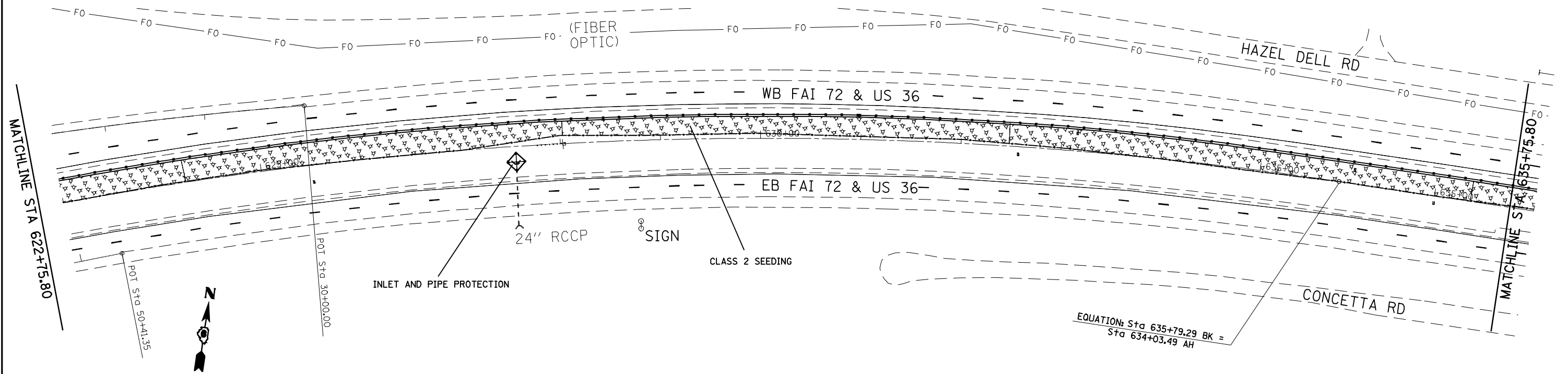

SECTION 16, T15N, R5W, 3rd PM

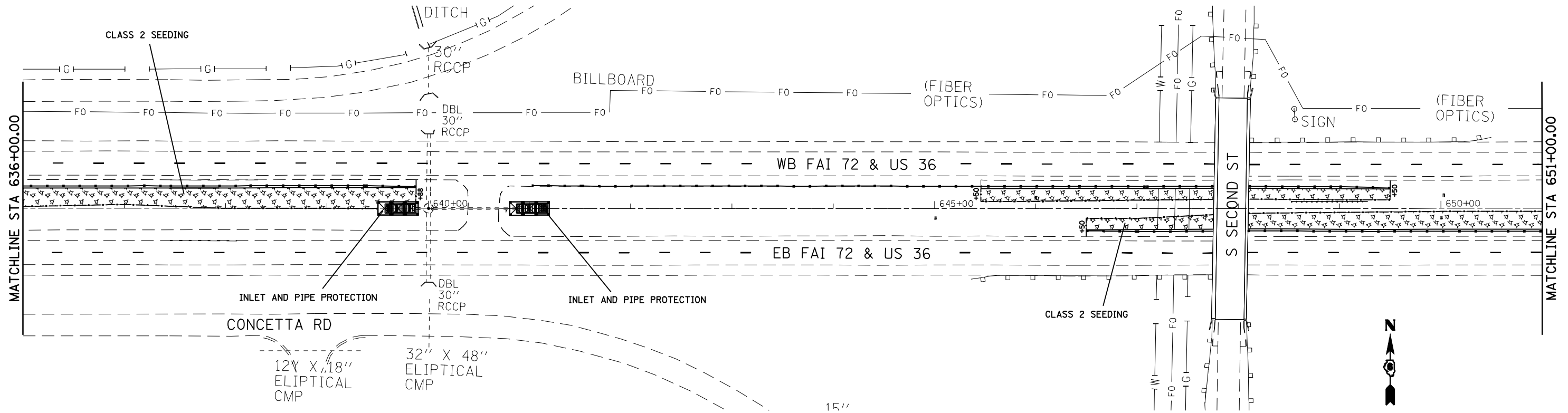

FILE NAME =	USER NAME = laughlinr1	DESIGNED - BKL	REVISED -	STATE OF ILLINOIS DEPARTMENT OF TRANSPORTATION	EROSION CONTROL AND SEEDING				F.A.I. RTE. = 72	SECTION =	COUNTY = SANGAMON	TOTAL SHEETS = 100	SHEET NO. = 24
es:\pwwork\pwidot\LAUGHLINR1\0672C77-sh-eros.dgn		DRAWN - BKL	REVISED -		SCALE: 1" = 50'	SHEET NO.	OF SHEETS	STA.	TO STA.	CONTRACT NO. 72C77			
PLOT SCALE = 100.0000' / IN.		CHECKED - JPM	REVISED -		ILLINOIS FED. AID PROJECT								
PLOT DATE = May-07-2009 08:15:05AM		DATE - 04/10/09	REVISED -		* DE CARLE/GUARINATI 2010								