

F.A.S. RTE.	SECTION	COUNTY	TOTAL SHEETS	SHEET NO.
731	(1)I-1	MACOUPIN	8	1
		ILLINOIS	CONTRACT NO. 72C91	

STATE OF ILLINOIS
DEPARTMENT OF TRANSPORTATION
DIVISION OF HIGHWAYS

PLANS FOR PROPOSED
CONTRACT MAINTENANCE

INDEX OF SHEETS

- 1 COVER SHEET
- 2 GENERAL NOTES /MIX REQUIREMENTS
- 3 SUMMARY OF QUANTITIES
- 4 TYPICAL CROSS SECTIONS
- 5-8 PLAN LAYOUT SHEETS

LIST OF STANDARDS

000001-05	701311-03
701001-02	701326-03
701006-03	701901-01
701011-02	780001-02
701301-03	

FAS ROUTE 731 (SCOTTVILLE ROAD)
SECTION (1)I-1
PROJECT
PROPOSED BITUMINOUS SHOULDERS, BOTH SIDES OF RDWY.
MACOUPIN COUNTY
C-96-086-09

D-96-086-09

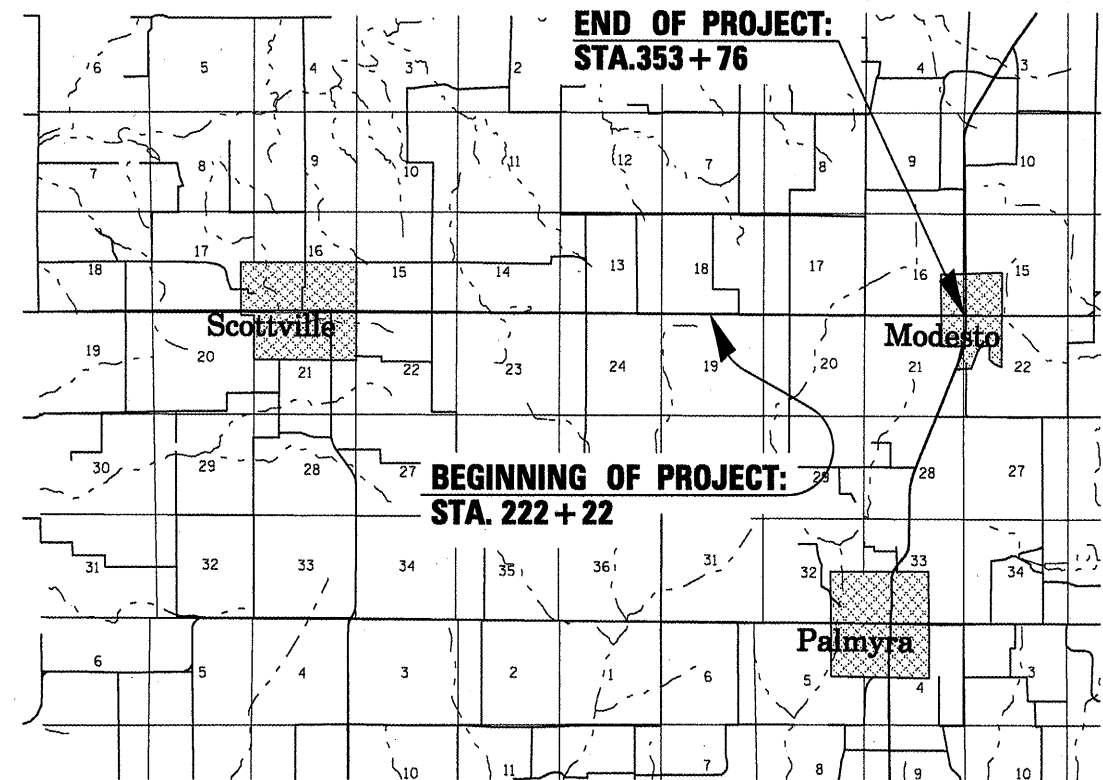
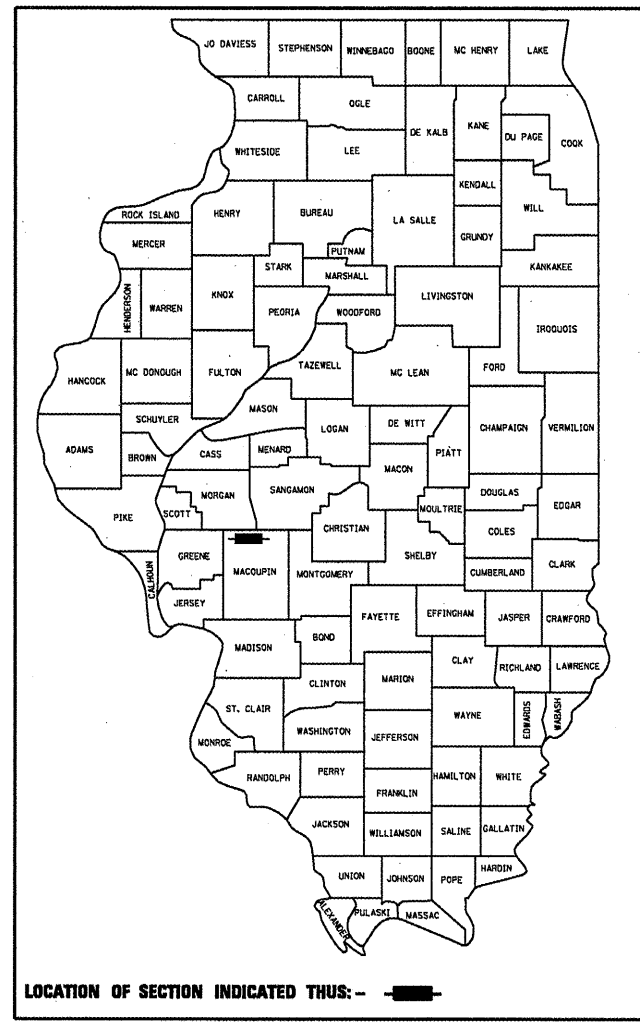

LOCATION MAP

GROSS LENGTH = 13,154 FT. = 2.491 MILES
NET LENGTH = 13,154 FT. = 2.491 MILES

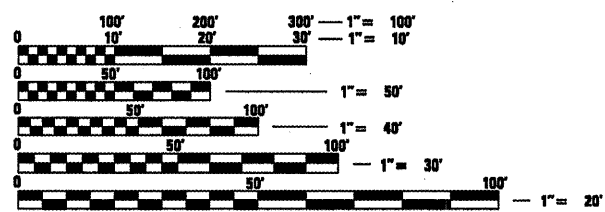

FULL SIZE PLANS HAVE BEEN PREPARED USING STANDARD ENGINEERING SCALES. REDUCED SIZED PLANS WILL NOT CONFORM TO STANDARD SCALES. IN MAKING MEASUREMENTS ON REDUCED PLANS, THE ABOVE SCALES MAY BE USED.

J.U.L.I.E.
JOINT UTILITY LOCATION INFORMATION FOR EXCAVATION
1-800-892-0123
OR 811

STATE OF ILLINOIS
DEPARTMENT OF TRANSPORTATION
DIVISION OF HIGHWAYS

SUBMITTED MAY 21 2009
Reg. E. Dumb
DEPUTY DIRECTOR OF HIGHWAYS, REGION ENGINEER

June 26 2009
Charles G. Ingersoll
ENGINEER OF DESIGN AND ENVIRONMENT

June 26 2009
Christine M. Reed
DIRECTOR OF HIGHWAYS, CHIEF ENGINEER

PRINTED BY THE AUTHORITY
OF THE STATE OF ILLINOIS

PROJECT ENGINEER: SAL MADONIA (217) 782-4761
SQUAD LEADER: MARCUS BRUCE (217) 524-0946

CONTRACT NO. 72C91

GENERAL NOTES

1. ANY REFERENCE TO A STANDARD IN THESE PLANS SHALL BE INTERPRETED TO MEAN THE EDITION AS INDICATED BY THE SUB NUMBER LISTED IN THE INDEX OF SHEETS OR THE COPY OF THE STANDARD INCLUDED IN THESE PLANS.
2. IN ADDITION TO FIELD SURVEYS, PLAN DIMENSIONS AND DETAILS RELATIVE TO THE EXISTING FACILITIES HAVE BEEN TAKEN FROM EXISTING PLANS AND ARE SUBJECT TO CONSTRUCTION VARIATIONS. IT SHALL BE THE CONTRACTOR'S RESPONSIBILITY TO VERIFY SUCH DIMENSIONS AND DETAILS IN THE FIELD. SUCH VARIATIONS SHALL NOT BE A CAUSE FOR ADDITIONAL COMPENSATION DUE TO A CHANGE IN THE SCOPE OF WORK, HOWEVER, THE CONTRACTOR WILL BE PAID FOR THE QUANTITY ACTUALLY FURNISHED AT THE UNIT PRICE BID FOR THE WORK.
3. ACCESS TO ALL ENTRANCES AND SIDE ROADS SHALL BE MAINTAINED AT ALL TIMES.
4. THE CONTRACTOR SHALL BE RESPONSIBLE FOR PROTECTING UTILITY PROPERTY FROM CONSTRUCTION OPERATIONS, AS OUTLINED IN ARTICLE 107.31 OF THE STANDARD SPECIFICATIONS. THE J.U.L.I.E. NUMBER IS 1-800-892-0123. A MINIMUM OF 48 HOURS ADVANCE NOTICE IS REQUIRED.
5. THE THICKNESS OF BITUMINOUS MIXTURES SHOWN ON THE PLANS IS THE NOMINAL THICKNESS. DEVIATIONS FROM THE NOMINAL THICKNESS WILL BE PERMITTED WHEN SUCH DEVIATIONS OCCUR DUE TO IRREGULARITIES IN THE EXISTING SURFACE OR BASE ON WHICH THE BITUMINOUS MIXTURE IS PLACED.
6. ALL SAW CUTS, NECESSARY TO COMPLETE THE WORK DETAILED IN THESE PLANS, SHALL BE INCLUDED IN THE COST FOR THE VARIOUS PAY ITEMS INVOLVED.
7. UNLESS DIRECTED BY THE ENGINEER, PAVEMENT MARKING LINES SHALL NOT BE LAID DIRECTLY OVER A LONGITUDINAL CRACK OR JOINT NOR OVER A TAR OR ASPHALT PAINTED LINE. THE EDGE OF A CENTERLINE OR LANE LINE SHALL BE OFFSET A MINIMUM DISTANCE OF 2" FROM A LONGITUDINAL CRACK OR JOINT. EDGE LINES SHALL BE APPROXIMATELY 2" FROM THE EDGE LINE OF PAVEMENT. SEE SECTION 780 OF THE STANDARD SPECIFICATIONS FOR TRAFFIC CONTROL ITEMS.
8. THE FOLLOWING RATES OF APPLICATION HAVE BEEN USED TO CALCULATE THE PLAN QUANTITIES:
 BITUMINOUS MATERIALS (PRIME COAT) 0.00038 TON/SQ. YD. (ON PAVEMENT)
 BITUMINOUS MATERIALS (PRIME COAT) 0.001425 TON/SQ.YD. (ON AGG)
 AGGREGATE PRIME COAT 0.002 TON/SQ. YD.
 BITUMINOUS CONCRETE SURFACE 0.056 TON/SQ. YD. PER 1"
 AGGREGATE MATERIAL 2.05 TON/CU. YD.
9. THE EXISTING ROAD SIGNS THAT INTERFERE WITH CONSTRUCTION WILL BE REMOVED OR RELOCATED AS DIRECTED BY THE ENGINEER. AFTER THE CONSTRUCTION IS COMPLETED, THE CONTRACTOR WILL REPLACE THE SIGNS AS DIRECTED BY THE ENGINEER. THIS WORK WILL NOT BE PAID SEPARATELY BUT SHALL BE CONSIDERED INCLUDED IN THE CONTRACT, AND NO COMPENSATION WILL BE ALLOWED.
10. WHERE SECTION OR SUB-SECTION MARKERS ARE ENCOUNTERED, THE ENGINEER SHALL BE NOTIFIED BEFORE SUCH MONUMENTS ARE REMOVED. THE CONTRACTOR SHALL PROTECT AND CAREFULLY PRESERVE ALL PROPERTY MARKERS AND MONUMENTS UNTIL THE OWNER, AN AUTHORIZED AGENT OR LAND SURVEYOR HAS WITNESSED OR OTHERWISE REFERENCED THEIR LOCATION.
11. LIMITS OF CONSTRUCTION ALONG SIDE ROADS SHALL BE VERIFIED AND APPROVED BY THE ENGINEER BEFORE WORK BEGINS. LIMITS MAY BE ADJUSTED FROM PROPOSED PLAN LAYOUT IF ENGINEER DEEMS NECESSARY.
12. EXISTING MANHOLES AND INLET FRAMES & LIDS DAMAGED BY THE CONTRACTOR'S OPERATION SHALL BE REPLACED WITH NEW FRAMES AND LIDS AT THE CONTRACTOR'S EXPENSE.
13. THE DISTRICT BUREAU OF OPERATIONS SHALL BE NOTIFIED AT LEAST 14 DAYS PRIOR TO PLACEMENT OF FINAL PAVEMENT MARKINGS, PHONE (217) 782-7314.
14. ALL OF THE DISTURBED AREAS WITHIN THE RIGHT OF WAY NOT COVERED BY SURFACING MATERIAL SHALL BE SEEDED.
15. THE CONTRACTOR SHALL PROVIDE ADEQUATE DRAINAGE FOR THE DURATION OF THIS PROJECT.
16. SEEDING WILL NOT BE PERMITTED AT ANY TIME WHEN THE GROUND IS FROZEN, WET OR IN AN UNTILLABLE CONDITION. LOCATIONS TO BE SEEDED SHALL BE DETERMINED BY THE ENGINEER.
17. THE GRADING AND SHAPING OF THE DITCHES SHALL BE DONE IN SUCH A MANNER TO ESTABLISH POSITIVE FLOW BETWEEN DRAINAGE STRUCTURES, OR BETWEEN THE EXISTING ELEVATION AT THE UPSTREAM END OF THE GRADING TO THE DOWNSTREAM DRAINAGE STRUCTURE.

COMMITMENTS:

THERE ARE NO COMMITMENTS MADE FOR THIS PROJECT.

MIXTURE REQUIREMENTS FOR PROPOSED 9" BITUMINOUS SHOULDERS		
LOCATIONS:	TOP 2" OF PROPOSED LT. & RT. SHLDRS.	BOTTOM 7" OF PROPOSED LT. & RT. SHLDRS.
MIXTURE USE(S):	HMA SURFACE COURSE, MIX "C", N50	HMA BINDER COURSE, IL-19.0, N50
P.G.:	PG 64-22	PG 64-22
DESIGN AIR VOIDS:	4.0% @ N50	4.0% @ N50
MIXTURE COMPOSITION: (GRADATION MIXTURE)	IL 9.5 OR 12.5	IL 19.0
FRICITION AGGREGATE:	MIX "C"	NOT APPLICABLE

DISTRICT SIX	
EXAMINED <u>May 21</u> 20 <u>09</u> <i>[Signature]</i>	OPERATIONS ENGINEER
EXAMINED <u>May 21</u> 20 <u>09</u> <i>[Signature]</i>	PROGRAM IMPLEMENTATION ENGINEER
EXAMINED <u>May 21</u> 20 <u>09</u> <i>[Signature]</i>	PROGRAM DEVELOPMENT ENGINEER

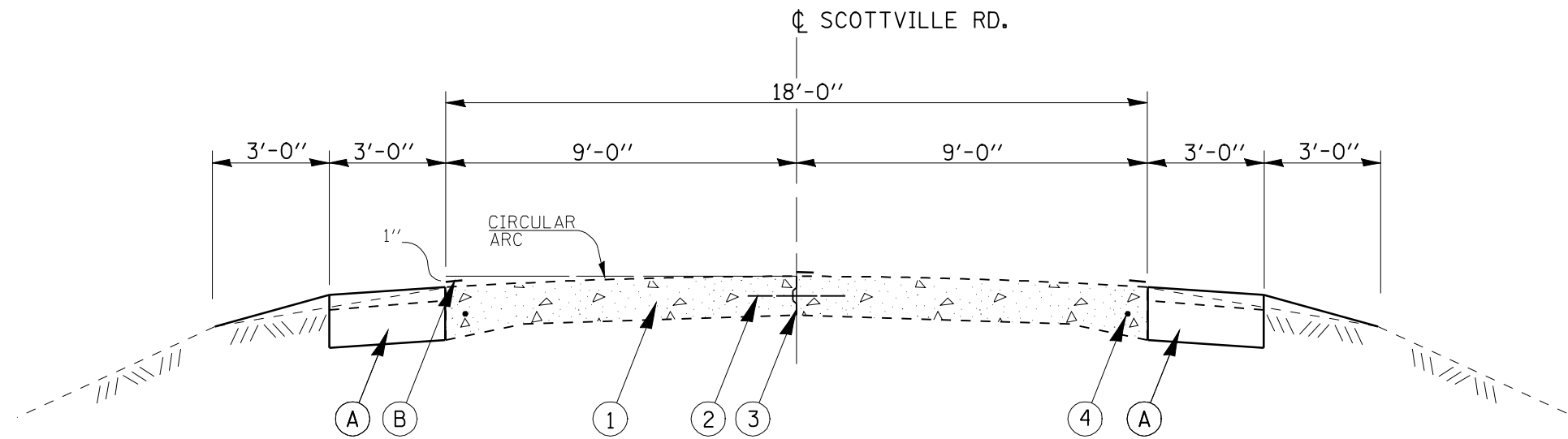

STA. 222+22 TO STA. 340+72

LEGEND

- ① EXISTING 9''-6''-9'' P.C.C. PAVEMENT
- ② EXISTING 1/2'' ϕ DEFORMED TIE BAR 4' LONG @ 5' CENTERS
- ③ EXISTING LONGITUDINAL METAL JOINT
- ④ 3/4'' ϕ SMOOTH BAR
- (A) PROPOSED HMA SHOULDERS, 9'', CONSISTING OF:
* HMA SURFACE COURSE, MIX "C", N 50, 2'' DEPTH
* HMA BINDER COURSE, IL-19.0, N50, 7'' DEPTH
- (B) PROPOSED PAINT PAVEMENT MARKING - LINE 4''

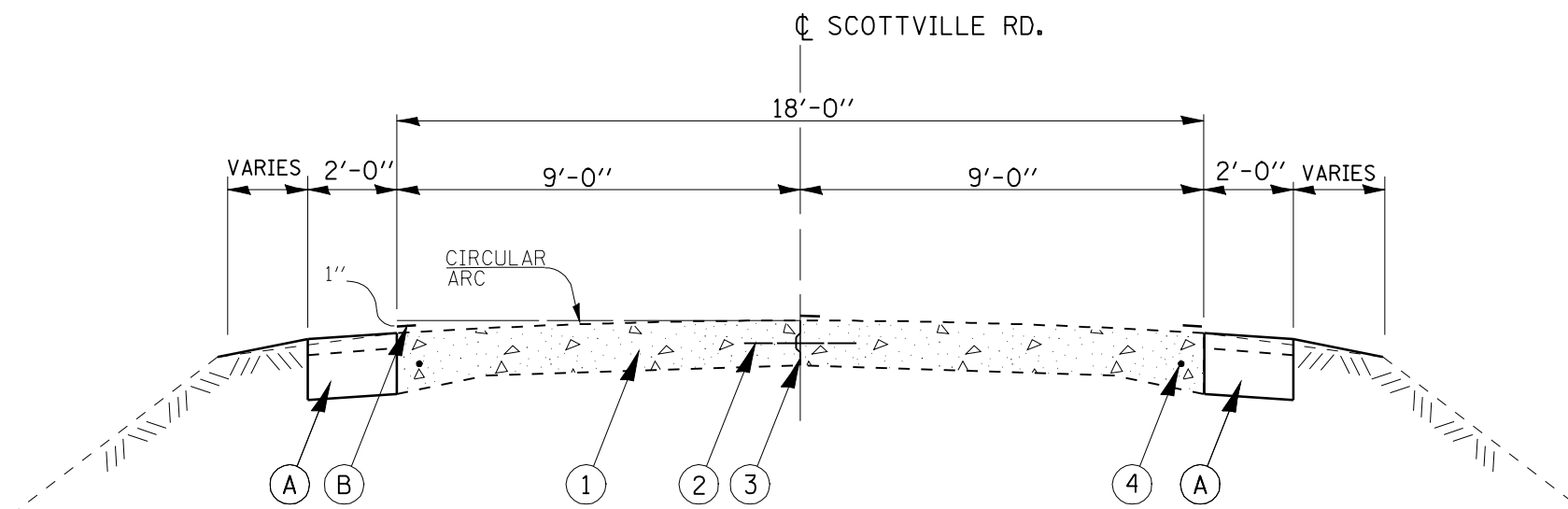

**STA. 340+72 TO STA. 353+76 (NORTH)
STA. 340+72 TO STA. 353+46 (SOUTH)**

FILE NAME =	USER NAME = woodsej	DESIGNED - RTS	REVISED -	STATE OF ILLINOIS DEPARTMENT OF TRANSPORTATION	TYPICAL CROSS SECTIONS			F.A.S. RTE.	SECTION	COUNTY	TOTAL SHEETS	SHEET NO.
ea:\pwork\pwidot\WOODSEJ\0143531\0672091-sht-typool.dgn		DRAWN - RTS	REVISED -		731	(1)I-1	MACOUPIN	8	4			
PLOT SCALE = 40.0000' / IN.		CHECKED - MEB	REVISED -		CONTRACT NO. 72C91							
PLOT DATE = May-21-2009 11:24:14AM		DATE - 05-19-09	REVISED -		SCALE:	SHEET NO. 1 OF 1 SHEETS	STA.	TO STA.	ILLINOIS FED. AID PROJECT			

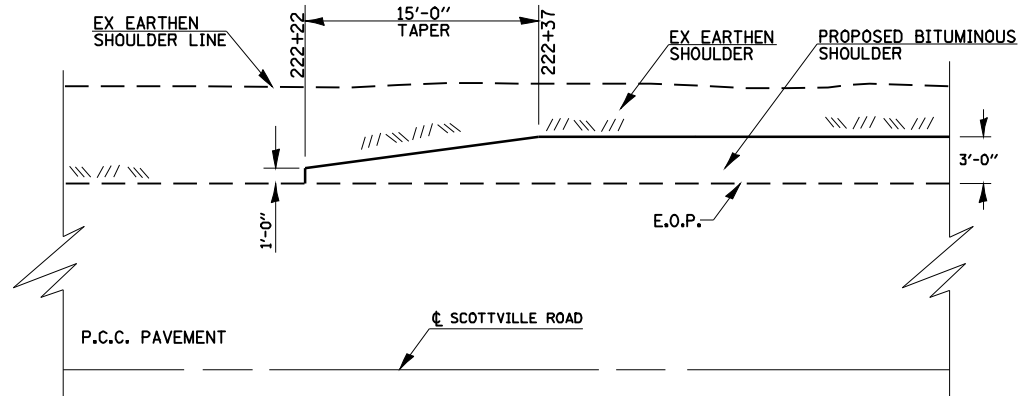
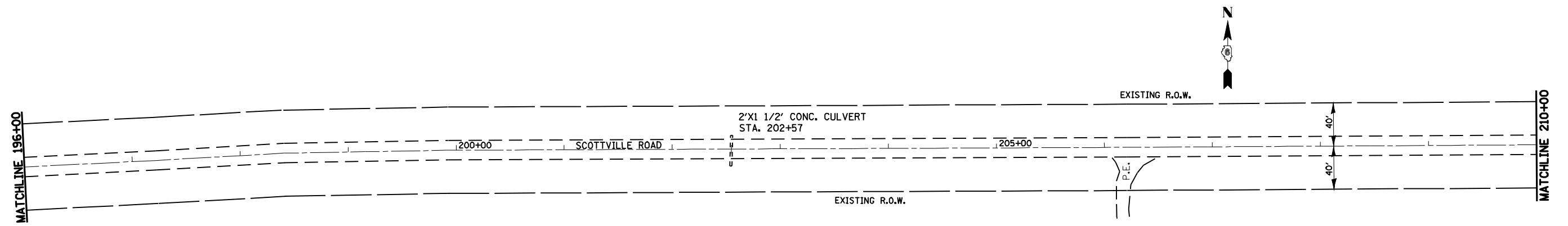

TAPER DETAIL FOR PROPOSED BITUMINOUS SHOULDERS
 (TRANSITION WIDTH FOR PROPOSED BITUMINOUS SHOULDERS FROM 1'-0" TO 3'-0" WITHIN 15'-0")
 INSET (BEGINNING OF PROJECT)

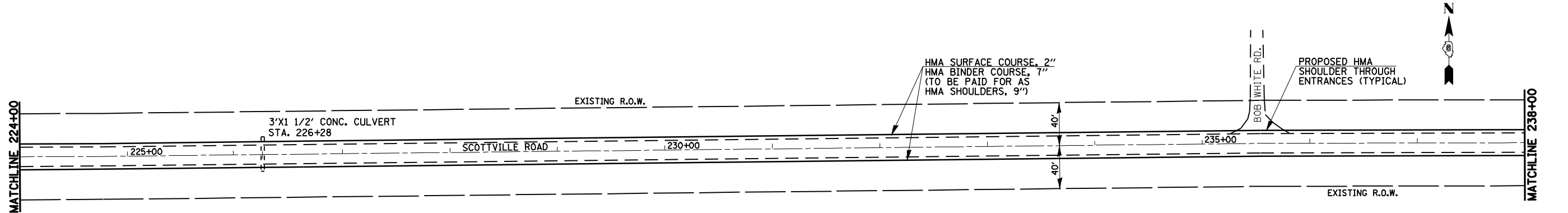
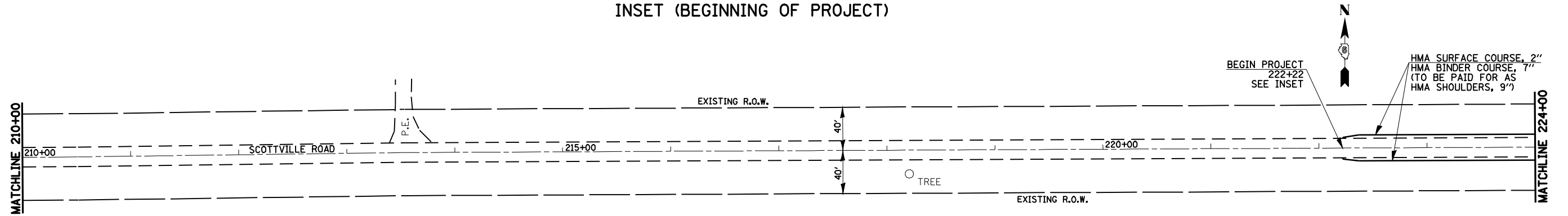

FILE NAME =	USER NAME = woodsej	DESIGNED -	REVISED -	STATE OF ILLINOIS DEPARTMENT OF TRANSPORTATION	PLAN LAYOUT		F.A.S. RTE.	SECTION	COUNTY	TOTAL SHEETS	SHEET NO.	
er:\pwork\PWIDOT\WOODSEJ\0143531\0672091-sht-plan.dgn		DRAWN -	REVISED -		SCALE:	SHEET NO. 1 OF 4 SHEETS	STA.	TO STA.	731	(1)I-1	MACOUPIN	8 5
		CHECKED -	REVISED -								CONTRACT NO. 72C91	
		DATE -	REVISED -								ILLINOIS FED. AID PROJECT	

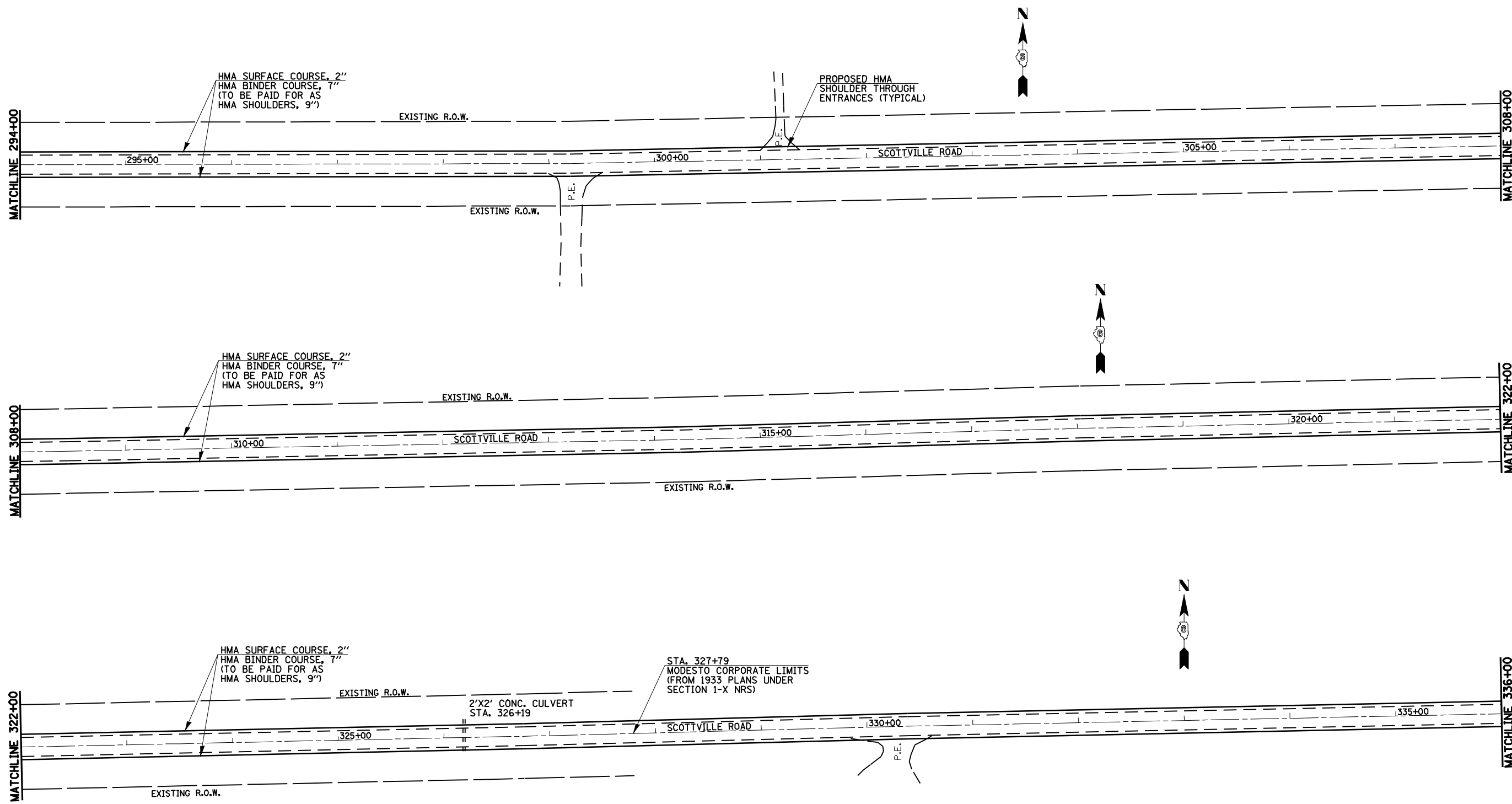

FILE NAME =
 e:\pwwork\pwwid001\WOODSEJ\143531\0672091-sht-plan.dgn

USER NAME = woodsej
 PLOT SCALE = 100.0000' / IN.
 PLOT DATE = May-21-2009 11:24:22AM

DESIGNED -
 DRAWN -
 CHECKED -
 DATE -

REVISED -
 REVISED -
 REVISED -
 REVISED -

**STATE OF ILLINOIS
 DEPARTMENT OF TRANSPORTATION**

PLAN LAYOUT

SCALE: SHEET NO. 3 OF 4 SHEETS STA. TO STA.

F.A.S. RTE.	SECTION	COUNTY	TOTAL SHEETS	SHEET NO.
731	(1)I-1	MACOUPIN	8	7
CONTRACT NO. 72C91			ILLINOIS FED. AID PROJECT	

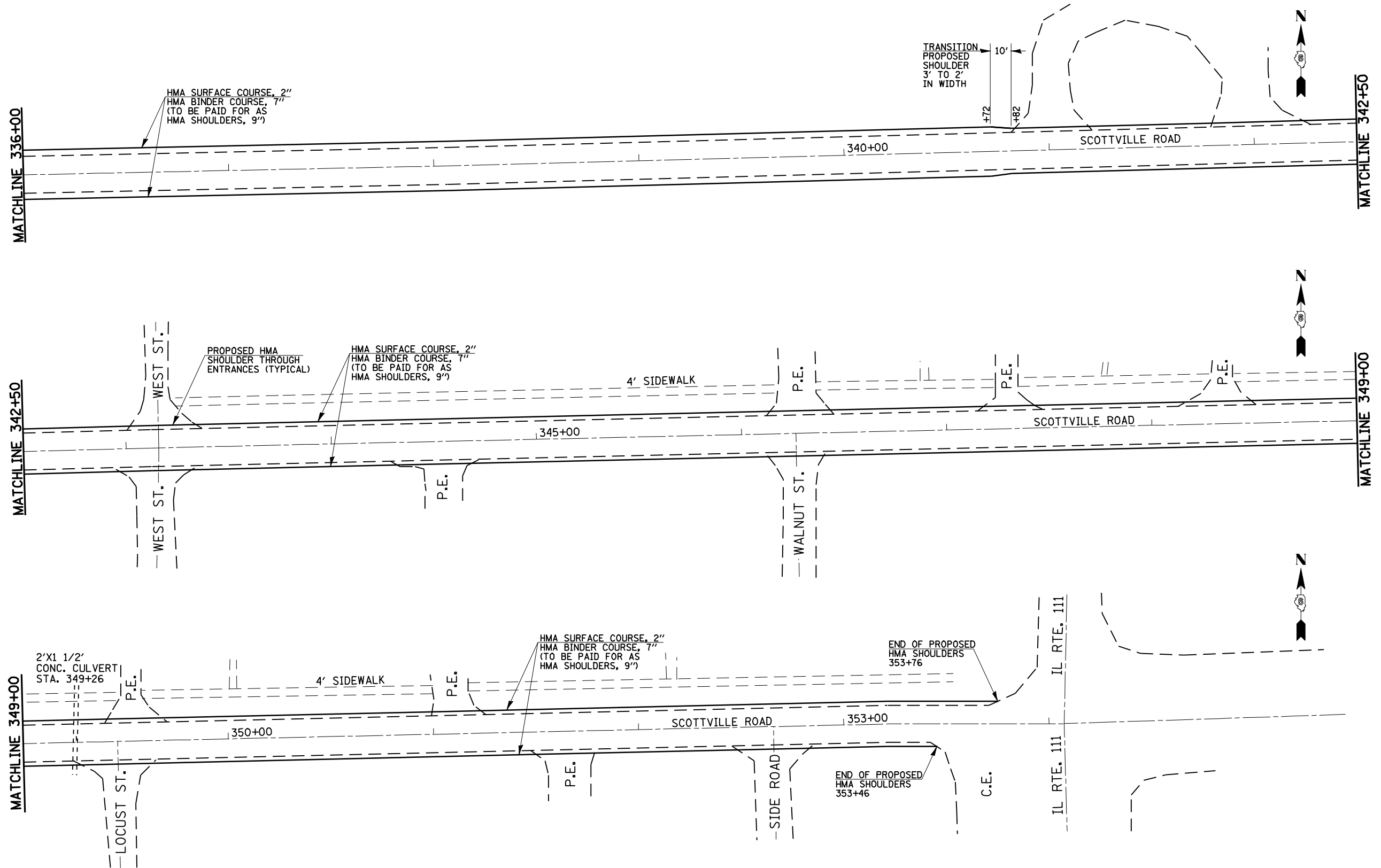

FILE NAME =	USER NAME = woodsej	DESIGNED -	REVISED -
er\pwork\PWIDOT\WOODSEJ\0143531\0672091-sht-plan.dgn		DRAWN -	REVISED -
PLOT SCALE = 100.0000' / IN.		CHECKED -	REVISED -
PLOT DATE = May-21-2009 11:24:25AM		DATE -	REVISED -

**STATE OF ILLINOIS
DEPARTMENT OF TRANSPORTATION**

PLAN LAYOUT			
SCALE:	SHEET NO. 4 OF 4 SHEETS	STA.	TO STA.

F.A.S. RTE.	SECTION	COUNTY	TOTAL SHEETS	SHEET NO.
731	(1)I-1	MACOUPIN	8	8
CONTRACT NO.				
ILLINOIS FED. AID PROJECT				

72C91