

MATCHLINE (SEE PAGE 8)

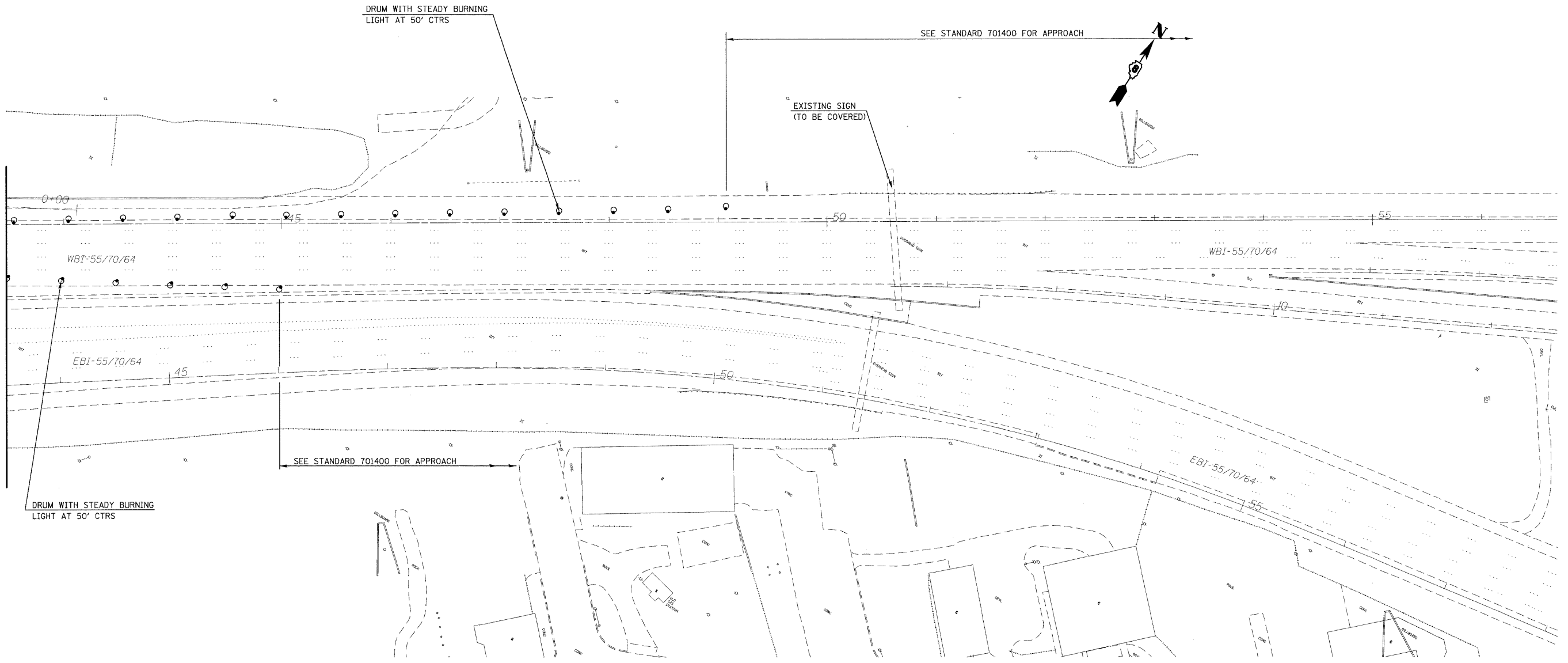

- NOTES:
1. THE COST OF DRUMS, "BARRICADES, TYPE III", "BRIDGE CLOSED" SIGNS, AND COVERING ALL EXISTING SIGNS SHALL BE INCLUDED IN THE COST OF "TRAFFIC CONTROL AND PROTECTION"
 2. A MINIMUM OF 3 CHANGEABLE MESSAGE SIGNS SHALL BE REQUIRED FOR THIS CONTRACT. ONE SHALL BE PLACED ON I-70 EB IN MISSOURI, ONE ON WB I-55/70/64, AND ONE ON WB 64.

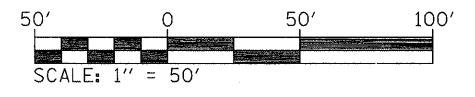

FILE NAME =
 c:\pw_work\VPWIDOT\GELINH\0141408\0876D

USER NAME = gelinh
 4-shr-closure.dgn
 PLOT SCALE = 50.0000' / IN.
 PLOT DATE = 5/28/2009

DESIGNED - ---
 DRAWN - ---
 CHECKED - ---
 DATE - ---

REVISED - ---
 REVISED - ---
 REVISED - ---
 REVISED - ---

**STATE OF ILLINOIS
 DEPARTMENT OF TRANSPORTATION**

MLK CLOSURE DETAILS

SCALE: _____ SHEET NO. ____ OF ____ SHEETS STA. _____ TO STA. _____

F.A.P. RTE.	SECTION	COUNTY	TOTAL SHEETS	SHEET NO.
799	I-I	ST CLAIR	15	9
CONTRACT NO. 76D14				
ILLINOIS FED. AID PROJECT				