

| | |
|---------------|--|
| DATE | |
| BY | |
| FINAL SURVEY | |
| NOTED | |
| NOTE BOOK | |
| AREAS CHECKED | |
| NO. | |

| | |
|-----------------|--|
| DATE | |
| BY | |
| ORIGINAL SURVEY | |
| NOTED | |
| NOTE BOOK | |
| AREAS CHECKED | |
| NO. | |

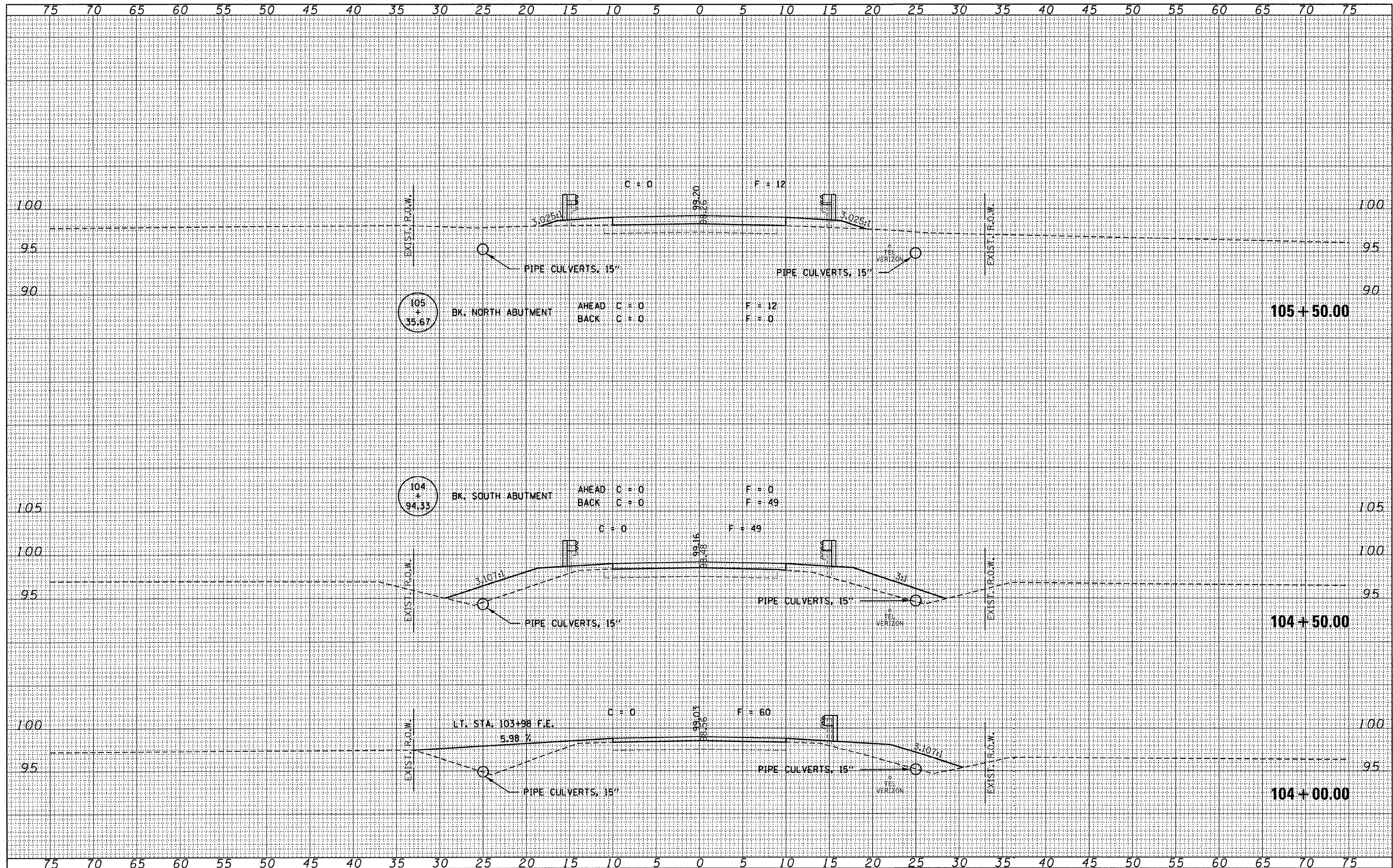

FILE NAME = 070432-sht-axe.dgn

USER NAME =
 PLOT SCALE =
 PLOT DATE = 5/6/2009

DESIGNED - J.W.F.
 DRAWN - D.T.M.
 CHECKED - S.W.M.
 DATE - 12/20/07

REVISED -
 REVISED - TWK
 REVISED - L.F.S.
 REVISED - 04/22/09

STATE OF ILLINOIS
 FORD COUNTY HIGHWAY DEPARTMENT



HAMPTON, LENZINI & RENWICK, INC.
 CIVIL & STRUCTURAL ENGINEERS
 LAND SURVEYORS

1500 E.
 CROSS SECTIONS

SCALE: SHEET NO. OF SHEETS STA. 104+00.00 TO STA. 105+50.00

| | | | | |
|---|----------------|--------|--------------------|-----------|
| C.H. | SECTION | COUNTY | TOTAL SHEETS | SHEET NO. |
| 26 | 09-00106-00-BR | FORD | 32 | 7 |
| FED. ROAD DIST. NO. [ILLINOIS] FED. AID PROJECT | | | CONTRACT NO. 87411 | |