

DATE	BY
SURVEYED	
NOTE BOOK	
NO.	
AREAS CHECKED	

DATE	BY
SURVEYED	
NOTE BOOK	
NO.	
AREAS CHECKED	

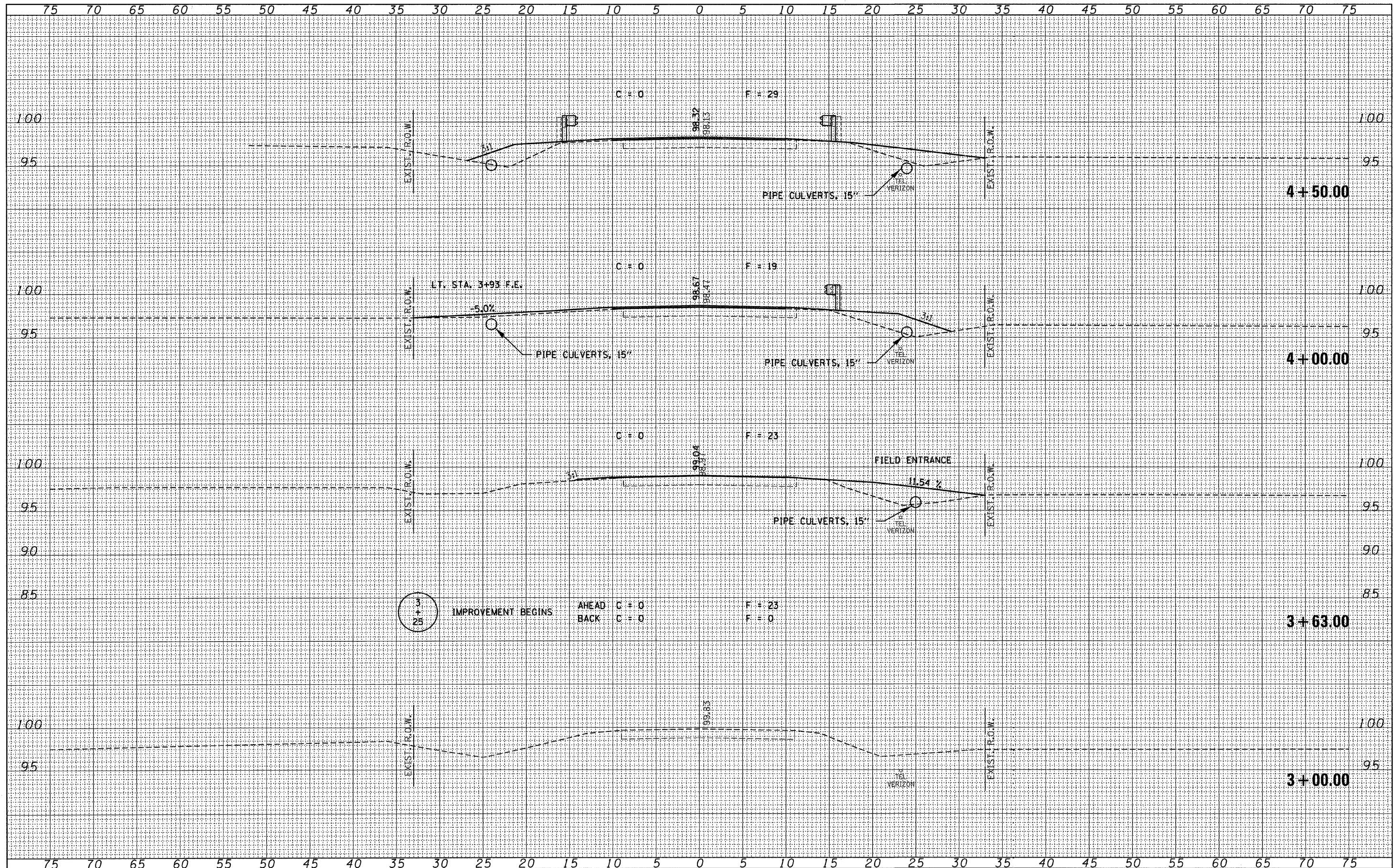

FILE NAME = 070435-shr-axe.dgn

USER NAME =	DESIGNED - J.W.F.	REVISED -
PLOT SCALE =	DRAWN - D.T.M.	REVISED - TWK
PLOT DATE = 5/6/2009	CHECKED - S.W.M.	REVISED - L.F.S.
	DATE - 12/26/07	REVISED - 04/22/09

**STATE OF ILLINOIS  
FORD COUNTY HIGHWAY DEPARTMENT**

**HLR** HAMPTON, LENZINI & RENWICK, INC.  
CIVIL & STRUCTURAL ENGINEERS  
LAND SURVEYORS

**1500 E.  
CROSS SECTIONS**

C.H.	SECTION	COUNTY	TOTAL SHEETS	SHEET NO.
26	09-00107-00-BR	FORD	32	11
FED. ROAD DIST. NO. ILLINOIS FED. AID PROJECT			CONTRACT NO. 87411	

SCALE: SHEET NO. OF SHEETS STA. 3+00.00 TO STA. 4+50.00