

P:\A\2005\EG05055A.dwg\EG05055-BASE-TOPG.dwg 5/12/2009 8:01:31 AM CDT

EROSION CONTROL LEGEND			
■	NEW INLET		
●	NEW MANHOLE		
▼	NEW FLARED END SECTION		
□	INLET AND PIPE PROTECTION		
C	CULVERT INLET PROTECTION		
S	PERIMETER EROSION BARRIER		
▨	RIP-RAP		

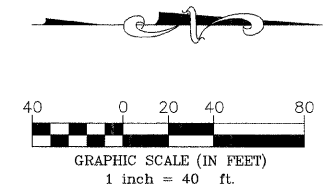
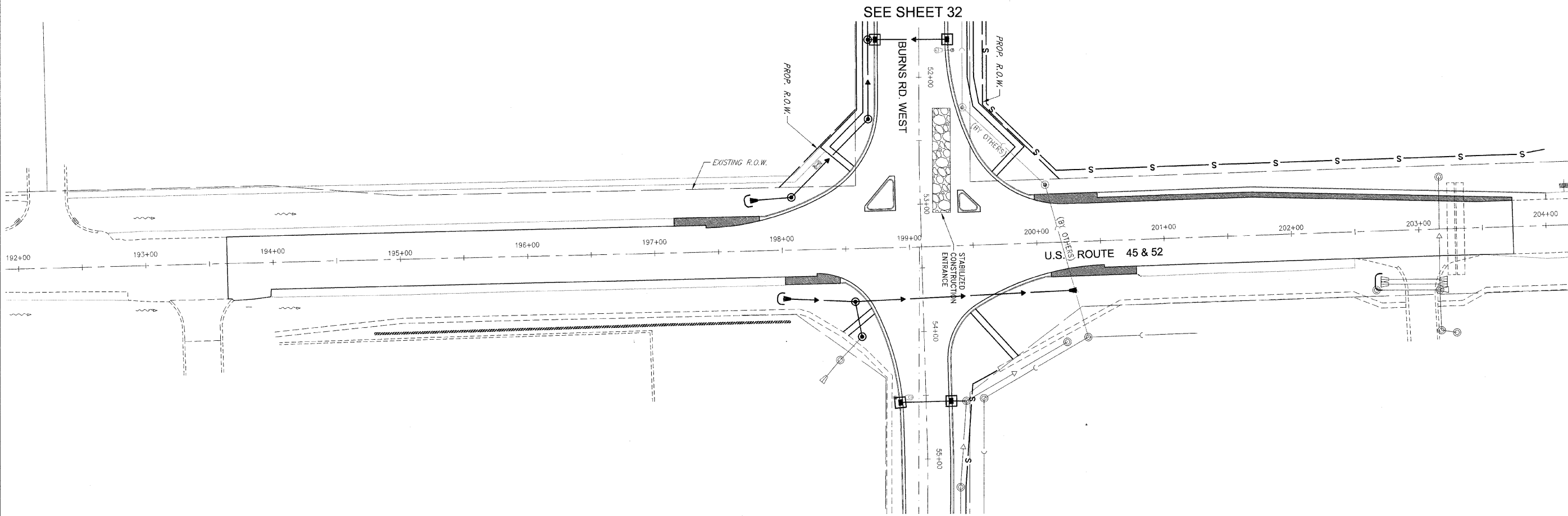

FAU. RFE.	SECTION	COUNTY	TOTAL SHEETS	SHEET NO.
*	**	KANKAKEE	41	33

CONTRACT NO. B7414
 FED. ROAD DIST. NO. ILLINOIS FED. AID PROJECT
 * BURNS ROAD WEST - FAU 6212
 ** 03-00058-00-FP

TYSON ENGINEERING, INC.
 CONSULTING CIVIL ENGINEERS
 LAND SURVEYORS
 DESIGN FIRM LICENSE #184-001136
 367 SOUTH SCHUYLER AVENUE
 KANKAKEE, ILLINOIS 60901
 PHONE (815) 932-7406

This document and the ideas and designs incorporated herein, as an instrument of professional service, is the property of Tyson Engineering Inc. and is not to be used in whole or in part, for any other project without written authorization of Tyson Engineering Inc.
 Do not scale drawings. Use dimensions only.
 Contractor shall be responsible for verifying all dimensions.
 Information hereon and herein is confidential.

REVISIONS			
NO.	DATE	BY	DESCRIPTION
1	3/12/07	MRG	PER IDOT REVIEW
2	4/13/07	MRG	PER IDOT REVIEW
3	4/9/09	MRG	PHASING
4	5/6/09	MRG	PER IDOT REVIEW

EROSION CONTROL PLAN

PROPOSED IMPROVEMENTS FOR
BURNS ROAD WEST
 FROM BURNING BUSH DRIVE
 TO U.S. ROUTE 45/52

SECTION
 03-00058-00-FP

DATE:	1/29/07	JOB NO.	E05055
SCALE:	HORZ.: 1"=40' VERT.: N/A	FILE NO.	
DRAWN BY:	MRG	SHEET	33
CHECKED BY:	SRM		41