

INDEX OF SHEETS

Sheet No.	Description
1	COVER SHEET
2	TYPICAL CROSS SECTION AND DETAILS
3	DETAILS & SCHEDULES

STATE OF ILLINOIS
DEPARTMENT OF TRANSPORTATION
COUNTY OF KANKAKEE
PLANS FOR PROPOSED
FEDERAL AID PROJECT ARA-1299(109)
F.A.S. 1299 (C.H.7) DESELM RD
SECTION 08-00041-04-RS JOB NO.C-93-141-09
AMERICAN REINVESTMENT & RECOVERY ACT OF 2009

F.A.S.ROUTE NO.	SEC.	COUNTY	NO.SHEETS	SHEET NO.
1299	*	Kankakee	3	1
ILLINOIS PROJECT ARA-1299(109)			CONTRACT NO. 87418	

* 08-00041-04-RS

KANKAKEE COUNTY

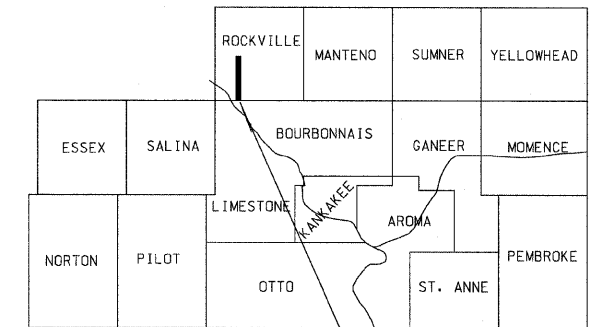

PROJECT LOCATION

STANDARDS

701301-03	LANE CLOSURE, 2L, 2W, SHORT TIME OPERATIONS
701306-02	LANE CLOSURE, 2L, 2W, SLOW MOVING OPERATIONS
701901-01	TRAFFIC CONTROL DEVICES

SUMMARY OF QUANTITIES

CODE NO.	DESCRIPTION	QUANTITY	UNIT
* 40600100	BITUMINOUS MATERIALS (PRIME COAT)	3963	GALLON
40600300	AGGREGATE (PRIME COAT)	81	TON
40600625	LEVELING BINDER (MACHINE METHOD), N50	2167	TON
40600982	HOT-MIX ASPHALT SURFACE REMOVAL - BUTT JOINT	220	SQ YD
40600990	TEMPORARY RAMP	14	SQ YD
* 40603310	HOT-MIX ASPHALT SURFACE CSE. MIX "C", N50	3314	TON
40800050	INCIDENTAL HOT-MIX ASPHALT SURFACING	110	TON
44000155	HOT-MIX ASPHALT SURFACE REMOVAL - 1 1/2"	507	SQ YD
* 48101200	AGGREGATE SHOULDERS, TYPE B	2209	TON
67100100	MOBILIZATION	1	L SUM
* 70100460	TRAFFIC CONTROL AND PROTECTION, STD 701306	1	L SUM
* 70300100	SHORT-TERM PAVEMENT MARKING	3458	FOOT

Construction Code I000
* Special Provisions

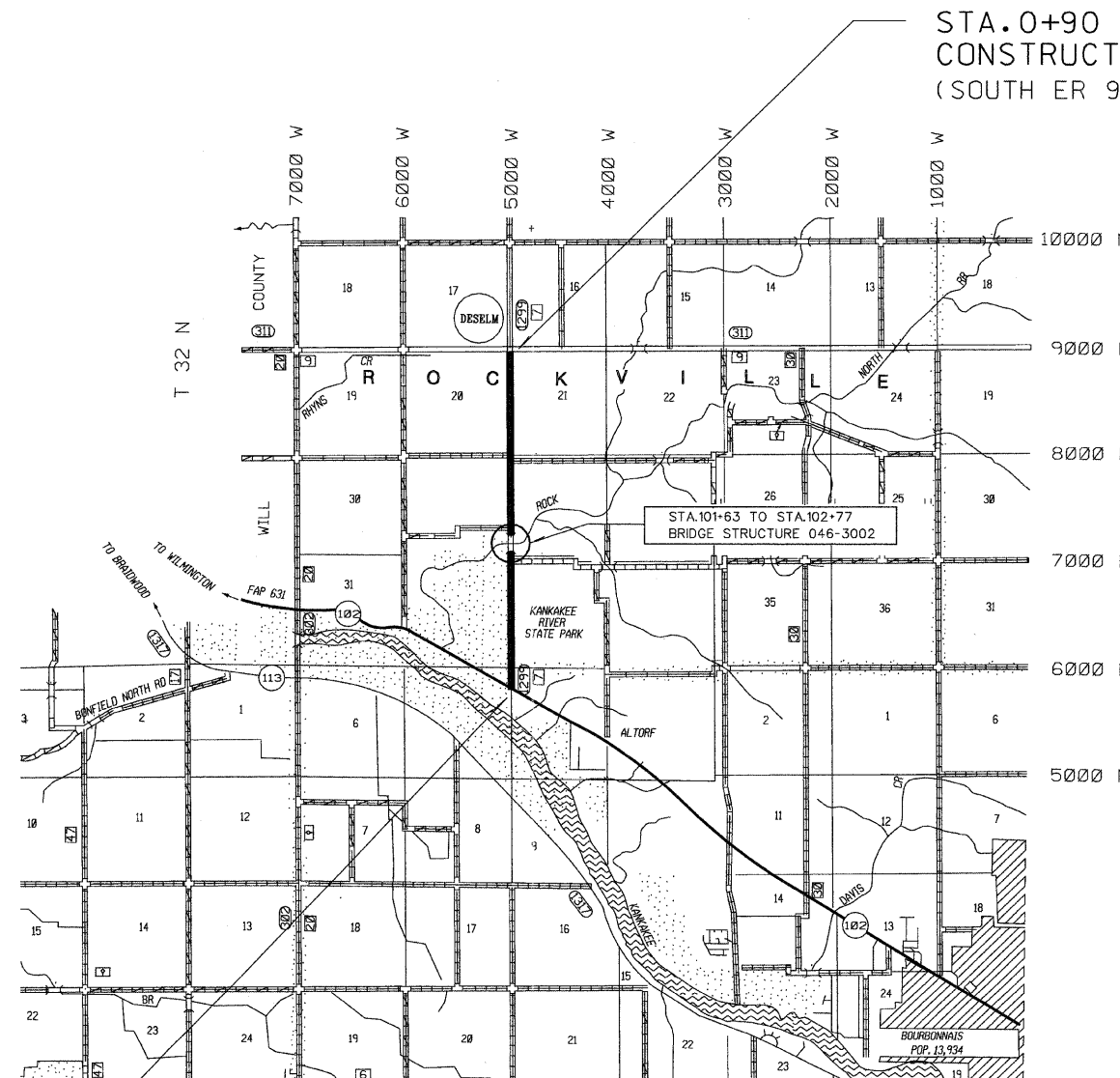

STA. 0+90
CONSTRUCTION STARTS
(SOUTH ER 9000N RD)

THE ACCEPTANCE OF THIS PROJECT IS BASED ON THE MINIMUM DESIGN CRITERIA FOR 3R GUIDELINES

CLASS III ROAD
CURRENT A.D.T. = 612
DESIGN A.D.T. = 637
DESIGN SPEED = 55 M.P.H.
ROADWAY CLASSIFICATION = COLLECTOR



CONTRACT NO. 87418

J.U.L.I.E. 1-800-892-0123

STA. 174+10
CONSTRUCTION ENDS
(SOUTH ER IL RT 102)

LOCATION MAP

GROSS & NET LENGTH = 17,320 LIN FT = 3.28 MILES

STATE OF ILLINOIS
DEPARTMENT OF TRANSPORTATION
DIVISION OF HIGHWAYS

Approved 5-11 2009

James W. Piekarczyk
JAMES W. PIEKARCZYK, P.E.
KANKAKEE COUNTY ENGINEER

Passed 05-21 2009

Kenneth R. Lang
KENNETH R. LANG
BUREAU CHIEF, LOCAL ROADS & STREETS

Releasing for Bid Based on Limited Review 05-21 2009

George F. Ryan
GEORGE F. RYAN
REGION 2 ENGINEER