

INDEX OF SHEETS

Sheet No.	Description
1	COVER SHEET
2	TYPICAL CROSS SECTION AND DETAILS
3	DETAILS & SCHEDULES

STATE OF ILLINOIS
DEPARTMENT OF TRANSPORTATION
COUNTY OF KANKAKEE
PLANS FOR PROPOSED
FEDERAL AID PROJECT ARA-1299(109)
F.A.S. 1299 (C.H.7) DESELM RD
SECTION 08-00041-04-RS JOB NO.C-93-141-09
AMERICAN REINVESTMENT & RECOVERY ACT OF 2009

F.A.S.ROUTE NO.	SEC.	COUNTY	NO.SHEETS	SHEET NO.
1299	*	Kankakee	3	1
ILLINOIS PROJECT ARA-1299(109)			CONTRACT NO. 87418	

* 08-00041-04-RS

KANKAKEE COUNTY

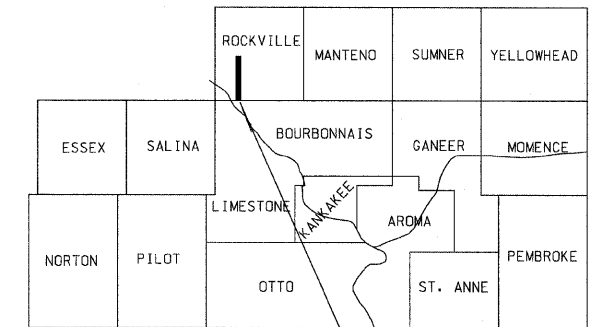

PROJECT LOCATION

STANDARDS

701301-03	LANE CLOSURE, 2L, 2W, SHORT TIME OPERATIONS
701306-02	LANE CLOSURE, 2L, 2W, SLOW MOVING OPERATIONS
701901-01	TRAFFIC CONTROL DEVICES

SUMMARY OF QUANTITIES

CODE NO.	DESCRIPTION	QUANTITY	UNIT
* 40600100	BITUMINOUS MATERIALS (PRIME COAT)	3963	GALLON
40600300	AGGREGATE (PRIME COAT)	81	TON
40600625	LEVELING BINDER (MACHINE METHOD), N50	2167	TON
40600982	HOT-MIX ASPHALT SURFACE REMOVAL - BUTT JOINT	220	SQ YD
40600990	TEMPORARY RAMP	14	SQ YD
* 40603310	HOT-MIX ASPHALT SURFACE CSE. MIX "C", N50	3314	TON
40800050	INCIDENTAL HOT-MIX ASPHALT SURFACING	110	TON
44000155	HOT-MIX ASPHALT SURFACE REMOVAL - 1 1/2"	507	SQ YD
* 48101200	AGGREGATE SHOULDERS, TYPE B	2209	TON
67100100	MOBILIZATION	1	L SUM
* 70100460	TRAFFIC CONTROL AND PROTECTION, STD 701306	1	L SUM
* 70300100	SHORT-TERM PAVEMENT MARKING	3458	FOOT

Construction Code I000

* Special Provisions

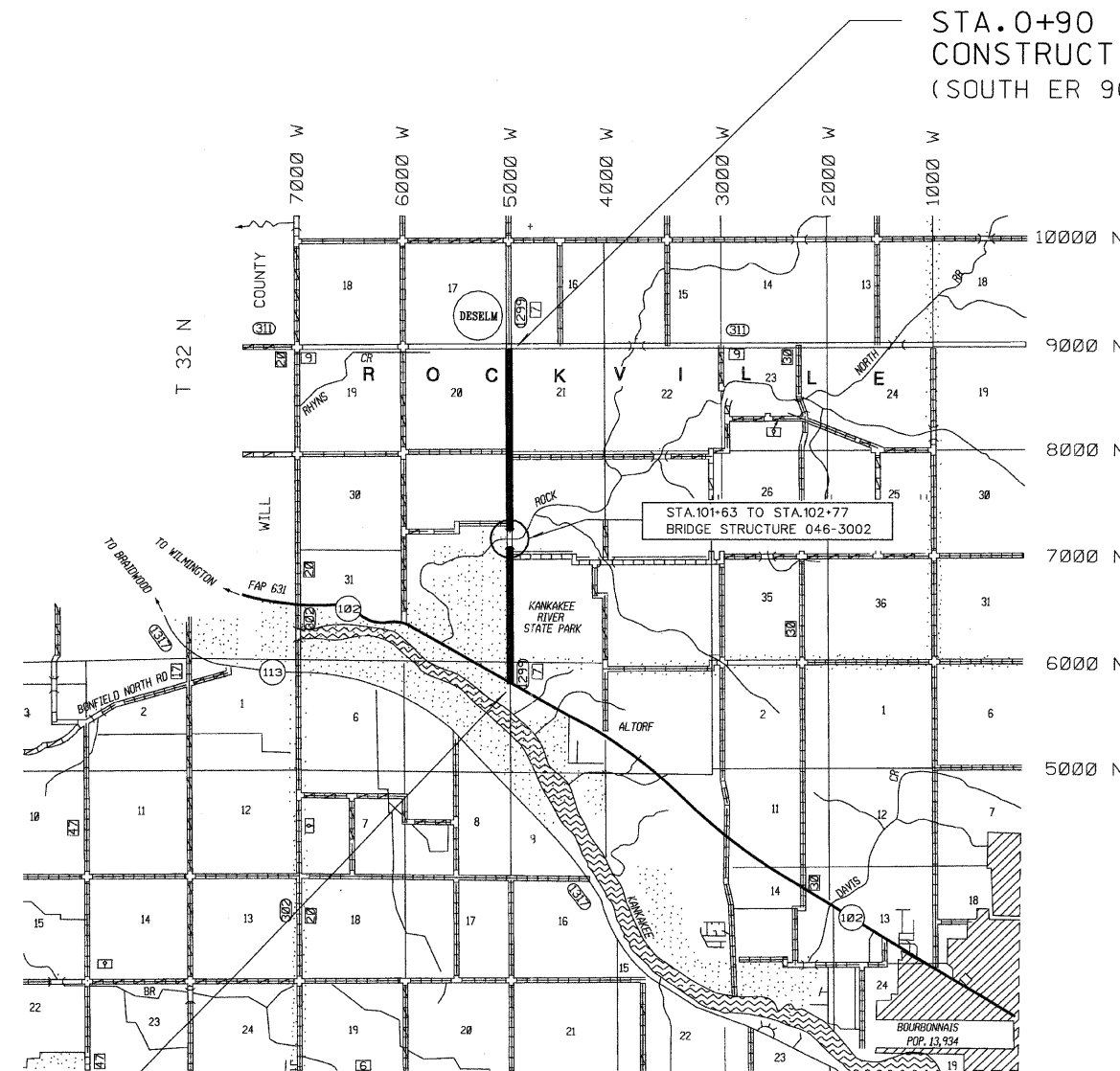

STA.0+90
CONSTRUCTION STARTS
(SOUTH ER 9000N RD)

THE ACCEPTANCE OF THIS PROJECT IS BASED ON THE MINIMUM DESIGN CRITERIA FOR 3R GUIDELINES

CLASS III ROAD
CURRENT A.D.T. = 612
DESIGN A.D.T. = 637
DESIGN SPEED = 55 M.P.H.
ROADWAY CLASSIFICATION = COLLECTOR

CONTRACT NO. 87418

J.U.L.I.E. 1-800-892-0123

STA.174+10
CONSTRUCTION ENDS
(SOUTH ER IL RT 102)

LOCATION MAP

GROSS & NET LENGTH = 17,320 LIN FT = 3.28 MILES

STATE OF ILLINOIS
DEPARTMENT OF TRANSPORTATION
DIVISION OF HIGHWAYS

Approved 5-11 2009

James W. Piekarczyk
JAMES W. PIEKARCZYK, P.E.
KANKAKEE COUNTY ENGINEER

Passed 05-21 2009

Kenneth R. Lang
KENNETH R. LANG
BUREAU CHIEF, LOCAL ROADS & STREETS

Releasing for Bid Based on Limited Review 05-21 2009

George F. Ryan
GEORGE F. RYAN
REGION 2 ENGINEER

TYPICAL ENTRANCE DETAIL

W : WIDTH OF APPROACH PADS IS ESTIMATED AT 20' PER ENTRANCE . THE ACTUAL CONSTRUCTED WIDTH MAY VARY AS DIRECTED BY THE ENGINEER TO FIT THE EXISTING ENTRANCES .
FIELD ENTRANCES SHALL NOT RECEIVE HOT-MIX ASPHALT SURFACING UNLESS DIRECTED BY THE ENGINEER.

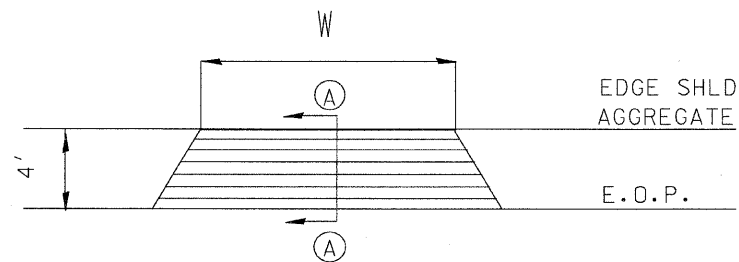

EDGE SHLD AGGREGATE

E.O.P.

CH.7

SECTION A-A

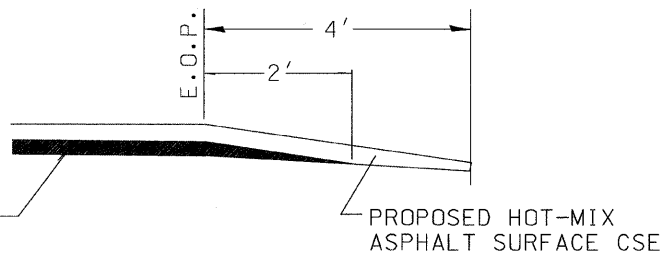

PROPOSED LEVELING BINDER

PROPOSED HOT-MIX ASPHALT SURFACE CSE

ESTIMATED QUANTITIES- 38 ENTRANCES		
ITEM	UNIT	QUANTITY
BITUMINOUS MATERIALS (PRIME COAT)	GAL	38
LEVELING BINDER (MM) N50	TON	19
HOT-MIX ASPHALT SURFACE CSE MIX C, N50	TON	38

TYPICAL MAILBOX TURNOUT DETAIL

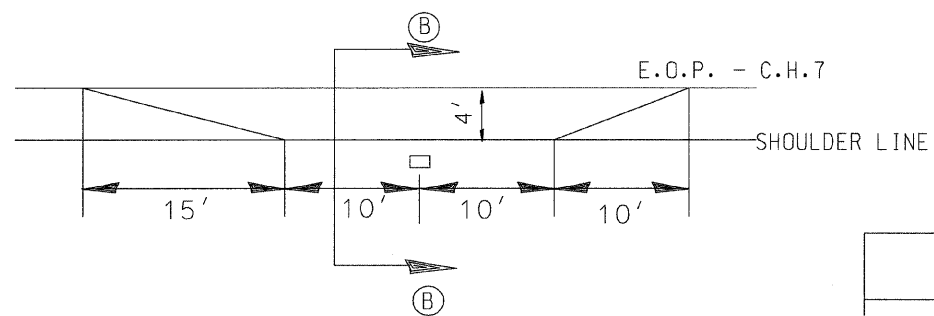

E.O.P. - C.H.7

SHOULDER LINE

SECTION B-B

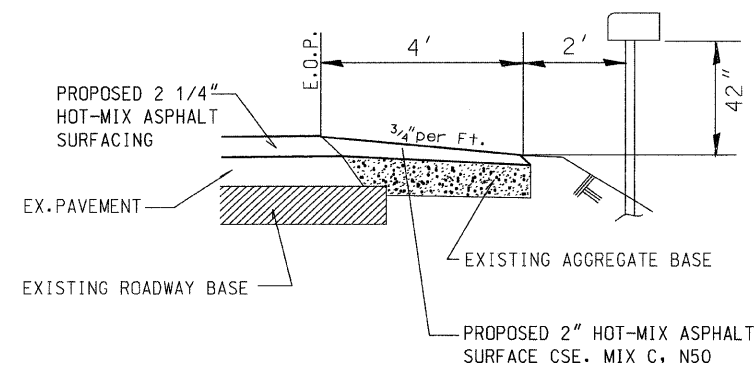

PROPOSED 2 1/4" HOT-MIX ASPHALT SURFACING

EX.PAVEMENT

EXISTING ROADWAY BASE

EXISTING AGGREGATE BASE

PROPOSED 2" HOT-MIX ASPHALT SURFACE CSE. MIX C, N50

ESTIMATED QUANTITIES - 21 MAILBOX TURNOUTS		
ITEM	UNIT	QUANTITY
BIT. MATERIALS (PRIME COAT)	GAL	21
HOT-MIX ASPHALT SURFACE CSE MIX C N50	TON	42

ALL MBTO'S HAVE BEEN PREVIOUSLY CONSTRUCTED AND SHALL RECEIVE HMA SURFACING ONLY.

SECTION	COUNTY	TOTAL SHEETS	SHEET NO.
08-00041-04-RS	KANKAKEE	3	2
CONTRACT NO. 87418			

TYPICAL CROSS SECTION

STA.0+90 TO STA.174+10

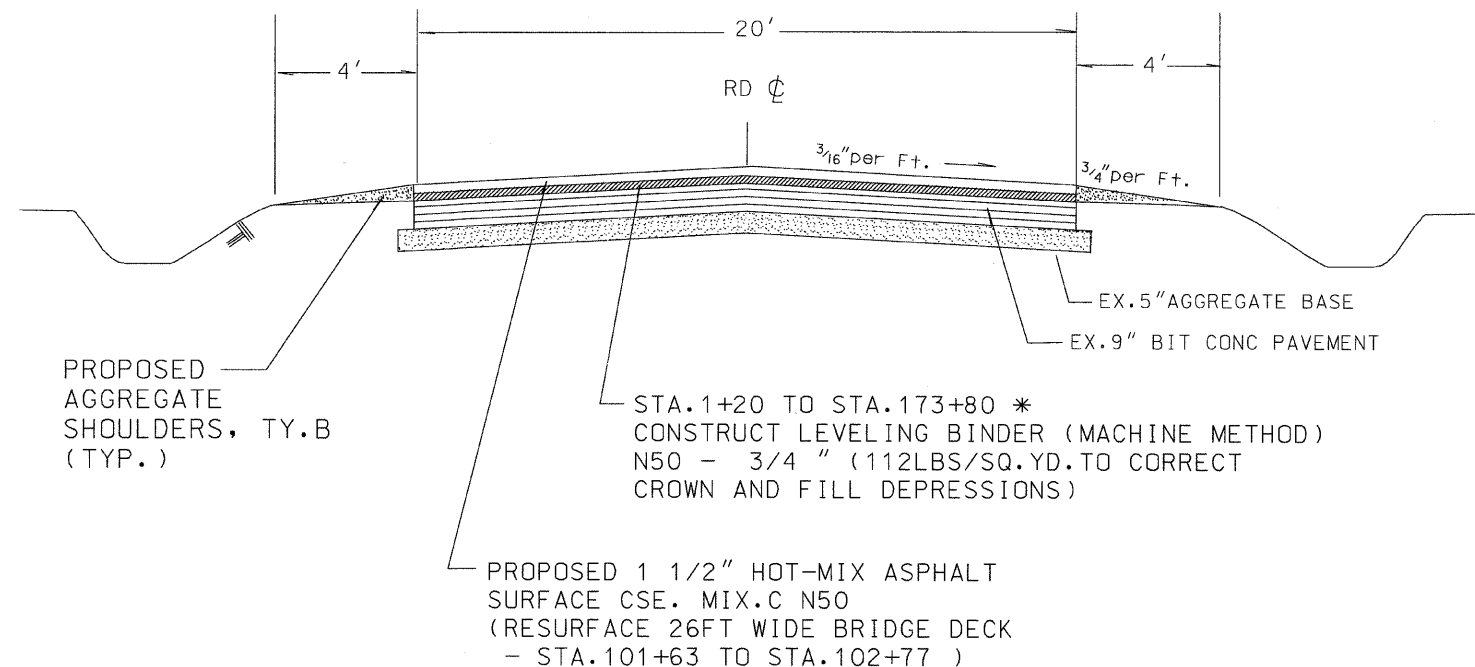

PROPOSED AGGREGATE SHOULDERS, TY.B (TYP.)

STA.1+20 TO STA.173+80 *
CONSTRUCT LEVELING BINDER (MACHINE METHOD) N50 - 3/4" (112LBS/SQ.YD. TO CORRECT CROWN AND FILL DEPRESSIONS)

PROPOSED 1 1/2" HOT-MIX ASPHALT SURFACE CSE. MIX.C N50 (RESURFACE 26FT WIDE BRIDGE DECK - STA.101+63 TO STA.102+77)

* LEVELING BINDER OMISSION:
STA.101+63 TO STA.102+77 (BRIDGE DECK)

ESTIMATED QUANTITIES ON TANGENTS

ITEM	UNIT	QUANTITY
AGGREGATE SHOULDERS TY.B	TON	2209
BITUMINOUS MATERIALS (PRIME COAT)	GALLON	3869
AGGREGATE (PRIME COAT)	TON	77
HOT-MIX ASPHALT SURFACE CSE MIX C, N50	TON	3234
LEVELING BINDER (MM) N50	TON	2148
SHORT-TERM PAVEMENT MARKING	FOOT	3458

INTERSECTION DETAIL

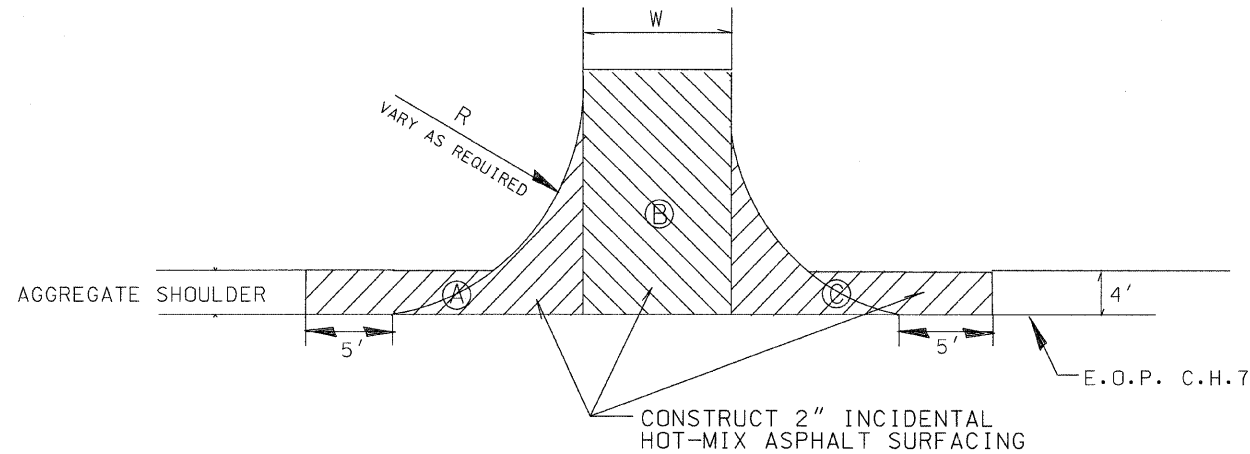

SECTION	COUNTY	TOTAL SHEETS	SHEET NO.
08-00041-04-RS	KANKAKEE	3	3
CONTRACT NO. 87418			

PAVEMENT REMOVAL DETAILS

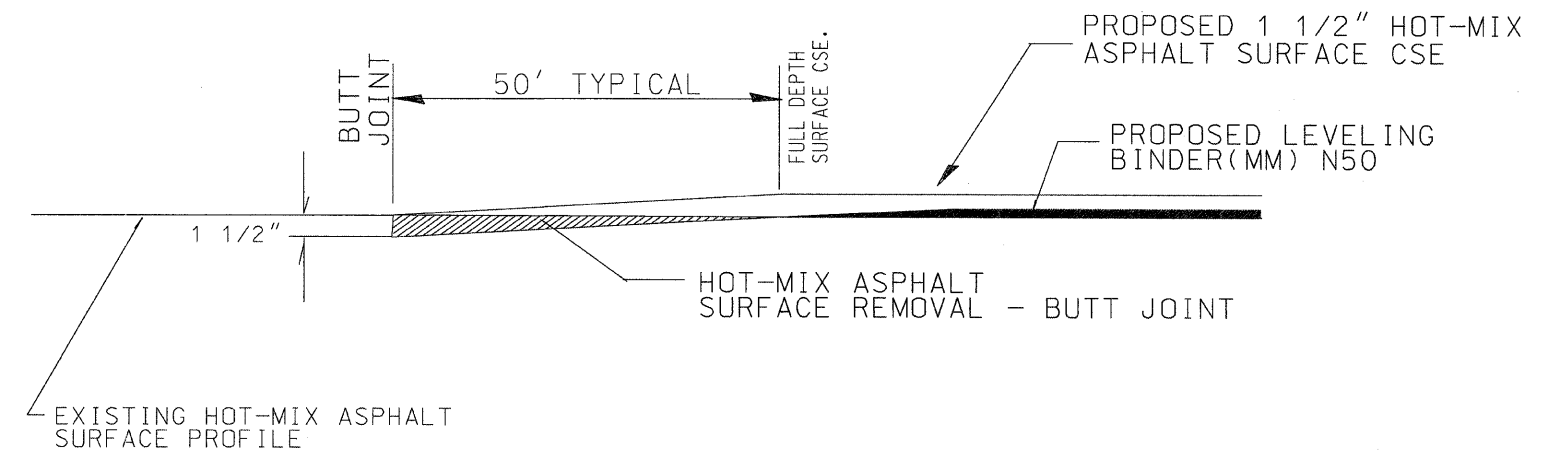

INTERSECTION QUANTITY SCHEDULE

STATION	AREA	WIDTH	RADIUS	INCIDENTAL HMA SURFACING (TON)	BIT. MATRLS. (PRIME COAT) (GAL)	AGGREGATE (PRIME COAT) (TON)	LOCATION
0+90	A C	20	30	20	5	0.5	9000N
52+60RT	A B C	18	30	15	5	0.5	8000N
55+79LT	A B C	18	30	15	5	0.5	7940N
88+03RT	A B C	18	30	15	5	0.5	7340N
105+76LT	A B C	18	30	15	5	0.5	7000N
132+50RT	A B C	18	30	10	5	0.5	PARK INT. STABLES
174+10	A C	20	30	20	5	1	IL RT 102
TOTALS				110	35	4	

STATION	HMA SURFACE REMOVAL - BUTT JOINT	HMA SURFACE REMOVAL - 1 1/2'	TEMPORARY RAMP (3' Wide)
0+90	110		7
101+23 TO 103+17*		507	
174+10	110		7
TOTALS	220 SQ YD	507 SQ YD	14 SQ YD

* INCLUDES 40' APPROACH TAPER NORTH AND SOUTH FROM THE END OF THE BRIDGE DECK

Pavement Design Data

Design Period = 8 Years

ADT = 612 (2009) 663 (2019)

P.V. = 96% = 612 S.U. = 3% = 19 M.U. = 1% = 6

T.F. = 0.02

S.N. = 2.30

Pavement Structure Number

Ex. 5" AGGREGATE BASE (crushed) 5 x 0.08 = 0.40

Ex. 6" CL.B 6 x 0.17 = 1.02

Ex. 3" CLASS I 3 x 0.23 = 0.69

Prop. 2.25" HMA Surface Cse. 2.25 x 0.40 = 0.80

3.01

Marshall Stability \geq 1700

HMA MIXTURE REQUIREMENTS

	LEVEL BINDER	HMA SURFACE
PG GRADE	PG58-22	PG58-22
MAX % RAP ALLOWABLE**	SEE SPECIAL PROVISION	SEE SPECIAL PROVISION
DESIGN AIR VOIDS	4.0%	4.0%
MIXTURE COMPOSITION	IL 9.5	IL 9.5
FRICTION AGGREGATE	MIXTURE C	MIXTURE C
DENSITY TEST METHOD	SATISFACTION OF THE ENGINEER	CORRELATION

** IF RAP OPTION IS SELECTED, THE ASPHALT CEMENT GRADE MAY NEED TO BE ADJUSTED. THIS WILL BE DETERMINED BY THE ENGINEER.

GENERAL NOTES:

- IT SHALL BE THE CONTRACTOR'S RESPONSIBILITY TO DETERMINE THE ACTUAL LOCATION OF ALL UTILITY LOCATIONS .
- PERMANENT PAVEMENT MARKINGS TO BE INSTALLED BY THE KANKAKEE COUNTY HIGHWAY DEPT.
- FLAGMEN SHALL BE REQUIRED DURING PRIMING OPERATIONS.
- "BUMP SIGNS" SHALL BE REQUIRED AT ALL TANGENT HOT-MIX ASPHALT SURFACE REMOVAL - BUTT JOINT LOCATIONS. THE COST SHALL BE CONSIDERED AS INCLUDED IN THE TRAFFIC CONTROL PAY ITEM.
- FURNISH EXCAVATION & LANDSCAPING AT SIDE ROADS AND ENTRANCES SHALL BE CONSTRUCTED BY THE KANKAKEE COUNTY HIGHWAY DEPT.