

RTE NO.	SECTION	COUNTY	TOTAL	SHEET #
FA 646	125W-1, RS-2	PEORIA	256	56

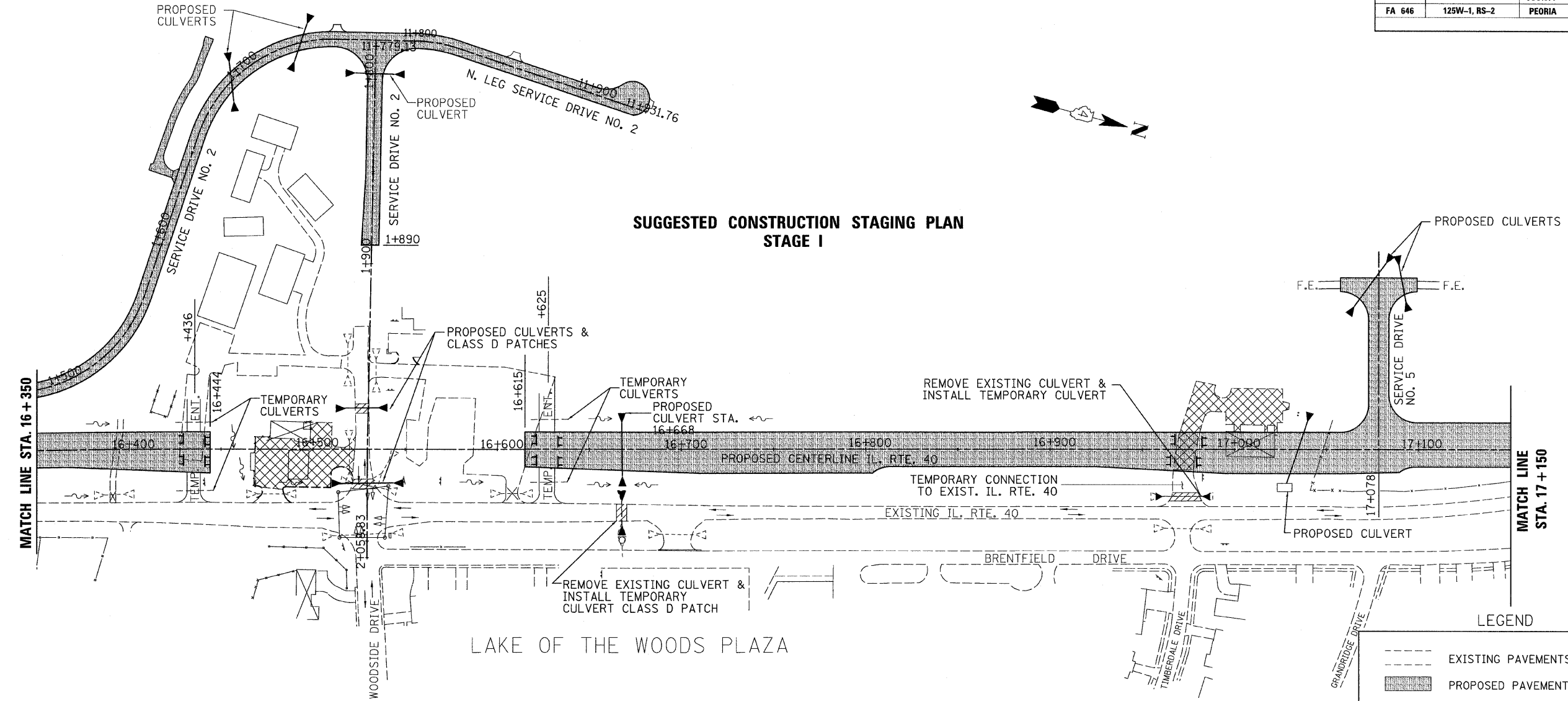

LAKE OF THE WOODS PLAZA

LEGEND

	EXISTING PAVEMENTS
	PROPOSED PAVEMENTS
	PREVIOUSLY CONSTRUCTED PAVEMENT
	EXISTING ENTRANCE TO BE CLOSED
	EXISTING ENTRANCE TO REMAIN
	PROPOSED ENTRANCE
	TRAFFIC FLOW
	TYPE III BARRICADE
	EXISTING CULVERT
	PROPOSED CULVERT
	PREVIOUSLY CONSTRUCTED CULVERT
	BUILDING REMOVAL
	PAVEMENT REMOVAL

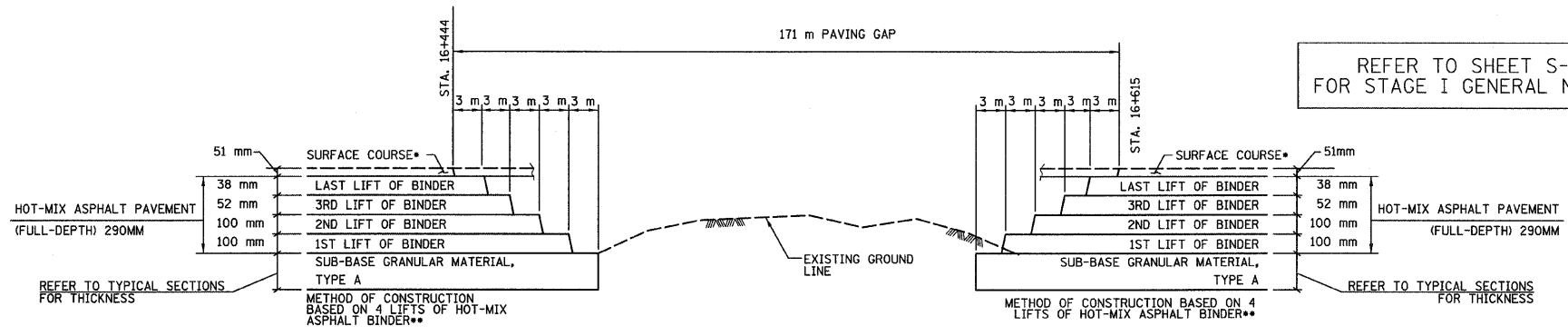

SUGGESTED METHOD OF CONSTRUCTION AT THE GAP STA 16+444 TO 16+615

NOTE: THE LIFT THICKNESS OF BINDER COURSE SHALL ALSO BE MODIFIED BY THE PROVISIONS OF ITEM 9 ON SHEET S-2.

- * TO BE PLACED DURING STAGE IV AFTER THE BINDER IN THE GAP HAS BEEN COMPLETED.
- ** LIFT THICKNESSES MAY BE VARIED AS DESIRED BY THE CONTRACTOR WITHIN THE LIMITS SET FORTH BY THE STANDARD SPECIFICATIONS AND THESE CONTRACT DOCUMENTS.

REVISIONS	
NAME	DATE

ILLINOIS DEPARTMENT OF TRANSPORTATION
**STAGE CONSTRUCTION
 ILLINOIS ROUTE 40
 STAGE I**

SCALE: NONE
 DATE: 03/13/09
 DRAWN BY: JRC, JDU
 CHECKED BY: ECM