

RTE NO.	SECTION	COUNTY	TOTAL	SHEET #
FA 646	125W-1, RS-2	PEORIA	256	58

**SUGGESTED CONSTRUCTION STAGING PLAN
STAGE II**

**STAGE II
GENERAL NOTES**

ALL TRAFFIC TO REMAIN ON EXISTING IL. RTE. 40

STAGE II MAY BE STARTED ANY TIME AFTER THE TEMPORARY ENTRANCES AT STATION 16+267, 16+436 AND 16+625 ARE COMPLETED, SEE ITEM NO. 12 IN STAGE I.

- CLOSE WOODSIDE DRIVE WEST. PLACE TYPE III BARRICADES ACROSS WOODSIDE DRIVE AT THE WEST EDGE OF IL. RTE. 40 PAVEMENT. REMOVE EXISTING PAVEMENTS AS SHOWN ON THE REMOVAL PLANS.
- PLACE TYPE I OR II BARRICADES ACROSS THE FULL-DEPTH HOT-MIX ASPHALT PAVEMENT BOTH SIDES OF ALL THREE TEMPORARY ENTRANCES TO PROHIBIT TRAFFIC ON THE COMPLETED PORTIONS OF PAVEMENT.
- COMPLETE THE EARTHWORK, CULVERT SUB-BASE GRANULAR MATERIAL, FULL-DEPTH HOT-MIX ASPHALT PAVEMENT, HOT-MIX ASPHALT BASE COURSE, HOT-MIX ASPHALT BINDER COURSE AND HOT-MIX ASPHALT SHOULDERS FOR IL. RTE. 40, STATION 16+444 TO 16+615 AND FOR SERVICE DRIVE NO. 2 WEST, FROM STATION 1+890 EASTERLY TO THE WEST EDGE OF EXISTING IL. RTE. 40.
- CONSTRUCT THE TRAFFIC SIGNAL SYSTEM FOR THIS INTERSECTION. THE EXISTING SIGNALS SHALL REMAIN IN PLACE UNTIL TRAFFIC IS SWITCHED TO THE RELOCATION. SEE TRAFFIC SIGNAL PLANS FOR DETAILS.
- PLACE SHORT TERM AND TEMPORARY PAVEMENT MARKINGS ON THE NEW AND WIDENED PAVEMENT CONSTRUCTED IN STAGES I AND II FOR ITS ENTIRE LENGTH.
- OPEN THE NEW PAVEMENTS TO TRAFFIC. TWO LANES OF TRAFFIC, ONE EACH DIRECTION SHALL BE MAINTAINED THROUGH THE NARROW PORTION OF PAVEMENT: STA. 17+600 TO 17+900. RIGHT AND LEFT TURN LANES SHALL BE PROVIDED AT CEDAR HILLS DRIVE. FOUR LANES OF TRAFFIC, TWO LANES EACH DIRECTION SHALL BE PROVIDED FROM THE BEGINNING OF THE PROJECT TO THE TRANSITION FROM FOUR LANES TO TWO LANES SOUTH OF STATION 17+100 (STANDARD 701606).
- OPEN WOODSIDE DRIVE, EAST AND SERVICE DRIVE NO. 2, WEST. REMOVE THE TEMPORARY ENTRANCES AND CULVERTS AT COMMERCIAL 16+267±, 16+436± AND 16+625±. CLOSE THE ACCESS ROAD FROM OLD IL. RTE. 40 TO LAKE OF THE WOODS PLAZA, RT. STATION 16+700±. OPEN THE TEMPORARY CONNECTION BETWEEN THE NEW PAVEMENT AND OLD IL. RTE. 40 RT. STATION 16+973±.

NOTE: REFER TO THE SUGGESTED CONSTRUCTION STAGING PLAN, STAGE III FOR TRAFFIC FLOW PRIOR TO BEGINNING STAGE III.

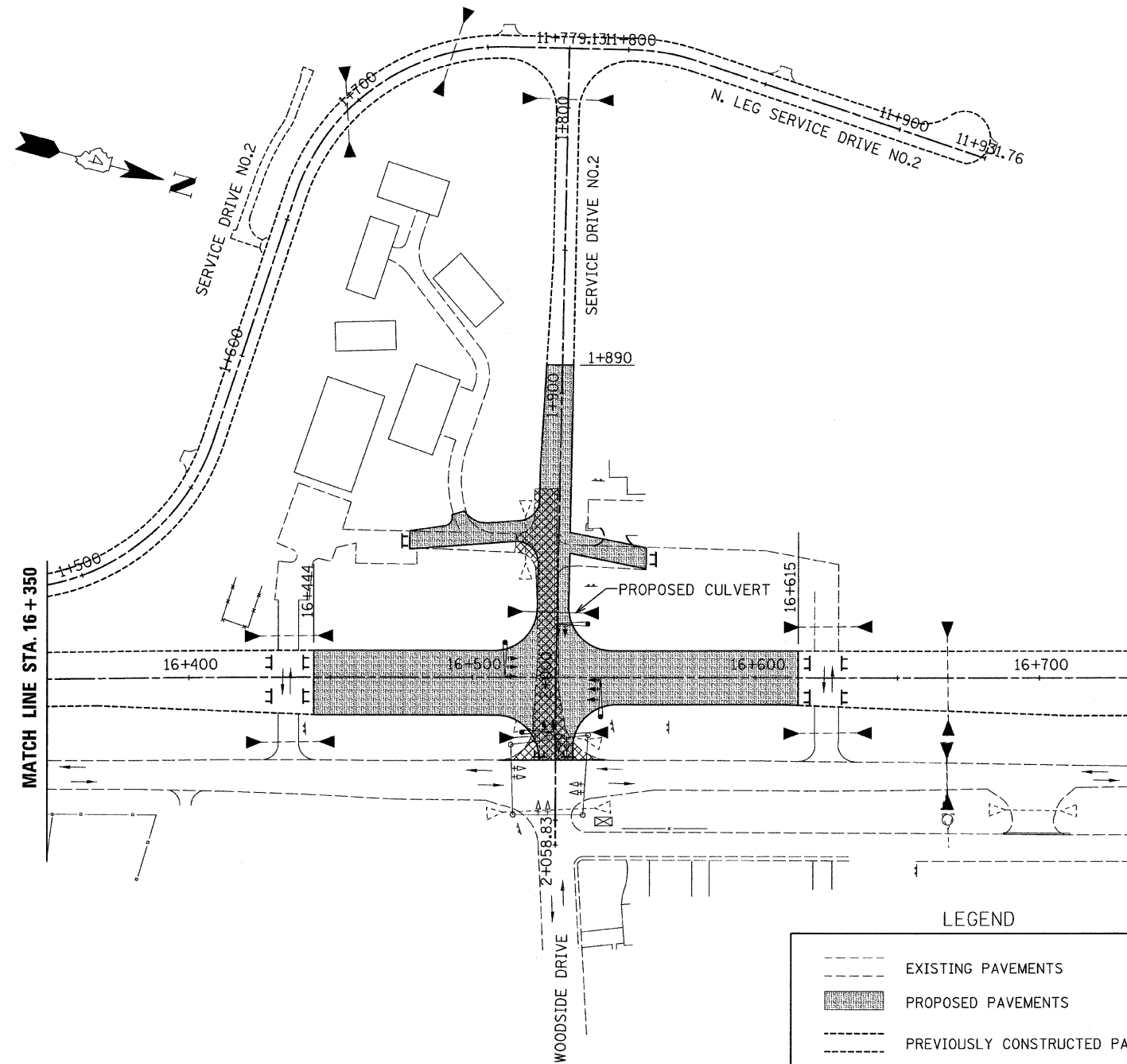

LEGEND

	EXISTING PAVEMENTS
	PROPOSED PAVEMENTS
	PREVIOUSLY CONSTRUCTED PAVEMENT
	EXISTING ENTRANCE TO BE CLOSED
	EXISTING ENTRANCE TO REMAIN
	PROPOSED ENTRANCE
	TRAFFIC FLOW
	TYPE III BARRICADE
	EXISTING CULVERT
	PROPOSED CULVERT
	PREVIOUSLY CONSTRUCTED CULVERT
	BUILDING REMOVAL
	PAVEMENT REMOVAL

REVISIONS	
NAME	DATE

ILLINOIS DEPARTMENT OF TRANSPORTATION
**STAGE CONSTRUCTION
ILLINOIS ROUTE 40
STAGE II**

SCALE: NONE
DATE: 3/13/09

DRAWN BY: JRC, JDU
CHECKED BY: ECM

S-5