

RTE NO.	SECTION	COUNTY	TOTAL	SHEET #
FA 646	125W-1, RS-2	PEORIA	256	60

**SUGGESTED CONSTRUCTION STAGING PLAN
STAGE III**

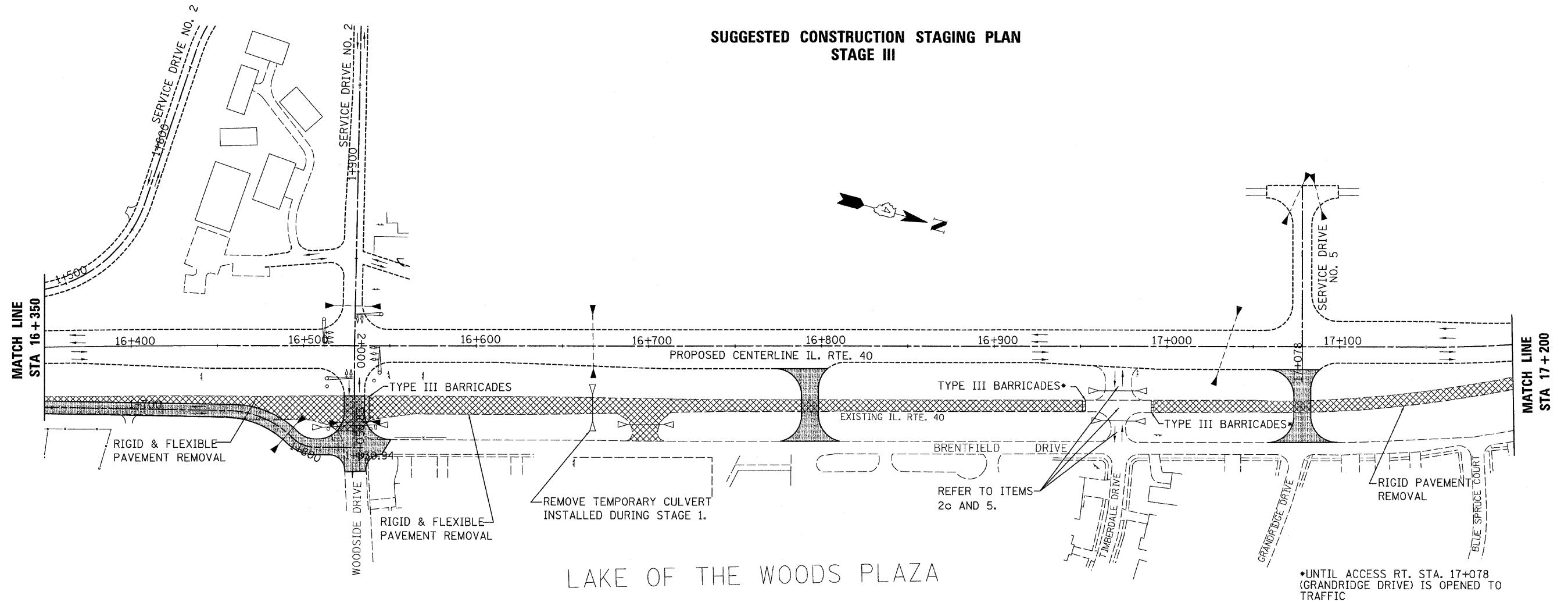

REFER TO SHEET S-6
FOR STAGE III GENERAL NOTES

LEGEND

	EXISTING PAVEMENTS
	PROPOSED PAVEMENTS
	PREVIOUSLY CONSTRUCTED PAVEMENT
	EXISTING ENTRANCE TO BE CLOSED
	EXISTING ENTRANCE TO REMAIN
	PROPOSED ENTRANCE
	TRAFFIC FLOW
	TYPE III BARRICADE
	EXISTING CULVERT
	PROPOSED CULVERT
	PREVIOUSLY CONSTRUCTED CULVERT
	BUILDING REMOVAL
	PAVEMENT REMOVAL

*UNTIL ACCESS RT. STA. 17+078 (GRANDRIDGE DRIVE) IS OPENED TO TRAFFIC

REVISIONS	
NAME	DATE

ILLINOIS DEPARTMENT OF TRANSPORTATION
**STAGE CONSTRUCTION
ILLINOIS ROUTE 40
STAGE III**

SCALE: NONE
DATE: 03/13/09
DRAWN BY: JRC, JDU
CHECKED BY: ECM

S-7