

RTE NO.	SECTION	COUNTY	TOTAL	SHEET NO.
FA 646	125W-1, RS-2	PEORIA	256	64

**CEDAR HILLS DRIVE  
(EAST) PHASE V  
CONSTRUCTION**

PHASE V  
GENERAL NOTES

1. PHASE V MAY BEGIN WHEN CEDAR HILLS DRIVE (WEST) RELOCATION AND SERVICE DRIVE NO. 3 CONNECTION ARE READY TO OPEN TO TRAFFIC.
2. REVISE THE TRAFFIC CONTROL AND TEMPORARY PAVEMENT MARKINGS AS SHOWN.
3. CLOSE EXISTING CEDAR HILLS DRIVE (WEST) AT IL. RTE. 40 AND OPEN THE TEMPORARY RUN-AROUND.
4. REMOVE THE FLEXIBLE PAVEMENT AND REMAINING PORTION OF THE EXISTING CULVERT. CONSTRUCT THE HOT-MIX ASPHALT CONCRETE PAVEMENT (FULL-DEPTH), BASE COURSE OR WIDENING AND THE 1.2 m WIDE HOT-MIX ASPHALT SHOULDERS.

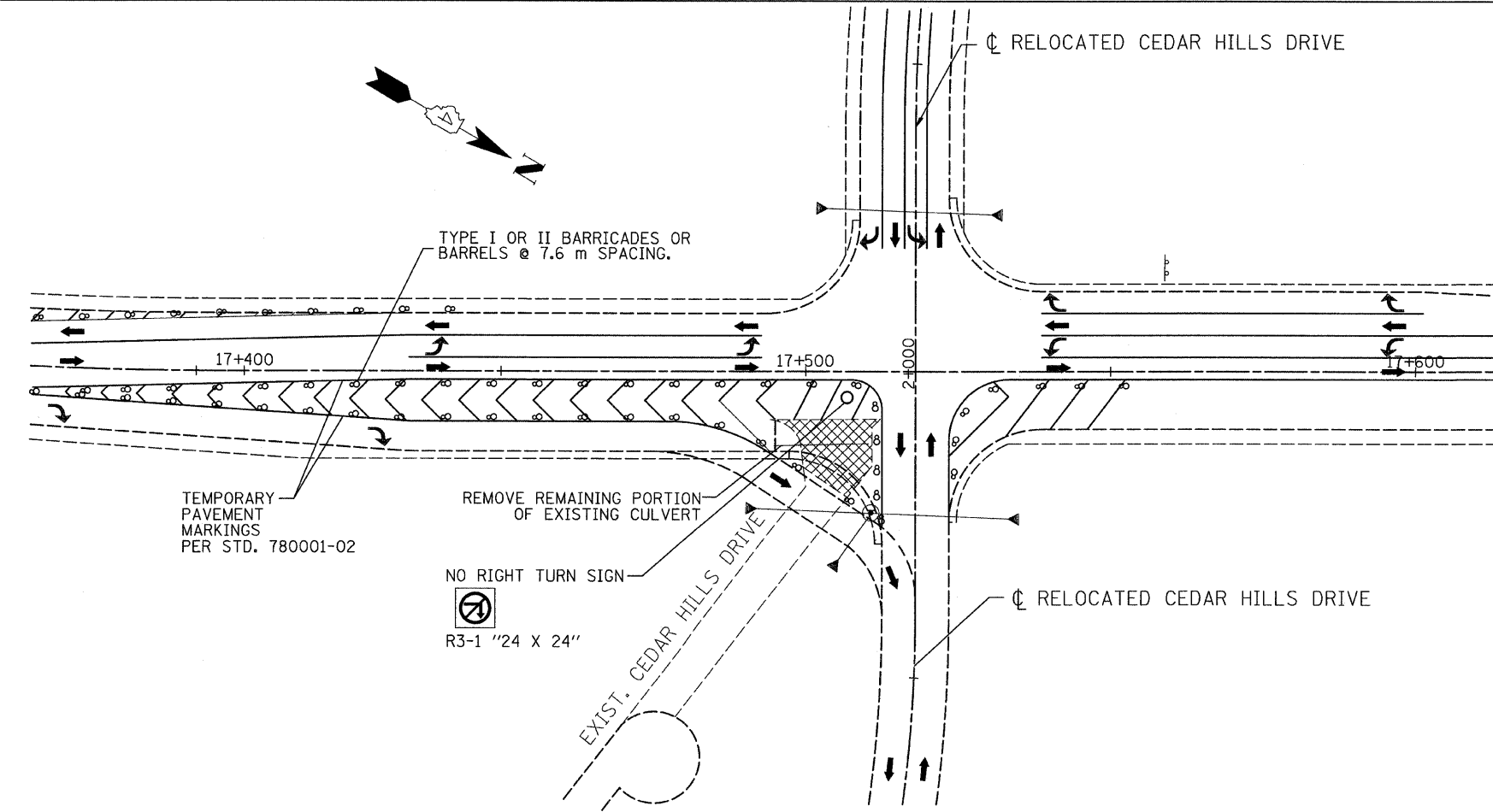

**CEDAR HILLS DRIVE  
(EAST) PHASE VI  
CONSTRUCTION**

PHASE VI  
GENERAL NOTES

1. IL RTE. 40 TRAFFIC USING ALL FOUR LANES AND THE DEDICATED LEFT AND RIGHT TURN LANES.
2. REMOVE THE TEMPORARY RUN-AROUND.
3. REMOVE THE FLEXIBLE PAVEMENT OF CEDAR HILLS DRIVE (WEST) EASTERLY TO THE CUL-DE-SAC, FINISH EARTHWORK OPERATIONS, AND CONSTRUCT THE CUL-DE-SAC.

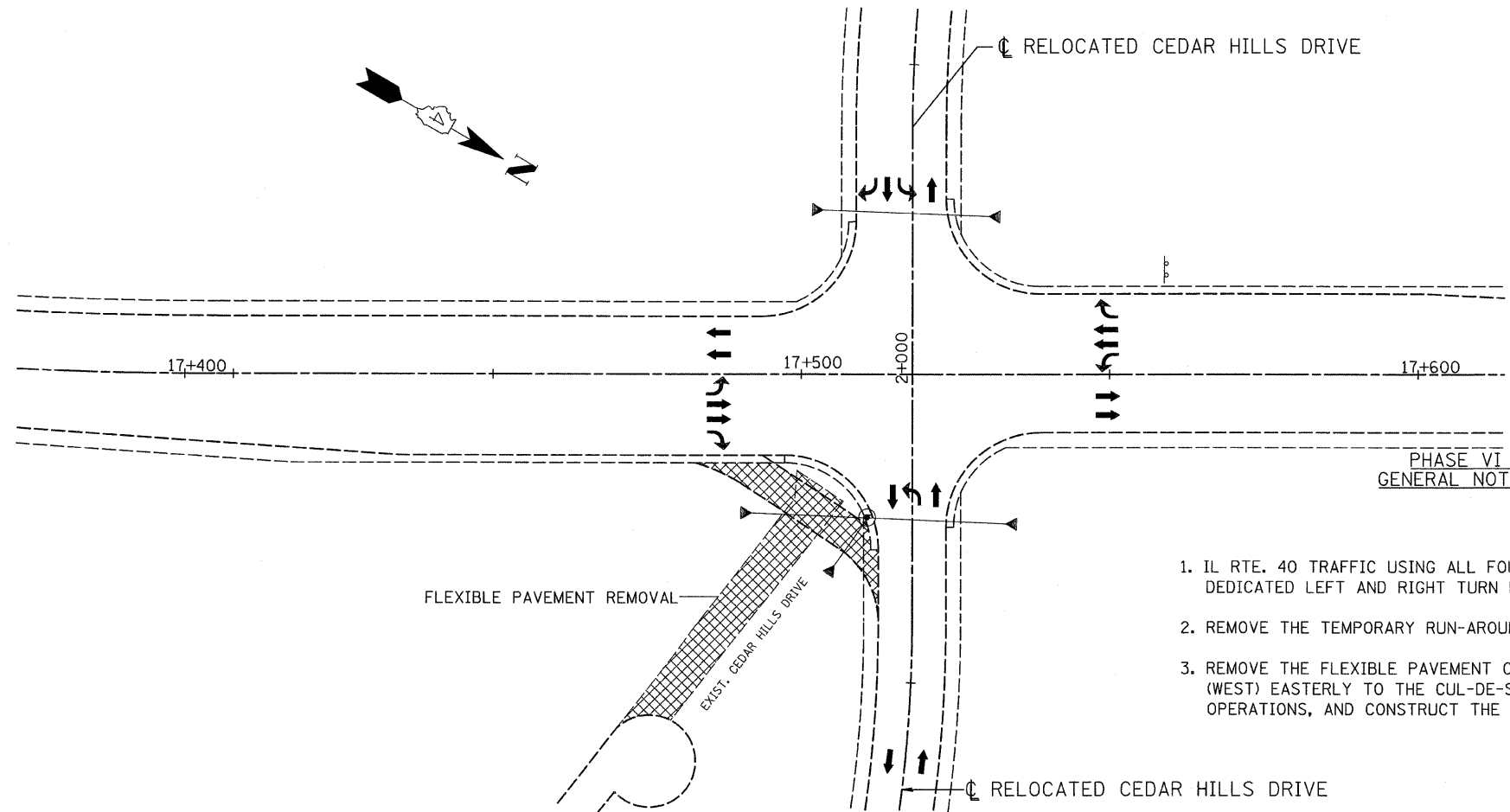

**LEGEND**

	EXISTING PAVEMENTS
	PROPOSED PAVEMENTS
	PREVIOUSLY CONSTRUCTED PAVEMENT
	EXISTING ENTRANCE TO BE CLOSED
	EXISTING ENTRANCE TO REMAIN
	PROPOSED ENTRANCE
	TRAFFIC FLOW
	TYPE III BARRICADE
	EXISTING CULVERT
	PROPOSED CULVERT
	PREVIOUSLY CONSTRUCTED CULVERT
	BUILDING REMOVAL
	PAVEMENT REMOVAL

REVISIONS	
NAME	DATE

ILLINOIS DEPARTMENT OF TRANSPORTATION

**STAGE CONSTRUCTION  
ILLINOIS ROUTE 40**

SCALE: NONE  
DATE: 03/13/09

DRAWN BY: JRC, JDU  
CHECKED BY: ECM