

RTE NO.	SECTION	COUNTY	TOTAL	SHEET #
FA 646	125W-1,RS-2	PEORIA	256	86
STATION 2+050 TO STATION 2+275				

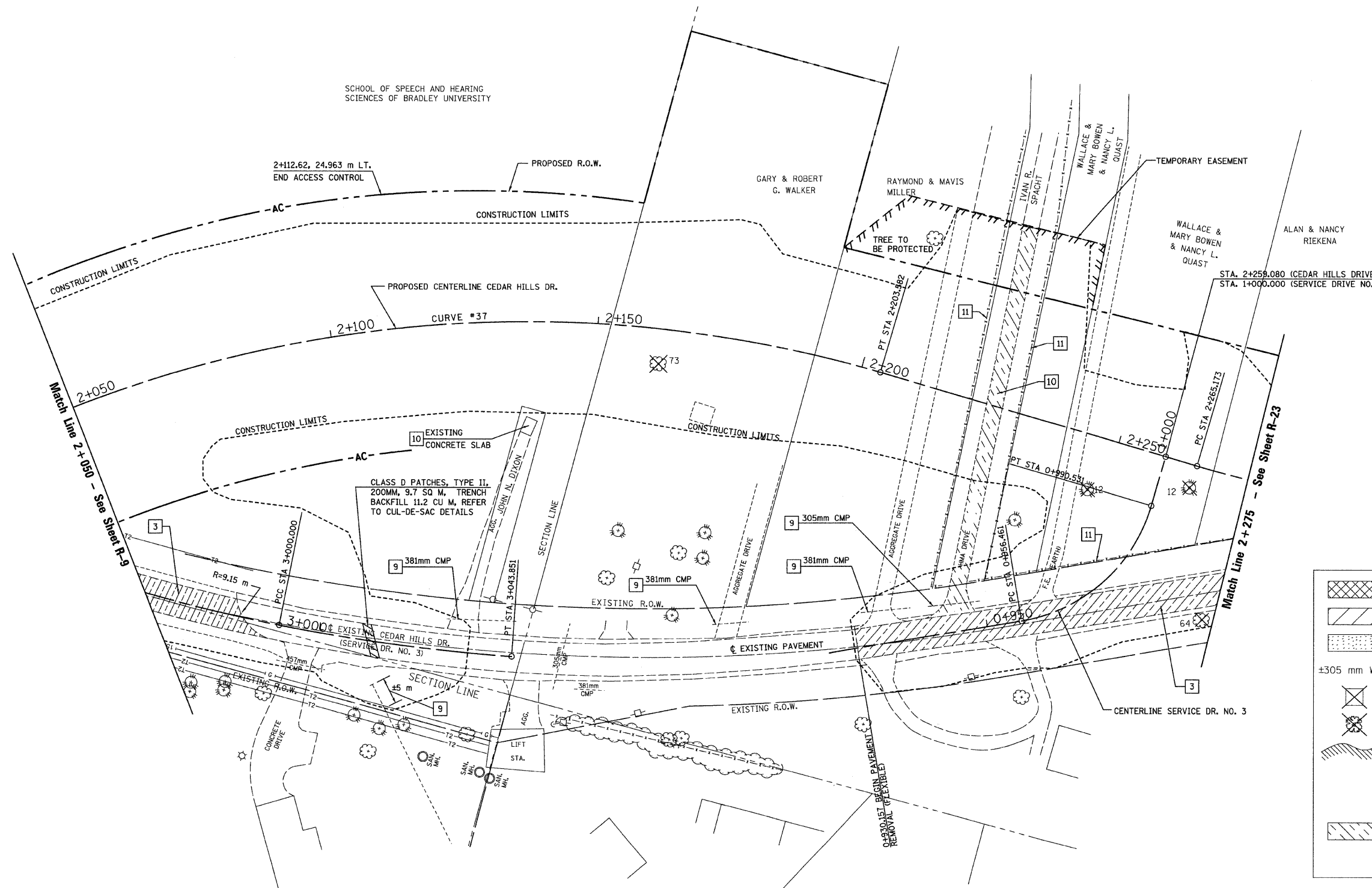

**REMOVAL LEGEND**

- 1 COMBINATION CURB & GUTTER REMOVAL
- 2 PAVEMENT REMOVAL (RIGID)
- 3 PAVEMENT REMOVAL (FLEXIBLE)
- ±305 mm WIDE 4 PAVED SHOULDER REMOVAL (SPECIAL) (meter)
- 5 BUILDING REMOVAL
- 6 INDIVIDUAL TREE REMOVAL (UNITS) (SEE SHEET Q-5 FOR TABULATION)
- 7 LIMITS OF TREE REMOVAL, HECTARES (SEE SHEET Q-5 FOR TABULATION)
- 8 REMOVE EXISTING CULVERTS (meter)
- 9 PIPE CULVERT REMOVAL (EACH)
- 10 DRIVEWAY PAVEMENT REMOVAL
- 11 FENCE REMOVAL

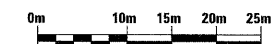

REVISIONS	
NAME	DATE

ILLINOIS DEPARTMENT OF TRANSPORTATION  
**EXISTING/REMOVAL**  
**ILLINOIS ROUTE 40**  
 STA. 2+050 TO STA. 2+275  
 SCALE: 1:400  
 DATE: 03/13/09  
 DRAWN BY: JRC, JDU  
 CHECKED BY: ECM