

SEC. 20 T.10N., R.8E., 4th P.M.

RTE NO.	SECTION	COUNTY	TOTAL	SHEET #
FA 646	125W-1, RS-2	PEORIA	256	126
STATION 15+850 TO STATION 16+400				

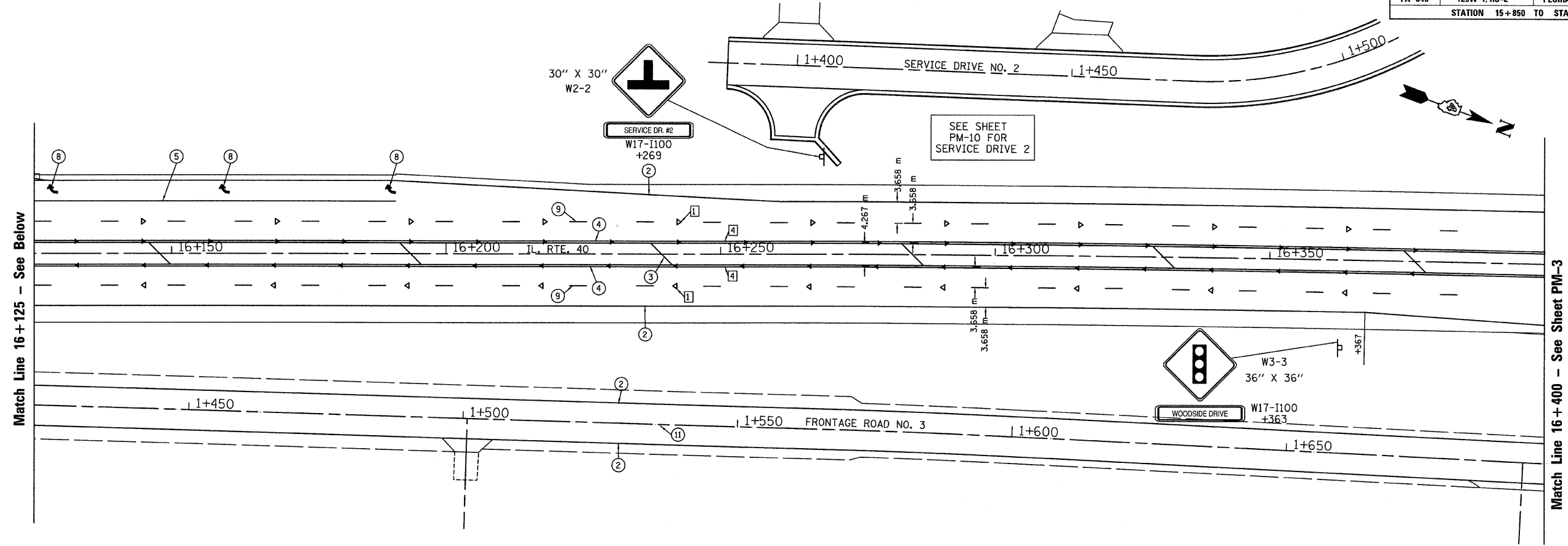

SEC. 29 T.10N., R.8E., 4th P.M.

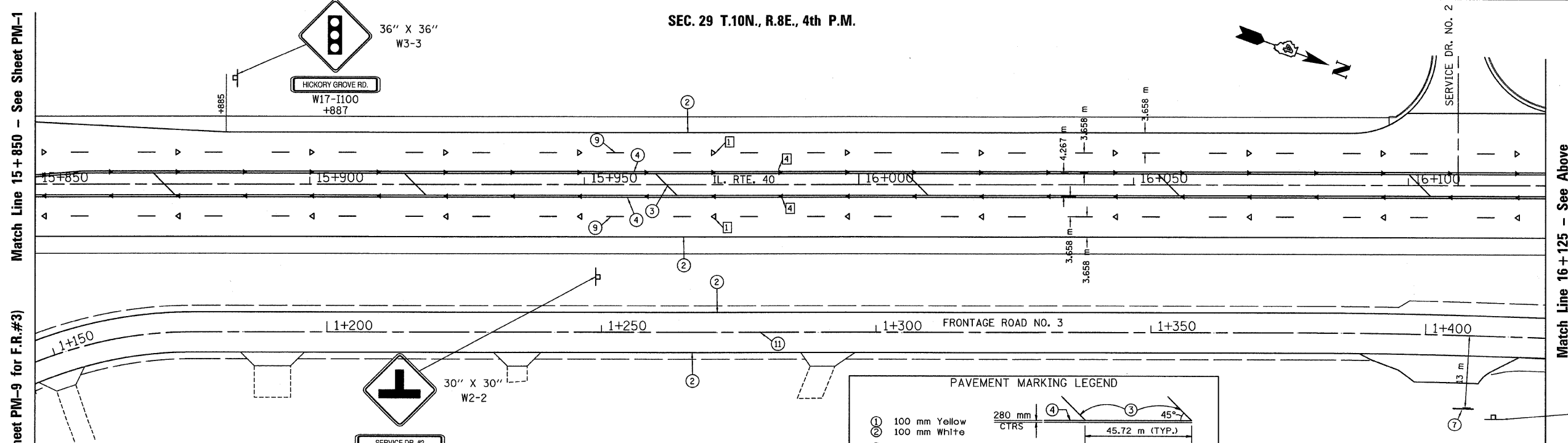

- RAISED REFLECTIVE PAVEMENT MARKERS (RRPM)**
- ① ONE-WAY RRPM CRYSTAL MARKER AT 24.4 m CENTERS
 - ② ONE-WAY RRPM CRYSTAL MARKER AT 12.2 m CENTERS
 - ③ TWO-WAY RRPM AMBER MARKER AT 12.2 m
 - ④ ONE-WAY RRPM AMBER MARKER AT 12.2 m

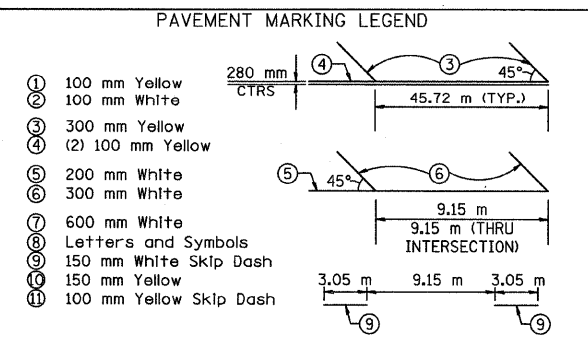
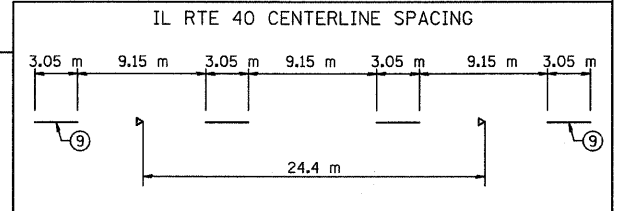

REVISIONS

NAME	DATE

ILLINOIS DEPARTMENT OF TRANSPORTATION

PAVEMENT MARKINGS AND SIGNING PLAN

ILLINOIS ROUTE 40

SCALE: 1:400
DATE: 03/13/09

DRAWN BY: JRC, JDU
CHECKED BY: ECM