

STAGE I  
EXISTING TRAFFIC SIGNAL

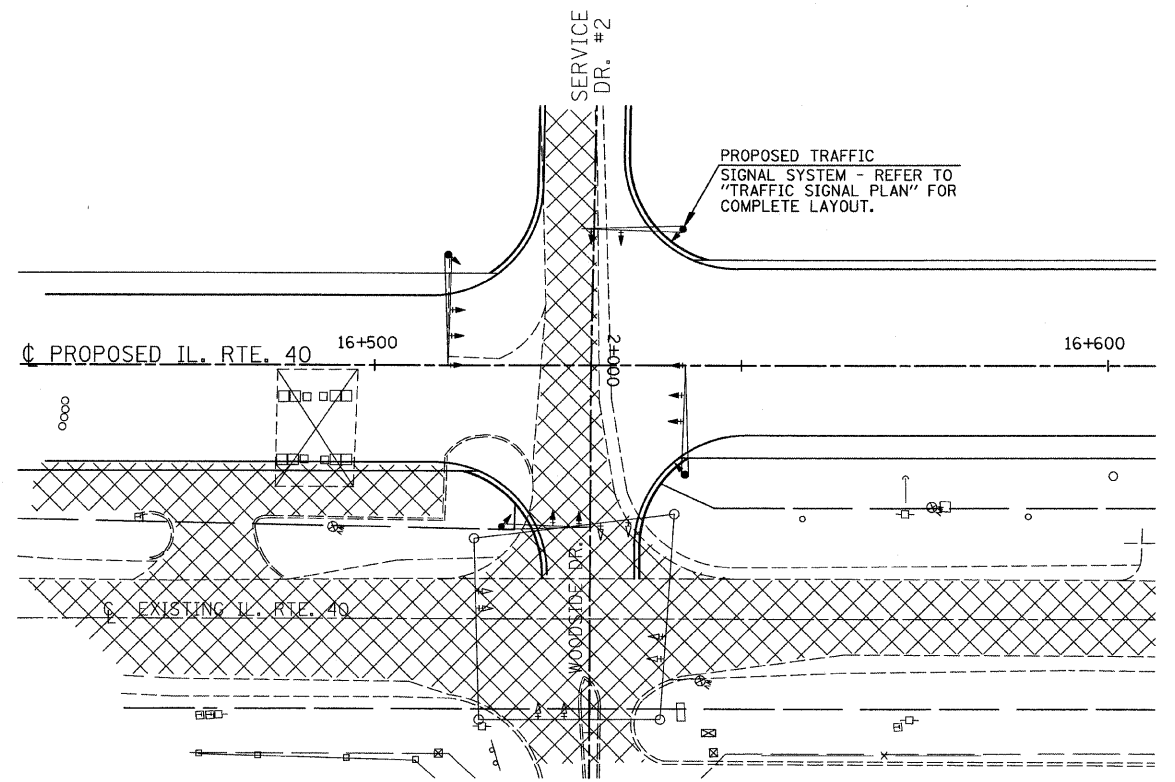

NOTE: NO TEMPORARY TRAFFIC SIGNALS ARE NEEDED. THE EXISTING SIGNALS SHALL REMAIN IN PLACE UNTIL TRAFFIC IS SWITCHED TO THE RELOCATION.

STAGE II  
PROPOSED TRAFFIC SIGNAL

LEGEND

	PROPOSED	EXISTING
CONTROLLER		
LIGHTING CONTROLLER		
SERVICE INSTALLATION		
SIGNAL HEAD		
SIGNAL HEAD WITH BACKPLATE		
MAST ARM ASSEMBLY AND POLE, STEEL		
LUMINAIRE		
JUNCTION BOX		
HANDHOLE		
QUADRAPOLE DETECTOR LOOP		
CONDUIT IN TRENCH OR PUSHED		
DETECTOR LOOP		
SIGNAL POST		

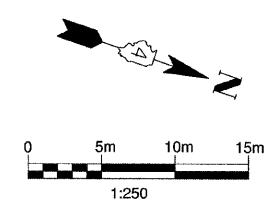

TS-9

ILLINOIS DEPARTMENT OF TRANSPORTATION  
**EXISTING TRAFFIC SIGNAL PLANS**  
**F.A. RTE. 646 (IL. RTE. 40) &**  
**WOODSIDE DRIVE/SERVICE DRIVE #2**  
**SECTION 125W-1, RS-2**  
**PEORIA COUNTY**

DESIGN BY: \_\_\_\_\_ DRAWN BY: JRC, JDU  
DATE: 03/13/09 CHECKED BY: ECM