

ELEVATION

All dimensions along \varnothing roadway

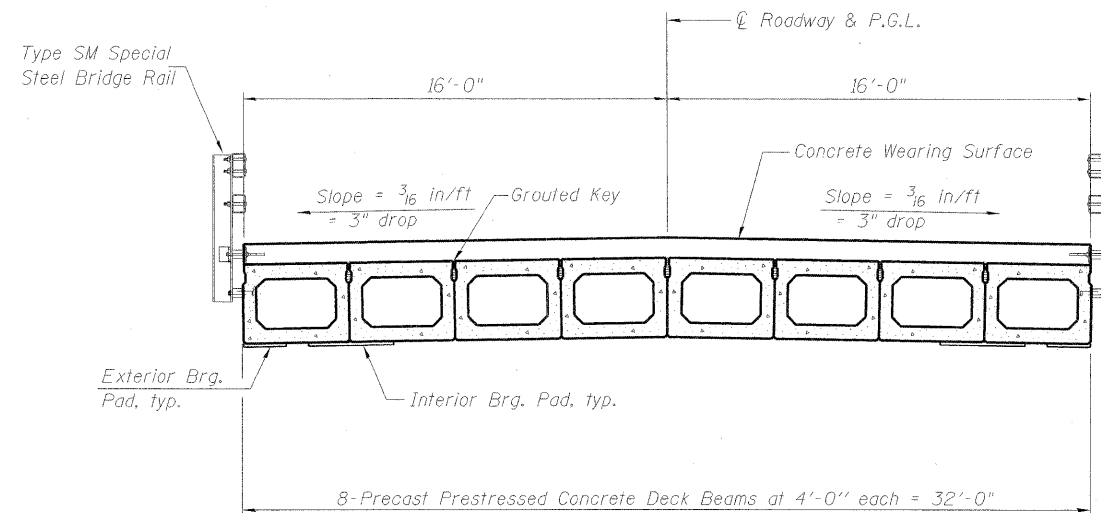

CROSS SECTION

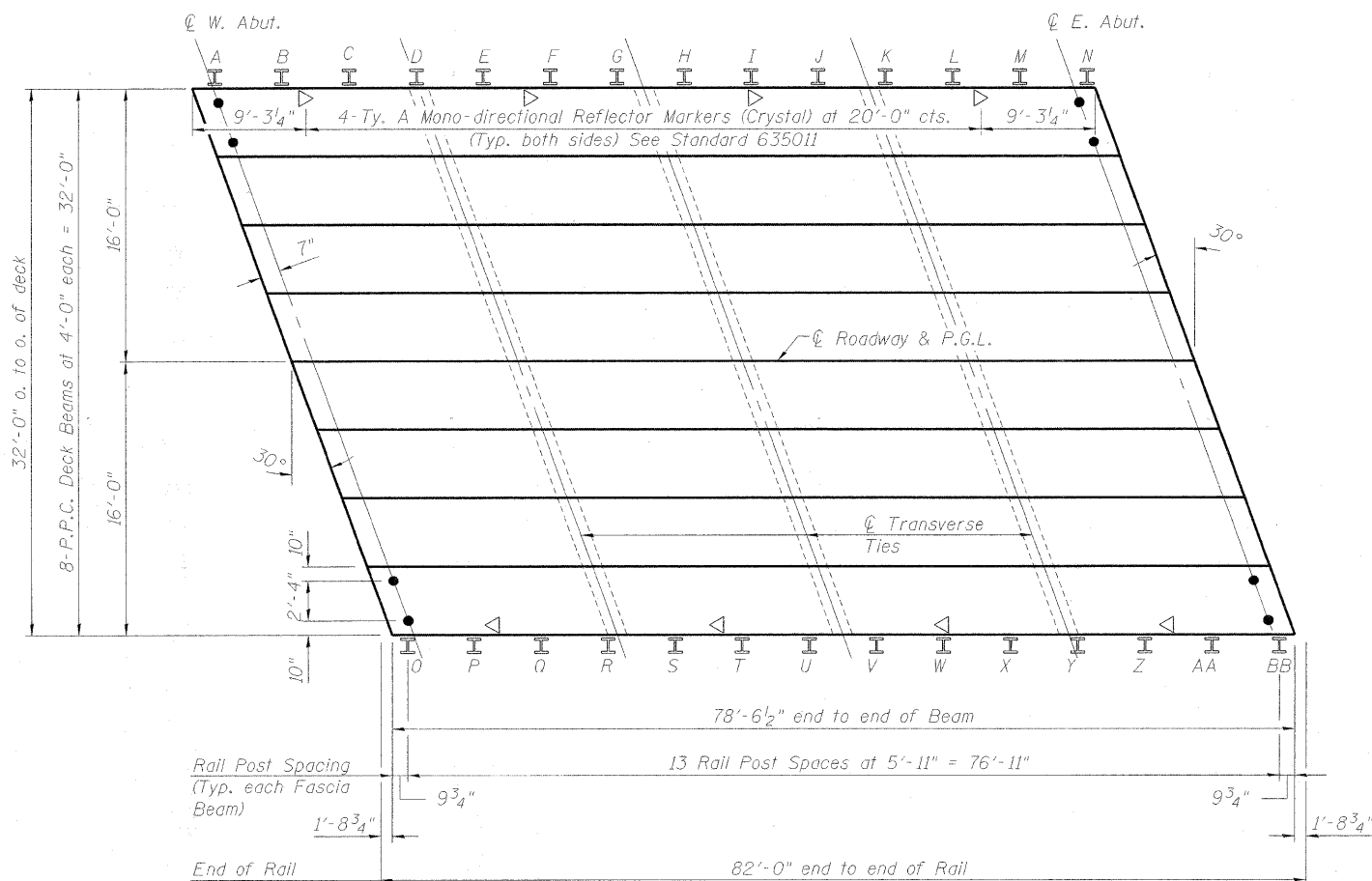

PLAN

NOTES

- After beams have been erected, holes shall be drilled into substructure and anchor dowels placed. Dowel holes shall be filled with non-shrink grout to top of beam and allowed to cure min. 24 hours prior to grouting the shear keys. Longitudinal keys shall be grouted.
- The bearing seat surfaces shall be adjusted by shimming to assure firm and even bearing. See sheet 5 of 11 for bearing pad details.
- Hatched area to be poured after Concrete Wearing Surface is in place, and will be paid for as Concrete Structures.
- See Sheet 7 of 11 for location of rail post anchor devices.
- See Sheet 6 of 11 for Section at Rail Post.
- Cost of Reflector Markers shall be considered incidental to Steel Bridge Rail, Type SM (Special).
- Theoretical weight of one PPC deck beam is 90,070 lbs.

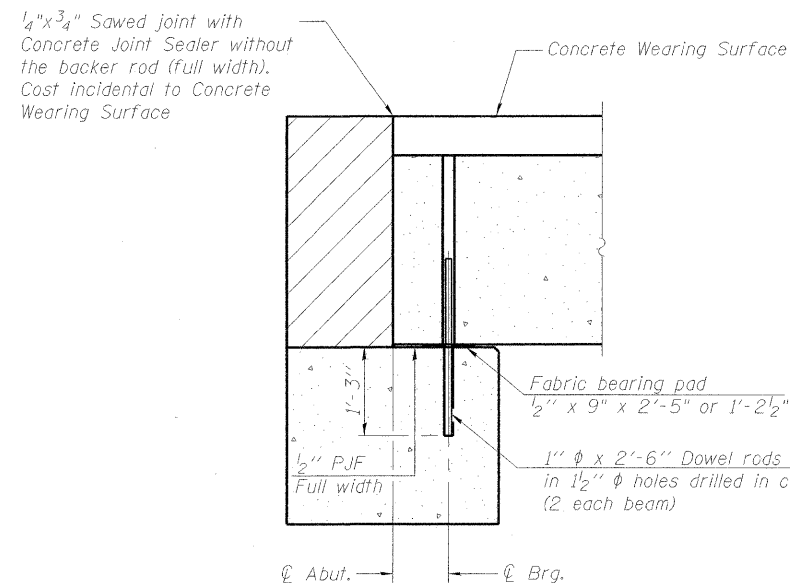

SECTION THRU ABUTMENT

All dimensions along \varnothing roadway

P.P.C. DECK BEAM SUPERSTRUCTURE

TODD SCHOOL ROAD BRIDGE
OVER BRANCH OF COPPERAS CREEK
CH D56
SEC. 08-00041-02-BR
PEORIA COUNTY, ILLINOIS
STATION 37+55
STRUCTURE NO. 072-3144

OBL0071	5/21/09		CH	SECTION	COUNTY	TOTAL SHEETS	SHEET NO.
			D56	08-00041-02-BR	PEORIA	25	11
			11 SHEETS		CONTRACT NO. 89479		
			FED. ROAD DIST. NO. 2 ILLINOIS FED. AID PROJECT				

09/21/2009
 A:\08\0805\081007\CAD\DS\Struct\Sheet\5-003-superstructure.dgn
 LAYOUT: MR 01/14/03
 DRAWN: MSM 02/27/03
 REVIEWED: SMK 05/27/09