

SUGGESTED CUT SECTION
CONSTRUCT AS SHOWN IN
STATION CROSS SECTIONS

TYPICAL CROSS SECTION

STA. 133+50 TO 135+95.33
STA. 136+64.67 TO 139+80

TRANSITION FROM THE PROPOSED ROADWAY TO THE EXISTING
ROADWAY IS TO BE CONSTRUCTED FROM STA. 133+50 TO 134+00 AND
STA. 139+30 TO 139+80. SEE SHEET 14 FOR TRANSITION AT BRIDGE.

SUGGESTED FILL SECTION
CONSTRUCT AS SHOWN IN
STATION CROSS SECTIONS

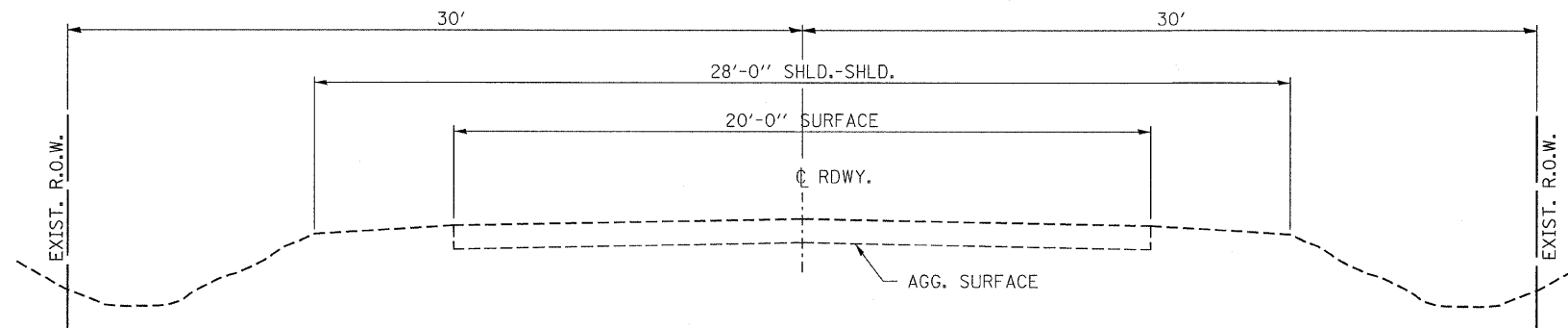

EXISTING CROSS SECTION

STA. 133+50 TO 139+80

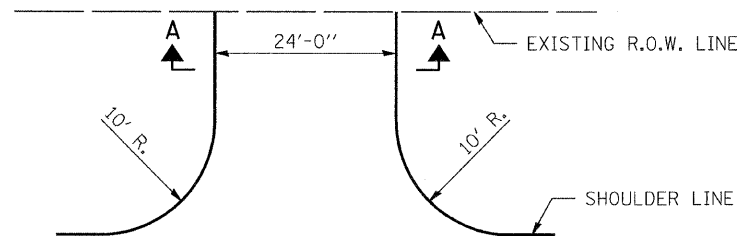

FIELD ENTRANCE DETAIL

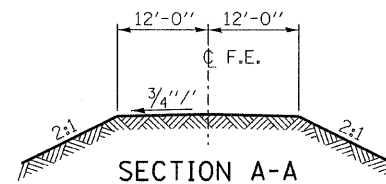

SECTION A-A

FILE NAME = 080274-shl-typesections.dgn

USER NAME =
PLOT SCALE =
PLOT DATE = 5/18/2009

DESIGNED - A.S.L.
DRAWN - D.A.B.
CHECKED - S.W.M.
DATE - 05/13/09

REVISED -
REVISED -
REVISED -
REVISED -

STATE OF ILLINOIS
STARK COUNTY HIGHWAY DEPARTMENT

HLR HAMPTON, LENZINI & RENWICK, INC.
CIVIL & STRUCTURAL ENGINEERS
LAND SURVEYORS
SCALE: SHEET NO. OF SHEETS STA. TO STA.

TYPICAL SECTIONS

C.H.	SECTION	COUNTY	TOTAL SHEETS	SHEET NO.
23	08-00158-00-BR	STARK	23	3
CONTRACT NO. 89509				
FED. ROAD DIST. NO. ILLINOIS FED. AID PROJECT				