

**2008 SURVEY DATA
EXISTING PIER AND ABUTMENT LAYOUT**

X = Easting Coordinates (E)
Y = Northing Coordinates (N)

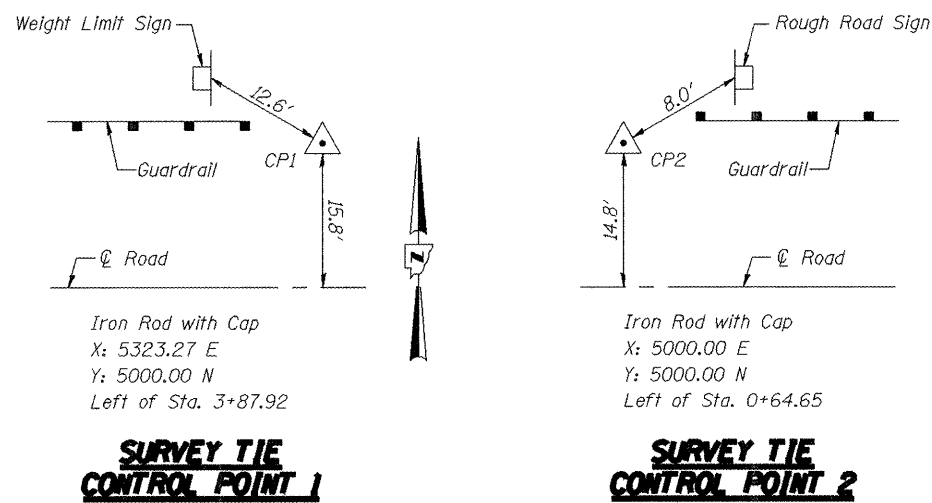

Contractor shall field verify substructure layout prior to ordering beams. Cost included in Construction Layout. Center new deck on centers of existing piers and abutments.



**SURVEY TIE
CONTROL POINT 1**

**SURVEY TIE
CONTROL POINT 2**

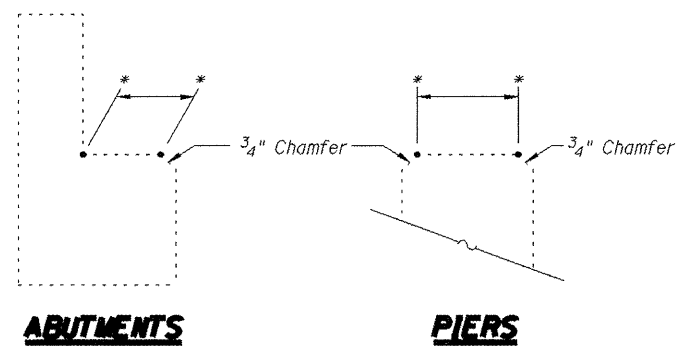

ABUTMENTS PIER

END VIEW

* Coordinates to backside of 3/4 inch chamfer at edge of bearing seat.

****CENTERLINE SUBSTRUCTURE AND DECK**

Location	Easting (X)	Northing (Y)	Station
W. Abut. Front of Backwall	5084.31	4984.00	1+48.96
Centerline Pier #1	5132.38	4984.10	1+97.03
Centerline Bridge = Centerline Span 2	5160.35	4984.20	2+25
Centerline Pier #2	5188.32	4984.29	2+52.97
E. Abut. Front of Backwall	5235.29	4984.32	2+99.94

**Skew angles given are with respect to survey baseline. See Sht. 7, 8, and 9 of 16 for PPC Deck Beam End Skew angles. Set centerline deck on centerline of piers and abutments. Centerline of Pier #2 is offset 0.07 ft. north of a straight line connecting the centerlines of both abutments and Pier #1.

**EXISTING PIER AND
ABUTMENT LAYOUT
SPOON RIVER ROAD
STATION 2+25.00**

DESIGNED	PJL
CHECKED	LLV
DRAWN	MGM
CHECKED	PJL

	HWY	SECTION	COUNTY	TOTAL SHEETS	SHEET NO.
	CH R15	08-00092-01-BR	PEORIA	16	6
	STRUCTURE NO. 072-3101				
FED. ROAD DIST. NO. ILLINOIS FED. AID PROJECT BROS-143(050)					

111 NE Jefferson Ave.
Peoria, Illinois 61602
Ph: 309.676.9464
Fax: 309.676.5445
IL Design Firm Reg.
No. 184-001518
www.aecom.com