

BM #20 STA. 111+94, 23' RT.  
CHISELED "4" TOP OF SW BOLT  
OF FIRE HYDRANT  
ELEV. 578.45

\* PASSING SPACE - SEE SIDEWALK TYPICAL SECTIONS.  
PROVIDE 5'x10' PASSING SPACE AT APPROXIMATE  
LOCATIONS SHOWN. MINOR ADJUSTMENTS MAY BE  
MADE IN THE FIELD. 200' MAX. BETWEEN PASSING  
SPACES.

PLAN	SURVEYED	DATE
	PLOTTED	
	GRADES CHECKED	
	STRUCTURE NOTATIONS CHKD	
	NO. OF WALK CHECKED	
	CADD FILE NAME	
	NO.	

PROFILE	SURVEYED	DATE
	PLOTTED	
	GRADES CHECKED	
	STRUCTURE NOTATIONS CHKD	
	NO. OF WALK CHECKED	
	CADD FILE NAME	
	NO.	

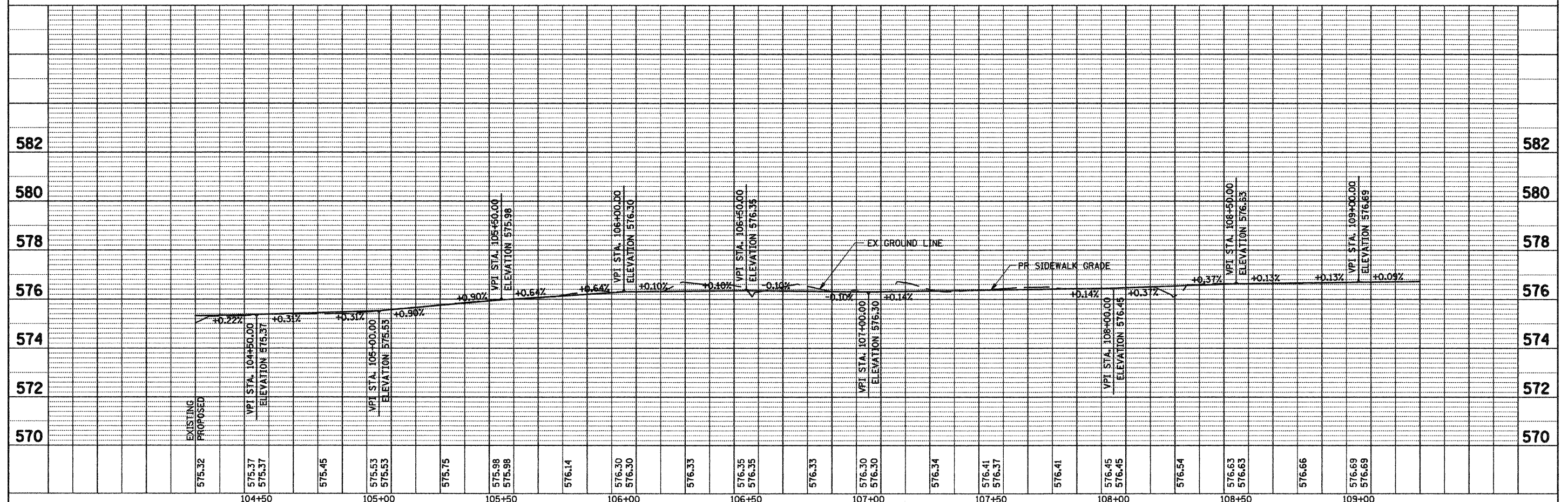

FILE NAME = G:\S07809-81\load\1st-South\7889PP02.SHT	USER NAME = IE Consultants	DESIGNED -	REVISED -	<b>STATE OF ILLINOIS DEPARTMENT OF TRANSPORTATION</b>	<b>FIRST / SOUTH STREET - PLAN &amp; PROFILE STA 104 + 25 TO STA 109 + 25</b>			F.A. RTE.	SECTION	COUNTY	TOTAL SHEETS	SHEET NO.	
		DRAWN -	REVISED -		SCALE:	SHEET NO.	OF	SHEETS	STA.	TO STA.	SANGAMON	47	12
		CHECKED -	REVISED -								CONTRACT NO. 03486		
		DATE -	REVISED -								ILLINOIS FED. AID PROJECT		