

PLAN	SURVEYED	DATE
	PLOTTED	BY
	GRADES CHECKED	
	STRUCTURE NOTATIONS CHK'D	
	NOTE BOOK NO.	
	FILE NAME	

PROFILE	SURVEYED	DATE
	PLOTTED	BY
	GRADES CHECKED	
	STRUCTURE NOTATIONS CHK'D	
	NOTE BOOK NO.	
	FILE NAME	

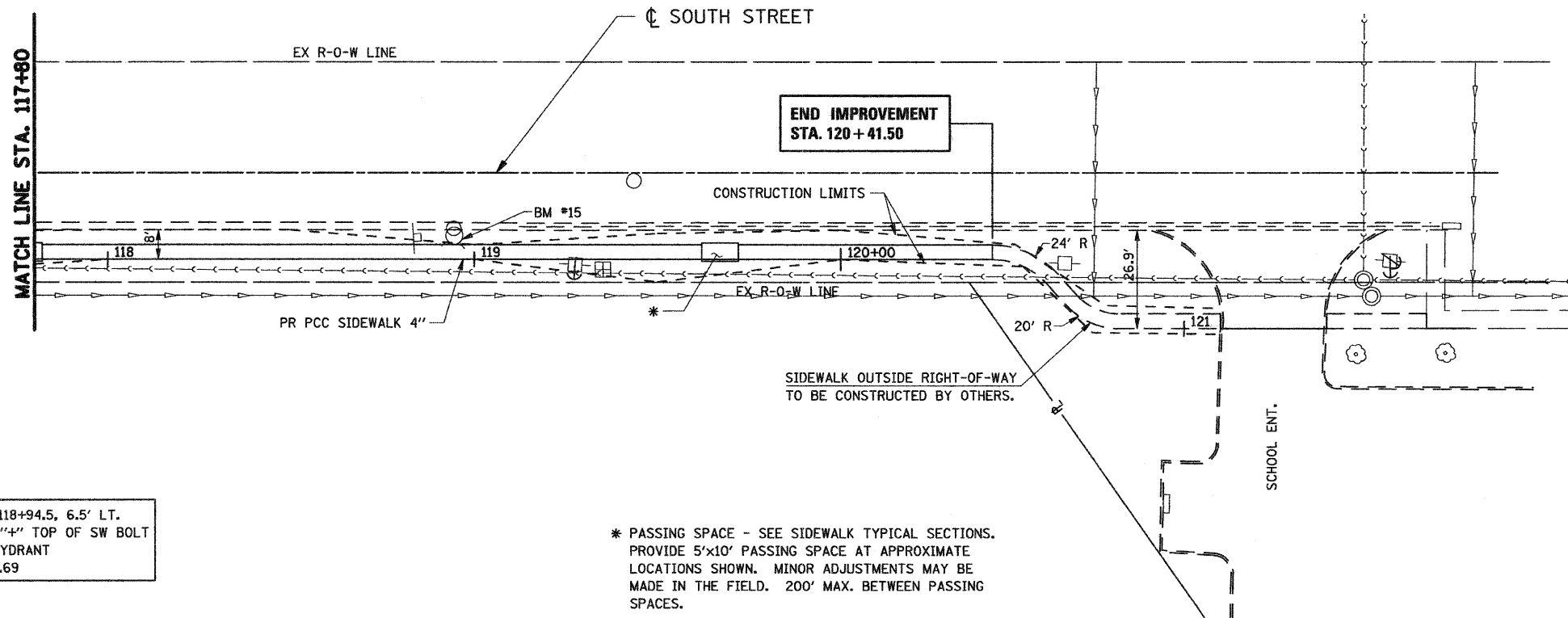

BM #15 STA. 118+94.5, 6.5' LT.
CHISELED "H" TOP OF SW BOLT
OF FIRE HYDRANT
ELEV. 580.69

* PASSING SPACE - SEE SIDEWALK TYPICAL SECTIONS.
PROVIDE 5'x10' PASSING SPACE AT APPROXIMATE
LOCATIONS SHOWN. MINOR ADJUSTMENTS MAY BE
MADE IN THE FIELD. 200' MAX. BETWEEN PASSING
SPACES.

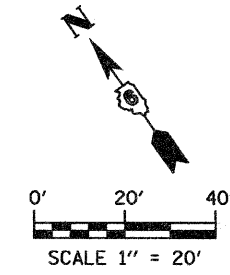

LEGEND

TBR - TO BE RELOCATED

SEE SIDEWALK DETAILS FOR
CONSTRUCTION INFORMATION.

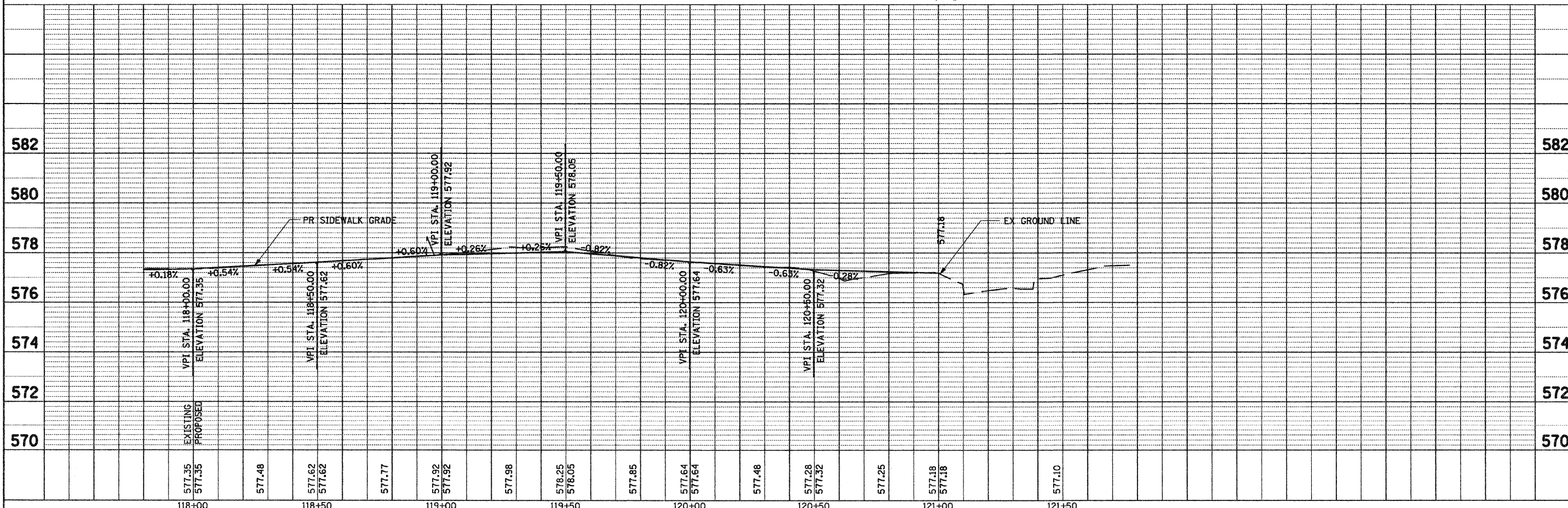

FILE NAME =	USER NAME = IE Consultants	DESIGNED -	REVISED -	STATE OF ILLINOIS DEPARTMENT OF TRANSPORTATION	FIRST / SOUTH STREET - PLAN & PROFILE STA 117 + 80 TO STA 121 + 66.14	F.A. RTE.	SECTION	COUNTY	TOTAL SHEETS	SHEET NO.
Gr:\S07009-01\lead\1st-South\7009PP05.SHT		DRAWN -	REVISED -			08-00014-00-SW	SANGAMON	47	15	
PLOT SCALE = 20.0000' / IN.		CHECKED -	REVISED -			CONTRACT NO. 93486				
PLOT DATE = 2/18/2009		DATE -	REVISED -			FED. ROAD DIST. NO.	ILLINOIS FED. AID PROJECT			
						SCALE:	SHEET NO.	OF	SHEETS	STA.