

FINAL SURVEY	BY	DATE
SURVEYED		
NOTE BOOK		
AREAS		
AREAS CHECKED		
NO.		

ORIGINAL SURVEY	BY	DATE
SURVEYED		
NOTE BOOK		
AREAS		
AREAS CHECKED		
NO.		

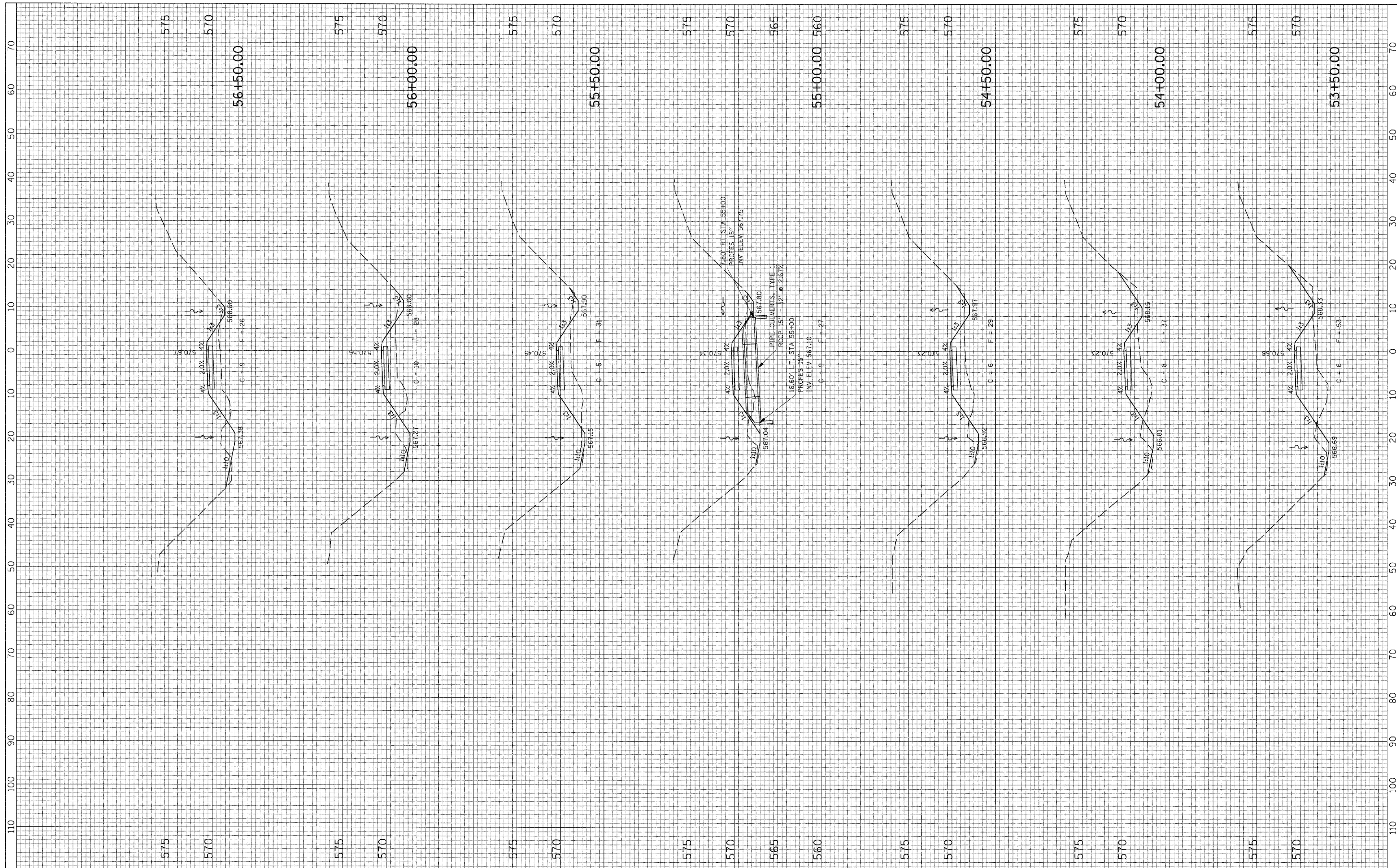

FILE NAME = G:\S07009-09\RR DITCH DATA COLLECTION\CAD\XS.PATH.dgn	USER NAME = IE Consultants	DESIGNED -	REVISED -	STATE OF ILLINOIS DEPARTMENT OF TRANSPORTATION	CROSS SECTIONS - SHARED USE PATH ZIMMERMAN DRIVE	F.A. RTE.	SECTION	COUNTY	TOTAL SHEETS	SHEET NO.
PLOT SCALE = 10,000.00' / IN.	PLOT DATE = 2/12/2009	DRAWN -	REVISED -			08-0014-SW	SANGAMON	47	33	
		CHECKED -	REVISED -			CONTRACT NO. 93486				
		DATE -	REVISED -			FED. ROAD DIST. NO. ILLINOIS FED. AID PROJECT				

SCALE: SHEET NO. 2 OF 6 SHEETS STA. 53+50.00 TO STA. 56+50.00