

| F.A.U. RTE. | SECTION | COUNTY | TOTAL SHEETS | SHEET NO. |
|---------------------|----------------------------------|----------|------------------|-----------|
| 9124 | 05-00085-01-FF 05-00085-02-FF | MADISON | 61 | 28 |
| FED. ROAD DIST. NO. | | ILLINOIS | FED. AID PROJECT | |

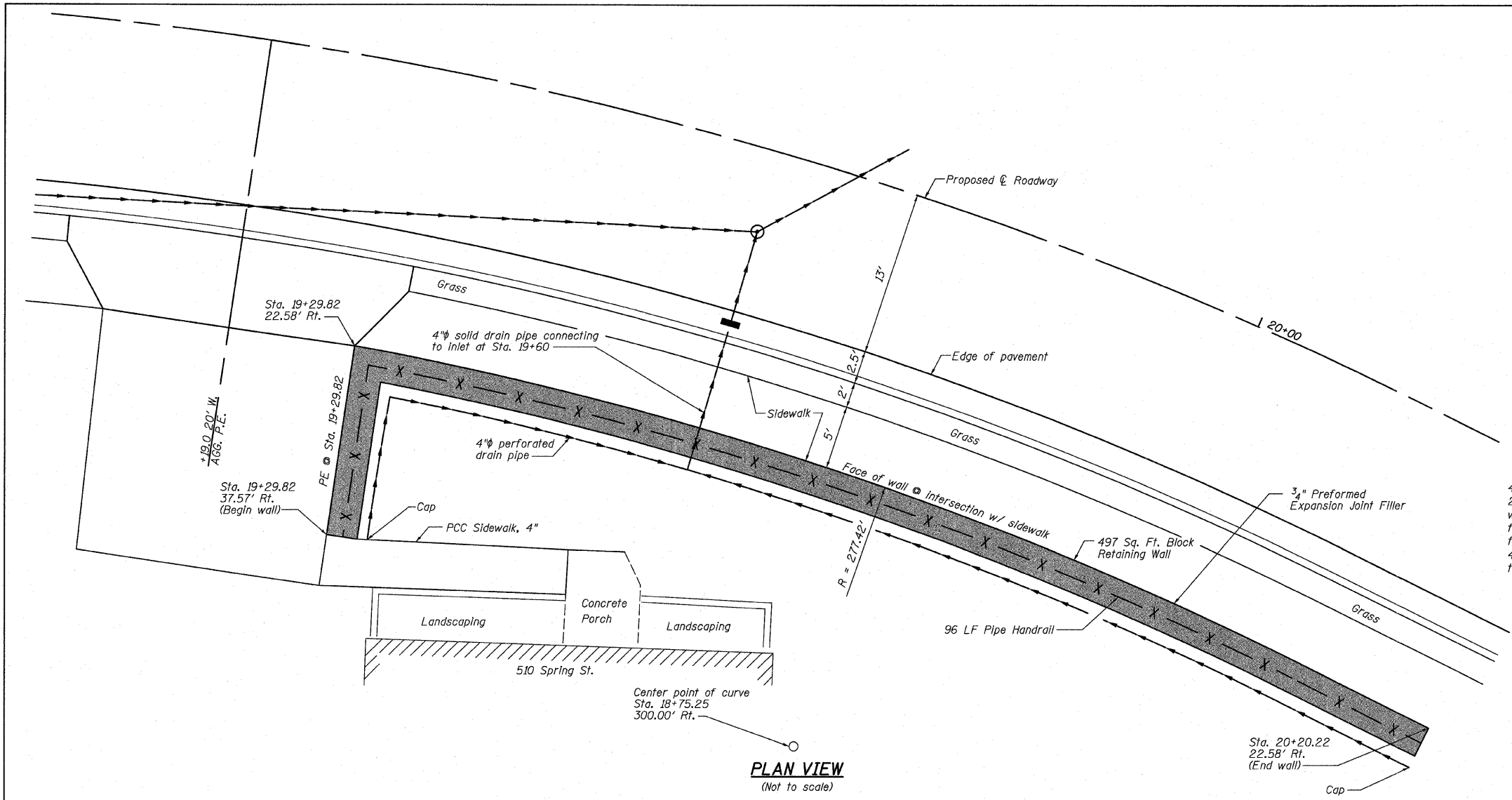

PLAN VIEW
(Not to scale)

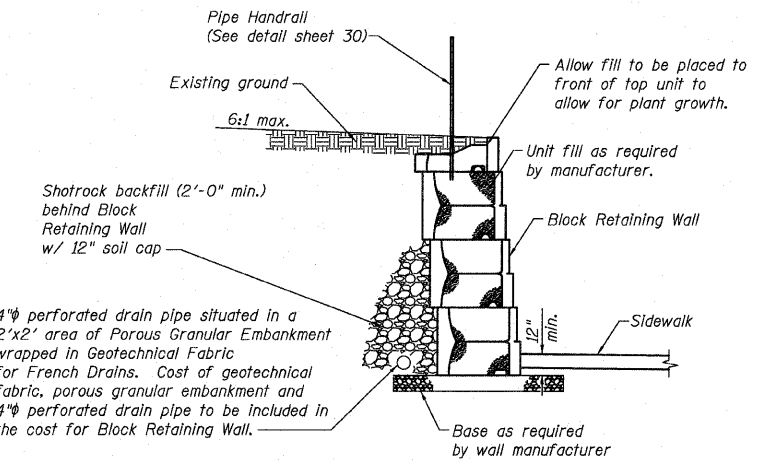

**BLOCK RETAINING WALL
(ABOVE ROAD GRADE)**
(Not to scale)

Notes:

1. The block retaining wall Contractor shall coordinate construction of the retaining wall with the General Contractor so that the construction of the roadway and adjacent driveway are not slowed by the retaining wall construction.
2. The adjacent driveway shall remain in use throughout construction.
3. Pipe handrail shall be installed upon completion of the retaining wall.
4. Quantities shown shall be verified by wall designer. Actual measurements and payment shall be in accordance with special provisions.

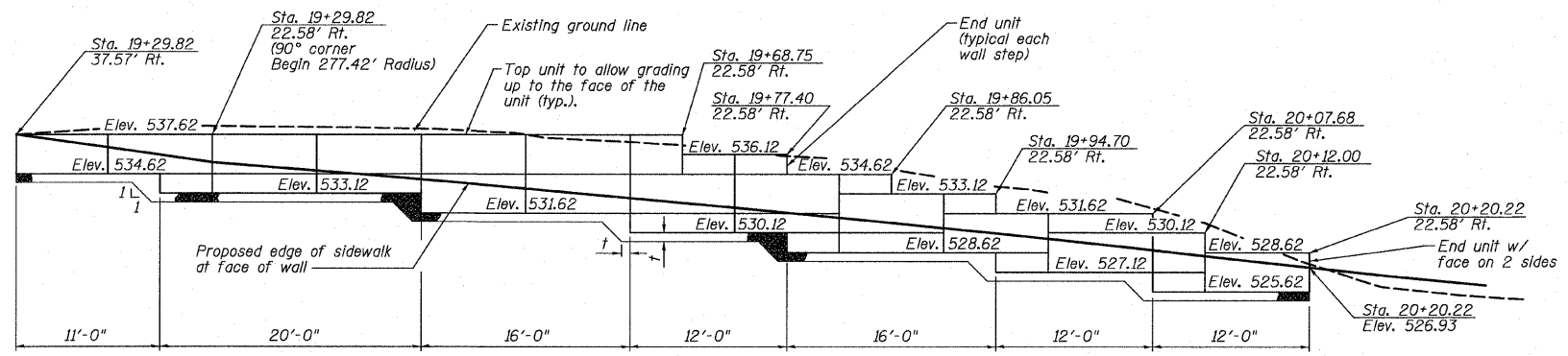

ELEVATION VIEW
(Not to scale)

BLOCK RETAINING WALL
(Not to scale)

Note: Since the wall will be battered, the stations shown reference the locations at the base of the wall & the elevation at the top of the wall.