

- 1 PRC FLAR END SEC 12  
+44.24, 50.73' LT  
INV 547.60
- 2 INLET TA T3F&G  
+50, 31.42' LT  
EOP 552.35  
INV 548.40
- 3 MH TY A 4 DIA TIF CL  
+50, 37.21' LT  
LID 552.82  
INV 548.03 (W)  
INV 547.66
- 4 INLET TA T3F&G  
+25, 25.84' LT  
EOP 553.40  
INV 549.75
- 5 MH TY A 4 DIA TIF CL  
+25, 36.21' LT  
LID 553.93  
INV 549.43 (W)  
INV 548.84
- 6 MH TY A 4 DIA TIF CL  
+00, 36.95' LT  
LID 553.86  
INV 549.20
- 7 INLET TA T3F&G  
+75, 19.31' LT  
EOP 554.87  
INV 552.24
- 8 MH TY A 4 DIA TIF CL  
+75, 25.08' LT  
LID 555.33  
INV 551.87 (W)  
INV 550.05
- 9 INLET TA T3F&G  
+00, 19.62' LT  
EOP 555.75  
INV 553.85
- 10 MH TY A 4 DIA TIF CL  
+00, 25.08' LT  
LID 556.96  
INV 553.48 (W)  
INV 552.53

- 10A INLET TA T3F&G  
+00, 19.31' LT  
EOP 557.54  
INV 554.89
- 10B MH TY A 4 DIA TIF CL  
+00, 25.08' LT  
LID 558.00  
INV 554.52 (W)  
INV 553.36
- 27 INLET TA T3F&G  
+00, 23.80' LT  
EOP 558.29  
INV 556.00
- 28 MH TY A 4 DIA TIF CL  
+00, 33.66' LT  
LID 558.82  
INV 555.50

EXISTING CURVE DATA  
 P.I. STA. 131+33.03  
 $\Delta = 3'00''00''$   
 $T = 183.30'$   
 $R = 7000.00'$   
 $L = 366.52'$   
 P.C. STA. 129+49.73  
 P.T. STA. 133+16.25  
 S.E. = N.C.

N/F  
 BIVER FAMILY FARMS PARTNERSHIP  
 08-19-300-002

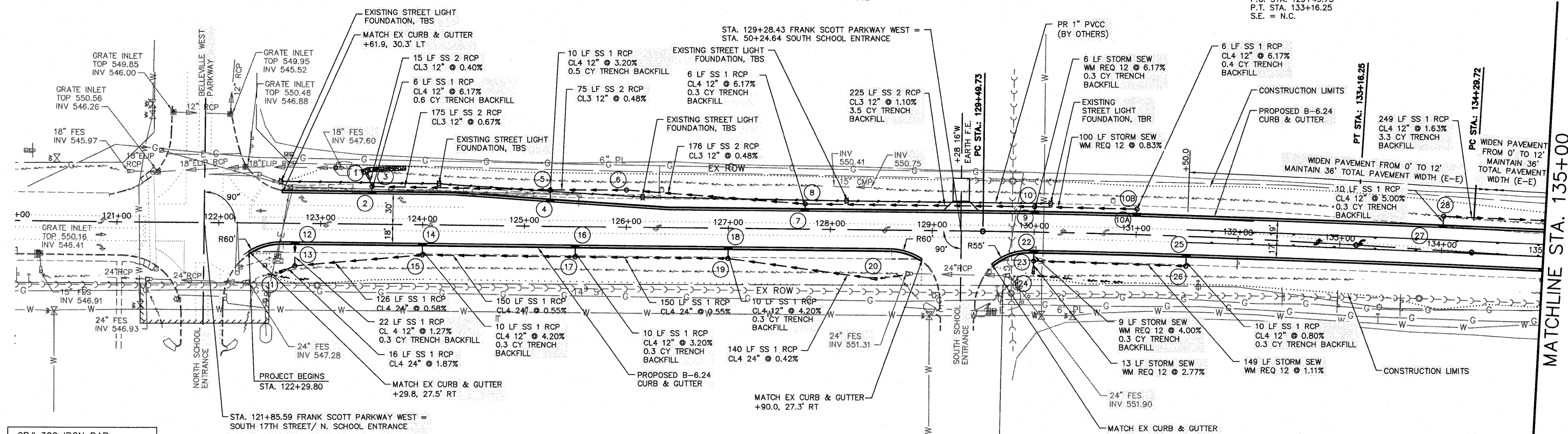

CP# 309 IRON BAR  
 STA 125+94.41, 67.22' RT  
 ELEV. 551.96

CP# 308 IRON BAR  
 STA. 132+93.31, 53.76' LT  
 ELEV. 559.89

BOARD OF EDUCATION OF BELLEVILLE  
 TOWNSHIP HIGH SCHOOL DISTRICT 201

- 11 PRC FLAR END SEC 24  
+60.25, 47.99' RT  
INV 547.88
- 12 INLET TA T3F&G  
+75, 19.29' RT  
EOP 551.91  
INV 549.75
- 13 MH TY A 4 DIA TIF CL  
+75, 41.58' RT  
LID 552.25  
INV 549.47 (E)  
INV 548.18
- 14 INLET TA T3F&G  
+00, 19.36' RT  
EOP 552.54  
INV 549.90
- 15 MH TY A 4 DIA TIF CL  
+00, 29.35' RT  
LID 553.05  
INV 549.48 (E)  
INV 548.91
- 16 INLET TA T3F&G  
+50, 19.28' RT  
EOP 553.38  
INV 550.50
- 17 MH TY A 4 DIA TIF CL  
+50, 29.27' RT  
LID 553.93  
INV 550.18 (E)  
INV 549.73
- 18 INLET TA T3F&G  
+00, 19.29' RT  
EOP 554.18  
INV 551.50
- 19 MH TY A 4 DIA TIF CL  
+00, 29.27' RT  
LID 554.69  
INV 551.08 (E)  
INV 550.55
- 20 PRC FLAR END SEC 24  
+46, 47.90' RT  
INV 551.14
- 22 INLET TA T3F&G  
+00, 19.26' RT  
EOP 556.13  
INV 553.20
- 23 MH TY A 4 DIA TIF CL  
+00, 28.29' RT  
LID 556.68  
INV 552.84
- 24 PRC FLAR END SEC 12  
+00, 40.84' RT  
INV 552.48
- 25 INLET TA T3F&G  
+50, 19.27' RT  
EOP 557.79  
INV 555.15
- 26 MH TY A 4 DIA TIF CL  
+50, 29.27' RT  
LID 558.33  
INV 555.07 (E)  
INV 554.49

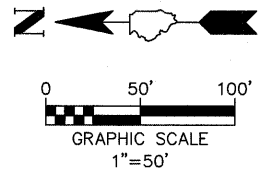

FILE NAME = 759MN01.DWG	USER NAME = SAM WRIGLEY	DESIGNED - SSM	REVISED -	<b>CITY OF BELLEVILLE, ILLINOIS</b>	<b>FRANK SCOTT PARKWAY WEST PLAN &amp; PROFILE SHEETS</b>	F.A.U. RTE. 9256	SECTION 09-00212-00-CG	COUNTY ST. CLAIR	TOTAL SHEETS 90	SHEET NO. 10
	PLOT SCALE = 1" = 1'	CHECKED - AJG	REVISED -	101 S. Illinois Street Belleville, IL 62220-2105	SCALE: SHEET NO. ___ OF ___ SHEETS STA. 120+00 TO STA. 134+50	CONTRACT NO. 97379				
	PLOT DATE = 2009-04-30	DATE - 2009-01-30	REVISED -			FED. ROAD DIST. NO. ILLINOIS FED. AID PROJECT				