

F.A.U. RTE.	SECTION	COUNTY	TOTAL SHEETS	SHEET NO.
9182	05-00186-07-PP	ST. CLAIR	47	18
STA. 166+00		TO STA. 172+00		
FED. ROAD DIST. NO. 8		ILLINOIS	FED. AID PROJECT	
CONTRACT NO. 97386				

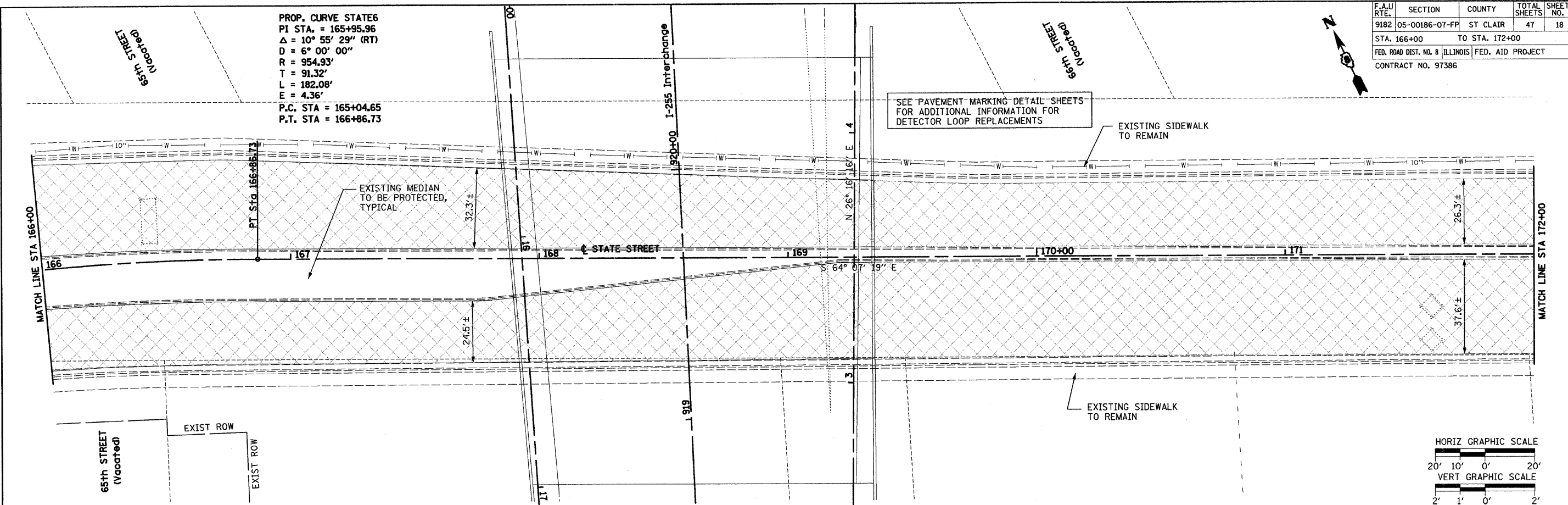

PROP. CURVE STATE6
 PI STA. = 165+95.96
 $\Delta = 10^\circ 55' 29''$ (RT)
 $D = 6^\circ 00' 00''$
 $R = 954.93'$
 $T = 91.32'$
 $L = 182.08'$
 $E = 4.36'$
 P.C. STA = 165+04.65
 P.T. STA = 166+86.73



SEE PAVEMENT MARKING DETAIL SHEETS FOR ADDITIONAL INFORMATION FOR DETECTOR LOOP REPLACEMENTS

EXISTING SIDEWALK TO REMAIN

EXISTING SIDEWALK TO REMAIN

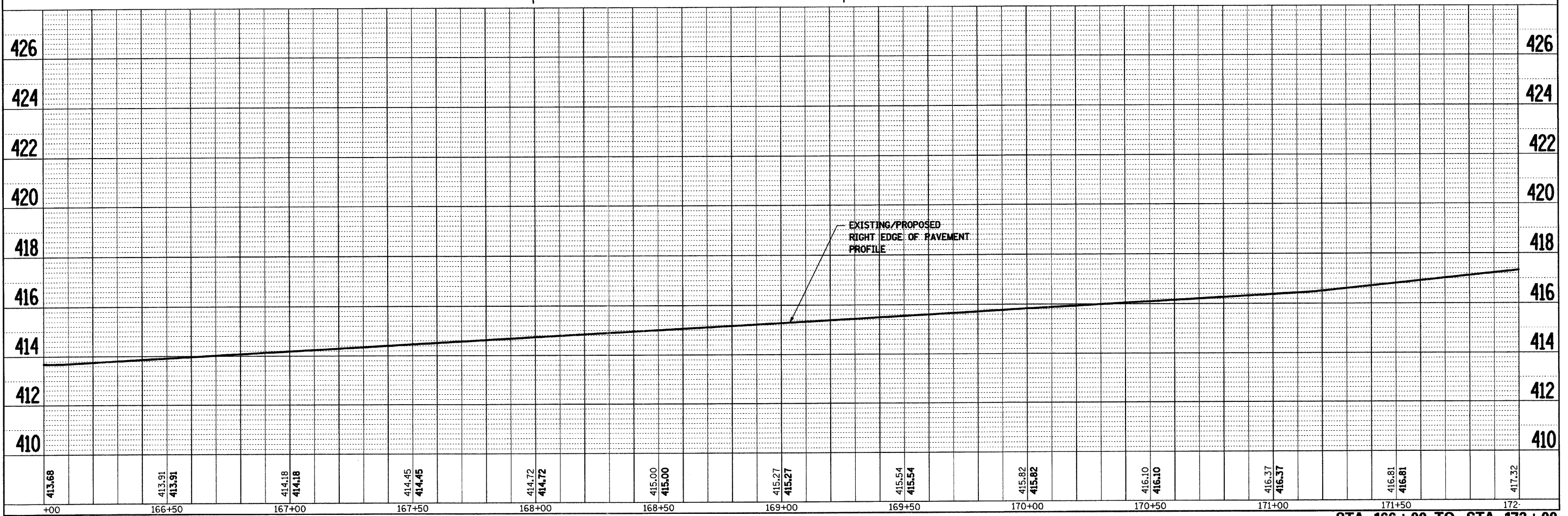
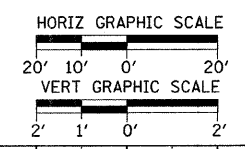

STA 166+00 TO STA 172+00