

F.A.U. RTE.	SECTION	COUNTY	TOTAL SHEETS	SHEET NO.
9182	05-00186-07-FP	ST CLAIR	47	33
STA.		TO STA.		
FED. ROAD DIST. 8		ILLINOIS		FED AID PROJECT
CONTRACT NO. 97386				

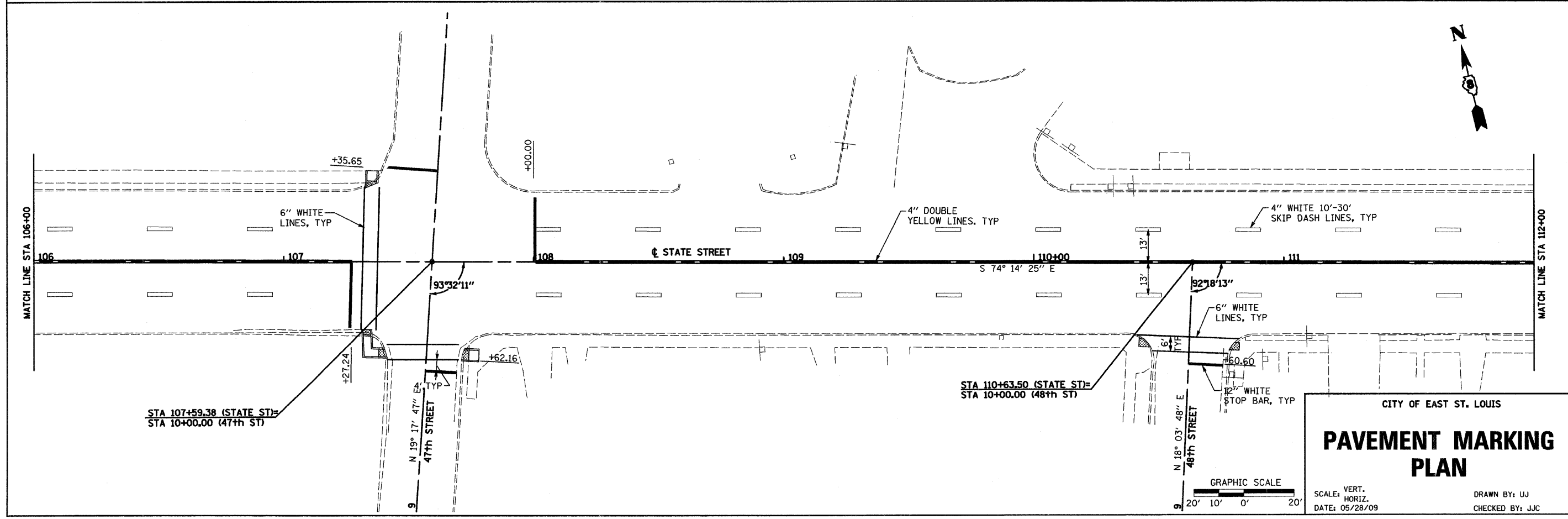
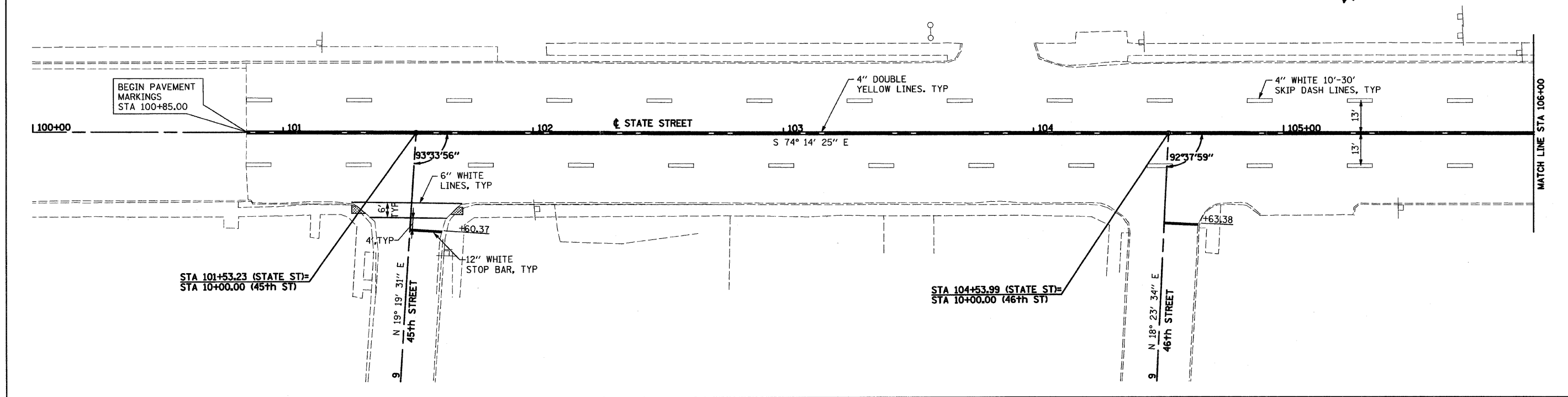

CITY OF EAST ST. LOUIS

PAVEMENT MARKING PLAN

SCALE: VERT. 1" = 10'
 HORIZ. 1" = 20'
 DATE: 05/28/09

GRAPHIC SCALE
 20' 10' 0' 20'

DRAWN BY: UJ
 CHECKED BY: JUC