

F.A.U. RTE.	SECTION	COUNTY	TOTAL SHEETS	SHEET NO.
9182	05-00186-07-FP	ST CLAIR	47	40
STA.		TO STA.		
FED. ROAD DIST. 8		ILLINOIS FED AID PROJECT		
CONTRACT NO. 97386				

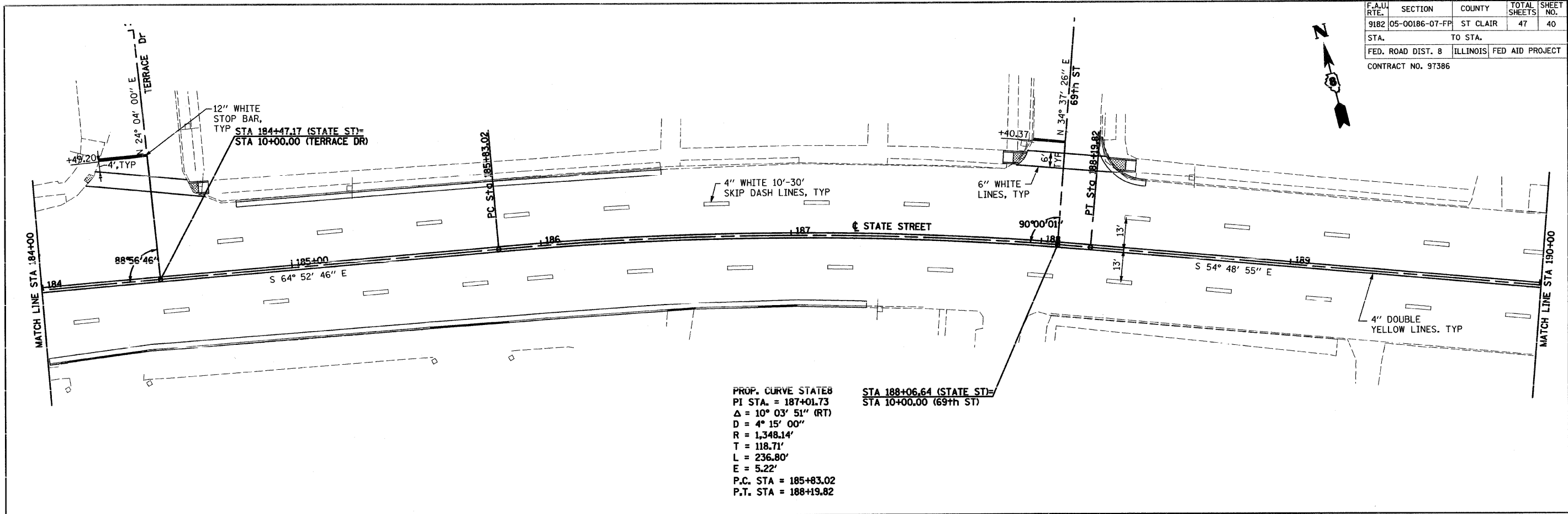

PROP. CURVE STATE  
 PI STA. = 187+01.73  
 $\Delta$  = 10° 03' 51" (RT)  
 D = 4° 15' 00"  
 R = 1,348.14'  
 T = 118.71'  
 L = 236.80'  
 E = 5.22'  
 P.C. STA = 185+83.02  
 P.T. STA = 188+19.82

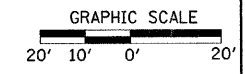
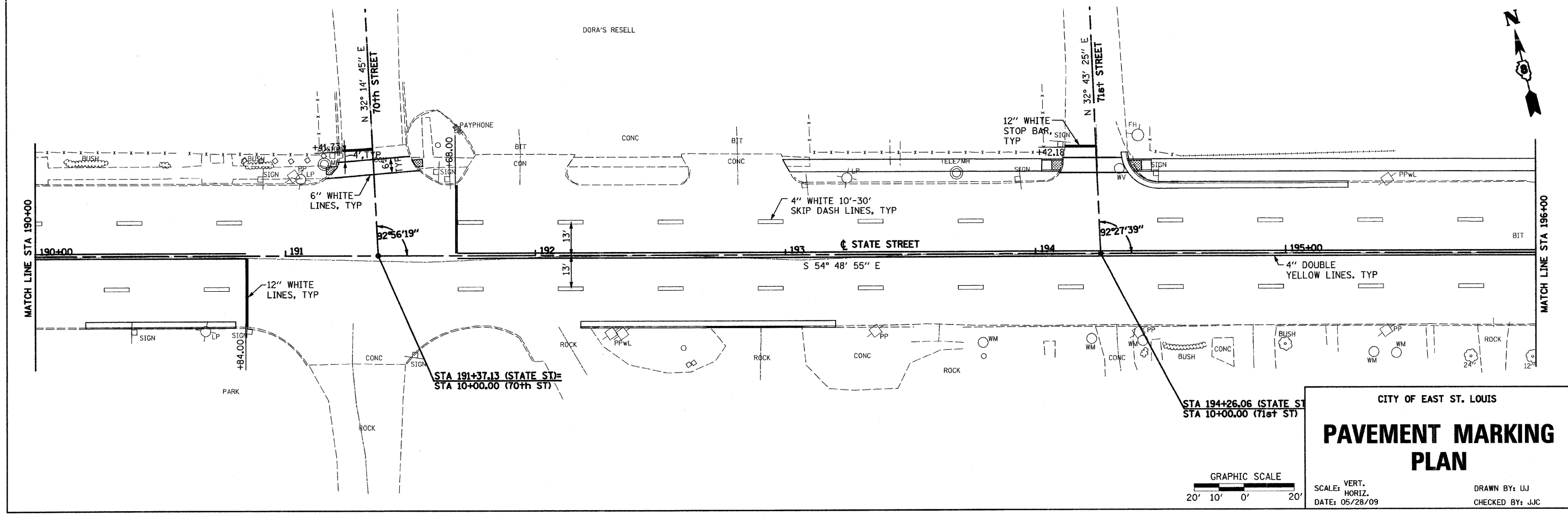

CITY OF EAST ST. LOUIS  
**PAVEMENT MARKING PLAN**  
 SCALE: VERT. \_\_\_\_\_  
 HORIZ. \_\_\_\_\_  
 DATE: 05/28/09  
 DRAWN BY: UJ  
 CHECKED BY: JJC