

SECTION	COUNTY	TOTAL SHEETS	SHEET NO.
*	MADISON	5	1

FEDERAL AID PROJECT
 * 09-00006-01-RS
 CONTRACT NO. 97387

STATE OF ILLINOIS
 DEPARTMENT OF TRANSPORTATION
 DIVISION OF HIGHWAYS
 FEDERAL AID HIGHWAY
PONTOON ROAD IMPROVEMENTS
FAU ROUTE 9082
 SECTION 09-00006-01-RS
 PROJECT ARA 5011 (290)
 VILLAGE OF PONTOON BEACH
 MADISON COUNTY
 JOB C-98-344-09

FOR UTILITY LOCATION PURPOSES, THIS PROJECT IS LOCATED IN THE N.E. AND S.E. QUARTERS OF SECTION 13, TOWNSHIP 5 NORTH, RANGE 10 WEST OF THE THIRD PRINCIPAL MERIDIAN.

UTILITY LOCATION CAN BE OBTAINED BY CALLING J.U.L.I.E. (1-800-892-0123)

THE FOLLOWING AGENCIES KNOWN TO HAVE FACILITIES WITHIN THE LIMITS OF THIS IMPROVEMENT ARE SHOWN BELOW (MEMBERS OF JULIE, PHONE (800) 892-0123, ARE INDICATED BY *)

- * CHARTER COMMUNICATIONS
508 NIAGARA
EAST ALTON, IL 62024
(618) 251-2660
- * AMERITECH
203 GOETHE
COLLINSVILLE, IL 62234
(618) 346-6400
- * AMEREN IP
GAS AND ELECTRIC
2600 N. CENTER STREET
MARYVILLE, ILLINOIS 62062
(618) 346-1273
- * PONTOON BEACH PUBLIC WATER DISTRICT
3959 PONTOON ROAD
PONTOON BEACH, ILLINOIS 62040
(618) 931-2856
- * ILLINOIS AMERICAN WATER CO.
4436 INDUSTRIAL DRIVE
P.O. BOX 186
ALTON, IL 62002
(618) 466-2131
- * MADISON COUNTY SPECIAL SERVICE
AREA #1 (SANITARY)
301 EAST CHAIN OF ROCKS ROAD
GRANITE CITY, ILLINOIS 62040
(618) 931-3400

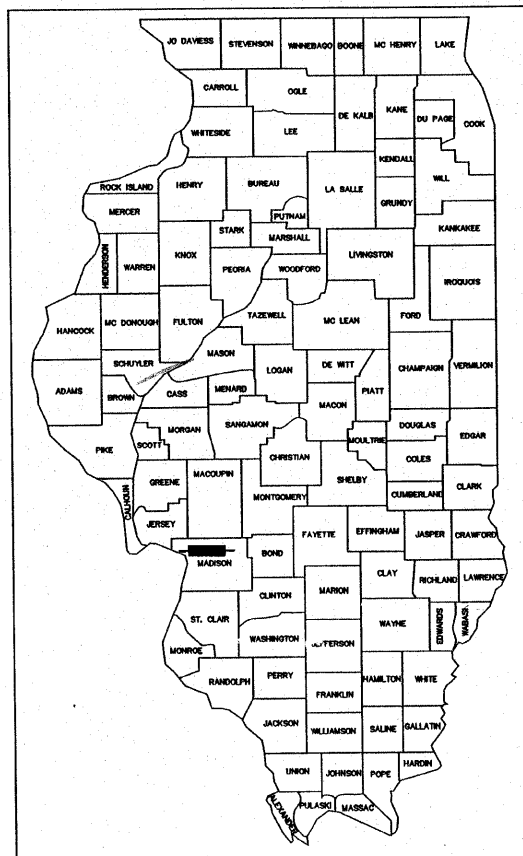

LOCATION OF SECTION INDICATED THUS: -

INDEX TO SHEETS

1. COVER SHEET
2. SUMMARY OF QUANTITIES, TYPICAL SECTIONS AND GENERAL NOTES
- 3.-5. PLAN SHEETS

HIGHWAY STANDARDS

- 442101-07
- 442201-03
- 701101-02
- 701421-02
- 701502-03
- 701901-01
- 720006-02
- 729001-01
- 780001-02
- 781001-03
- 886001-01
- 886006-01

BEGIN PROJECT
 STA. 70+38

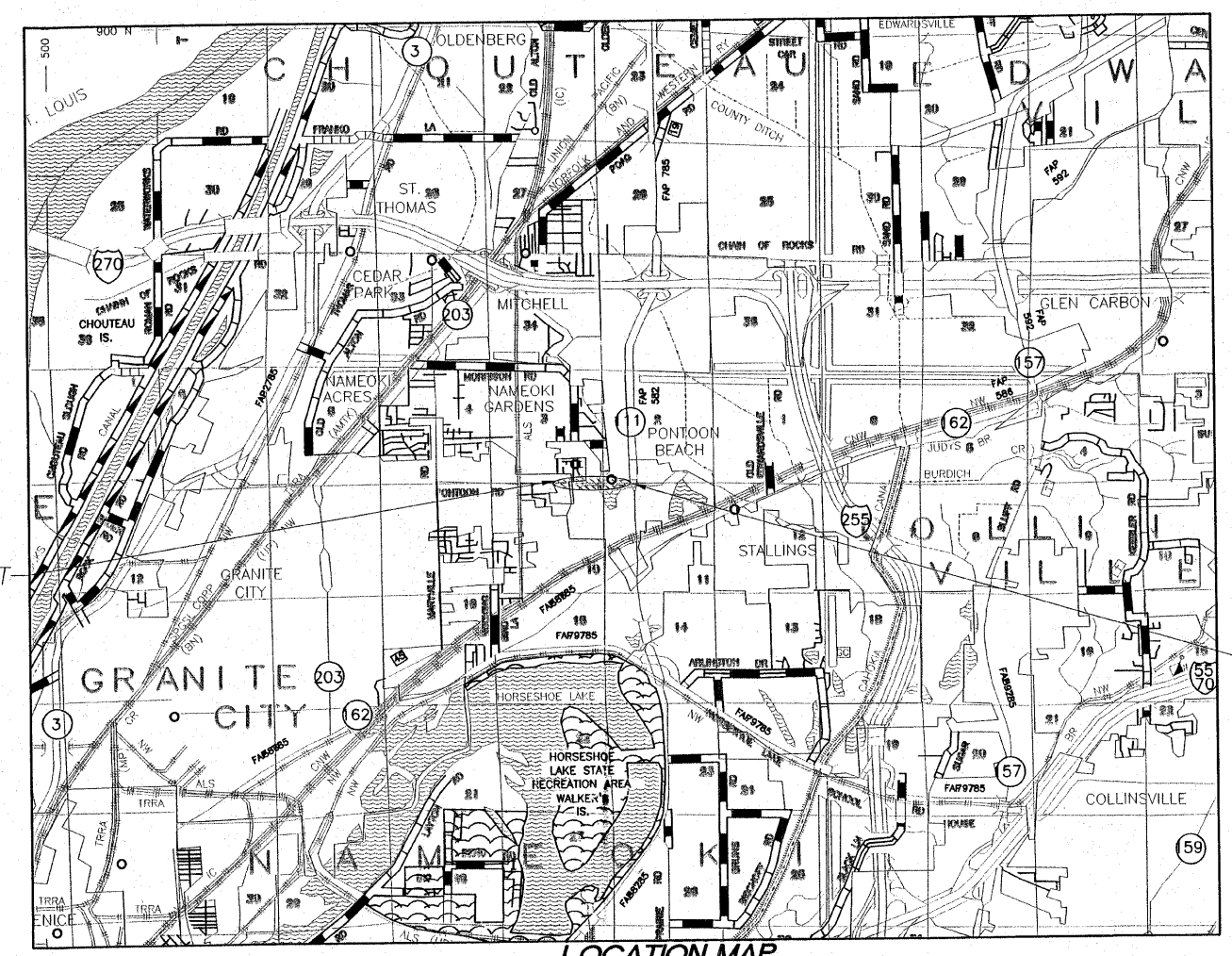

LOCATION MAP

NO SCALE

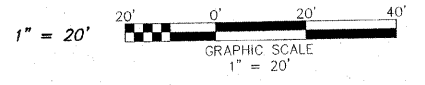

FULL SIZE PLANS HAVE BEEN PREPARED USING STANDARD ENGINEERING SCALES. REDUCED SIZED PLANS WILL NOT CONFORM TO STANDARD SCALES IN MAKING MEASUREMENTS ON REDUCED PLANS THE ABOVE SCALE MAY BE USED

DESIGN DESIGNATION - 12,700 ADT (2010) URBAN MINOR ARTERIAL
 DESIGN SPEED = 35 M.P.H.

NET LENGTH OF PONTOON ROAD IMPROVEMENT = 2,837 FEET = 0.537 MILES

APPROVED: *Shirley Ruth* 20 09
 Mayor
 LOCAL AGENCY REPRESENTATIVE

PASSED: *5/28* 20 09
 DISTRICT 8 ENGINEER OF LOCAL ROADS & STREETS

RELEASING FOR BID
 BASED ON LIMITED
 REVIEW: *5/28/09*
 MARY C. LAMIE, P.E.
 DEPUTY DIRECTOR OF HIGHWAYS
 REGION FIVE ENGINEER
 STATE OF ILLINOIS
 DEPARTMENT OF TRANSPORTATION

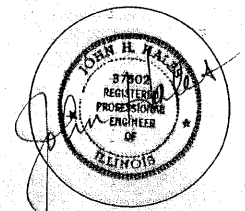

DATED: MAY, 2009
 EXPIRES: NOVEMBER 30, 2009

SMS Sheppard, Morgan & Schwaab, Inc.
 CONSULTING ENGINEERS AND LAND SURVEYORS
 215 Market Street, P.O. Box E, Alton, IL 62002 618/462-9755 E-mail: msll@smsgengineers.com
 10 Central Industrial Drive Suite 3, Granite City, IL 62040 618/977-8700 E-mail: mail@smsgengineers.com