

STATE OF ILLINOIS  
DEPARTMENT OF TRANSPORTATION  
DIVISION OF HIGHWAYS

PLANS FOR PROPOSED  
LOCAL AGENCY PROJECT

VARIOUS FAU ROUTES  
SECTION 09-00070-00-RS  
PROJECT NO. ARA-5064(014)  
CITY OF SALEM, ILLINOIS  
MARION COUNTY  
JOB NO. C-98-368-09  
ARRA RESURFACING

|                      |                |                    |              |              |
|----------------------|----------------|--------------------|--------------|--------------|
| F.A.U. ROUTE         | SECTION        | COUNTY             | TOTAL SHEETS | SHEET NUMBER |
| VARIOUS              | 09-00070-00-RS | MARION             | 10           | 1            |
| FEDERAL AID PROJECT* |                | CONTRACT NO. 97388 |              |              |

\*ARA-5064(014)



APPLICABLE IDOT  
HIGHWAY STANDARDS

- 701501-05
- 701901-01
- 780001-02

INDEX OF SHEETS

1. COVER SHEET
2. SUMMARY OF QUANTITIES, GENERAL NOTES, AND SCHEDULES
3. TYPICAL SECTIONS
- 4.-9. ROADWAY PLAN SHEETS
10. MISCELLANEOUS DETAILS

SCALES



ROADWAY DESIGNATION: URBAN LOCAL COLLECTORS  
FAU 8557 (BOONE STREET) ADT (2009) 1350  
FAU 8562 (AIRPORT ROAD) ADT (2009) 1600  
FAU 8558 (WHITTAKER STREET) ADT (2009) 2600  
FAU 8566 (MARION STREET) ADT (2009) 1400

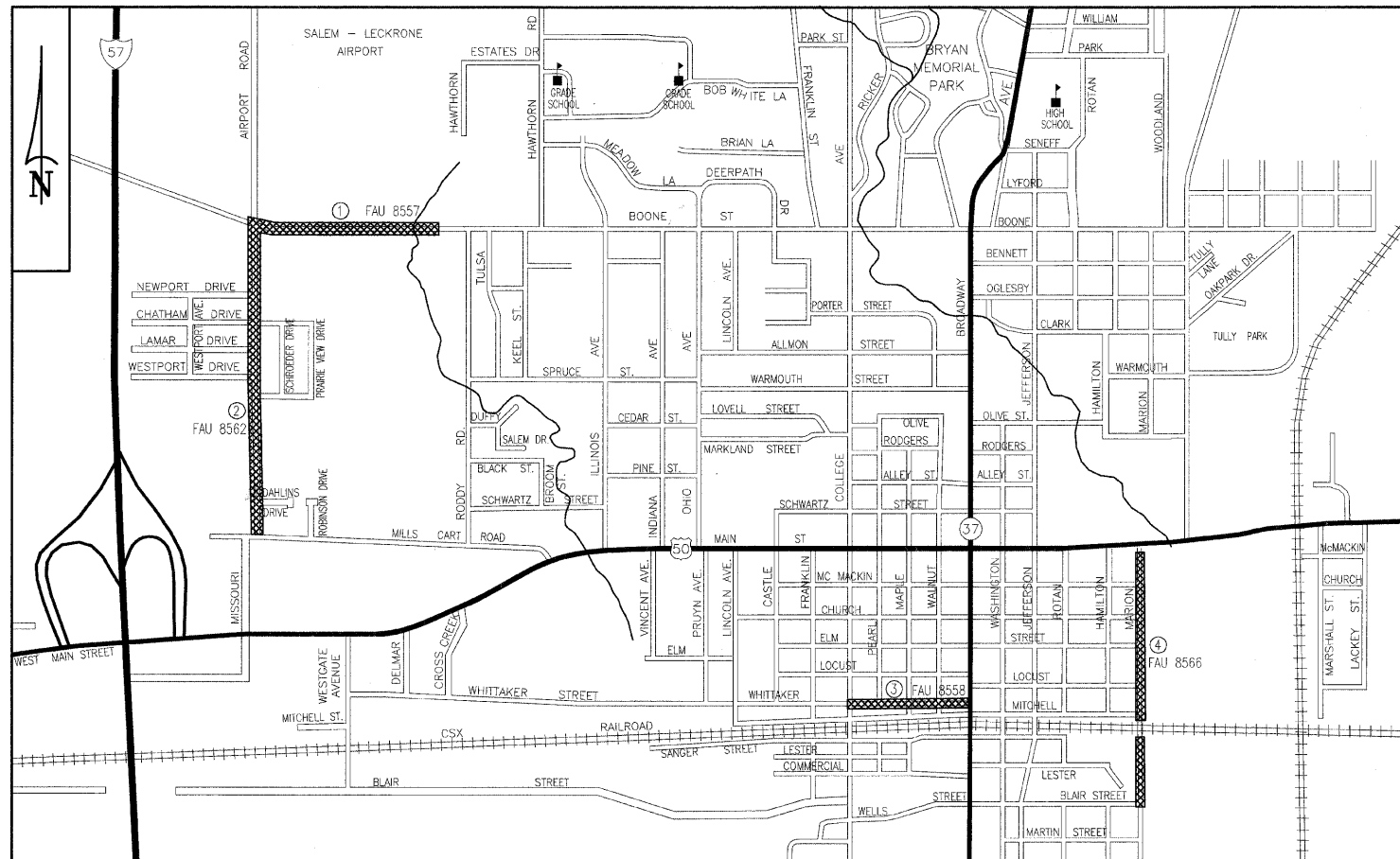

LOCATION MAP  
NOT TO SCALE

LENGTH OF PROJECT

|  | GROSS / NET                    |
|--|--------------------------------|
| ① WEST BOONE STREET = (Sta. 59+85 to Sta. 77+60) | 1,775 FT. / 1,775 FT.          |
| ② AIRPORT ROAD = (Sta. 30+10 to Sta. 58+87)      | 2,877 FT. / 2,877 FT.          |
| ③ WHITTAKER STREET = (Sta. 10+30 to Sta. 20+95)  | 1,065 FT. / 1,065 FT.          |
| ④ MARION STREET = (Sta. 169+70 to Sta. 195+34)   | 2,564 FT. / 1,999 FT.          |
| <b>TOTAL GROSS LENGTH =</b>                      | <b>8,281 FT. = 1.568 MILES</b> |
| <b>TOTAL NET LENGTH =</b>                        | <b>7,716 FT. = 1.461 MILES</b> |

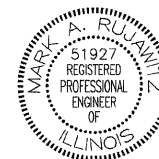

*Mark A. Rujowitz*  
Mark A. Rujowitz  
5/26/2009  
Date of Signing  
11/30/2009  
Date of License Expiration

ILLINOIS  
DEPARTMENT OF  
TRANSPORTATION

APPROVED: 05-26-2009 DATE  
*Thomas Pruiti*  
CITY MANAGER, CITY OF SALEM

PASSED: 5/29/09 DATE  
*[Signature]*  
DISTRICT EIGHT ENGINEER OF LOCAL ROADS & STREETS

RELEASING FOR BID  
BASED ON LIMITED  
REVIEW: 5/29/09 DATE  
*May C. Lane*  
DEPUTY DIRECTOR OF HIGHWAYS, REGION FIVE ENGINEER

HOLD IT ! CALL BEFORE YOU DIG !  
Phone J.U.L.I.E.

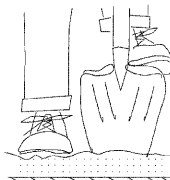

The owner would like to remind you that underground utility facilities can be damaged by shovel blades or other digging equipment. You can prevent damage or possible personal danger by phoning 800/892-0123 at least 48 hours before you dig. That's the toll-free number for "J.U.L.I.E.", which stands for Joint Utilities Location Information for Excavators.

If there are any pipes, cables, lines or mains in the excavation area, utility personnel will be out to mark the facilities so you can work around them.

Toll Free 800/892-0123

PREPARED BY:  
**RHUTASEL and ASSOCIATES, INC.**  
CONSULTING ENGINEERS • LAND SURVEYORS

CORPORATE OFFICE: 4 INDUSTRIAL DRIVE, FREEBURG, ILLINOIS 62243 (618) 539-3178  
REGIONAL OFFICE: 201 SOUTH LOCUST STREET, CENTRALIA, ILLINOIS 62801 (618) 532-1992

|                     |                |                |              |              |
|---------------------|----------------|----------------|--------------|--------------|
| F.A.U. ROUTE        | SECTION        | COUNTY         | TOTAL SHEETS | SHEET NUMBER |
| VARIOUS             | 09-00070-00-RS | MARION         | 10           | 2            |
| FEDERAL AID PROJECT |                | CONTRACT 97388 |              |              |

## SUMMARY OF QUANTITIES

| CODE       | PAY ITEM   | UNIT   | QUANTITY |
|------------|--|--------|----------|
| 40600100   | BITUMINOUS MATERIALS (PRIME COAT)                    | GALLON | 3,730    |
| 40600300   | AGGREGATE (PRIME COAT)                               | TON    | 33       |
| 40600635   | LEVELING BINDER (MACHINE METHOD), N70                | TON    | 444      |
| 40600982   | HOT-MIX ASPHALT SURFACE REMOVAL - BUTT JOINT         | SQ YD  | 199      |
| 40603315   | HOT-MIX ASPHALT SURFACE COURSE, MIX "C", N70         | TON    | 1,884    |
| 40800050   | INCIDENTAL HOT-MIX ASPHALT SURFACING                 | TON    | 32       |
| 44000155   | HOT-MIX ASPHALT SURFACE REMOVAL, 1 1/2"              | SQ YD  | 8,133    |
| 44212900   | PAVEMENT PATCHING (PARTIAL DEPTH)                    | SQ YD  | 12       |
| 67100100   | MOBILIZATION   | L SUM  | 1        |
| 70101700   | TRAFFIC CONTROL AND PROTECTION                       | L SUM  | 1        |
| * 78000100 | THERMOPLASTIC PAVEMENT MARKING - LETTERS AND SYMBOLS | SQ FT  | 115.2    |
| * 78000650 | THERMOPLASTIC PAVEMENT MARKING - LINE 24"            | FOOT   | 48       |

\* SPECIALTY ITEM

## GENERAL NOTES

ALL CONSTRUCTION SHALL BE ACCORDING TO ILLINOIS DEPARTMENT OF TRANSPORTATION STANDARD SPECIFICATIONS FOR ROAD AND BRIDGE CONSTRUCTION, ADOPTED JANUARY 1, 2007.

THE THICKNESS OF THE HOT-MIX ASPHALT SHOWN ON THE PLANS IS THE NOMINAL THICKNESS. DEVIATIONS FROM THE NOMINAL THICKNESS WILL BE PERMITTED WHEN SUCH DEVIATIONS OCCUR DUE TO IRREGULARITIES IN THE EXISTING SURFACE ON WHICH THE HOT-MIX ASPHALT IS PLACED.

FACTORS USED FOR QUANTITY CALCULATIONS ARE AS FOLLOWS:

|                                     |                        |
|-------------------------------------|------------------------|
| PAVING                              |                        |
| ALL HOT-MIX ASPHALT                 | 0.056 TONS/SQ.YD./INCH |
| AGGREGATE (PRIME COAT)              | 0.0015 TONS/SQ.YD.     |
| BITUMINOUS MATERIALS (PRIME COAT)   |                        |
| WHITTAKER STREET                    | 0.075 GAL./SQ.YD.      |
| AIRPORT ROAD                        | 0.150 GAL./SQ.YD.      |
| BOONE STREET                        | 0.150 GAL./SQ.YD.      |
| MARION STREET (MITCHELL TO MAIN)    | 0.075 GAL./SQ.YD.      |
| MARION STREET (BLAIR TO IDOT DRIVE) | 0.300 GAL./SQ.YD.      |

THE CONTRACTOR AND THE ENGINEER SHALL BE AWARE THAT ONLY SIMPLE SURVEY WAS PERFORMED FOR THIS PROJECT. THE STATIONING AND TOPO SHOWN IN THE PLANS WAS CREATED USING MEASUREMENTS MADE BY DESIGN PERSONNEL AND SHALL BE ASSUMED TO BE APPROXIMATE.

THE CONTRACTOR SHALL BE AWARE THAT THERE ARE MANHOLES AND VALVES LOCATED WITHIN THE RESURFACING LIMITS. CARE SHALL BE TAKEN IN THESE LOCATIONS DURING MILLING OPERATIONS.

THE THICKNESS OF HOT-MIX ASPHALT SURFACE REMOVAL IS THE REMOVAL DEPTH AT THE CENTERLINE. AN ESTIMATED 685 TONS OF HOT-MIX ASPHALT SURFACE WILL BE REMOVED.

THE FOLLOWING MIXTURE REQUIREMENTS ARE APPLICABLE FOR THIS PROJECT:

| MIXTURE USE(S)                      | SURFACE      | LEVEL BINDER | INCIDENTAL   |
|-------------------------------------|--------------|--------------|--------------|
| AC/PG                               | PG 64-22     | PG 64-22     | PG 64-22     |
| RAP % (MAX.)                        | 15%          | 25%          | 15%          |
| DESIGN AIR VOIDS                    | 4.0%@Ndes=70 | 4.0%@Ndes=70 | 4.0%@Ndes=70 |
| MIX COMPOSITION (GRADATION MIXTURE) | IL-9.5       | IL-9.5       | IL-9.5       |
| FRICTION AGG                        | MIXTURE C    | MIXTURE C    | MIXTURE C    |

## UTILITY TYPE      NAME OF UTILITY      PHONE NUMBER

|                |                                 |              |
|----------------|---------------------------------|--------------|
| ELECTRIC       | AMEREN IP, MT. VERNON, ILLINOIS | 618-244-8271 |
| GAS            | CITY OF SALEM, SALEM, ILLINOIS  | 618-548-2222 |
| WATER          | CITY OF SALEM, SALEM, ILLINOIS  | 618-548-2222 |
| TELEPHONE      | AT&T, CENTRALIA, ILLINOIS       | 618-533-3418 |
| CABLE          | USSONET, SALEM, ILLINOIS        | 618-548-6909 |
| SANITARY SEWER | CITY OF SALEM SALEM, ILLINOIS   | 618-548-2222 |
| STORM SEWER    | CITY OF SALEM, SALEM, ILLINOIS  | 618-548-2222 |

## PAVEMENT SCHEDULE

| STATION          | LOCATION       | BITUMINOUS MATERIALS (PRIME COAT) | AGGREGATE (PRIME COAT) | HOT-MIX ASPHALT SURFACE COURSE, MIX "C", N70 | LEVELING BINDER (MACHINE METHOD), N70 | INCIDENTAL HOT-MIX ASPHALT SURFACING | HOT-MIX ASPHALT SURFACE REMOVAL, 1 1/2" | HOT-MIX ASPHALT SURFACE REMOVAL - BUTT JOINT |
|------------------|----------------|-----------------------------------|------------------------|--|---------------------------------------|--------------------------------------|---|--|
|                  |                | GALLON                            | TON                    | TON  | TON                                   | TON                                  | SQ. YD.                                 | SQ. YD.                                      |
| 10+30 TO 20+95   | WHITTAKER ST.  | 230                               | 4.6                    | 259  |                                       |                                      | 3,080                                   |  |
| 169+70 TO 175+25 | MARION ST.     | 140                               | 2.8                    | 167  | 57                                    |                                      |   | 80   |
| 180+90 TO 195+34 | MARION ST.     | 1,520                             | 7.6                    | 424  |                                       |                                      | 5,053                                   |  |
| 30+10 TO 58+76   | AIRPORT ROAD   | 1,160                             | 11.6                   | 647  | 241                                   | 26                                   |   | 81   |
| 59+85 TO 77+60   | WEST BOONE ST. | 680                               | 6.8                    | 387  | 146                                   | 6                                    |   | 38   |
| TOTAL            |                | 3,730                             | 33.4                   | 1,884  | 444                                   | 32                                   | 8,133                                   | 199  |

| F.A.U. ROUTE        | SECTION        | COUNTY         | TOTAL SHEETS | SHEET NUMBER |
|---------------------|----------------|----------------|--------------|--------------|
| VARIOUS             | 09-00070-00-RS | MARION         | 10           | 3            |
| FEDERAL AID PROJECT |                | CONTRACT 97388 |              |              |

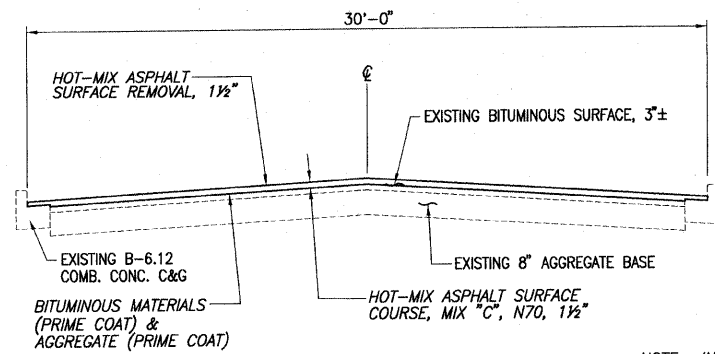

**STA. 10+00 TO 12+25**  
**WHITTAKER STREET**  
 (COLLEGE STREET TO PEARL STREET)  
 Scale: 1"=4' (Horizontal)  
 1"=2' (Vertical)

NOTE: IN THOSE AREAS WHERE BITUMINOUS SURFACE EXISTS IN GUTTER PAN, REMOVE SURFACE COMPLETELY TO P.C.C. BASE. COST SHALL BE INCLUDED IN COST OF HMA SURFACE REMOVAL, 1 1/2".

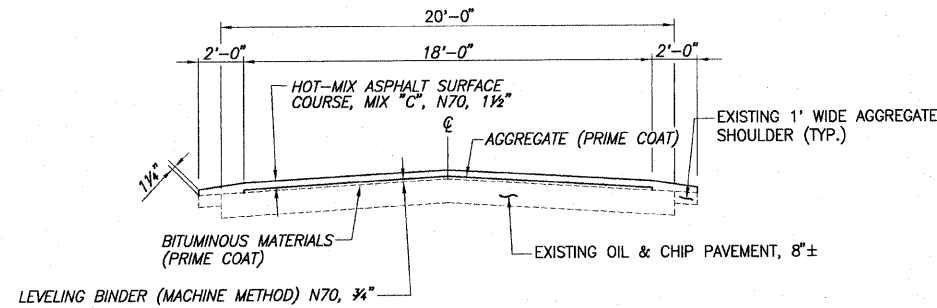

**STA. 59+85 TO 77+60**  
**BOONE STREET**  
 (AIRPORT ROAD TO PCC PAVEMENT WEST OF RODDY ROAD)  
 Scale: 1"=4' (Horizontal)  
 1"=2' (Vertical)

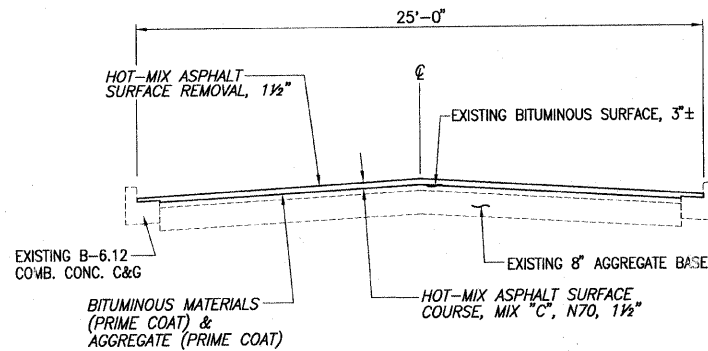

**STA. 12+25 TO 20+95**  
**WHITTAKER STREET**  
 (PEARL STREET TO BROADWAY STREET)  
 Scale: 1"=4' (Horizontal)  
 1"=2' (Vertical)

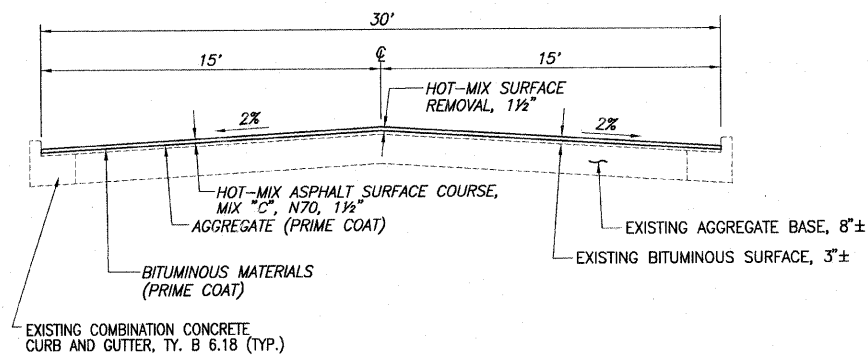

**STA. 180+96 TO 195+34**  
**MARION STREET**  
 (MITCHELL STREET TO MAIN STREET)  
 Scale: 1"=4' (Horizontal)  
 1"=2' (Vertical)

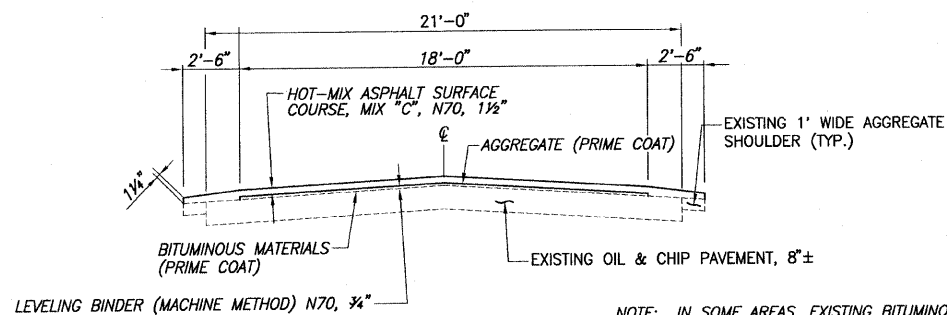

**STA. 30+00 TO 58+87**  
**AIRPORT ROAD**  
 (MILL CART ROAD TO BOONE STREET)  
 Scale: 1"=4' (Horizontal)  
 1"=2' (Vertical)

NOTE: IN SOME AREAS, EXISTING BITUMINOUS SURFACE TREATMENT MAY EXTEND TO ROADWAY LIMITS SHOWN AS AGGREGATE SHOULDER.

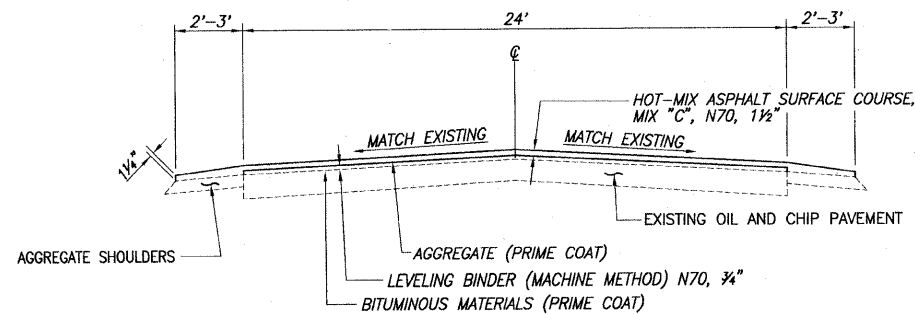

**STA. 170+00 TO 174+80**  
**MARION STREET**  
 (BLAIR STREET TO I.D.O.T. YARD DRIVEWAY)  
 Scale: 1"=4' (Horizontal)  
 1"=2' (Vertical)

| F.A.U. ROUTE        | SECTION        | COUNTY | TOTAL SHEETS   | SHEET NUMBER |
|---------------------|----------------|--------|----------------|--------------|
| VARIOUS             | 09-00070-00-RS | MARION | 10             | 4            |
| FEDERAL AID PROJECT |                |        | CONTRACT 97388 |              |

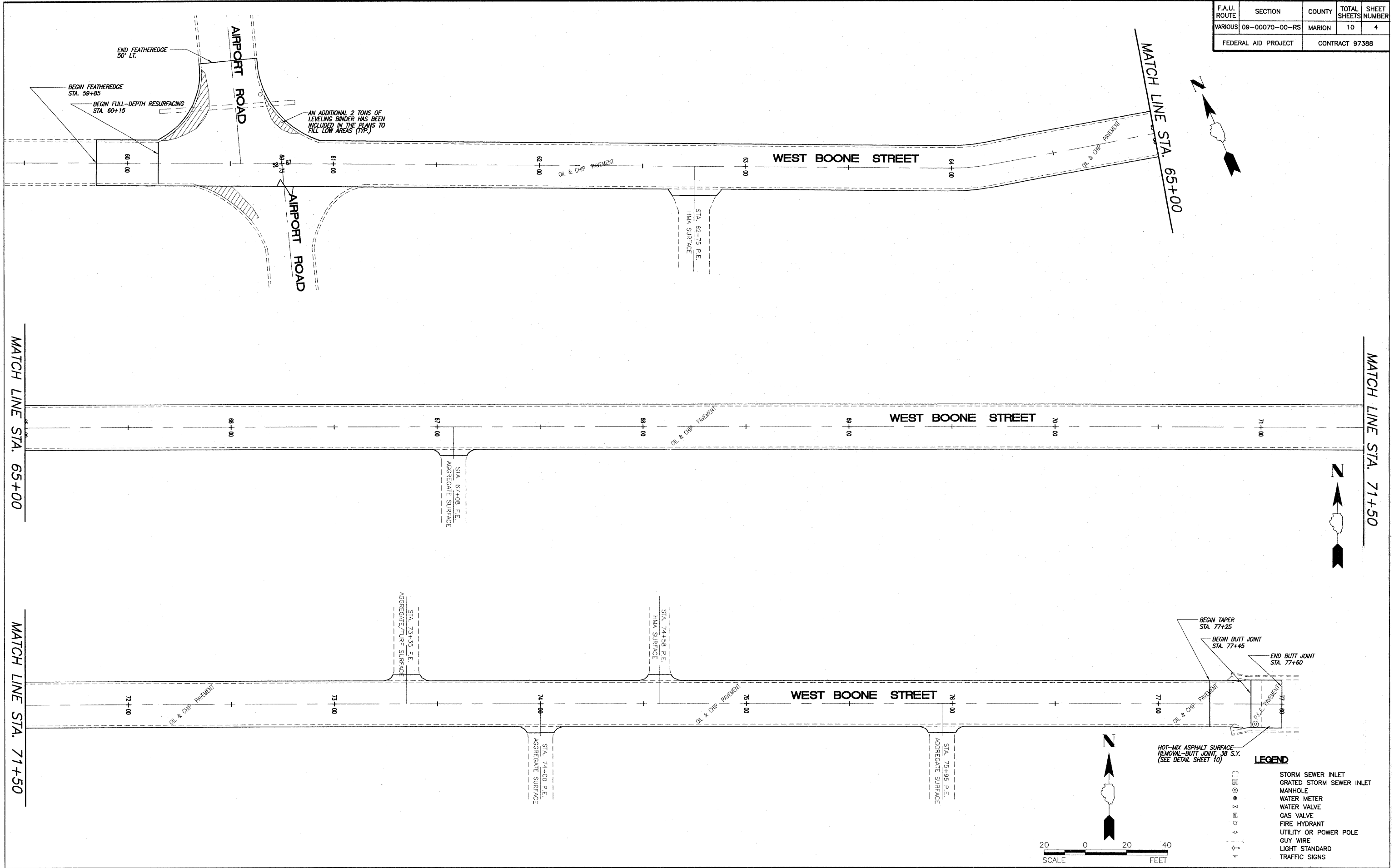

|                     |                |                |              |              |
|---------------------|----------------|----------------|--------------|--------------|
| F.A.U. ROUTE        | SECTION        | COUNTY         | TOTAL SHEETS | SHEET NUMBER |
| VARIOUS             | 09-00070-00-RS | MARION         | 10           | 5            |
| FEDERAL AID PROJECT |                | CONTRACT 97388 |              |              |

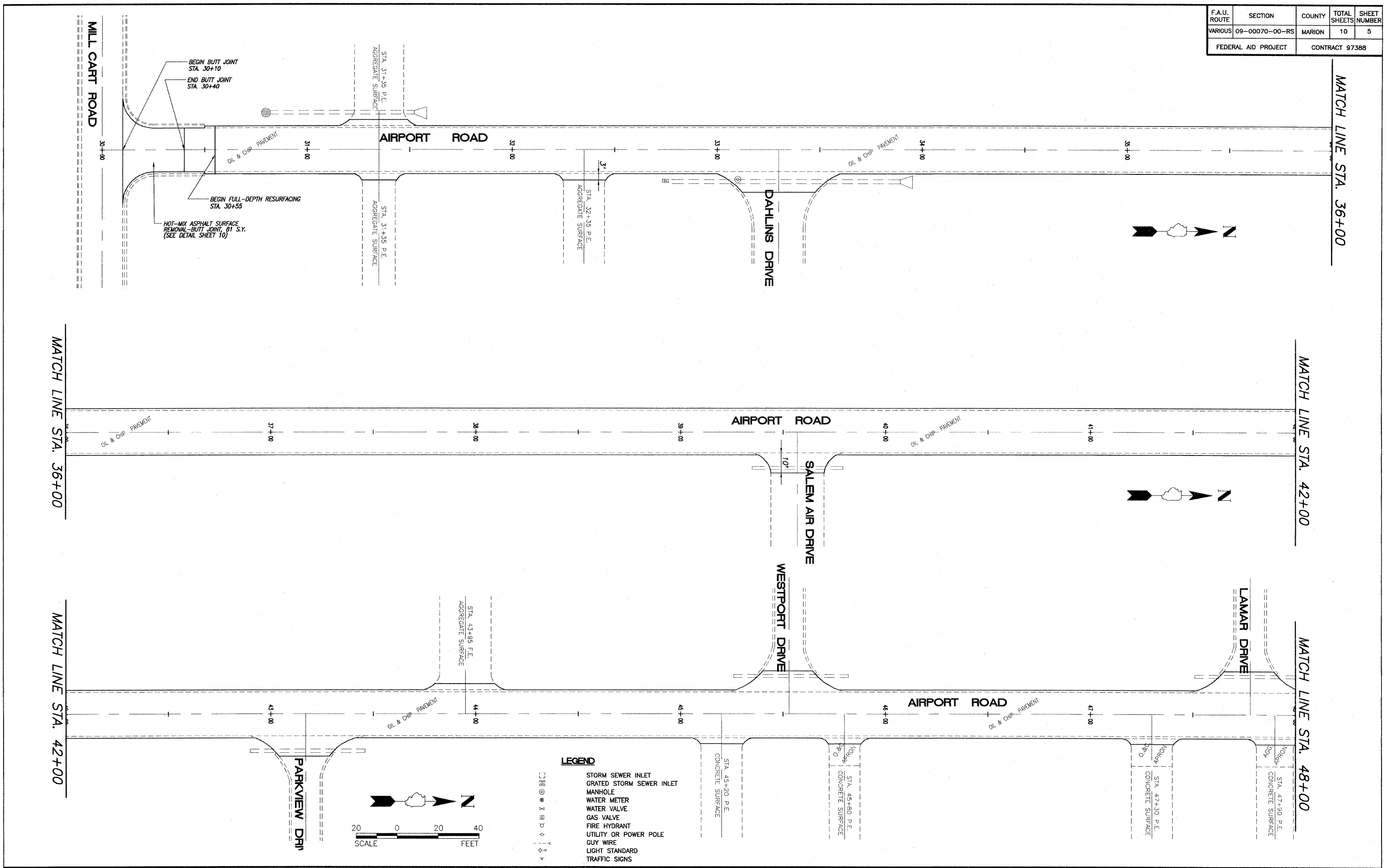

**LEGEND**

- STORM SEWER INLET
- ▣ GRATED STORM SEWER INLET
- MANHOLE
- ⊙ WATER METER
- ⊕ WATER VALVE
- ⊖ GAS VALVE
- ⊗ FIRE HYDRANT
- ⊘ UTILITY OR POWER POLE
- ⊙ GUY WIRE
- ⊙ LIGHT STANDARD
- ⊙ TRAFFIC SIGNS



|                     |                |                |              |              |
|---------------------|----------------|----------------|--------------|--------------|
| F.A.U. ROUTE        | SECTION        | COUNTY         | TOTAL SHEETS | SHEET NUMBER |
| VARIOUS             | 09-00070-00-RS | MARION         | 10           | 6            |
| FEDERAL AID PROJECT |                | CONTRACT 97388 |              |              |

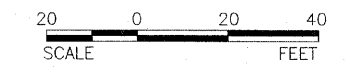
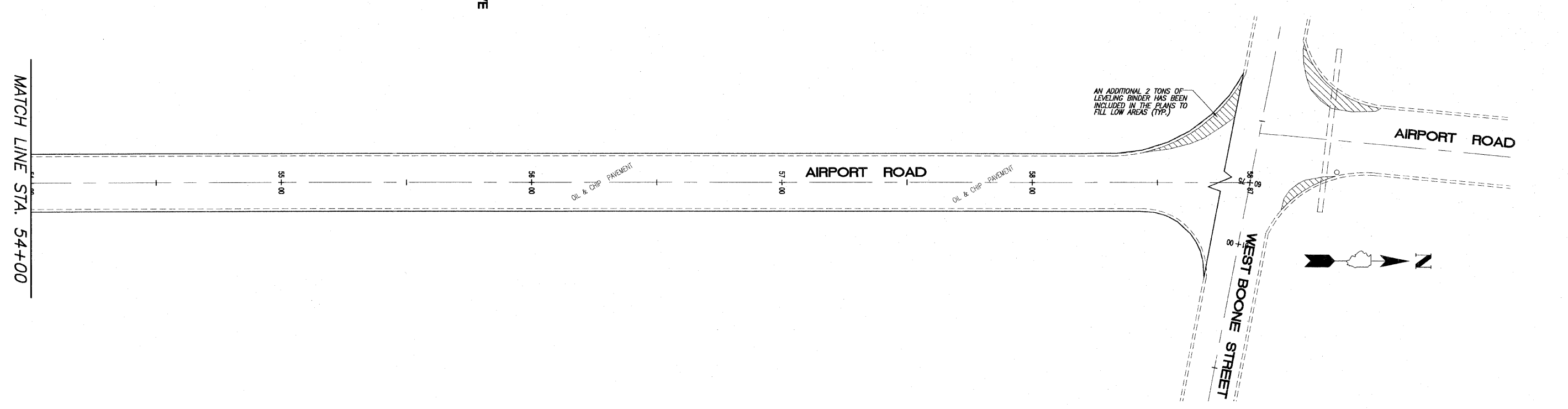
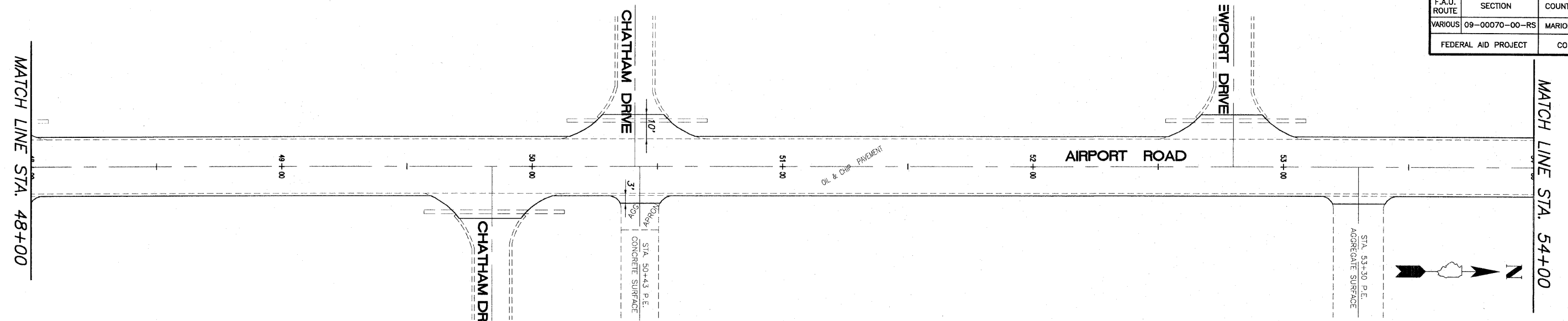

- LEGEND**
- STORM SEWER INLET
  - ▣ GRATED STORM SEWER INLET
  - MANHOLE
  - ⊙ WATER METER
  - ⊕ WATER VALVE
  - ⊖ GAS VALVE
  - ⊗ FIRE HYDRANT
  - ⊘ UTILITY OR POWER POLE
  - ⊙ GUY WIRE
  - ⊙ LIGHT STANDARD
  - ⊙ TRAFFIC SIGNS

|                     |                |                |              |              |
|---------------------|----------------|----------------|--------------|--------------|
| F.A.U. ROUTE        | SECTION        | COUNTY         | TOTAL SHEETS | SHEET NUMBER |
| VARIOUS             | 09-00070-00-RS | MARION         | 10           | 7            |
| FEDERAL AID PROJECT |                | CONTRACT 97388 |              |              |

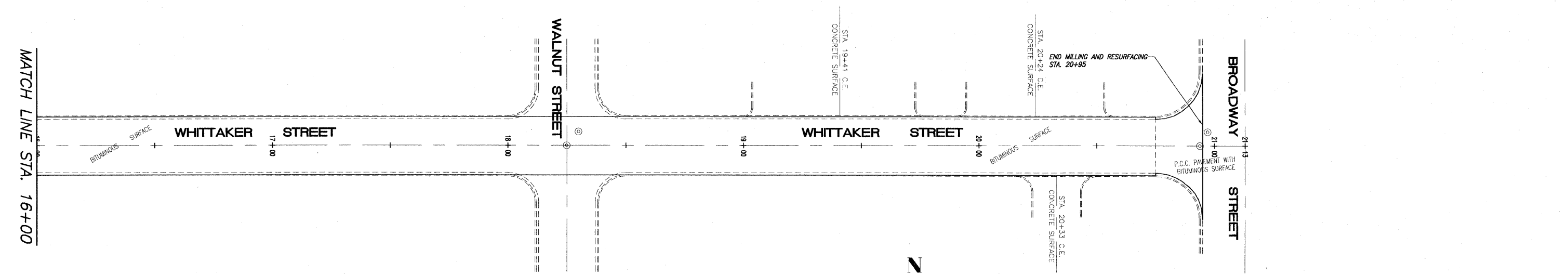
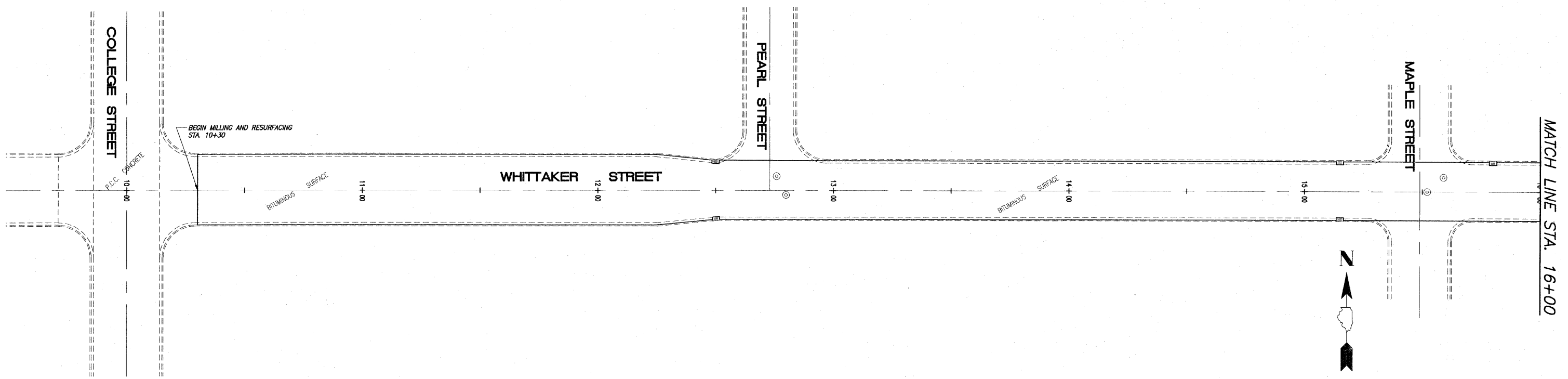

**LEGEND**

- STORM SEWER INLET
- ⊕ GRATED STORM SEWER INLET
- MANHOLE
- ⊙ WATER METER
- ⊗ WATER VALVE
- ⊕ GAS VALVE
- ⊙ FIRE HYDRANT
- ⊙ UTILITY OR POWER POLE
- ⊙ GUY WIRE
- ⊙ LIGHT STANDARD
- ⊙ TRAFFIC SIGNS

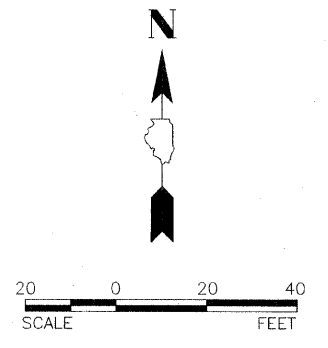

|                     |                |        |                |              |
|---------------------|----------------|--------|----------------|--------------|
| F.A.U. ROUTE        | SECTION        | COUNTY | TOTAL SHEETS   | SHEET NUMBER |
| VARIOUS             | 09-00070-00-RS | MARION | 10             | 8            |
| FEDERAL AID PROJECT |                |        | CONTRACT 97388 |              |

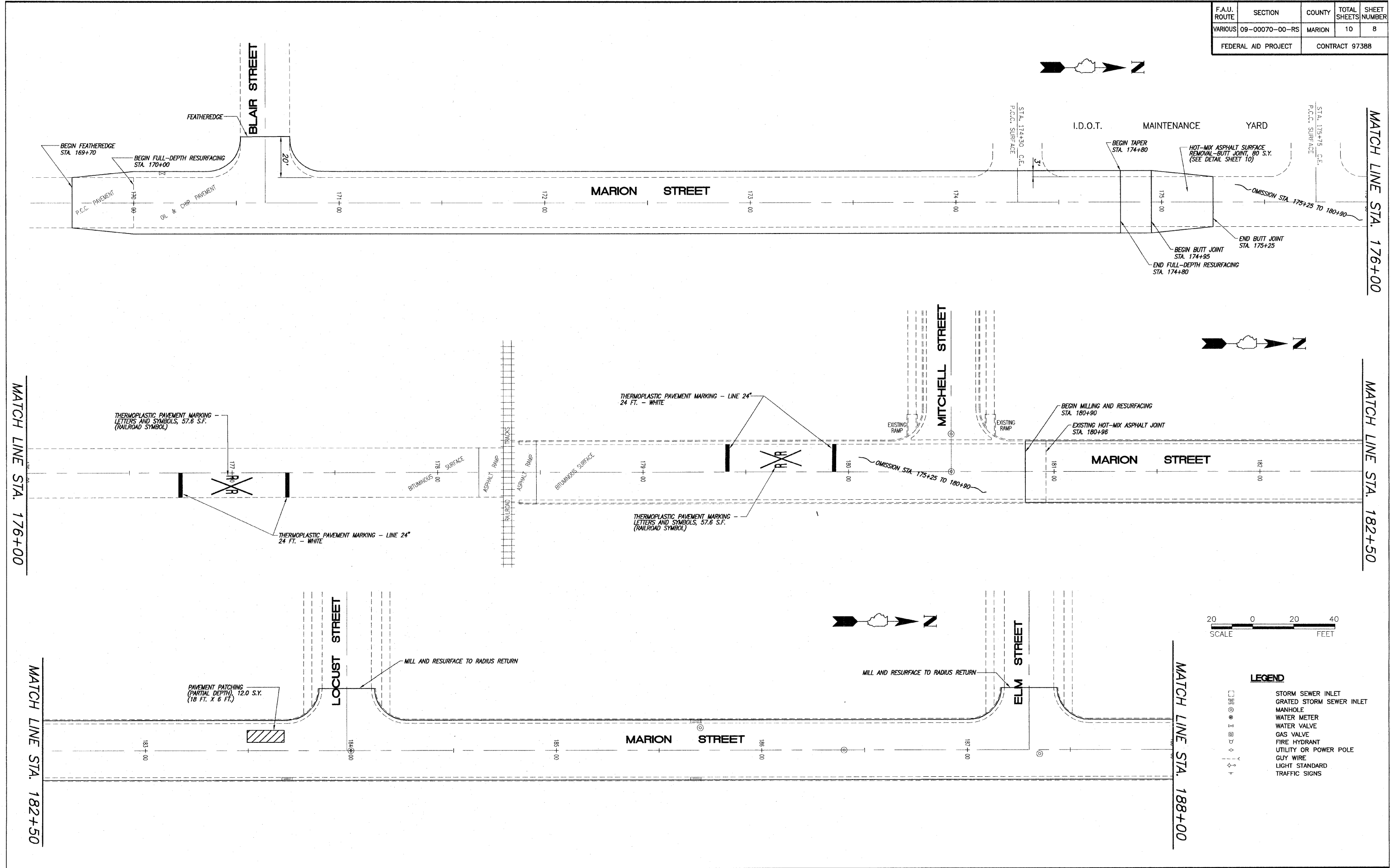

- LEGEND**
- STORM SEWER INLET
  - ⊕ GRATED STORM SEWER INLET
  - MANHOLE
  - ⊙ WATER METER
  - ⊕ WATER VALVE
  - ⊕ GAS VALVE
  - ⊕ FIRE HYDRANT
  - ⊕ UTILITY OR POWER POLE
  - ⊕ GUY WIRE
  - ⊕ LIGHT STANDARD
  - ⊕ TRAFFIC SIGNS

E:\00001 - 2003 Salem ARRA Resurfacing\09-00070-00-RS - 27 FEET PLANS.dwg, 6/12/2008 10:56:04 AM, Printed by P.L.L.



| F.A.U. ROUTE        | SECTION        | COUNTY         | TOTAL SHEETS | SHEET NUMBER |
|---------------------|----------------|----------------|--------------|--------------|
| VARIOUS             | 09-00070-00-RS | MARION         | 10           | 9            |
| FEDERAL AID PROJECT |                | CONTRACT 97388 |              |              |



- LEGEND**
- ☐ STORM SEWER INLET
  - ⊗ GRATED STORM SEWER INLET
  - MANHOLE
  - ⊕ WATER METER
  - ⊖ WATER VALVE
  - ⊙ GAS VALVE
  - ⊕ FIRE HYDRANT
  - ⊕ UTILITY OR POWER POLE
  - ⊕ GUY WIRE
  - ⊕ LIGHT STANDARD
  - ⊕ TRAFFIC SIGNS

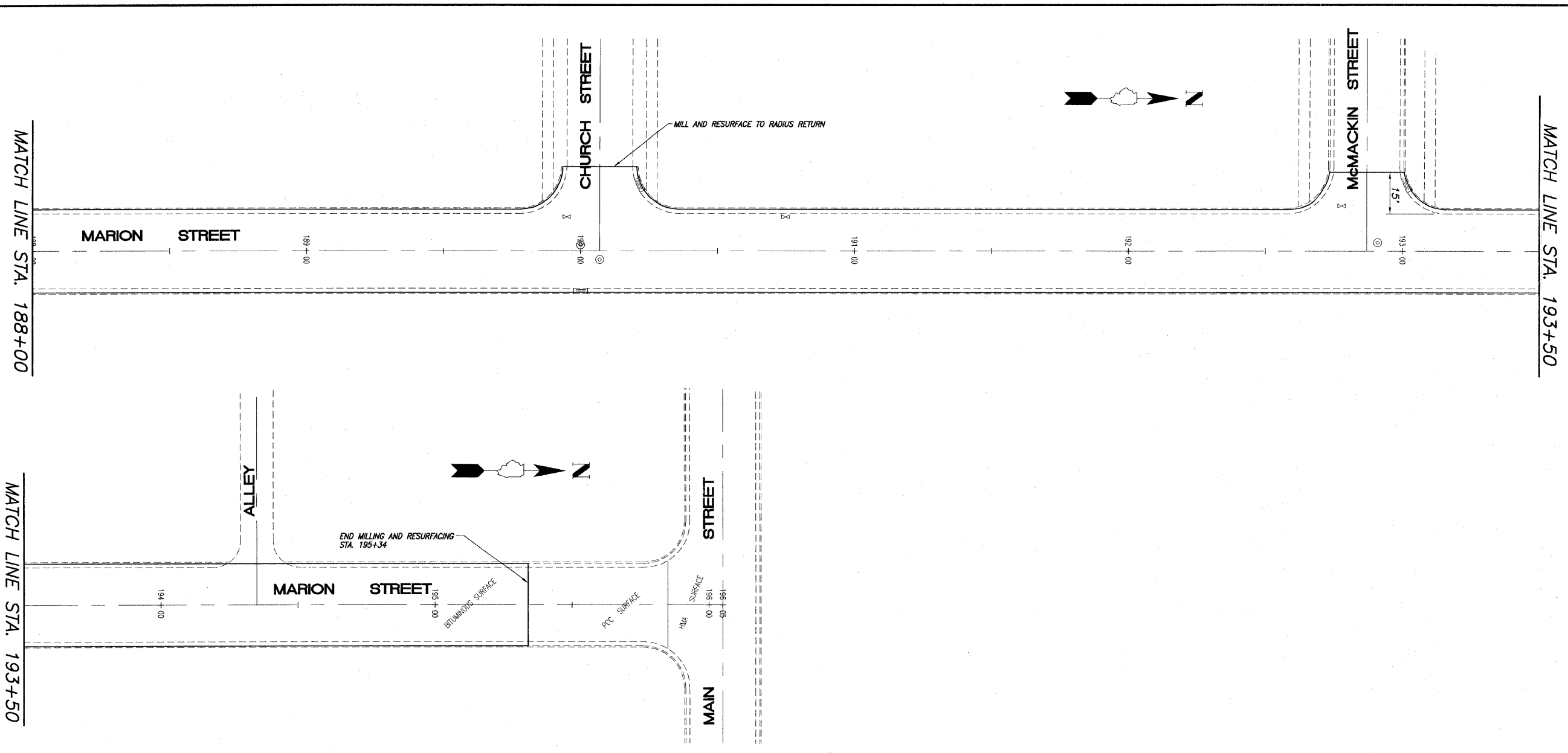

|                     |                |                |              |              |
|---------------------|----------------|----------------|--------------|--------------|
| F.A.U. ROUTE        | SECTION        | COUNTY         | TOTAL SHEETS | SHEET NUMBER |
| VARIOUS             | 09-00070-00-RS | MARION         | 10           | 10           |
| FEDERAL AID PROJECT |                | CONTRACT 97388 |              |              |

