

S.B.I. RTE.	SECTION	COUNTY	TOTAL SHEETS	SHEET NO.
150	(113A) D, I	ALEXANDER	32	1
FED. ROAD DIST. NO. -		ILLINOIS	CONTRACT NO. 98910	

D-99-017-05

*32+3=35

INDEX OF SHEETS

- 1 COVER SHEET
- 2 GENERAL NOTES & COMMITMENTS
- 3 SUMMARY OF QUANTITIES
- 4 SCHEDULE OF QUANTITIES
- 5 ALIGNMENT & SURVEY CONTROL POINTS
- 6 PLAN AND PROFILE SHEET
- 7 MAINTENANCE OF TRAFFIC DETAIL
- 8-31 STRUCTURAL PLANS
- 32-32c BRIDGE APPROACH PAVEMENT DETAILS

HIGHWAY STANDARDS

000001-05
001001-02
001006

421001-02
515001-03
635006-03
635011-02
701001-02
701006-03
701901-01
720011-01
728001-01
729001-01
780001-02
781001-03
BLR 21-8

STATE OF ILLINOIS
DEPARTMENT OF TRANSPORTATION
DIVISION OF HIGHWAYS

PROPOSED
HIGHWAY PLANS

SBI ROUTE 150 (OLD IL 3)
SECTION (133A) D, I
PROJECT: BHOS-000S(683)
ALEXANDER COUNTY

C-99-023-09
BRIDGE REHABILITATION OVER SEXTON CREEK

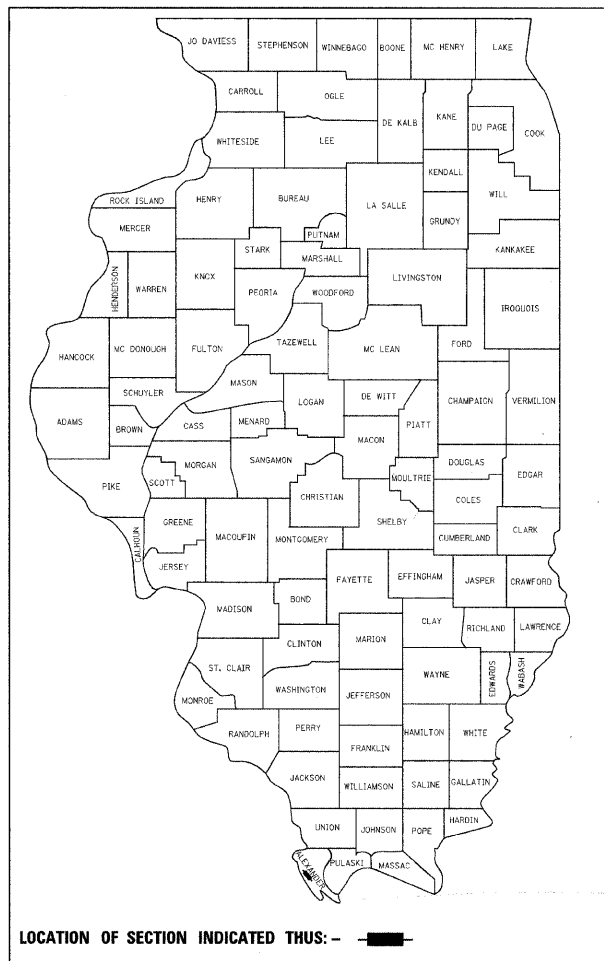

LOCATION OF SECTION INDICATED THUS: - [shaded box]

PREPARED BY:
LIN ENGINEERING, LTD.
CHATHAM, ILLINOIS 62629
(217) 483-4168

Fred M. Lin

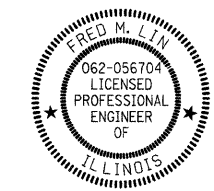

SEAL

FRED M. LIN, P.E.
ILLINOIS REGISTERED ENGINEER NO. 062-056704
REGISTRATION EXPIRES NOV. 30, 2009

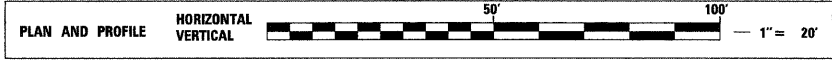

FULL SIZE PLANS HAVE BEEN PREPARED USING STANDARD ENGINEERING SCALES. REDUCED SIZED PLANS WILL NOT CONFORM TO STANDARD SCALES. IN MAKING MEASUREMENTS ON REDUCED PLANS, THE ABOVE SCALES MAY BE USED.

J.U.L.I.E.
JOINT UTILITY LOCATION INFORMATION FOR EXCAVATION
1-800-892-0123
OR 811

THEBES TOWNSHIP, SECTION 4

PROJECT ENGINEER - DAVID PICHE (618) 351-5227
CONSULTANT - LIN ENGINEERING, LTD (630) 323-5168
TENG AND ASSOCIATES (312) 616-0000
CONTRACT NO. 98910

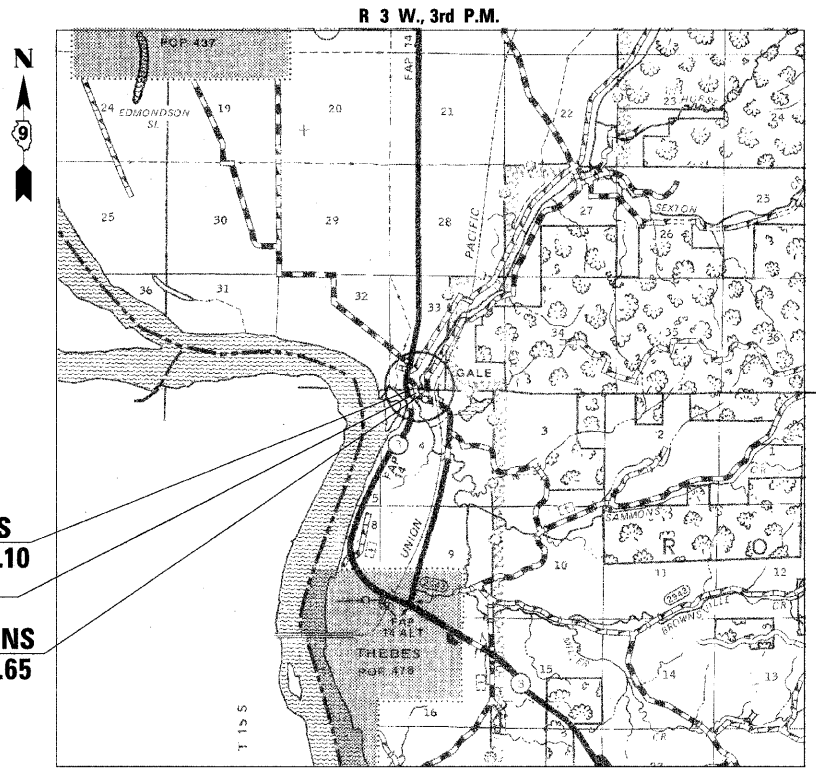

PROJECT ENDS
STA 1214 + 90.10
S.N. 002-0009
PROJECT BEGINS
STA 1210 + 79.65



GROSS LENGTH OF IMPROVEMENT = 410.5 FT = 0.08 MILE
NET LENGTH OF IMPROVEMENT = 410.5 FT = 0.08 MILE

STATE OF ILLINOIS
DEPARTMENT OF TRANSPORTATION
DIVISION OF HIGHWAYS

SUBMITTED *April 29 2009*

Mary C. Lamic
DEPUTY DIRECTOR OF HIGHWAYS, REGION ENGINEER

June 26, 2009
Charles G. Ingraw
ENGINEER OF DESIGN AND ENVIRONMENT

June 26, 2009
Christine M. Reed
DIRECTOR OF HIGHWAYS, CHIEF ENGINEER

PRINTED BY THE AUTHORITY
OF THE STATE OF ILLINOIS